

NOTES:
1. MATERIAL AND FINISH (PLATING THICKNESS IN MICRO-INCHES):
BODY BERYLLIUM COPPER, ALBALOY PLATING OVER SILVER
CONTACT PIN BERYLLIUM COPPER, GOLD PLATING
INSULATOR PTFE, NATURAL

2. ELECTRICAL:
A. IMPEDANCE:50 OHM
B. FREQUENCY RANGE: DC- 6 GHz
C. RETURN LOSS(VSWR) AT AXIAL FLOAT POSITION:
DC-3 GHz: 28 dB (1.08) @ NOMINAL
21 dB (1.12) @ ±0.7 mm
3-6 GHz: 22 dB (1.17) @ NOMINAL
19 dB (1.25) @ ±0.7 mm
D. INSULATION RESISTANCE:5 GOHM MIN.
E. POWER HANDLING:40 W MAX.@ 2.6GHz AT 85°C
F. STATIC INTERMODULATION 3RD ORDER IN ALL AXIAL FLOAT POSITIONS:
-163 dBc MAX. (930 MHz & 955 MHz AT 43 dBm)

3. MECHANICAL:
A. MATING CYCLES:200 MIN FOR SMOOTH BORE
50 MIN FOR LIMITED DETENT
B. TEMPERATURE RANGE:-55°C TO +125°C

4. PACKAGING:
A. PACKAGE IN 50 PIECE TRAYS
B. MARK TRAYS: "AMPHENOL RF, 920-505A-51S, DATE CODE"

THIRD ANGLE PROJ.

REVISIONS				
REV	DESCRIPTION	DATE	ECN	APPR
A	RELEASE TO MFG.	24-May-18	8168	BMG

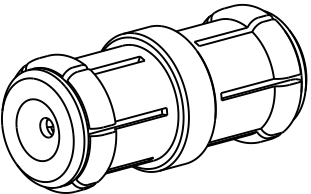

SCALE 5.000

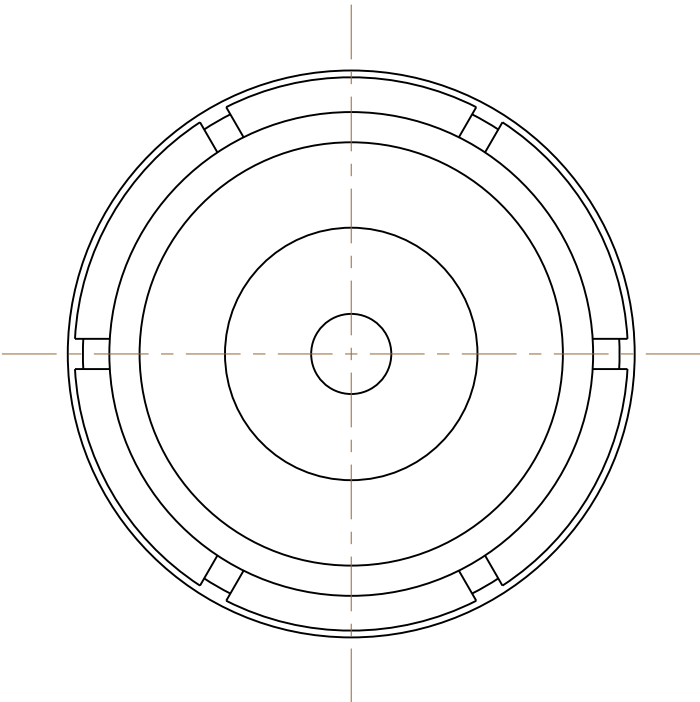
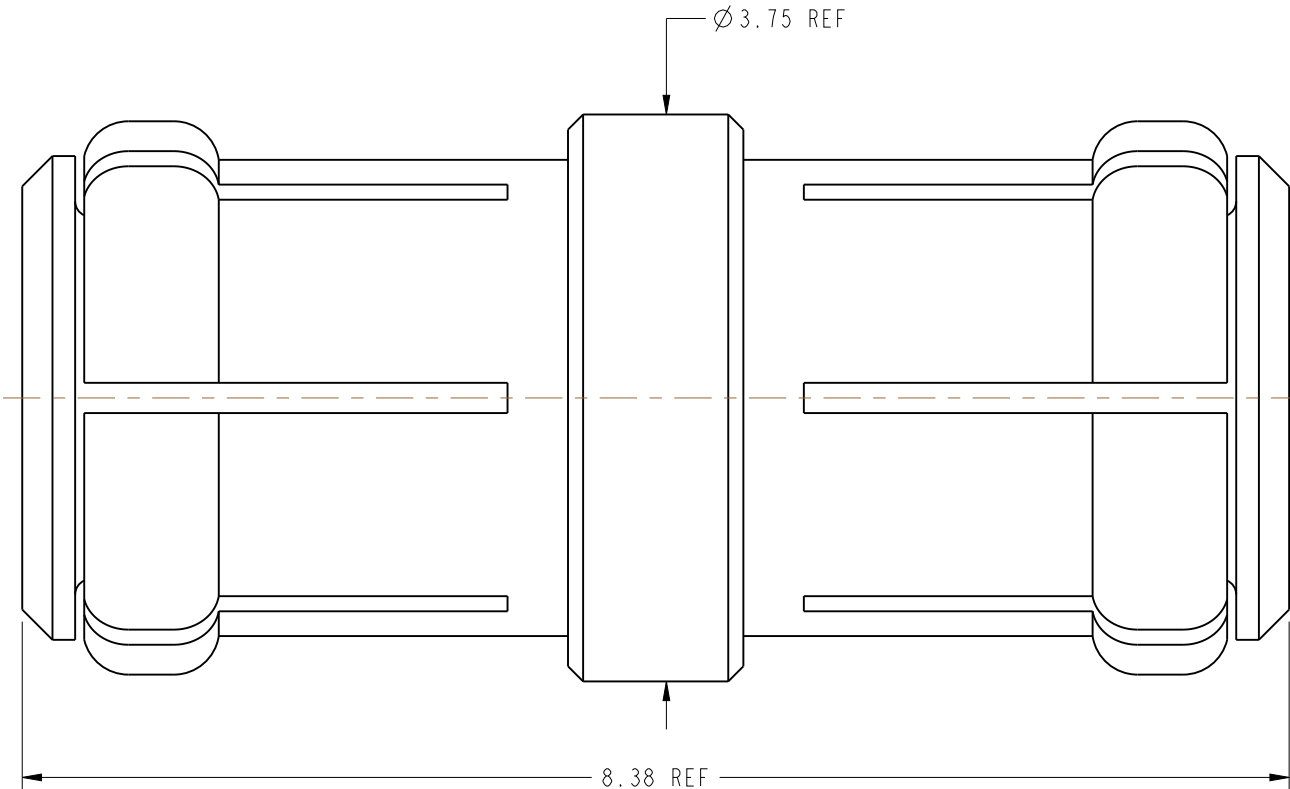

CUSTOMER OUTLINE DRAWING
ALL OTHER SHEETS ARE FOR INTERNAL USE ONLY

<div>UNLESS OTHERWISE SPECIFIED, DIMENSIONS ARE IN METRIC AND TOLERANCES ARE: <0.5mm 0.5 - 6mm 6 - 30mm 30 - 120mm ANGLES ± 0.05mm ±0.1mm ±0.2mm ± 0.3mm ±1°</div> <div>NOTICE - These drawings, specifications, or other data (1) are, and remain the property of Amphenol corp. (2) must be returned upon request; and (3) are confidential and not to be disclosed to any person other than those to whom they are given by Amphenol Corp. the furnishing of these drawings, specifications, or other data by Amphenol Corp., or to any other person to anyone for any purpose is not to be regarded by implication or otherwise in any manner licensing, granting rights to permitting such holder or any other person to manufacture, use or sell any product, process or design, patented or otherwise, that may in any way be related to or disclosed by said drawings, specifications, or other data.</div>	MATERIAL	DRAWN	DATE	TITLE HD-EFI 8.38MM BULLET		Amphenol RF www.amphenolrf.com	
	SEE NOTES	B. GREENBAUM	18-May-17				
	REFERENCE	ENGINEER	DATE				
	EAR# 7563	B. GREENBAUM	18-May-17	SCALE: 20.0:1.0 SHEET 2 OF 2		DRAWING NO. 920-505A-51S	
	REF: 615X-3349-X00	APPROVED	DATE	DWG SIZE B		ITEM NO. 920-505A-51S	
CONFIGURATION LEVEL: In Work		K.CAPOZZI	24-May-18			PART NO. 920-505A-51S	
FINISH		CAD FILE		REV A			