

## RAFIX 16 F - Signal indicator, flush lens

1.65.126.301/1300



### General information

|                 |                 |
|-----------------|-----------------|
| Form of lens    | flat lens       |
| Color of lens   | transparent red |
| Form of collar  | square          |
| Form of collar  | square          |
| Color of collar | black           |

### Dimensions

|                                   |                |
|-----------------------------------|----------------|
| Collar dimensions                 | 24.9 x 24.9 mm |
| Overall height                    | 1.7 mm         |
| Mounting depth with contact block | 50 mm          |
| Key grid                          | 30 x 30 mm     |
| Mounting hole                     | 23.1 x 23.1 mm |

### Mechanical design

|                  |          |
|------------------|----------|
| Mounting         | ring nut |
| Contact function | -        |
| Illumination     | yes      |

### Other specifications

|   |  |
|---|--|
| Operating life (operations)                     | - cycle                                  |
| Degree of protection from front side            | IP65 (DIN EN 60529)                      |
| Operation temperature min.                      | -25 °C                                   |
| Ambient temp. operating max. without lamp / LED | - °C                                     |
| Ambient temp. operating max. with lamp /LED     | +55 °C                                   |
| Storage temperature min.                        | -40 °C                                   |
| Storage temperature max.                        | +85 °C                                   |
| Environmental resistance                        | acc. to IEC 60068-2-14, -30, -33 and -78 |
| ROHS compliant                                  | yes                                      |
| REACH compliant                                 | yes                                      |

### Panel cut-out

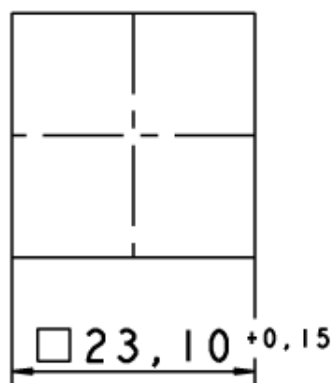

Technical data are approximate and intended solely for general orientation in the selection of a product.  
Subject to modifications and errors. Images and other graphics may only be similar.  
For more information, refer to [www.rafi.de](http://www.rafi.de) chapter Imprint / Data Protection.

with PCB plug-in socket

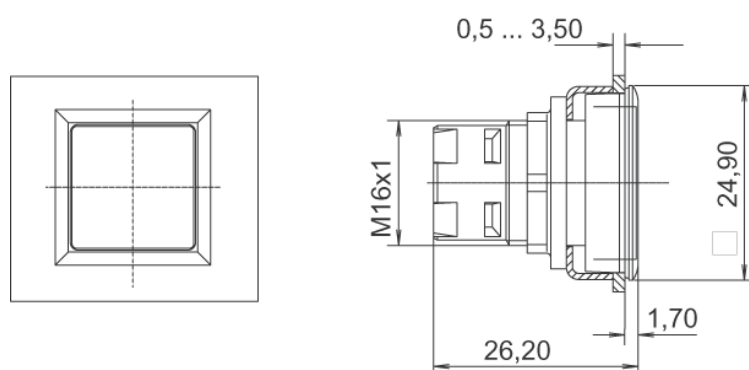
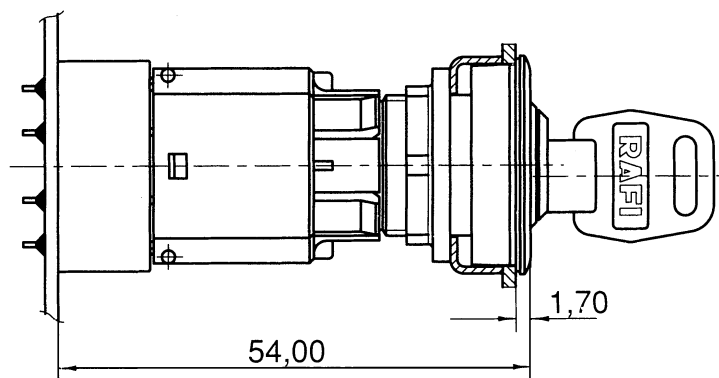

operating element and contact block

