

Flush-type socket - SACC-DSI-FSX-8CON-PG9-L180 SCO - 1404741

Please be informed that the data shown in this PDF Document is generated from our Online Catalog. Please find the complete data in the user's documentation. Our General Terms of Use for Downloads are valid (<http://phoenixcontact.com/download>)



CAT6_A flush-type socket, Ethernet, one-piece, 8-pos., M12-SPEEDCON, rear/screw mounting with Pg9 fastening thread, with straight solder connection

M12 panel feed-through, rear mounting

Product Features



Key commercial data

Packing unit	1 pc
Weight per Piece (excluding packing)	30.0 GRM
Custom tariff number	85366990
Country of origin	Germany

Technical data

Dimensions

Length of the solder pin	6 mm
--------------------------	------

Ambient conditions

Ambient temperature (operation)	-40 °C ... 85 °C
Degree of protection	IP67 (When plugged in)

General

Rated current at 40°C	0.5 A (Data)
Rated voltage	48 V
Rated surge voltage	0.8 kV
Number of positions	8

Flush-type socket - SACC-DSI-FSX-8CON-PG9-L180 SCO - 1404741

Technical data

General

Contact resistance	$\leq 3 \text{ m}\Omega$
Insulation resistance	$> 100 \text{ M}\Omega$
Coding	X - data
Signal type/category	Ethernet CAT6 _A
Surge voltage category	III
Pollution degree	3
Connection method	Solder-in connection
Insertion/withdrawal cycles	≥ 100
Mounting type	Rear mounting M12 x 1

Material

Inflammability class according to UL 94	V0
Contact material	CuZn
Contact surface material	Gold-plated
Contact carrier material	PPA
Material of grip body	Zinc die-cast, nickel-plated
Material, knurls	Zinc die-cast, nickel-plated
Material	Zinc die-cast (nickel-plated)
Sealing material	FKM

Cable

Transmission characteristics (category)	CAT6 _A
---	-------------------

Classifications

eCl@ss

eCl@ss 4.0	272607xx
eCl@ss 4.1	27260701
eCl@ss 5.0	27260701
eCl@ss 5.1	27260701
eCl@ss 6.0	27180802
eCl@ss 7.0	27182702

ETIM

ETIM 3.0	EC001031
ETIM 4.0	EC002498
ETIM 5.0	EC002498

Flush-type socket - SACC-DSI-FSX-8CON-PG9-L180 SCO - 1404741

Classifications

UNSPSC

UNSPSC 6.01	31261501
UNSPSC 7.0901	31261501
UNSPSC 11	31261501
UNSPSC 12.01	31261501
UNSPSC 13.2	31261501

Approvals

Approvals

Approvals

EAC / EAC

Ex Approvals

Approvals submitted

Approval details

EAC

EAC

Drawings

Dimensional drawing

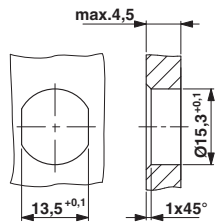

Schematic diagram

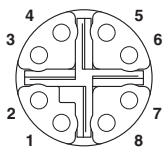

M12 socket pin assignment, 8-pos, view of socket side

Housing cutout for Pg9 fastening thread, mounting panel with feed-through hole (alternatively with surface as protection against rotation)

Flush-type socket - SACC-DSI-FSX-8CON-PG9-L180 SCO - 1404741

Drilling diagram

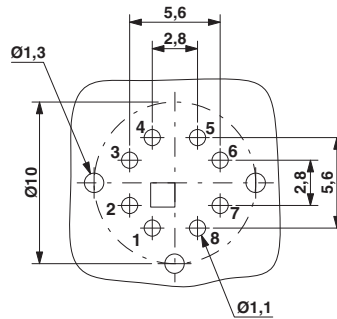

Soldering pad geometry