

PART NUMBER
10145295-101LF

BULKHEAD ADAPTER ASSEMBLY FOR OCTIS MPO ADAPTER PLUG KIT

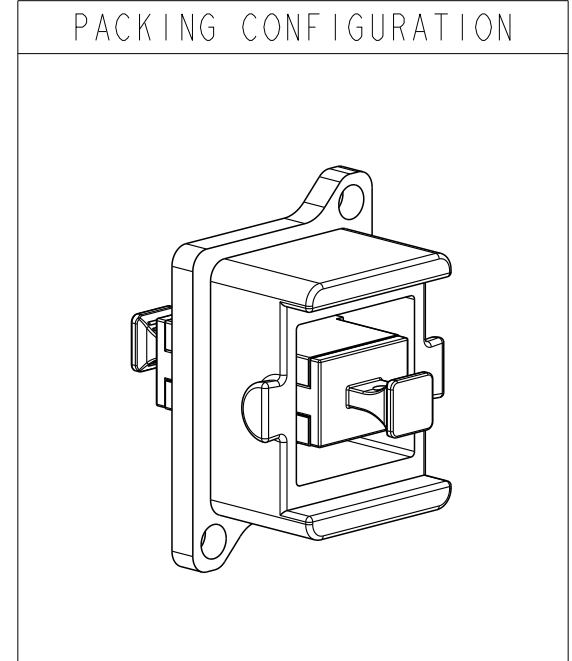

PANEL CUTOUT DIMENSIONS

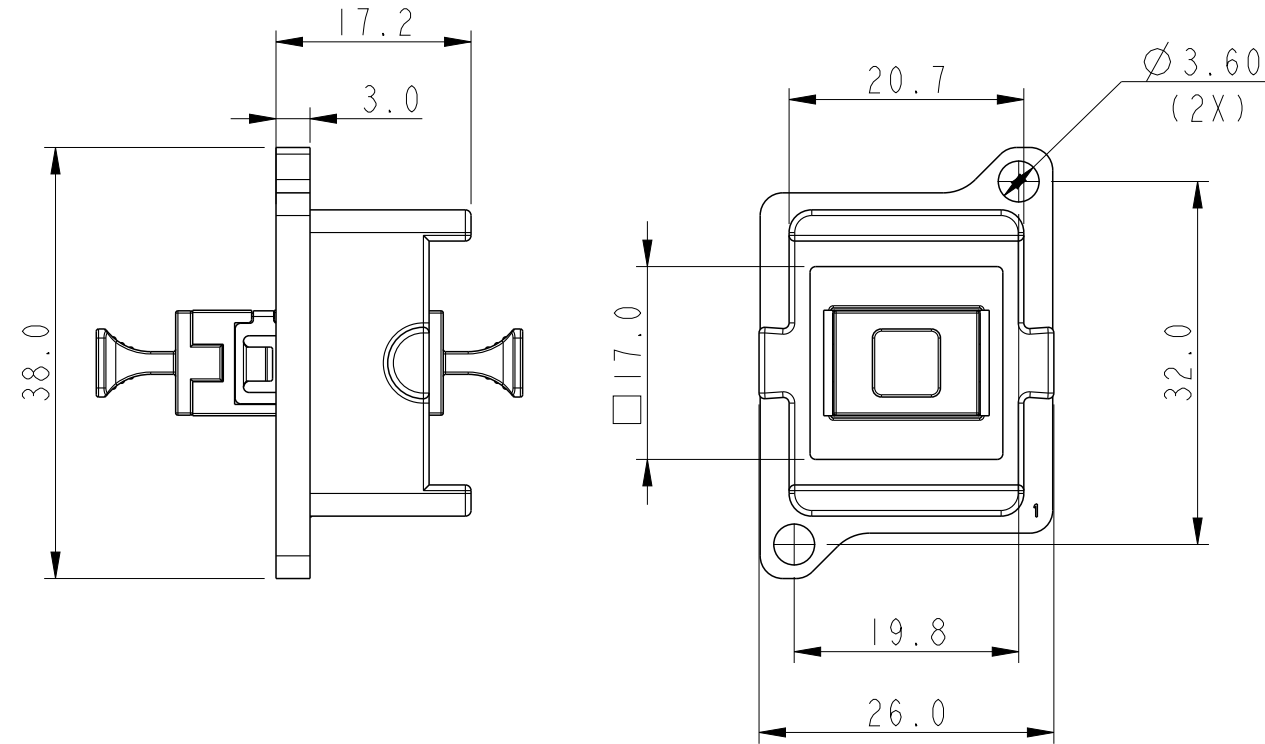
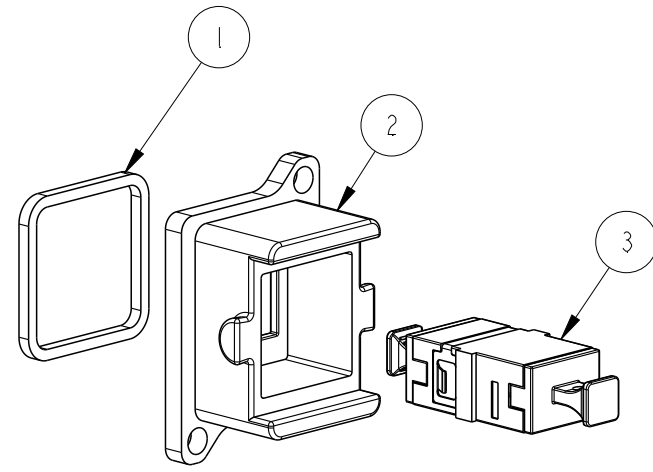
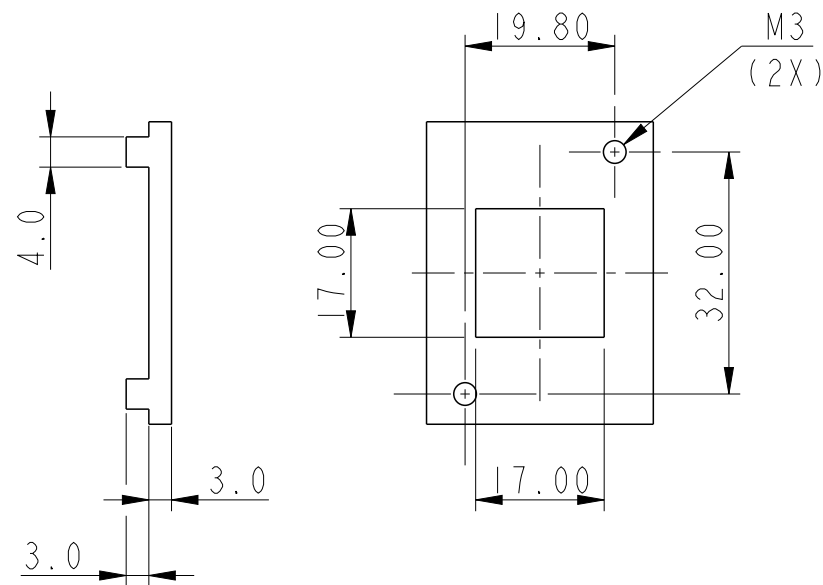

SL NO.	COMPONENT	MATERIAL	QTY	COLOUR
1	SEALING GASKET	SILICONE	1	BLACK
2	BULKHEAD FOR MPO ADAPTER	IXEF	1	BLACK
3	MPO ADAPTER	PEI+PP+STAINLESS STEEL	1	BLACK

NOTES:

1. TO BE USED WITH OCTIS PLUG KIT FOR MPO ADAPTER VERSION,PITCH 26 MM- PART NUMBER 10145416-XXXLF
2. CASTED MOUNTING PANEL SHOULD HAVE ON ITS REAR SIDE INTEGRAL RECTANGULAR REINFORCED RIBS OF 3MM THICKNESS AND 4MM WIDTH ALONG THE MOUNTING SCREW PLANE AT THE TOP AND BOTTOM TO ACCOMODATE THE BLIND INTERNAL SCREW THREAD

spec ref				dr	B T Varghese	2018/01/12	projection 	MM 	size	A3	scale	1:1					
tolerance std				eng	B T Varghese	2018/01/18			ecn no	-							
ISO 406 ISO 1101				chr	-	-											
TOLERANCES UNLESS OTHERWISE SPECIFIED				appr	K-Paul Biju	2018/01/18	product family			-	rel level		Released				
				surface 	linear	0.X	±0.3	Amphenol FCi	title	MPO ADAPTER AND BULKHEAD ASSEMBLY FOR OCTIS MPO ADAPTER PLUG KIT,PITCH 26 MM			dwg no	10145295		rev	A
						0.XX	±0.10										
0.XXX	±0.05																
ISO 1302				angular	0°	±2°	cat. no.	-	Product - Customer Drw			sheet 1 of 1					