

NOTE:

1. Material:
 - HOUSING: HIGH TEMPERATURE THERMOPLASTIC, UL 94 V-0 FLAME RETARDANT.
 - TERMINAL: HIGH CONDUCTIVITY COPPER ALLOY.
 - PLATING SPEC AS BELOW:
 - Ni 50u" UNDER PLATED.
 - Au 30u" OVER CONTACT AREA.(ONE SIDE)
 - Matte Tin 120u" OVER SOLDERING AREA.)
2. PACKING SPEC. GS-14-937.
3. PRODUCT SPEC. GS-12-338.
4. PART NUMBER SCHEME:(EX. 10046971-038 LF)

LEAD FREE

5. PART NUMBER 10046971-038LF MEETS EUROPEAN UNION DIRECTIVE AND OTHER COUNTRY REGULATIONS AS DESCRIBED IN GS-22-008. THE HOUSING WILL WITHSTAND EXPOSURE TO 260°C PEAK TEMPERATURE FOR 10 SECONDS IN A WAVE SOLDER APPLICATION WITH A CIRCUIT BOARD.

REV	ECN NUMBER	REV'D BY	DATE
A	-	HZ	2012-01-02

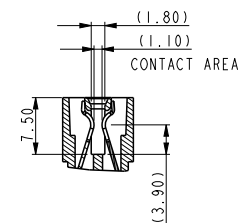
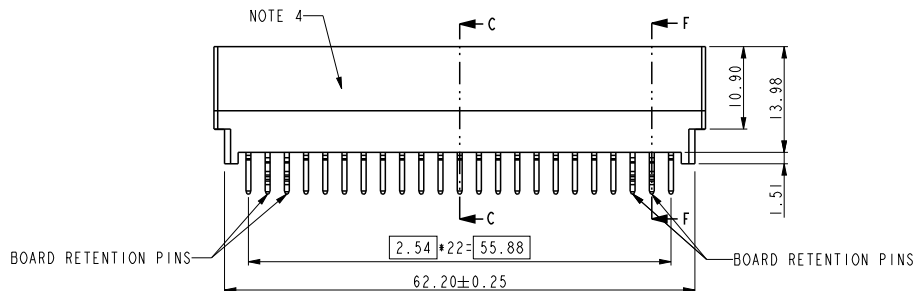

SECTION C-C



BOARD RETENTION PINS
SECTION F-F

spec ref	*	dr	Wei-Long Zhang	2011/12/07	projection	mm	size	A4	scale	1.000	
tolerance std	TOLERANCES UNLESS OTHERWISE SPECIFIED	eng	Wei-Long Zhang	2012/01/03			←→	ecn no	-	rel level	Released
		chr	Eleven Hu	2012/01/04							
surface	✓	appr	Pei-Ming Zheng	2012/01/04	product family	PEC	rev	10046971-038	A		
	linear										
	angular										
		www.fci.com		cat. no.	*	Product - Customer Drw		sheet 1 of 2			



Copyright FCI.



RECOMMENDED PC BOARD LAYOUT
AND THE THICKNESS IS 3.18mm



DETAIL A
SCALE 5.000



Copyright FCI.

spec ref	*	dr	Wei-Long Zhang	2011/12/07	projection 	mm ←→	size	A4	scale	1.000		
tolerance std	TOLERANCES UNLESS OTHERWISE SPECIFIED	eng	Wei-Long Zhang	2012/01/03			product family	PEC	ecn no	-	rel level	Released
		chr	Eleven Hu	2012/01/04				app	Pei-Ming Zheng	2012/01/04		
surface	✓	linear	0.X	± 0.50	 www.fci.com	POWER EDGE CONNECTOR OF VERTICAL TYPE (23PX2)	surface linear 0.XX ± 0.25 0.XXX ± 0.13 angular 0° ± 2°	title www.fci.com	cat. no.	*	Product - Customer Drw	sheet 2 of 2
title POWER EDGE CONNECTOR OF VERTICAL TYPE (23PX2)	dwg no 10046971-038	rev A										
product family PEC	rel level Released											

PrdE File - REV C - 2009-06-09