

NOTE:

- 1. Material:
 - HOUSING: HIGH TEMPERATURE THERMOPLASTIC, UL 94 V-0 FLAME RETARDANT.
 - TERMINAL: HIGH CONDUCTIVITY COPPER ALLOY. PLATING SPEC AS BELOW:
 - Ni 50u" UNDER PLATED.
 - Au 30u" OVER CONTACT AREA.(ONE SIDE)
 - Matte Tin 120u" OVER SOLDERING AREA.)
- 2. PACKING SPEC. GS-14-937.
- 3. PRODUCT SPEC. GS-12-338.
- 4. PART NUMBER SCHEME:(EX. 10046971-038 LF)

LEAD FREE

- 5. PART NUMBER 10046971-038LF MEETS EUROPEAN UNION DIRECTIVE AND OTHER COUNTRY REGULATIONS AS DESCRIBED IN GS-22-008. THE HOUSING WILL WITHSTAND EXPOSURE TO 260°C PEAK TEMPERATURE FOR 10 SECONDS IN A WAVE SOLDER APPLICATION WITH A CIRCUIT BOARD.

REV	ECN NUMBER	REV'D BY	DATE
A	-	HZ	2012-01-02

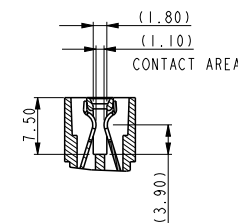
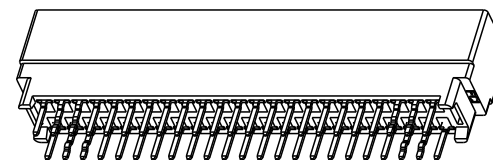

SECTION C-C



BOARD RETENTION PINS
SECTION F-F



Copyright FCI.

spec ref	*	dr	Wei-Long Zhang	2011/12/07	projection	mm	size	A4	scale	1.000							
tolerance std	TOLERANCES UNLESS OTHERWISE SPECIFIED	eng	Wei-Long Zhang	2012/01/03				ecn no	-	rel level	Released						
		chr	Eleven Hu	2012/01/04													
		appr	Pei-Ming Zheng	2012/01/04	product family	PEC											
surface	<table border="1"> <tr> <td>linear</td> <td>0.X</td> <td>± 0.50</td> </tr> <tr> <td></td> <td>0.XX</td> <td>± 0.25</td> </tr> <tr> <td></td> <td>0.XXX</td> <td>± 0.13</td> </tr> <tr> <td>angular</td> <td>0°</td> <td>± 2°</td> </tr> </table>	linear	0.X	± 0.50		0.XX	± 0.25		0.XXX	± 0.13	angular	0°	± 2°		title POWER EDGE CONNECTOR OF VERTICAL TYPE (23PX2)	dwg no 10046971-038	rev A
linear	0.X	± 0.50															
	0.XX	± 0.25															
	0.XXX	± 0.13															
angular	0°	± 2°															
www.fci.com			cat. no.	*	Product - Customer Drw			sheet 1 of 2									



RECOMMENDED PC BOARD LAYOUT
AND THE THICKNESS IS 3.18mm



Copyright FCI.

spec ref	*	dr	Wei-Long Zhang	2011/12/07	projection 	mm ←→	size	A4	scale	1.000		
tolerance std	TOLERANCES UNLESS OTHERWISE SPECIFIED	eng	Wei-Long Zhang	2012/01/03			product family	PEC	ecn no	-	rel level	Released
		chr	Eleven Hu	2012/01/04				product family	PEC	rel level		Released
surface	✓	appr	Pei-Ming Zheng	2012/01/04	title		POWER EDGE CONNECTOR OF VERTICAL TYPE (23PX2)		cat. no.	*		
	linear	0.X	± 0.50		www.fci.com	title	POWER EDGE CONNECTOR OF VERTICAL TYPE (23PX2)	cat. no.	*	Product - Customer Drw	sheet 2 of 2	
		0.XX	± 0.25									
		0.XXX	± 0.13									
	angular	0°	± 2°									
surface		linear	0.X	± 0.50		www.fci.com	title	POWER EDGE CONNECTOR OF VERTICAL TYPE (23PX2)	cat. no.	*	Product - Customer Drw	sheet 2 of 2
		0.XX	± 0.25									
		0.XXX	± 0.13									
	angular	0°	± 2°									
surface		linear	0.X	± 0.50		www.fci.com	title	POWER EDGE CONNECTOR OF VERTICAL TYPE (23PX2)	cat. no.	*	Product - Customer Drw	sheet 2 of 2
		0.XX	± 0.25									
		0.XXX	± 0.13									
	angular	0°	± 2°									
surface		linear	0.X	± 0.50		www.fci.com	title	POWER EDGE CONNECTOR OF VERTICAL TYPE (23PX2)	cat. no.	*	Product - Customer Drw	sheet 2 of 2
		0.XX	± 0.25									
		0.XXX	± 0.13									
	angular	0°	± 2°									
surface		linear	0.X	± 0.50		www.fci.com	title	POWER EDGE CONNECTOR OF VERTICAL TYPE (23PX2)	cat. no.	*	Product - Customer Drw	sheet 2 of 2
		0.XX	± 0.25									
		0.XXX	± 0.13									
	angular	0°	± 2°									
surface		linear	0.X	± 0.50		www.fci.com	title	POWER EDGE CONNECTOR OF VERTICAL TYPE (23PX2)	cat. no.	*	Product - Customer Drw	sheet 2 of 2
		0.XX	± 0.25									
		0.XXX	± 0.13									
	angular	0°	± 2°									

PrdE File - REV C - 2009-06-09