

NOTE:

1. Material:
 - HOUSING: HIGH TEMPERATURE THERMOPLASTIC, UL 94 V-0 FLAME RETARDANT.
 - TERMINAL: HIGH CONDUCTIVITY COPPER ALLOY. PLATING SPEC AS BELOW:
 - Ni 50u" UNDER PLATED.
 - Au 30u" OVER CONTACT AREA.(ONE SIDE)
 - Matte Tin 120u" OVER SOLDERING AREA.)
2. PACKING SPEC. GS-14-937.
3. PRODUCT SPEC. GS-12-338.
4. PART NUMBER SCHEME:(EX. 10046971-038 LF)

LEAD FREE

5. PART NUMBER 10046971-038LF MEETS EUROPEAN UNION DIRECTIVE AND OTHER COUNTRY REGULATIONS AS DESCRIBED IN GS-22-008. THE HOUSING WILL WITHSTAND EXPOSURE TO 260°C PEAK TEMPERATURE FOR 10 SECONDS IN A WAVE SOLDER APPLICATION WITH A CIRCUIT BOARD.

| REV | ECN NUMBER | REV'D BY | DATE |
|-----|------------|----------|------------|
| A | - | HZ | 2012-01-02 |
| | | | |
| | | | |

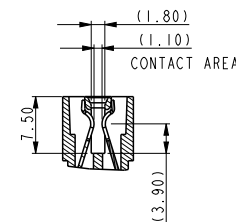
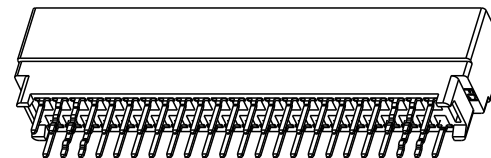

SECTION C-C



BOARD RETENTION PINS
SECTION F-F



Copyright FCI.

| | | | | | | | | | | | |
|---------------|---------------------------------------|------|----------------|------------|----------------|-----|----------|--------------|------------------------|--------------|----------|
| spec ref | * | dr | Wei-Long Zhang | 2011/12/07 | projection | mm | size | A4 | scale | 1.000 | |
| tolerance std | TOLERANCES UNLESS OTHERWISE SPECIFIED | eng | Wei-Long Zhang | 2012/01/03 | | | ←→ | ecn no | - | rel level | Released |
| | | chr | Eleven Hu | 2012/01/04 | | | | | | | |
| surface | ✓ | appr | Pei-Ming Zheng | 2012/01/04 | product family | PEC | rev | 10046971-038 | A | | |
| | linear | | 0.X | ± 0.50 | www.fci.com | | cat. no. | * | Product - Customer Drw | sheet 1 of 2 | |
| | | | 0.XX | ± 0.25 | | | | | | | |
| | | | 0.XXX | ± 0.13 | | | | | | | |
| | angular | | 0° | ± 2° | | | | | | | |

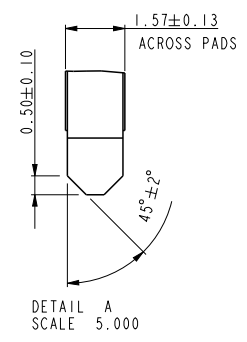

RECOMMENDED PC BOARD LAYOUT
AND THE THICKNESS IS 3.18mm

| | | | | | | | | | | |
|---------------|---------------------------------------|--------|----------------|------------|--|------------------------|--------------|--------------|-------|-------|
| spec ref | * | dr | Wei-Long Zhang | 2011/12/07 | projection | mm | size | A4 | scale | 1.000 |
| tolerance std | TOLERANCES UNLESS OTHERWISE SPECIFIED | eng | Wei-Long Zhang | 2012/01/03 | | | ecn no | - | | |
| | | chr | Eleven Hu | 2012/01/04 | | | | | | |
| surface | ✓ | appr | Pei-Ming Zheng | 2012/01/04 | product family | PEC | rel level | Released | | |
| linear | 0.X | ± 0.50 | | title | POWER EDGE CONNECTOR OF VERTICAL TYPE (23PX2) | | dwg no | 10046971-038 | | rev |
| | 0.XX | ± 0.25 | | | | | | | | |
| 0.XXX | ± 0.13 | | | | | | | | | |
| angular | 0° | ± 2° | www.fci.com | cat. no. | * | Product - Customer Drw | sheet 2 of 2 | | | |

PrdE File - REV C - 2009-06-09



Copyright FCI.