



## Heyco® Nylon Conduit Fittings

For Flexible, Corrugated Nylon Conduit/Tubing  
Straight-Thru, PG Hubs

FITS CONDUIT SIZE	PART NO.  Black	DESCRIPTION	THREAD SIZE	PART DIMENSIONS BODY AND SEALING UNIT							
				A Thread Length		B Wrenching Flat Size		C Max. O.A. Length		D Clearance Hole	
				in.	mm.	in.	mm.	in.	mm.	in.	mm.
10 mm	<b>F8540</b>	FPA 10-PG7*	PG 7	.354	9,0	.718	18,4	1.299	33,0	.492	12,5
13 mm	<b>F8542</b>	FPA 13-PG9*	PG 9	.433	11,0	.890	22,6	1.457	37,0	.599	15,2
16 mm	<b>F8548</b>	FPA 16-PG13	PG 13	.394	10,0	1.120	28,4	1.378	35,0	.804	20,4
21 mm	<b>F8552</b>	FPA 21-PG16	PG 16	.433	11,0	1.185	30,1	1.614	41,0	.886	22,5
34 mm	<b>F8560</b>	FPA 34-PG29	PG 29	.472	12,0	1.921	48,8	1.929	49,0	1.470	37,3

Standard color black. Consult Heyco for other colors.

\*Not UL recognized.



- Unitary design and assembled shipment allows fast fit.
- No threading of the conduit/tubing is required to install.
- For use with Heyco Nylon Corrugated Conduit/Tubing. See page 2-21.
- Suitable for use with both fine and/or coarse pitch conduit/tubing.
- Protection class IP 66 per EN 60529 including high pressure water jet from any angle.
- IP 68 rated fittings available - consult Heyco.
- Suitable for use by original equipment manufacturers.
- All nylon construction resists salt water, weak acids, gasoline, alcohol, oil, grease, and common solvents. (This feature is not assessed by UL certification or testing.)
- Vibration and tamper resistant, but easily removed with a screwdriver.
- **Locknuts not included.** See page 2-14 for Nylon Locknuts.

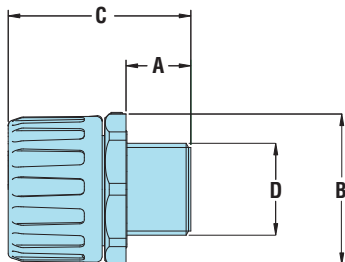

### Assembly instructions:



### Removal instructions:

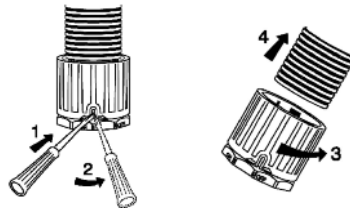

Material	Nylon 6/6
Certifications	Recognized under Underwriters' Laboratories File E229161 Approved as per EN50086
Flammability Rating	94V-2 and Low Fire Hazard Including Low Smoke, Low Toxicity as well as Halogen, Sulphur, and Phosphorus Free
Temperature Range	-58°F (-50°C) to 275°F (135°C)
IP Rating	IP 66 standard as per EN60529 IP 66 & 67 & 68 available—consult factory and specify FPAX fittings

Quick  
Specs