

REV. A	SHEET 1 OF 1	DOCUMENT NO. 10-565991-61
REVISIONS		
LTR	DESCRIPTION	DATE
A	INITIAL RELEASE	

KIT PART NUMBER	CONNECTOR PART NUMBER	KIT TYPE	PCB PART NUMBER	CONTACT QTY.	LJT REF NUMBER	CAP
10-565991-61N	91-416468-35P	II	10-407552-445	100	LJT07RE-23-35P (023)	10-70500-022
10-565991-61A	91-416468-35E				LJT07RE-23-35PA(023)	
10-565991-61B	91-416468-35R				LJT07RE-23-35PB(023)	
10-565991-61C	91-416468-35W				LJT07RE-23-35PC(023)	
10-565991-61D	91-416468-35Y				LJT07RE-23-35PD(023)	

**FOR UNIT ILLUSTRATION AND DIMENSIONAL DATA
SEE 91-416460/469**

ALTERNATE SHELL ROTATION
SEE NOTE 4

CONNECTOR LESS STAMPING
SEE NOTE 4

SEE NOTE 1

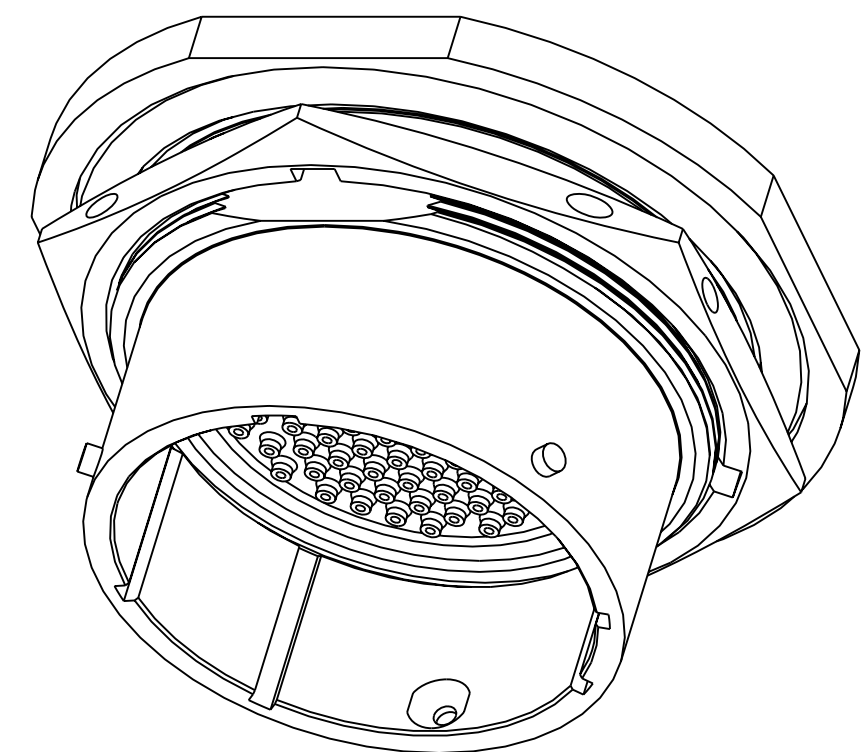

SCALE 2

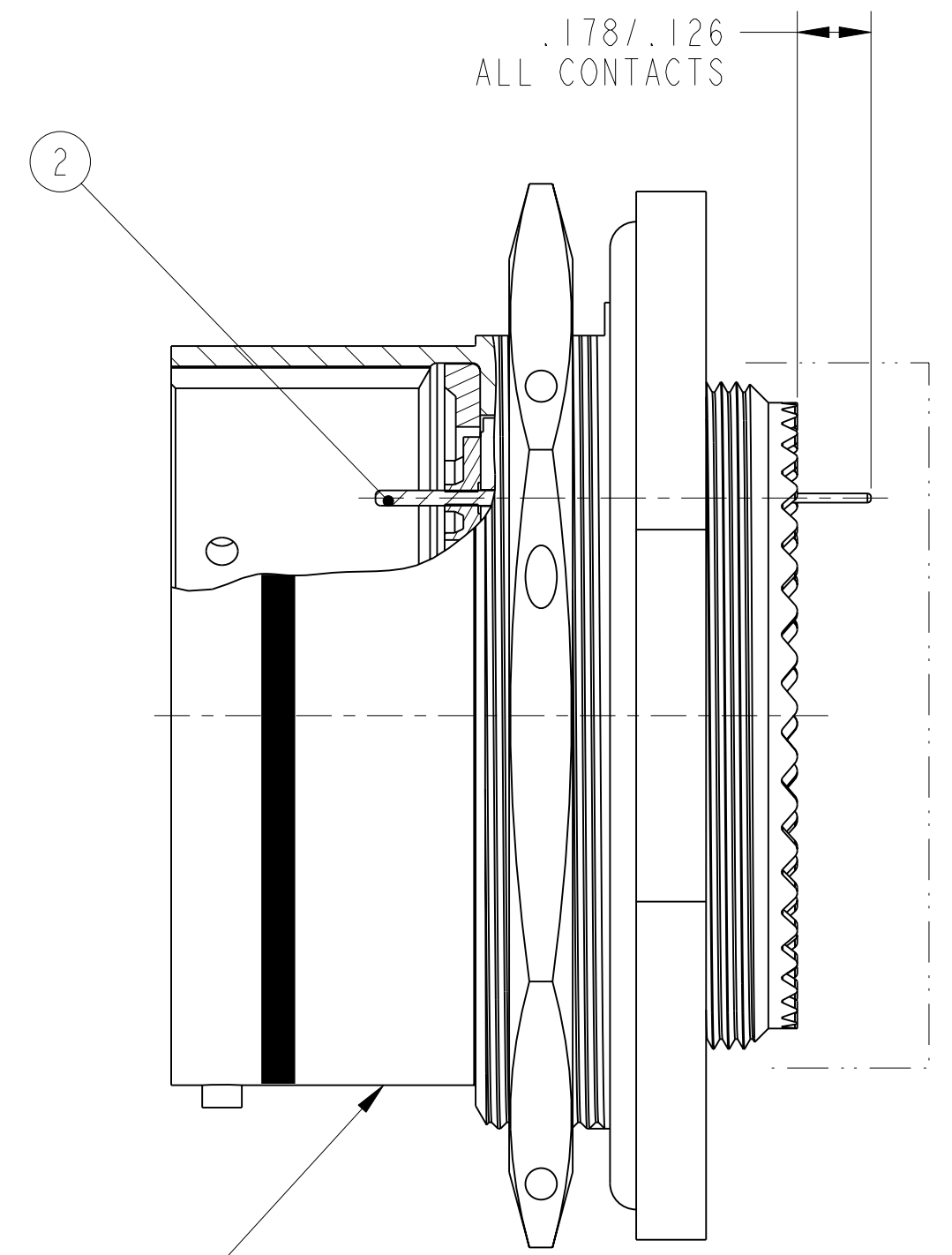
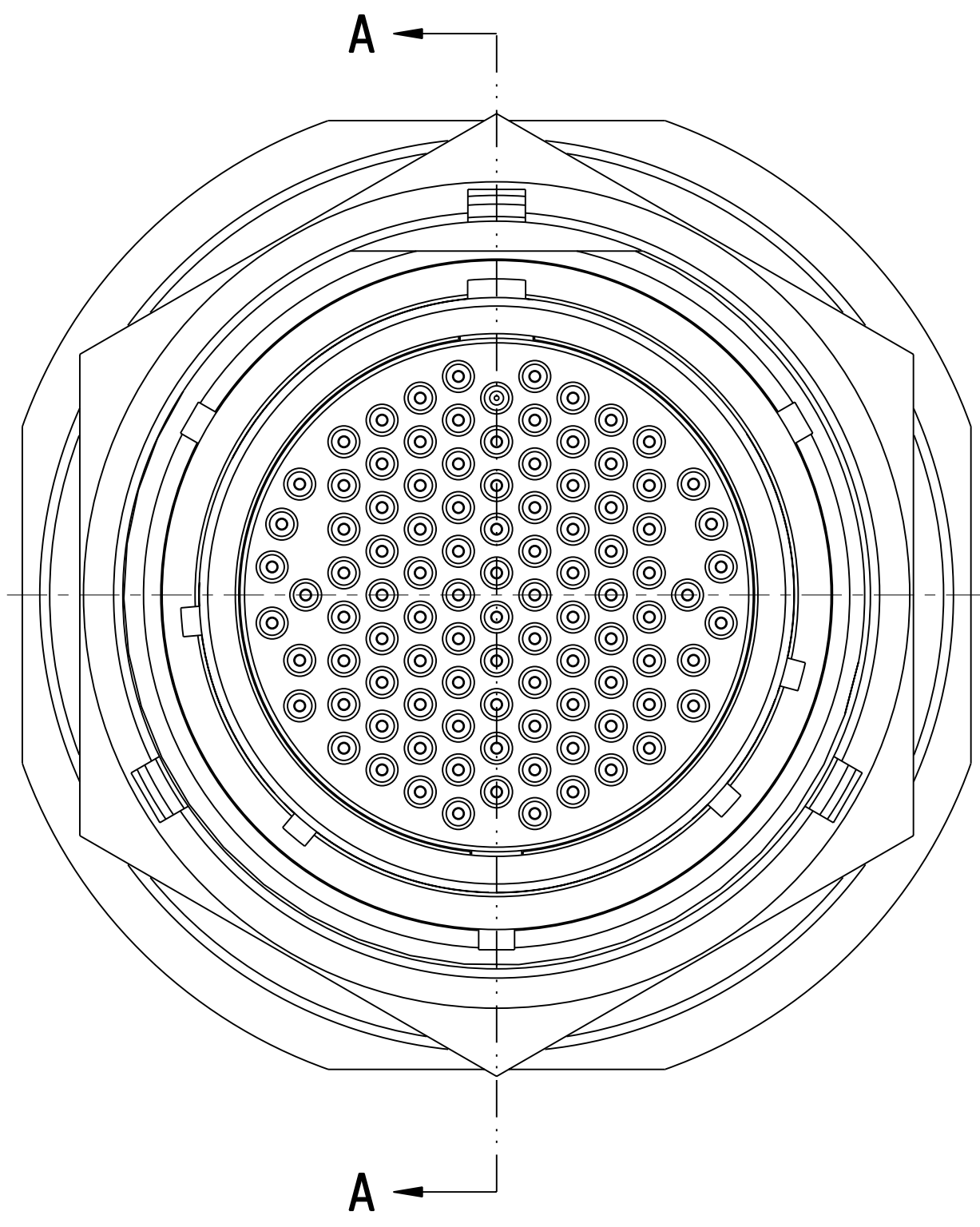

SECTION A-A

5. AFTER CONTACTS HAVE BEEN INSTALLED, ASSEMBLE PROTECTION CAP TO REAR OF CONNECTOR. TO INSURE CAP LOCATION APPLY TAPE IF NEEDED.
4. STAMP "AMPHENOL", PART NUMBER, DATE CODE (9-3895), AND LOT NUMBER PER 9-5788
EXAMPLE:
AMPHENOL 10-565991-61B 0637 001000
3. PROCESS SPEC.:
9-3895, 9-5788
2. PACKAGE PER PRODUCTION PROCESS SHEET.
1. KIT TYPE I CONTACTS ARE SHIPPED UNASSEMBLED.
KIT TYPE II CONTACTS ARE SHIPPED ASSEMBLED IN CONNECTOR.

NOTES:

THE USE OF THIS DOCUMENT IS UNLIMITED. HOWEVER, DOCUMENTS REFERENCED HEREON MAY CONTAIN LIMITED RIGHTS DATA.

N/A	PRO/ENGINEER INFORMATION
N/A	Pro/e Model Used: 10-565991-61.ASSEM
N/A	Drawing Name: 10-565991-61
N/A	NEXT ASSEMBLY

UNLESS OTHERWISE SPECIFIED

SPECIFICATIONS

MATERIAL SPEC.
N/A

PROCESS SPEC.
SEE NOTE 3

LINEAR DIMENSIONS ARE IN INCHES
TOLERANCES:
.XXXX = ±.0005 ANGLES= ±2°
.XXX = ±.010
.XX = ±.03
.X = ±.1

DIM. & TOL. PER ASME Y14.5M;
DRM PER MIL-DTL-31000;
OTHER Amphenol Sds. PER 9-3800

LEGENDS:
=FLAG NOTE CALL OUT REFERENCE ONLY

2	SEE COLUMN	CONTACT	
1	SEE COLUMN	CONNECTOR	
POS	QTY	PART NUMBER	DESCRIPTION
			NOTE
PARTS LIST			
AMPHENOL CORPORATION 40-60 DELAWARE AVENUE SIDNEY, N.Y. 13838			
CONNECTOR KIT, TYPE LJT-RE()FW STAMPING, LJT07RE-23-35P()			
APPROVALS	DATE		
PREPARED BY D. ALGER	4-OCT-06		
ENGINEER IN CHARGE D. FREAR			
DESIGN MANAGER E. SHEPLER			
DESIGN ACTIVITY GROUP MILAERO			
THIRD ANGLE PROJECTION			
SIZE C	CAGE CODE 77820	DOCUMENT NO. 10-565991-61	REV. A
SCALE: NONE		REF: 91-416460/469	SHEET 1 OF 1

DOCUMENT NO. 10-565991-61 SHEET 1 OF 1 REV. A

DOCUMENT NO. 10-565991-61 SHEET 1 OF 1 REV. A