

# High Voltage Fuses



Low Current  
High Voltage 50A Fuses

## Low Current High Voltage 50A Fuse

The LC HEV fuse is designed for protection of high-voltage accessory circuits in electric and hybrid electric vehicles.

### Specifications

Voltage Rating (50A):	275 VAC
Interrupting Rating (50A):	10,000A @ 275 VAC
Operating Temperature Range:	-40°C to +125°C

### Ordering Information

Part Number	Termination	Package Size
0HEVxxx.ZXC2	Cartridge	240
0HEVxxx.ZXISO2	Bolt Down (ISO)	240
0HEVxxx.ZXP2Y	Blade	240
0HEVxxx.ZXPCB2	PCB Mount	240
0HEVxxx.ZXPCBL2	PCB Mount (Long)	240
0HEVxxx.ZXBD2	Bolt Down (Axial)	240

### Time-Current Characteristics

% of Rating	Opening Time Min / Max (s)
100	100 hrs / -
110	4 hrs / -
135	-
150	-
200	0.5 / 100
300	0.1 / 15
500	0.05 / 1

### Ratings

Part Number	Current Rating (A)	Voltage Rating (VAC)	Color Code	Typical Voltage Drop at 70% I <sub>R</sub> (mV)	Maximum Voltage Drop Spec at 100% I <sub>R</sub> (mV)	Typical Cold Resistance (mΩ)	Minimum Melting I <sub>t</sub> (A <sup>2</sup> s)
0HEV050.XXX	50	275		57	200	1.2	1495

### Time-Current Characteristic Curves

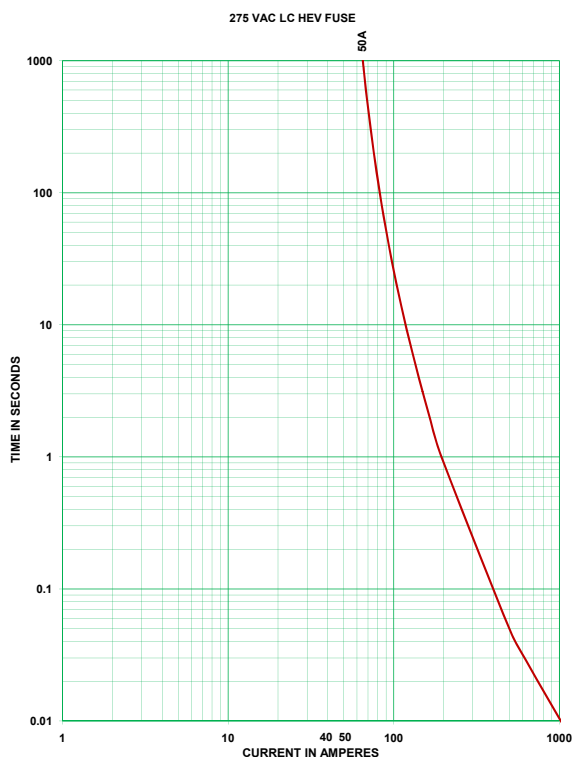

### Temperature Derating Curve

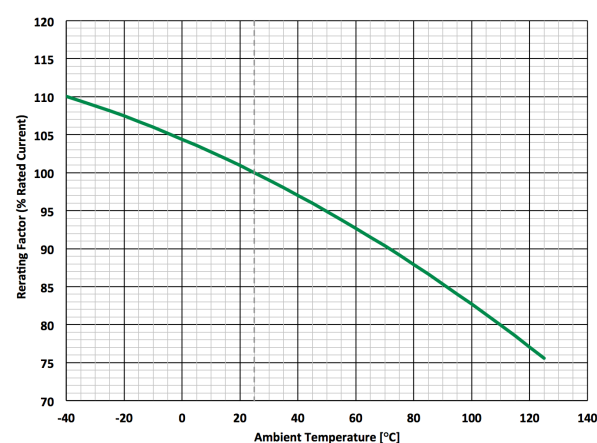

## Low Current High Voltage 50A Fuse

### Dimensions

Dimensions in mm

ZXC2 Cartridge

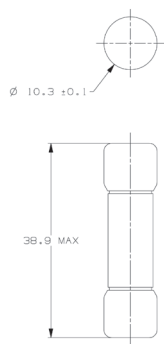

ZXIS02 Bolt Down (ISO)

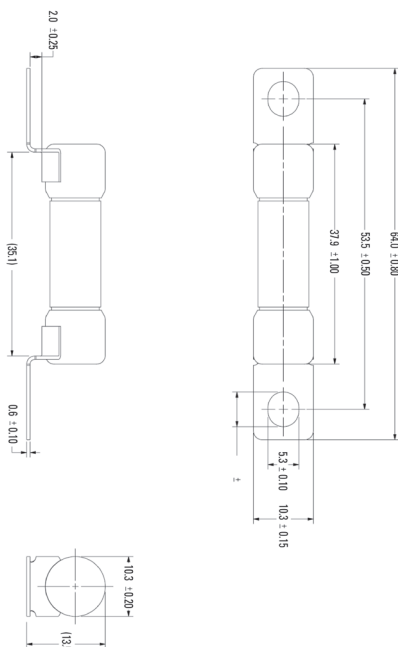

ZXP2Y Blade

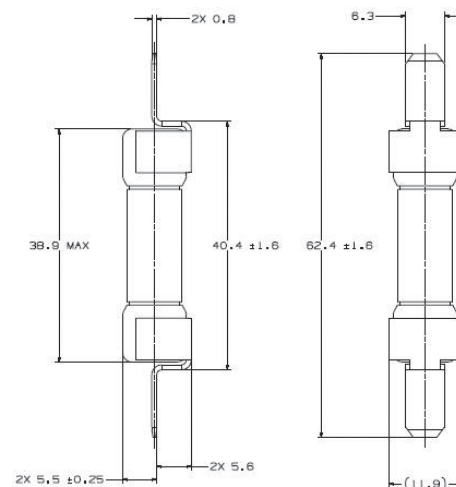

ZXPCB2 PCB Mount

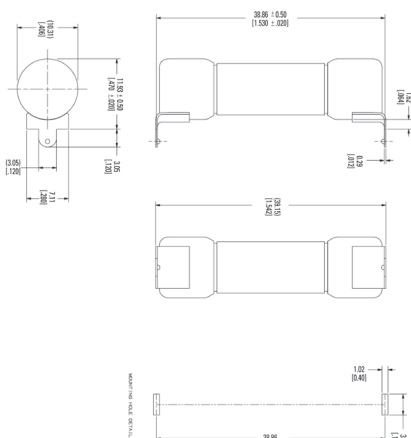

ZXPCBL2 PCB Mount (Long)

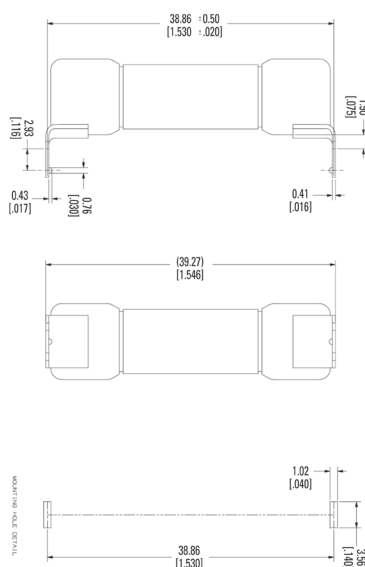

ZXBD2 Bolt Down (Axial)

