

TABLE 1

PART NO.	APPLICABLE TO CF HEADER PART NO.	DIM. A
10053869-0050LF	CF TYPE I Header Normal & Reverse	2.95
10053869-0150LF	CF TYPE II Header Normal	4.40

- NOTES :
1. MATERIAL :
COVER : STAINLESS STEEL.
ARM : STAINLESS STEEL.
PUSH ROD : HIGH TEMPERATURE THERMOPLASTIC, UL94V-0, BLACK RIVET : COPPER ALLOY.
 2. PRODUCT SPEC: GS-12-240.
 3. PACKAGING SPEC: GS-14-981.

4.PART NO DESCRIPTION:
10053869-0 X 5 0 LF

LEAD FREE VERSION (RoHS Compatible).

SEE THE TABLE 1

5. THIS PRODUCT (10053869-0X50LF) MEETS THE EUROPEAN UNION DERECTIVE AS DESCRIBED IN GS-22-008.
6. THE HOUSING WILL WITHSTAND EXPOSURE TO 260°C PEAK TEMPERATURE FOR 10 SECONDS IN A CONNECTION, IR OR VAPOR PHASE REFLOW OVEN.
7. THE PRODUCT WHERE THE PART NUMBER ENDS IN 'LF' MEET THE CRITERIA SHOWN IN THE NOTES 5 AND 6.

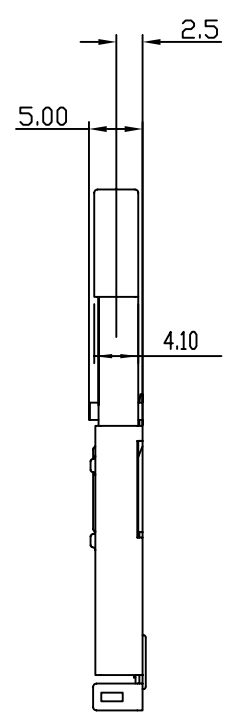

mat'l. code		tolerances unless otherwise specified		CUSTOMER		FCI	
ltr	ecn no	dr	date	projection	copy	title	www.fciconnect.com
A	T05-02581	A.C.	11/21/05	XXX ±.10	MM	CF CARD EJECTOR-RIGHT PUSH ROD, WITH GROUND	
				0° ±2°			
				dr ALLEN CHANG 2/22/05			
				engr ALLEN CHANG 2/22/05			
				chr STERLING LIN 2/22/05	scale		
				appl H.C LIU 2/22/05	N/A		
sheet	revision	A				A4	
index	sheet	1				10053869	
						1	
						1 of 1	

ACAD

code code
22526