

3.5mm Mono

161-1640-EX

KOBI CONN

3.5mm Mono

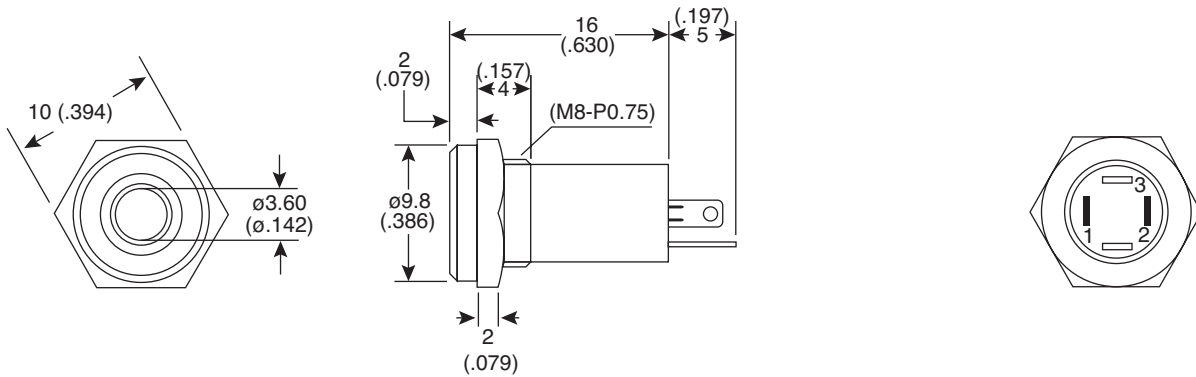
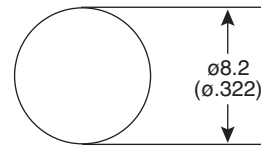
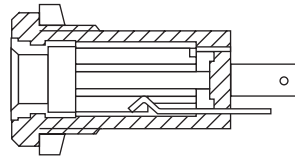
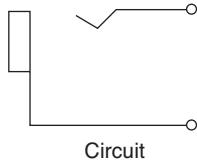

DIMENSIONS mm (in.)
(except where noted)

SPECIFICATIONS

Dielectric strength:	500V AC for one minute
Contact resistance:	50mΩ max
Insulation resistance:	100MΩ min. at 500V DC
Body material:	Polyamide66 (PA66 Nylon)
Mating cycles life min:	5,000
Insertion force:	30 - 30N
Extraction force:	30 - -30N
RoHS Compliant by Exemption	

Mating Plugs

17PP047-EX, 171-3200-EX, 171-3201-EX, 171-3302-EX

Date Last Revised: 1-30-15

Available from Mouser Electronics
1-800-346-6873 / www.mouser.com

KC-300852

Specifications are subject to change without notice. No liability or warranty implied by this information. Environmental compliance based on producer documentation.

161-1640-EX