

6

5

4

3

2

1

E

E

D

D

C

C

B

B

A

A

LENGTH "L" REF.

8.0 ± 2.0

7.16 REF.

LENGTH "A"

3.00 REF.

2.25 REF.

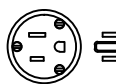

NEMA 5-15 SUPER-SAFEWAY PART NO. 1447 COLOR: YELLOW

#12-3 STJW, 300V CORD COLOR: YELLOW



LED INDICATOR CONFIRMS POWER AND FAULT STATUS

LINE

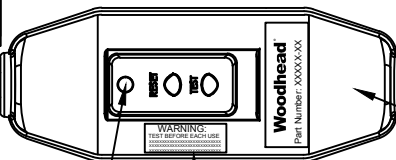

AUTOMATIC OR MANUAL (SAFE START) RESET TYPES

LOAD

HIGH STRENGTH POLYCARBONATE HOUSING COLOR: BLACK

NYLON CLAMP

RUBBER HUSK



NEMA 5-15 SUPER-SAFEWAY PART NO. 1547 COLOR YELLOW

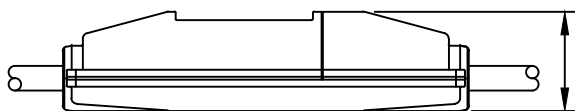

1.75 REF.

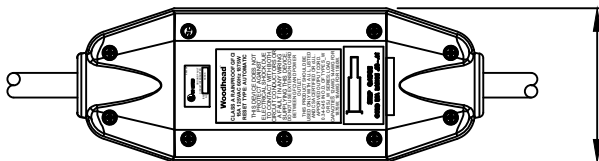

2.74 REF.

TECHNICAL:

LISTED:
RATED SUPPLY VOLTAGE:
RATED CURRENT:
RESET TYPE:
OPERATING FREQUENCY:
TYPE:
GROUND TRIP CURRENT:
OVERLOAD CURRENT:
INSULATION VOLTAGE:
ENDURANCE OPERATIONS:

UL AND cUL
120 VAC
UP TO 15 AMPS OR CABLE RATING
AUTOMATIC OR MANUAL
60 Hz
CLASS A
4-6 mA
90 AMP 125 VAC
1,500 VRMS - 1 MINUTE
3000 OPERATIONS

MATERIAL NO.	ENGINEERING NO.	LENGTH "L"	LENGTH "A"	POWER-UP
1301530043	15051-1A	2 FT 7 IN	1 FT ± 1 IN	AUTO
1301530052	15051-6A	7 FT 7 IN	6 FT ± 2 IN	AUTO
1301530046	15051-25A	26 FT 7 IN	25 FT ± 2 IN	AUTO
1301530049	15051-50A	51 FT 7 IN	50 FT ± 4 IN	AUTO
1301530044	15051-1M	2 FT 7 IN	1 FT ± 1 IN	MANUAL
1301530053	15051-6M	7 FT 7 IN	6 FT ± 2 IN	MANUAL
1301530047	15051-25M	26 FT 7 IN	25 FT ± 2 IN	MANUAL
1301530050	15051-50M	51 FT 7 IN	50 FT ± 4 IN	MANUAL

INITIAL RELEASE EC NO: IPCG2013-1078 DRWN: HRUIZ01 2013/02/06 CHKD: HKNEELAN 2014/07/22 APPR: JFMURPHY 2015/04/20	DESCRIPTION REV	QUALITY SYMBOLS ▽=0 ▽C=0	GENERAL TOLERANCES (UNLESS SPECIFIED)		DIMENSION STYLE INCH		SCALE NTS	DESIGN UNITS INCH	THIRD ANGLE PROJECTION		
		4 PLACES ±--- ±--- 3 PLACES ±--- ±.005 2 PLACES ±0.13 ±0.10 1 PLACE ±0.25 ±0.020	mm INCH	DRAWN BY HRUIZ01	DATE 2013/02/06	TITLE 120V 15A INLINE GFCI W/ 1447 & 1547 NEMA 5-15					
		ANGULAR ±1/2°		CHECKED BY HKNEELAN	DATE 2014/07/22	MOLEX INCORPORATED					
		DRAFT WHERE APPLICABLE MUST REMAIN WITHIN DIMENSIONS		APPROVED BY JFMURPHY	DATE 2015/04/20	MATERIAL NO. SEE TABLE	DOCUMENT NO. SD-130153-015	SHEET NO. 1 OF 1			
THIS DRAWING CONTAINS INFORMATION THAT IS PROPRIETARY TO MOLEX INCORPORATED AND SHOULD NOT BE USED WITHOUT WRITTEN PERMISSION											

6

5

4

3

2

1