

2004KL (50[□] X 10^L)



EMINEBEA.COM

General Specifications

Motor Protection:

Auto Restart/Polarity Protection

Insulation Resistance: 10M Ω or over with a DC500V Megger

Dielectric Withstand Voltage: AC 700V 1s

Allowable Ambient Temperature Range:

-10°C ~ +70°C (Operating)

-40°C ~ +70°C (Storage)

(non-condensing environment)

Expected Life

Failure Rate: 10%

25°C 60,000 Hours (B00)

25°C 50,000 Hours (M00)

Outline

Units: $\frac{\text{inch}}{\text{(mm)}}$

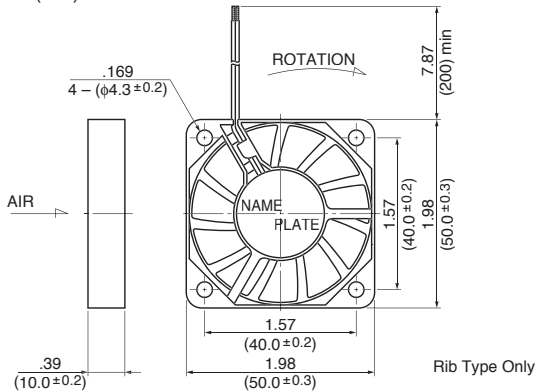

Characteristic Curves

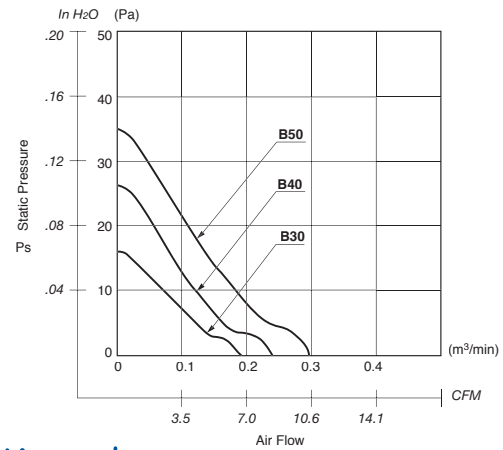

Panel Cut-outs

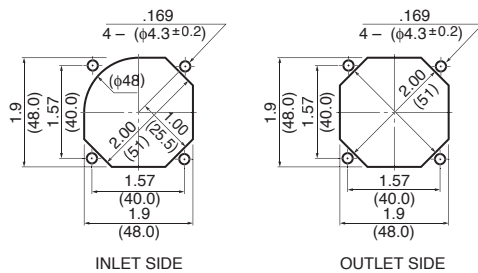

Material

Casing : Plastic (Black) 94V-0

Impeller : Plastic (Black) 94V-0

Bearing : Ball Bearing

Lead Wire : UL1061, AWG26, +Red, -Black

Specifications

MODEL	Product No.	Rated Voltage	Operating Voltage	Current	Input Power	Speed	Max. Air Flow		Max. Static Pressure		Noise	Mass
		(V)	(V)	(A) ^{*1}	(W) ^{*1}	(min ⁻¹) ^{*1}	CFM ^{*1}	(m ³ /min) ^{*1}	in H ₂ O	(Pa) ^{*1}	(dB) ^{*1}	(g)
2004KL-01W-B30-	X00	5	4.5 ~ 6.0	0.10	0.50	3500	6.4	0.18	.06	16.0	23.0	20
2004KL-01W-B40-	X00	5	4.5 ~ 6.0	0.16	0.80	4500	8.1	0.23	.10	26.0	28.5	20
2004KL-01W-B50-	X00	5	4.5 ~ 6.0	0.30	1.50	5500	10.2	0.29	.14	35.0	34.0	20
2004KL-04W-B30-	X00	12	10.2 ~ 13.8	0.04	0.48	3500	6.4	0.18	.06	16.0	23.0	20
2004KL-04W-B40-	X00	12	10.2 ~ 13.8	0.07	0.84	4500	8.1	0.23	.10	26.0	28.5	20
2004KL-04W-B50-	X00	12	10.2 ~ 13.8	0.10	1.20	5500	10.2	0.29	.14	35.0	34.0	20

Rotation: Clockwise

Airflow Outlet: Air Out Over Struts

*1: Average Values in Free Air