

CONTACT ORIENTATION ON ROLL

NOTES : (UNLESS OTHERWISE SPECIFIED)

1. MATERIAL :
  - 1.1. CONTACT BODY : COPPER ALLOY.
  - 1.2. OUTER SPRING : STAINLESS STEEL.
2. SPECIFICATIONS :
  - 2.1 CURRENT RATING : 23A MAX.
  - 2.2 TERMINATION TYPE : CRIMPING.
  - 2.3 WIRE RANGE : 14~12AWG.
  - 2.4 WIRE INSULATION DIA(MAX) :  $\phi$ 4.3mm.
3. ROHS COMPLIANT.
4. ALL DIMENSIONS ARE FOR REFERENCE USE ONLY.

P/N	CONTACT PLATING(MATING AREA)
SP12A1T	TIN PLATING OVER NICKEL.
SP12A1F	GOLD FLASH PLATING OVER NICKEL.
SP12A1G10	10 $\mu$ "GOLD PLATING OVER NICKEL.
SP12A1G15	15 $\mu$ "GOLD PLATING OVER NICKEL.
SP12A1G30	30 $\mu$ "GOLD PLATING OVER NICKEL.

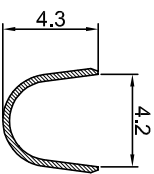

SECTION B-B

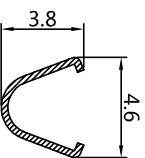

SECTION A-A

REVISIONS					
REV	ECO	DESCRIPTION	DATE	BY	APPR
B1	-	RELEASED DRAWING	JAN-18-2014	ARROW	TOMMY
B2	-	UPDATE DRAWING	NOV-09-2016	FLAN	TOMMY

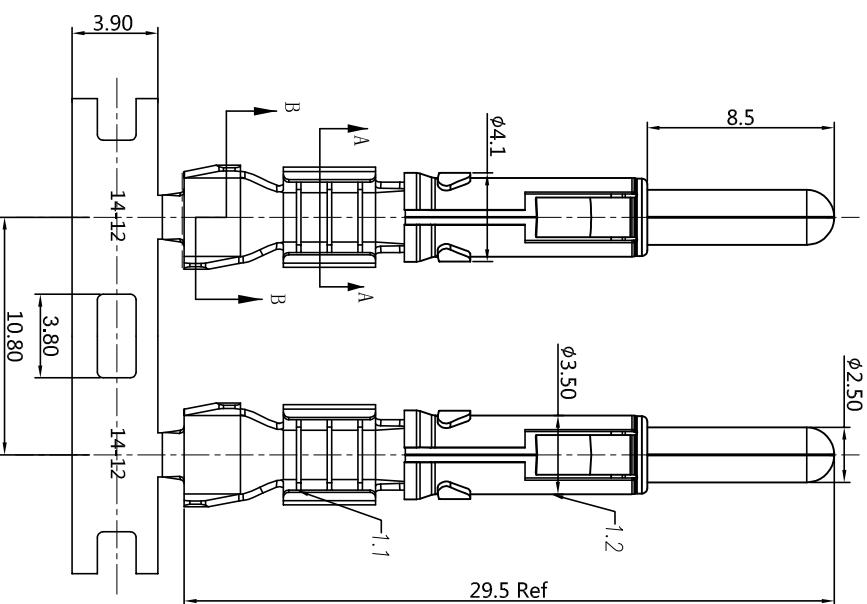

QUANTITY	PART NUMBER	DESCRIPTION	ITEM
1	SP12A1XX	ECO-MATE PIN CONTACT, STAMPED, 14-12AWG, 2.5mm	0F: 1

MATERIALS LIST			
UNLESS OTHERWISE SPECIFIED	SIGNATURES	DATE	REVISION
1) All dimensions are in millimeters. 2) Tolerances are as follows: 1 Pl. DEC 240.30 Fractions .1754 3 Pl. DEC 240.08 Angles .1°	DRAWN: FLN	NOV-09-2016	
3) Note reference = $\Delta$	ENGINEER: TDD	NOV-09-2016	
MATERIAL SPECIFICATIONS:	APPROVAL: TOMMY	NOV-09-2016	
CUSTOMER: TOMMY			
PROCESS SPECIFICATIONS:			
TEST SPECIFICATIONS:			
TEST SPECIFICATIONS SUPERSEDES:			
TEST SPECIFICATIONS AND PERFORMANCE DATA:			
THE MATERIAL CORPORATION HAS NO RESPONSIBILITY FOR REPRODUCTION AND LABELING. ALL MANUFACTURING VARIATIONS.			
SCALE: NONE	SIZE: B	TYPE: C-	DWG NO: SP12A1XX
REVISION: B2			SHEET: 1 OF 1

**Amphenol**  
 Site Systems - www.amphenol-site.com  
 44724 Morley Drive  
 Clinton Township, MI 48036

ECO-MATE PIN CONTACT,  
 STAMPED, 14-12AWG, 2.5mm CONTACT