

# PD-9501G/24VAC

60W, Gigabit, Single-port PoE Midspan, 24VAC Input

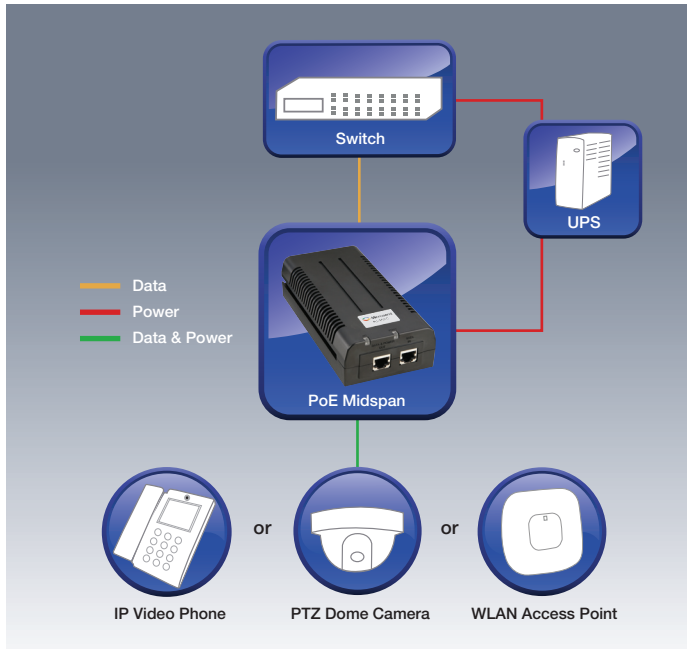

## Overview

Microsemi's PD-9501G-24VAC is a Best-of-Breed single port solution for remote powering of current in a 24VAC environment as well as high power applications.

It is designed specifically to power IEEE 802.11n and IEEE 802.3at access points, pan-tilt-zoom (PTZ) and dome cameras, IP videophones, thin clients and other high power Ethernet end-terminals with 60W of power, and is also backward compatible and safe to use with any 802.3af terminal such as VoIP phones, IP cameras and wireless LAN access points.

It can power both existing 10/100Base-T devices and emerging wireless Gigabit devices such as WI-MAX and wireless IEEE 802.11n access points.

With the midspan's plug-and-play installation, they are easily and cost effectively implemented leveraging an existing Ethernet infrastructure while at the same time providing flexibility to assurance a future-proof scalable network.

## PD-9501G-24VAC Features

- Up to 60W of power over 4-pairs
- 24VAC input voltage
- IEEE802.3at compliant
- Plug-and-play installation
- Guaranteed uptime

## PD-9501G-24VAC Specifications

No. of Ports	1
Pass Through Data Rates	10/100/1000 Mbps
Power over Ethernet Output	Pin Assignment and Polarity: Data Pairs 1/2 (-) and 3/6 (+) Spare Pairs 7/8 (-) and 4/5 (+) Output Power Voltage: 54-57Vdc User Port Power: 60W Max.
Input Power Requirements	AC Input Voltage: 24VAC $\pm$ 20% AC Input Current: 6A @24VAC Frequency: 50 to 60 Hz
Dimensions	87 mm (W) x 43 mm (H) x 166 mm (L) 3.46 in. x 1.68 in. x 6.53 in.
Weight	.992 lbs (450g)
Indicators	System Indicator: Green—AC Power  Channel Power: Green— Power delivered over 4 pairs
Connectors	Shielded RJ-45, EIA 568A and 568B
Environmental Conditions	Operating Ambient Temperature: 14° to 104°F (-10°C to 40°C) @60W 14° to 122°F (-10°C to 50°C) @30W  Operating Humidity: Maximum 90%, Non-condensing  Storage Temperature: -4° to 158°F (-20° to 70°C)  Storage Humidity: Maximum 95%, Non-condensing  Operating Altitude: -1000 to 10,000 ft. (-304.8 to 3048 m)
Reliability	MTBF: 150,000 hrs. @25°C
Thermal Rating	44 BTU/Hr
Warranty	1-year
Regulatory	IEEE 802.3af (PoE), IEEE 802.3at (including 2-event), RoHS Compliant, WEEE Compliant, CE
Electromagnetic Emission & Immunity	FCC Part 15, Class B EN 55022 Class B (Emissions) EN 55024 (Immunity)
Safety Approvals	GS Mark Per IEC60950

## Ordering Information

Part Number	Name	Ports
PD-9501G/24AC	Microsemi PD-9501G 24VAC	1-port



**Microsemi**

Microsemi Corporate Headquarters  
One Enterprise, Aliso Viejo, CA 92656 USA  
Within the USA: +1 (800) 713-4113  
Outside the USA: +1 (949) 380-6100  
Sales: +1 (949) 380-6136  
Fax: +1 (949) 215-4996  
email: [sales.support@microsemi.com](mailto:sales.support@microsemi.com)  
[www.microsemi.com](http://www.microsemi.com)

Microsemi Corporation (Nasdaq: MSCC) offers a comprehensive portfolio of semiconductor and system solutions for communications, defense & security, aerospace and industrial markets. Products include high-performance and radiation-hardened analog mixed-signal integrated circuits, FPGAs, SoCs and ASICs; power management products; timing and synchronization devices and precise time solutions, setting the world's standard for time; voice processing devices; RF solutions; discrete components; security technologies and scalable anti-tamper products; Power-over-Ethernet ICs and midspans; as well as custom design capabilities and services. Microsemi is headquartered in Aliso Viejo, Calif., and has approximately 3,400 employees globally. Learn more at [www.microsemi.com](http://www.microsemi.com).

©2014 Microsemi Corporation. All rights reserved. Microsemi and the Microsemi logo are trademarks of Microsemi Corporation. All other trademarks and service marks are the property of their respective owners.

MSC-PD-9501G/24VAC/6.2014