

Amphenol

MFM Series

Singleway Fibre Optic Connector

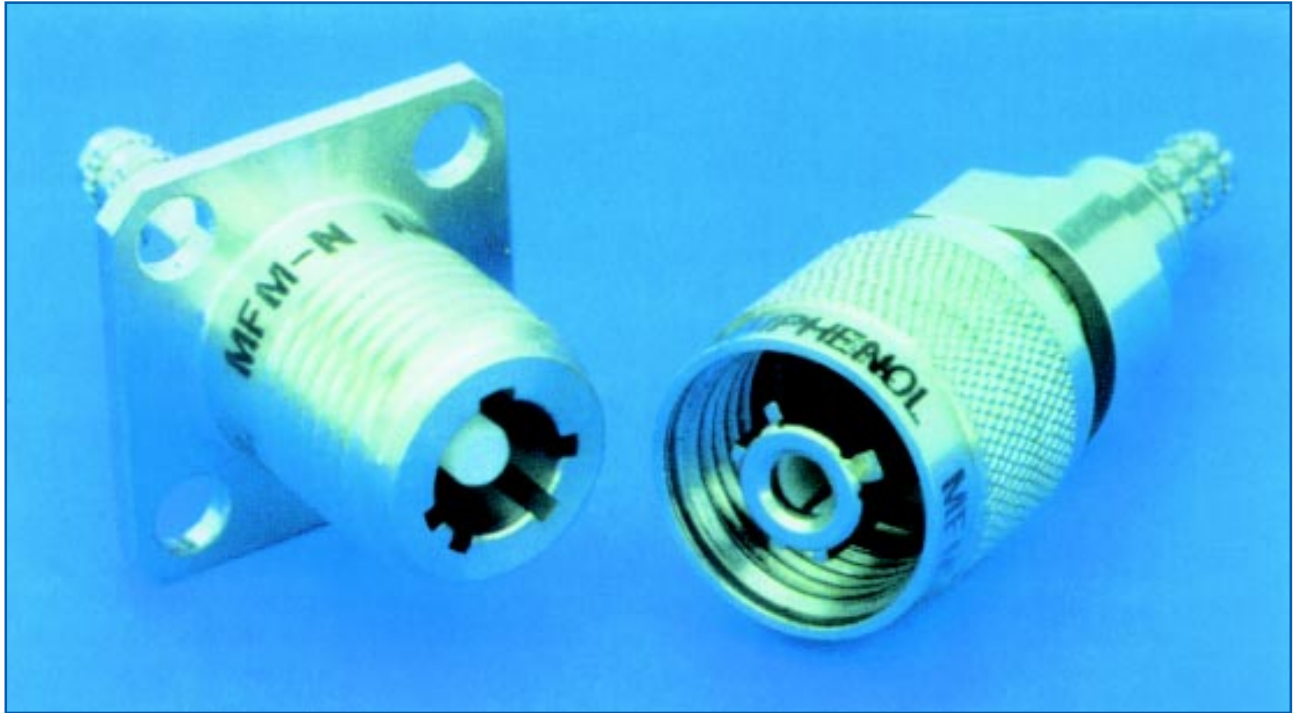

A high performance, low loss, fibre optic connector specifically designed to operate in harsh environments.

- The MFM uses ceramic PC ferrule technology with a ceramic alignment sleeve to reduce insertion loss.
- Lightweight, designed to interface with a wide range of rugged fibre optic cables.
- Keyed shells and ferrules for optimum repeatability.
- Anti vibration coupling mechanism.
- Silicone 'O'-ring environmental sealing.
- Keyway polarisation.
- RFI receptacle gasket.
- Manufactured in Arcap for corrosion resistance.

Amphenol

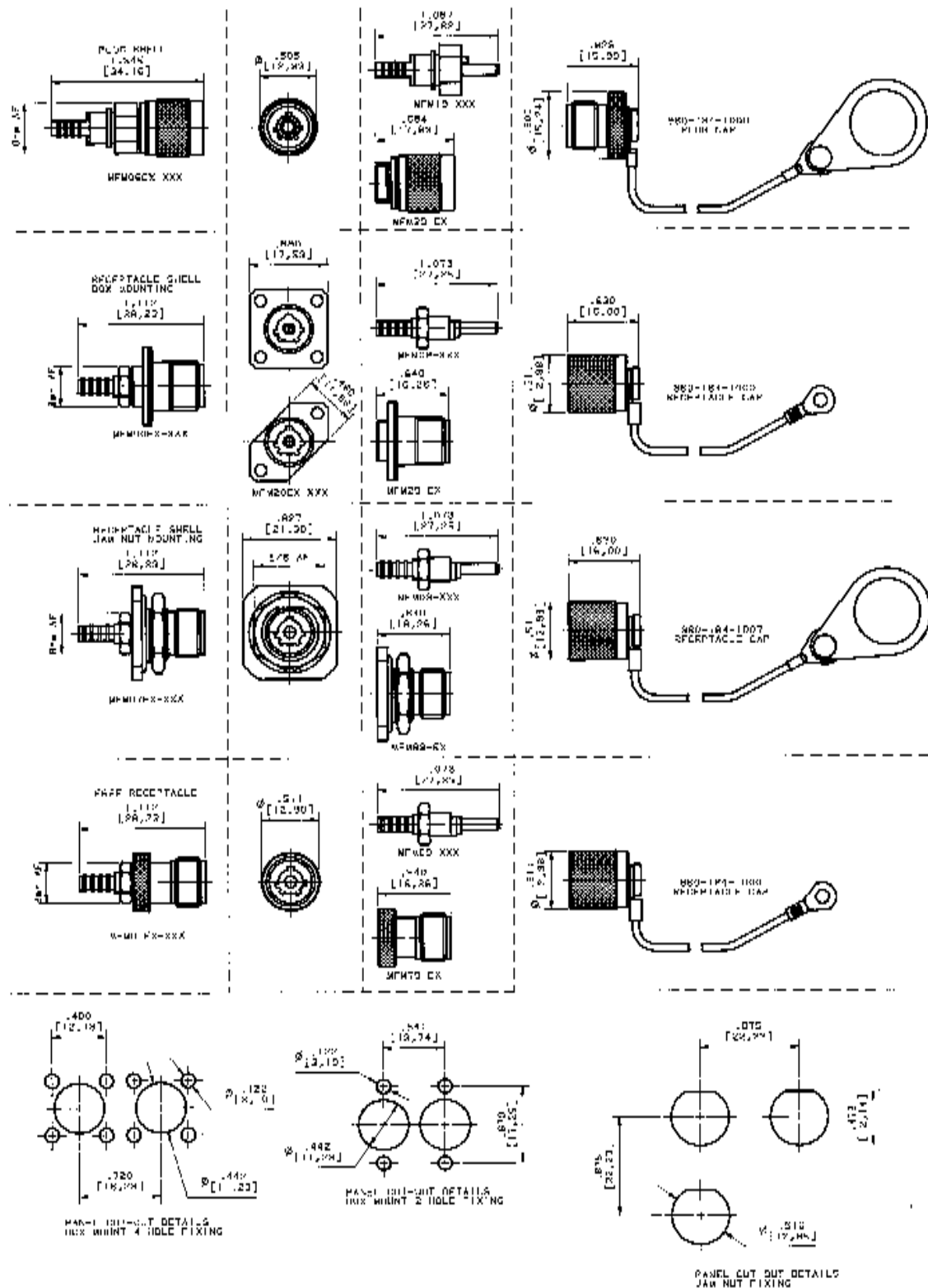

Performance

Optical				
Attenuation	Typically 0.25 with 62.5/125 cable			
Repeatability	<0.1dB			
Fibre types	50/125	62.5/125		
	85/125	100/140		
	200/280	8/125		
Cable types	-001	62.5/125	2.75 OD	Ruggedised
	-002	62.5/125	6.2 OD	Ruggedised
	-003	62.5/125	2.75 OD	Loose Tube
	-004	200/280	2.5 OD	Ruggedised
	-005	100/140	1.6 OD	Ruggedised
	-006	8/125	2.75 OD	Ruggedised
	-007	8/125	6.2 OD	Ruggedised
	-008	62.5/125	2.75 TJ	Santaprene boot
	-015	100/140	1.5 mm	Buffer
	-017	62.5/125	5.4 OD	-7 Crimp ferrule and heatshrink
Many other cable types are available - contact factory for details				
Termination method	Epoxy/polish			

Environmental	
Temperature range	-65°C - +155°C
Vibration	As per pr EN 2519 Test D3
Method A	

Mechanical	
Durability	>500 matings
Materials	Shell: Arcap
	Ferrule: PC Zirconia ceramic
	Alignment Sleeve: Zirconia ceramic
	'O' ring (seals): Silicone
	Boot: Silicone

Termination tools and Consumables	
Basic termination kit	927 - 100 - 3000
Add on kit	927 - 100 - 3500
Consumable pack (50 terminations approximately)	927 - 100 - 6000
Other items of tooling may be purchased separately, please contact factory for details	

Part Numbers Information

SeriesMFM—XX—E—X—XXX

Plug06

Receptacle00

Free Receptacle01

2 hole receptacle20

Jam Nut07

Orientation
N,A,B,C,D,E,U

Cable variant - See previous page

Sub-Assembly

SeriesMFM—XX—E—X

Plug Shell39

Receptacle Shell29

Jam nut shell69

Free receptacle shell79

Orientation
N,A,B,C,D,E,U

SeriesMFM—XX—XXX

Receptacle Sub Assembly09

Plug Sub Assembly19

Cable variant - See previous page

Protective Caps - See Technical Information on Page 2

For further information on cables, connectors and assemblies please consult your local office.
Product specifications and performance characteristics are typical only, and subject to change.

Notice: Products are sold subject to Amphenol's conditions of sale ("the standard conditions"). All specifications and statements contained herein are believed to be correct at the time of printing, but no representation or warranty, express or implied, is given as to any specification or statement contained herein. Product specifications including performance characteristics are typical only and subject to deviation. Specifications are also subject to change without notice. Users should not assume that all safety measures are indicated or that other measures may not be required. No representation or warranty, express or implied, is given that any use of products (including any stated or suggested use) does not infringe any patent, registered design or other third party rights and no stated or suggested use of products can be taken to recommend any such infringement.