

THIS DRAWING IS UNPUBLISHED. RELEASED FOR PUBLICATION, 19

© COPYRIGHT 19 BY AMP INCORPORATED. ALL INTERNATIONAL RIGHTS RESERVED

DESCRIPTION	MATERIAL	FINISH
MODULE ASSEMBLY	D.A.P. PER MIL-M14	COLOR: RED
GROMMET	FLOURSILICONE 40/50 PER MIL-R-25988	COLOR: NATURAL
CONTACT SOCKET	BERYLLIUM COPPER ASTM-B194	GOLD PLATE PER MIL-G-45204
RETAINING CLIP	BERYLLIUM COPPER ASTM-B194 OR STAINLESS STEEL PER QQ-S-766	NONE

REVISIONS						
P	F	ZONE	LTR	DESCRIPTION	DATE	APPROVED
			0	RELEASE OF NEW PRODUCT	02/93	J.L.M.
			A	REV PER 0600-4061-95	NF 06/95	JH

D

D

BUSSING ARRANGEMENT

INDEXING INDICATOR

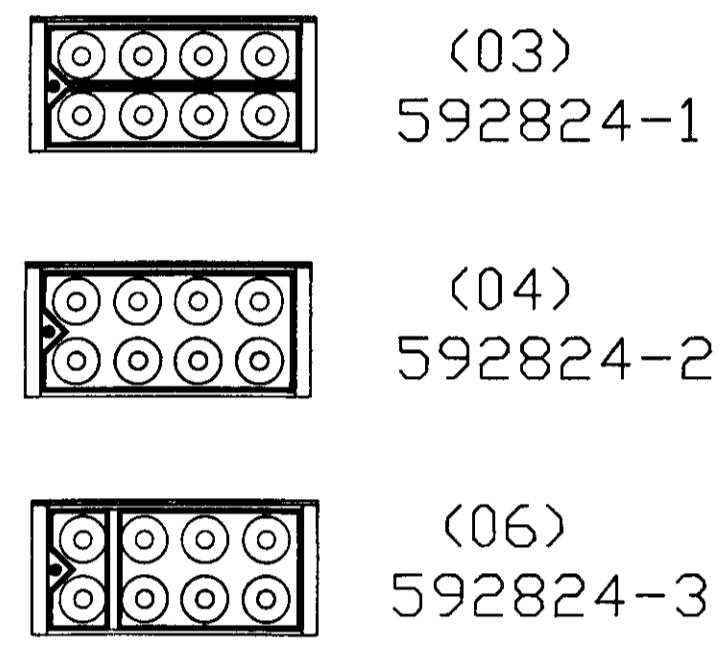
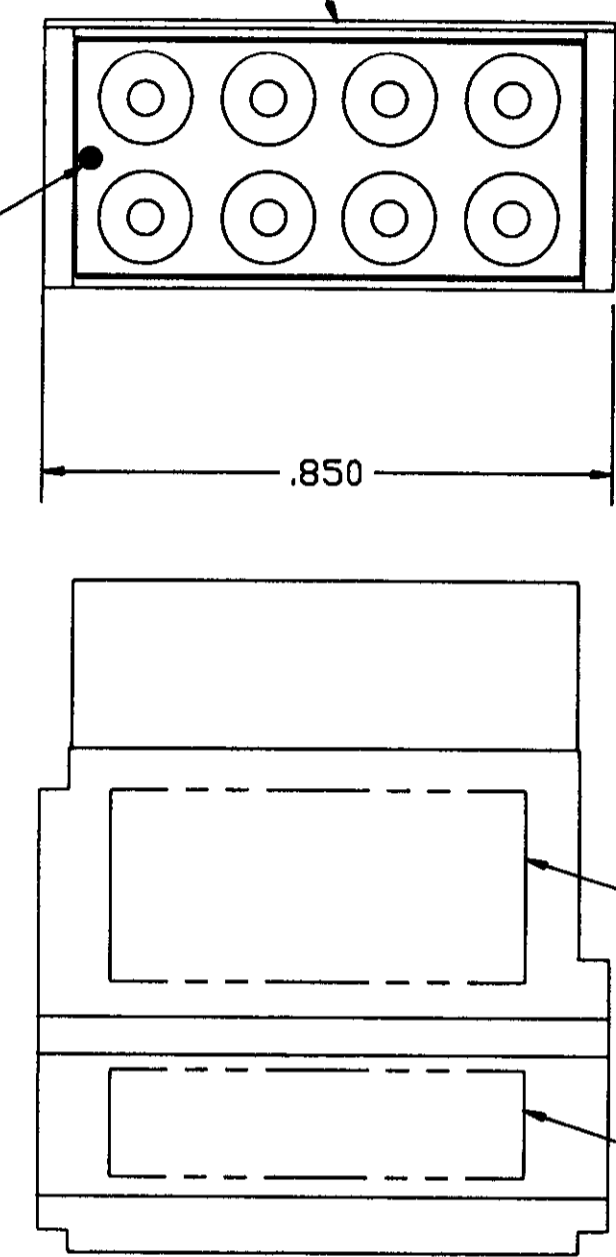
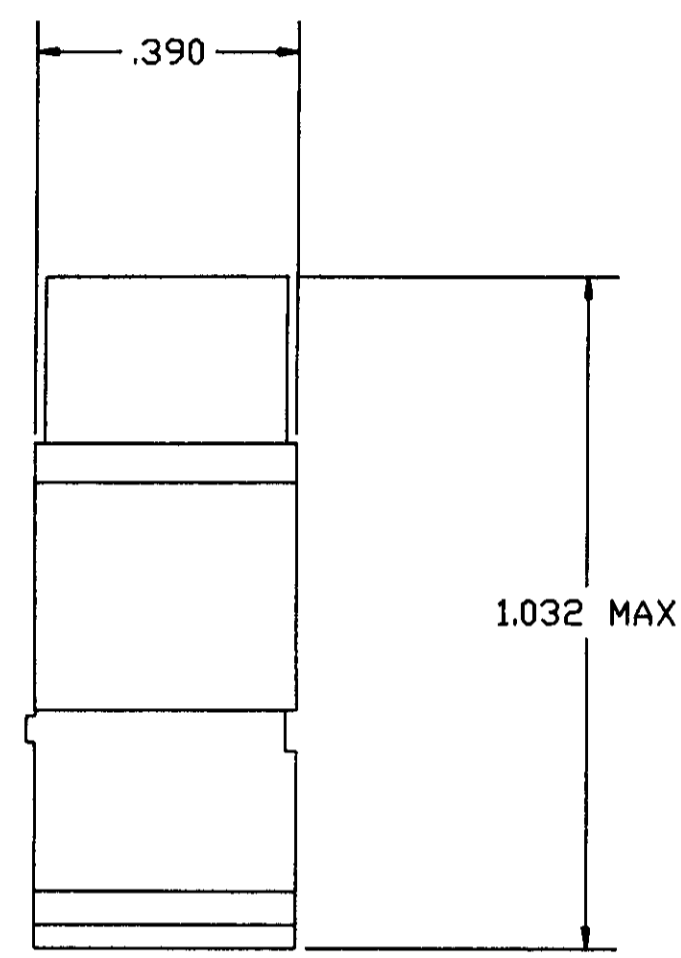

BUSSING ARRANGEMENTS

- 1 MARK MODULE IDENTIFICATION, "AMP", AMP PART NO. AND DATE CODE.
- 2 MARK MODULE ASSEMBLY 592824-1 WITH CUSTOMER PART NO. MRTB16E03-204.
- 3 MARK MODULE ASSEMBLY 592824-2 WITH CUSTOMER PART NO. MRTB16E04-204.
- 4 MARK MODULE ASSEMBLY 592824-3 WITH CUSTOMER PART NO. MRTB16E06-204.
- 5. ROLLS ROYCE QUALITY SPECIFICATION CQC-103 IS INVOKED FOR THIS PART NO.

REMARKS	DESCRIPTION	PART NO
4	SIZE 16	592824-3
3	SIZE 16	592824-2
2	SIZE 16	592824-1

DO NOT SCALE PRINT. UNLESS OTHERWISE SPECIFIED DIMENSIONS ARE IN INCHES. TOLERANCES DIM: 2 PLC DEC ± --- 3 PLC DEC ± .005 ANGLES ± ---	CONTRACT NO		AMP AMP INCORPORATED Harrisburg, Pa. 17105			
	DR	N. FRITZ 09-21-93				
	MATERIAL	SEE TABLE	CHK	R. RYAN 09-22-93	NAME	MODULE, FEED-BACK ASSEMBLY SIZE 16 TJ
	FINISH	SEE TABLE	APPD	R. RYAN 09-22-93 D. ENGLER 09-22-93	SIZE	C
OTHER APPD		Dsgn APPD	FSCM NO	00779	DRAWING NO	592824
SCALE 1 : 1			SHEET 1 OF 1			

THIS DRAWING IS A CONTROLLED DOCUMENT FOR AMP INCORPORATED. IT IS SUBJECT TO CHANGE AND THE CONTROLLING ENGINEERING ORGANIZATION SHOULD BE CONTACTED FOR THE LATEST REVISION.

592824