



ETA-USA

HIGH QUALITY SWITCHING POWER SUPPLIES

AC/DC SWITCHING DESKTOP ADAPTER
POWER SUPPLY WITH PFC
SINGLE OUTPUT / UNIVERSAL RANGE INPUT
80 WATTS

DTC80-SX-W6 Series



Dimension: L132.0×W69.0×H40.0mm



General Description

Features

1. High Reliability
2. Meets CEC, CoC, EISA, RoHS, and DoE requirements
3. Over voltage protection
4. Short circuit protection
5. Over load protection
6. Meets UL, CSA, TUV, IEC60950-1 standards
7. 100% burn-in test at max load under 35~45 centigrade
8. Meets Energy Star level 6 requirements

| Input | |
|----------------------|----------------------------------|
| Input Voltage Range: | 90-264VAC |
| Frequency: | 47-63Hz |
| Input Current (rms): | 2.0A @ 90Vac max |
| Inrush current: | 150A at 230VAC max at cold start |
| Power Factor: | >0.9 (115VAC100%Load) |
| Efficiency : | >88% @ full load, 115VAC |

| Output Characteristic | Unit | DTC80-12SX-W6 | DTC80-15SX-W6 | DTC80-18SX-W6 | DTC80-24SX-W6 | DTC80-28SX-W6 | DTC80-48SX-W6 |
|------------------------|-------|-------------------------------------|---------------|---------------|---------------|---------------|---------------|
| | | Output Voltage | Vdc | 12 | 15 | 18 | 24 |
| Output Current | A | 6.67 | 5.34 | 4.45 | 3.34 | 2.86 | 1.67 |
| Output Power | W | 80 | | | | | |
| O/P Regulation | % | ±5% | | | | | |
| Ripple & Noise (Vp-p)* | mVp-p | <240mVpp | | | | | |
| Hold-up time | mS | >20ms typical at full load @ 115VAC | | | | | |

* Peak-to-peak with 20MHz bandwidth with a tantalum 10uF in parallel with a 0.1uF ceramic capacitor.



ETA-USA

HIGH QUALITY SWITCHING POWER SUPPLIES

| Dielectric withstand | |
|--|---|
| Primary-Secondary | 4242VDC for 4 sec |
| Primary-Frame Ground | 2121VDC for 4 sec |
| Insulation Resistance | |
| Primary-Secondary | 20MOhm min 500VDC |
| Primary-Frame Ground | 20MOhm min 500VDC |
| Environmental Specification | |
| Operating Temperature | 0 to +60°C (derate linearly by 2.5% / °C from 41°C to 60°C) |
| Storage Temperature | -10 to +85°C |
| Storage Humidity | 10~90% RH non-condensing |
| MTBF demonstrated | >120,000 hours at full load and 25 °C ambient temperature |
| Temperature Coefficient | 0.05%/°C max |
| Environmental Agencies | |
| Safety Standards | UL 60950 -1 CSA 22.2-No.60950-1 TUV EN60950-1 CB IEC 60950-1 |
| EMC Standards | EN55022 Class B, EN55024 Class B, FCC Class B |
| Protection | |
| Short circuit protection | Auto Recover |
| Over Load Protection | Auto Recover |
| Over Voltage Protection | LATCH AC Recycle after 110~130% of rated output |
| Overshoot at turn on/turn off | Any overshoots should be less than 5% of voltage regulation tolerance. No voltage of opposite polarity shall be present on any output during turn-on or turn-off. |
| Mechanical | |
| Dimension [mm]: L132.0×W69.0×H40.0mm | |
| AC Input : IEC 320-C14 | |
| Output connector: As specified by customer | |





ETA-USA

HIGH QUALITY SWITCHING POWER SUPPLIES

DIMENSION DIAGRAM (mm)

Note :

1. AC INLET : IEC320-C14 STANDARD
2. BOX COLOR : BLACK
3. TOLERANCE : +/-0.5mm
4. UNIT : mm

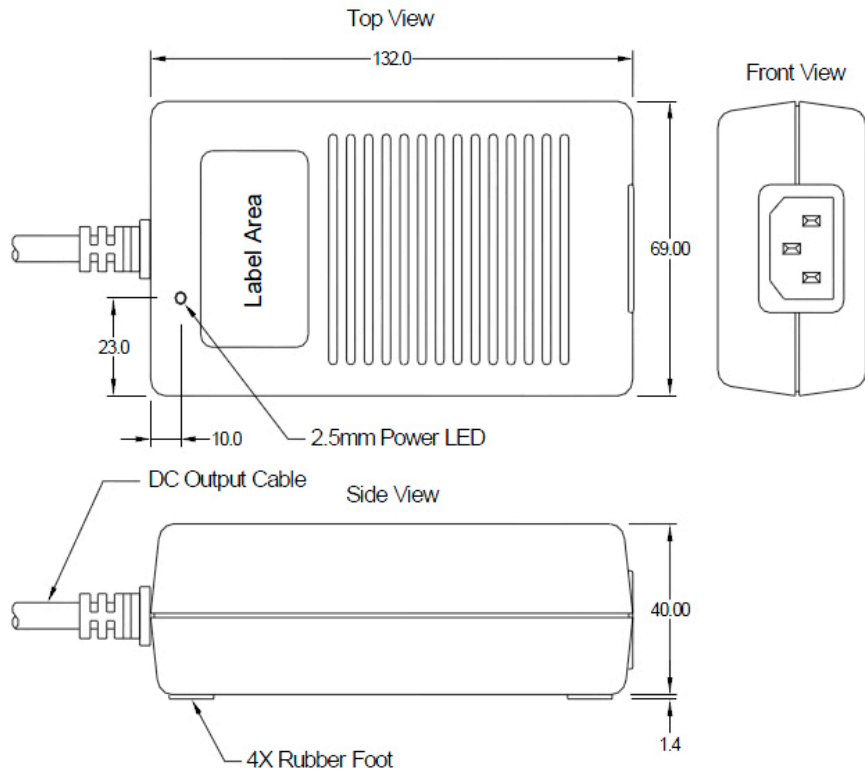



ETA-USA

HIGH QUALITY SWITCHING POWER SUPPLIES

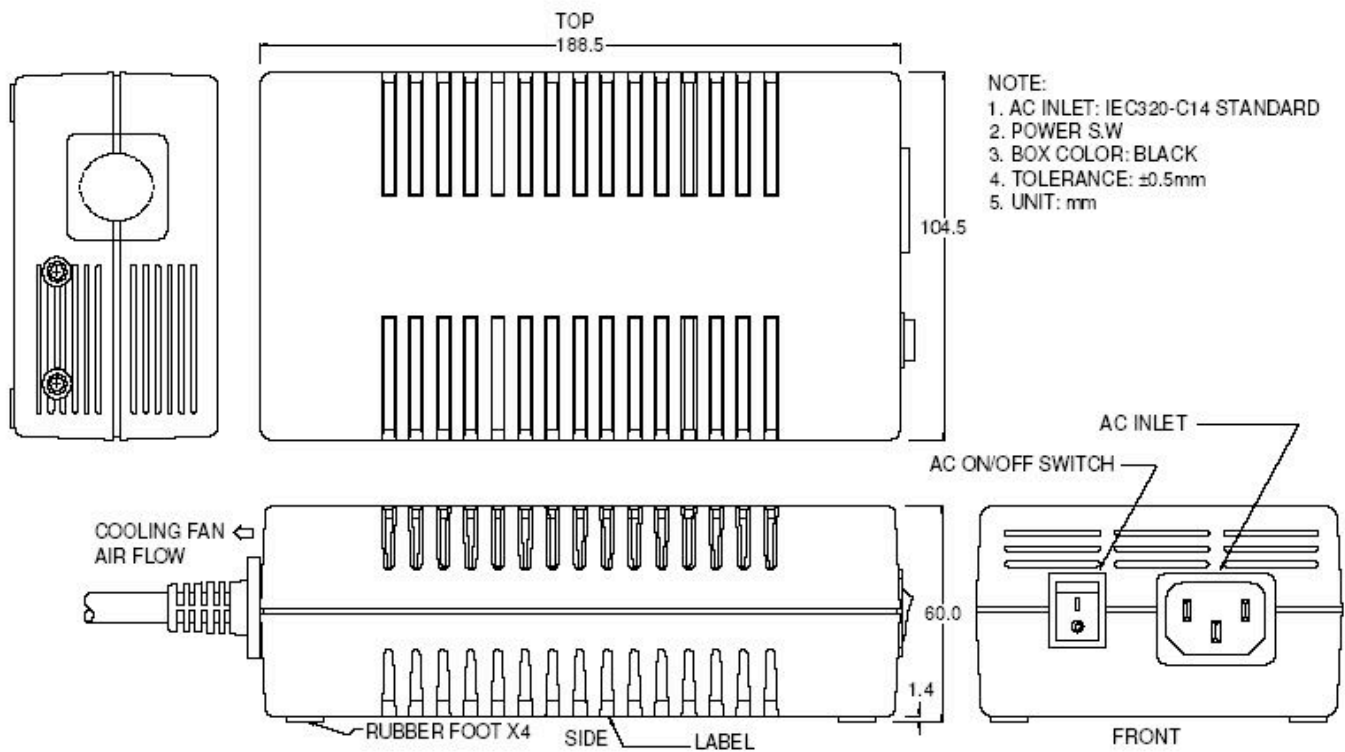

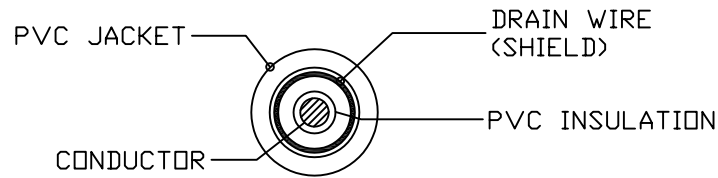

[1571#14AWG 1C+1]
SECTIONAL DRAWING

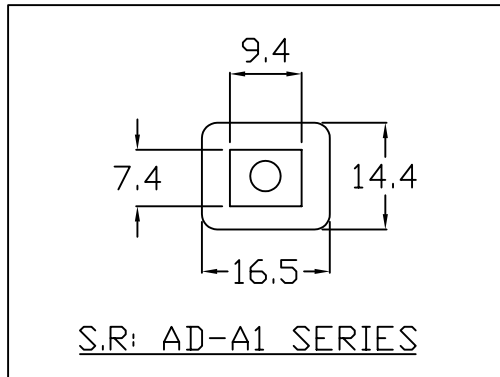
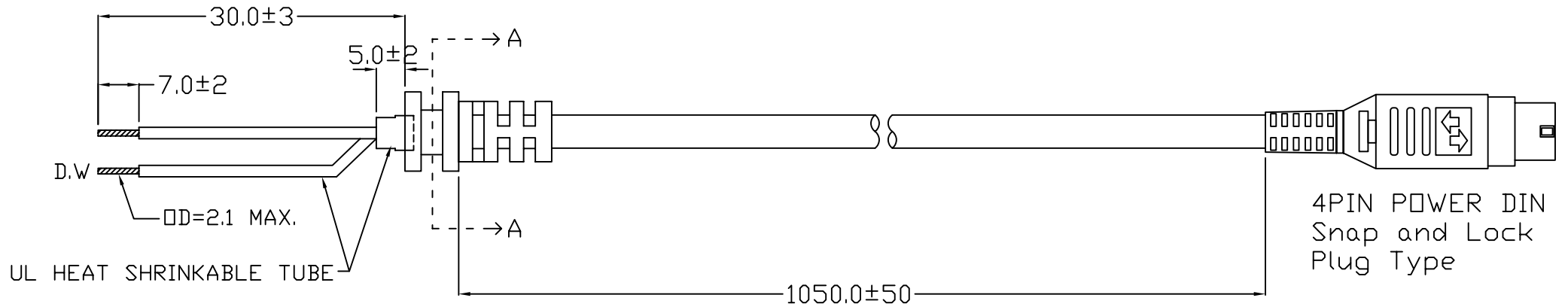
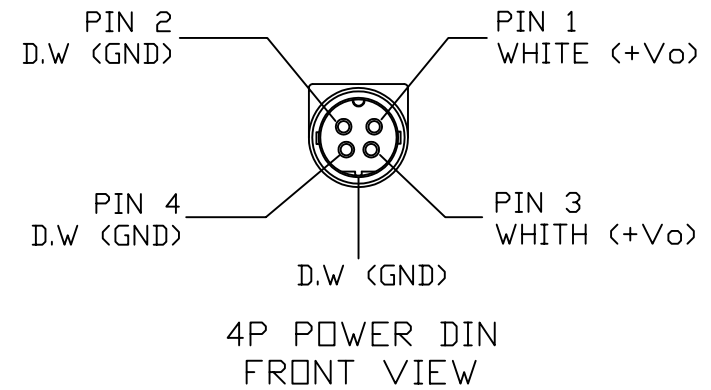

SECTION A-A

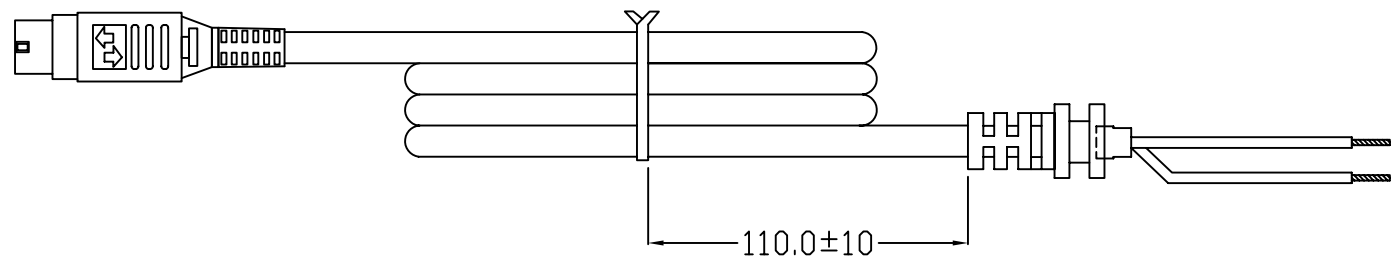

[包裝方式]

COMPONENT LIST

- 1.CABLE : COLOR BLACK UL/CSA 1571 80/90°C 30V
14AWGX1C + DRAIN WIRE
- 2.PVC WIRES : COLOR : BLACK / WHITE
- DTC80-12SX-W6
- DTC80-15SX-W6
- DTC80-18SX-W6
- D0972A



ETA-USA

16170 Vineyard Blvd. Suite 180
Morgan Hill, CA 95037

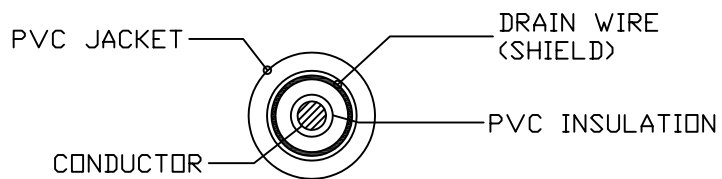

[1185#16AWG 1C+1]
SECTIONAL DRAWING

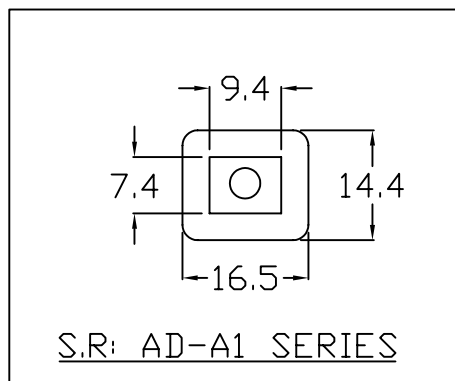
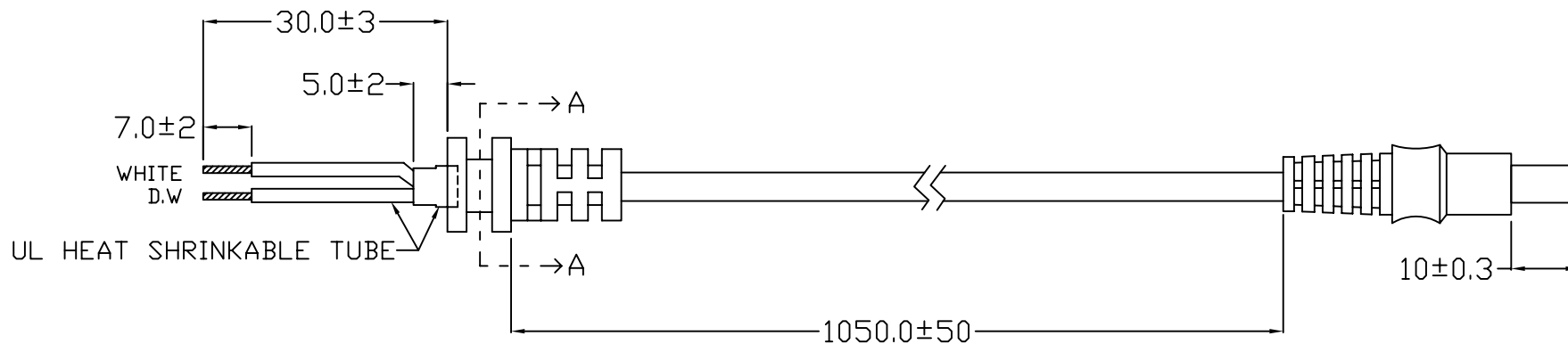
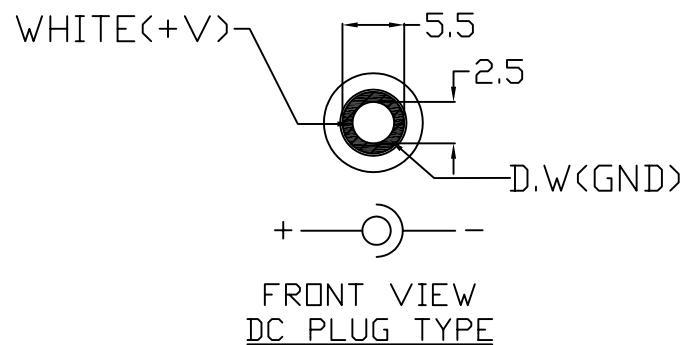

SECTION A-A

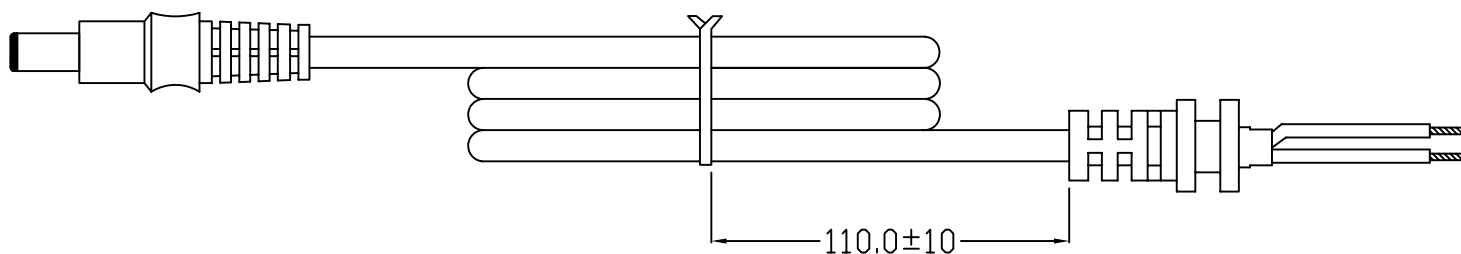

[包裝方式]

COMPONENT LIST

- 1.CABLE:COLOR BLACK UL/CSA 1185 80/90°C 300V
16AWGX1C+SHIELD
- DTC80-24SX-W6
- DTC80-48SX-W6
- DO973A



ETA-USA

16170 Vineyard Blvd. Suite 180
Morgan Hill, CA 95037