

KP10LU07

OUTLINE DIMENSIONS

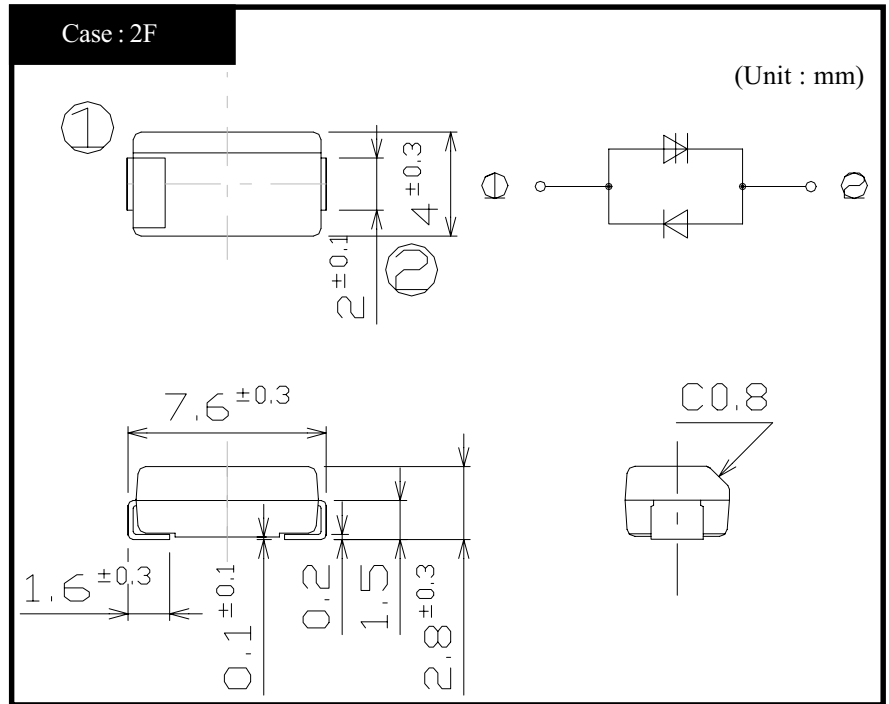

RATINGS

●Absolute Maximum Ratings

Item	Symbol	Conditions	Ratings	Unit
Storage Temperature	T _{stg}		-40~125	°C
Junction Temperature	T _j		125	°C
Maximum Off-State Voltage	V _{DRM}		60	V
Surge On-State Current	I _{TSM}	10/1000 μ s, Non-repetitive	100	A
Surge On-State Current	I _{FSM}	10/1000 μ s, Non-repetitive	100	

●Electrical Characteristics (Tl=25°C)

Item	Symbol	Conditions	Ratings	Unit
Breakdown Voltage	V _{BR}	Pulse measurement	Min 62	V
Off-State Current	I _{DRM}	V _D = V _{DRM}	Max 10	μ A
Holding Current	I _H	Pulse measurement	Min 100	mA
On-State Voltage	V _T	I _T = 2A	TYP 1.15	V
Junction Capacitance	C _j	f = 1kHz OSC = 1V, V _D = 50V	Max 180	pF
Clamping Voltage	V _{CL}	dv/dt = 100V/μ s	Max 100	V

KP10LU07 On-State Voltage - On-State Current

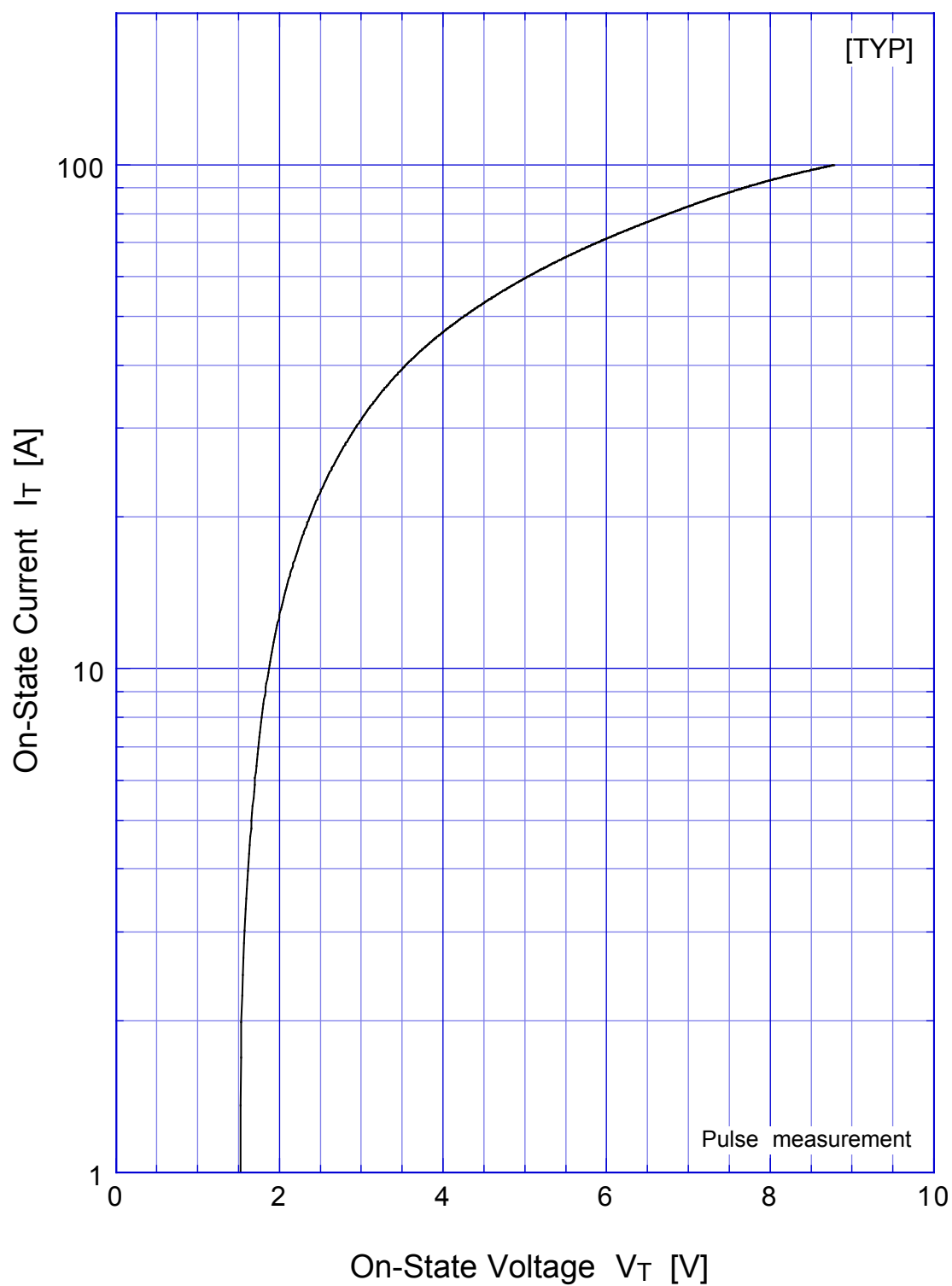

KP10LU07 Breakover Voltage - Junction Temperature

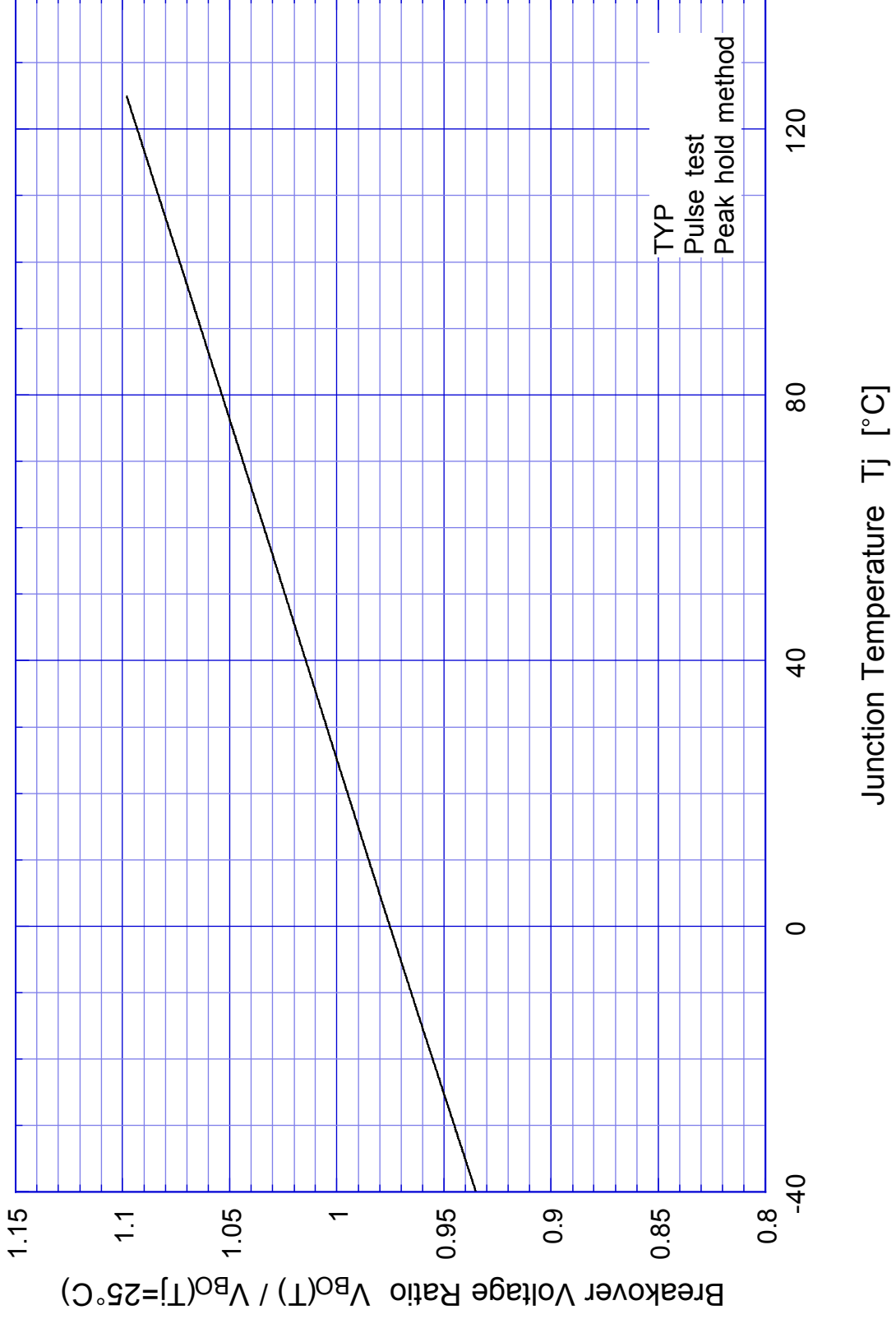

KP10LU07 Holding Current - Junction Temperature

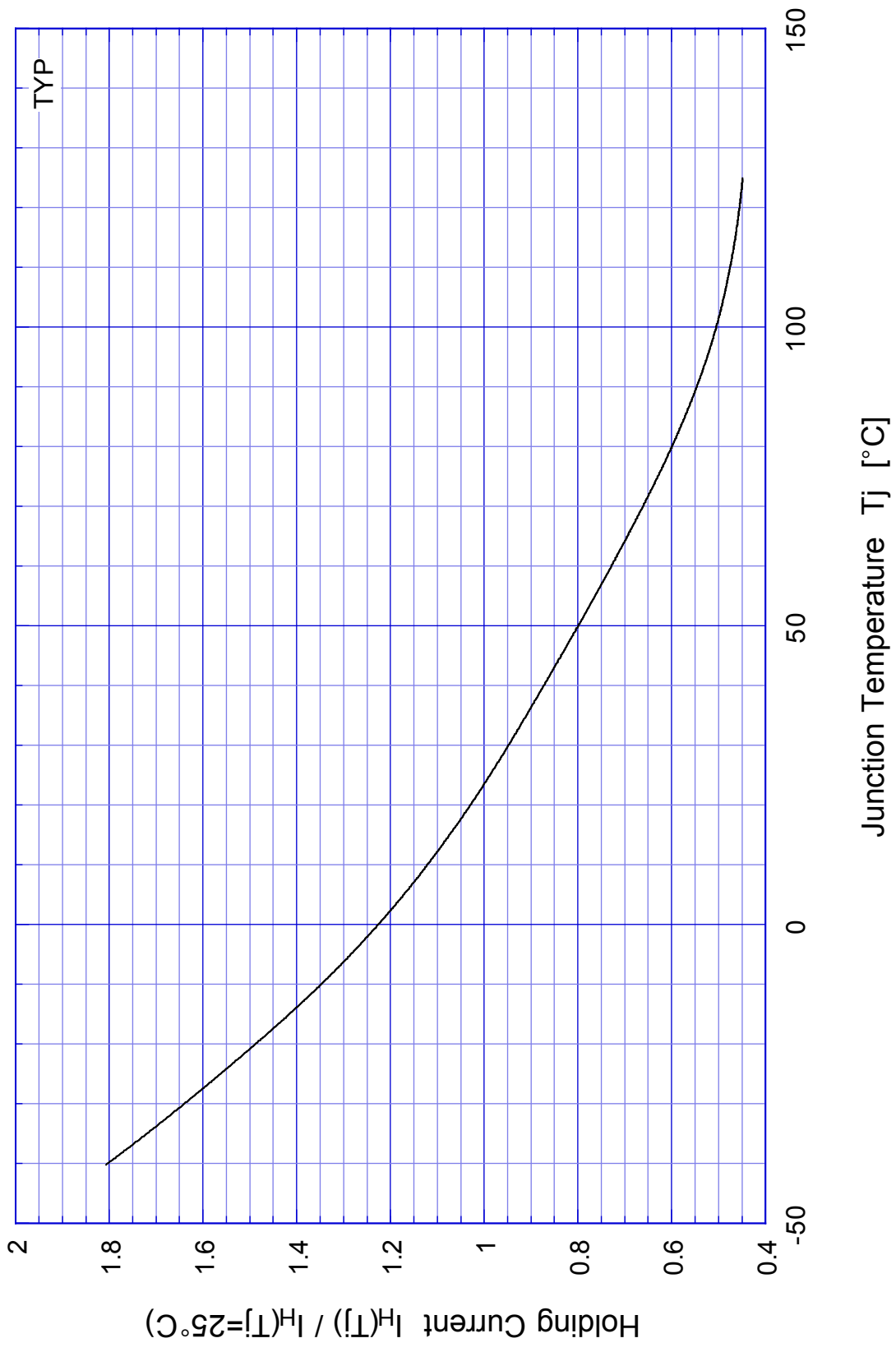

TYP

KP10LU07 Junction Capacitance

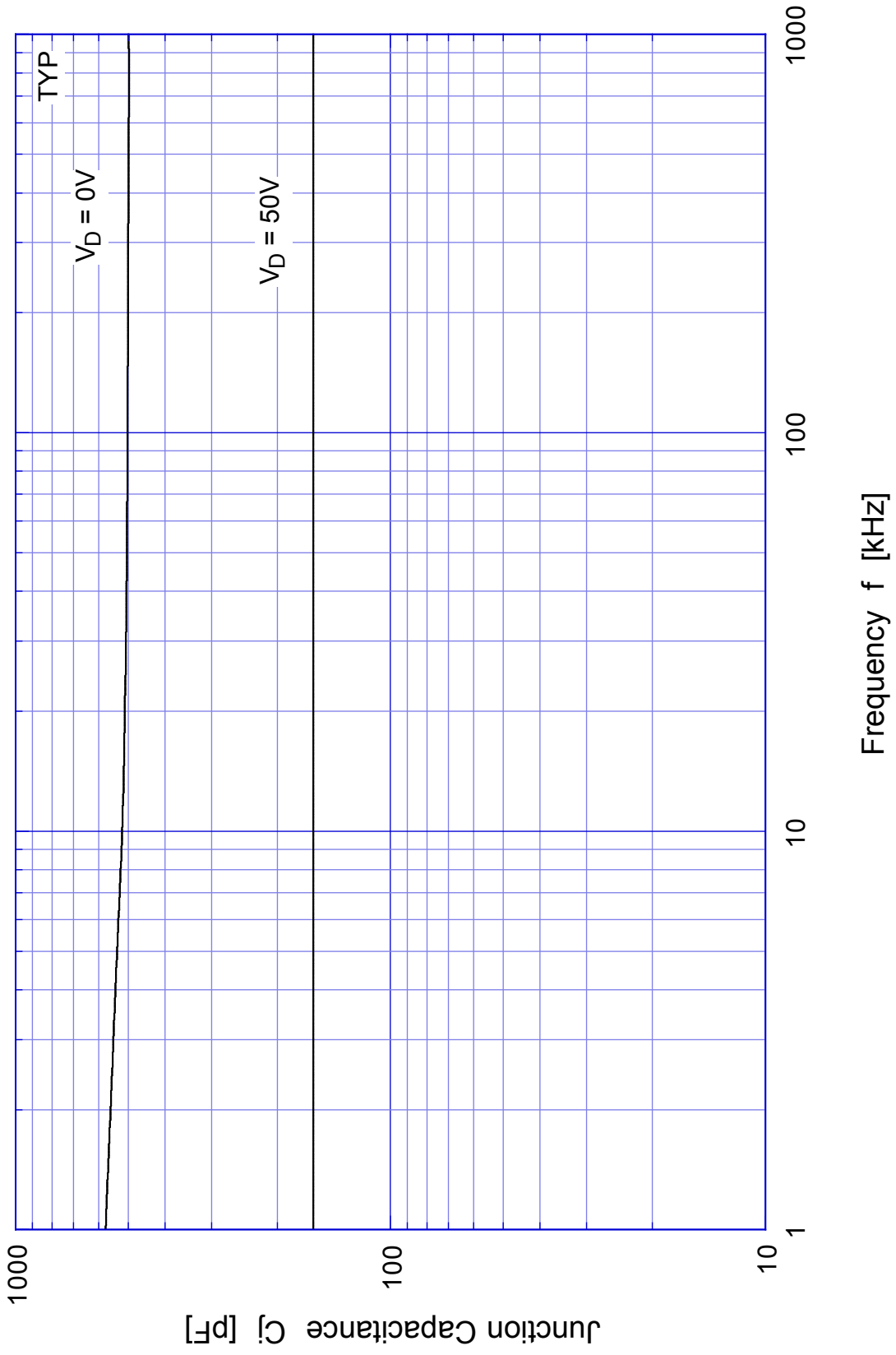

KP10LU07 Junction Capacitance

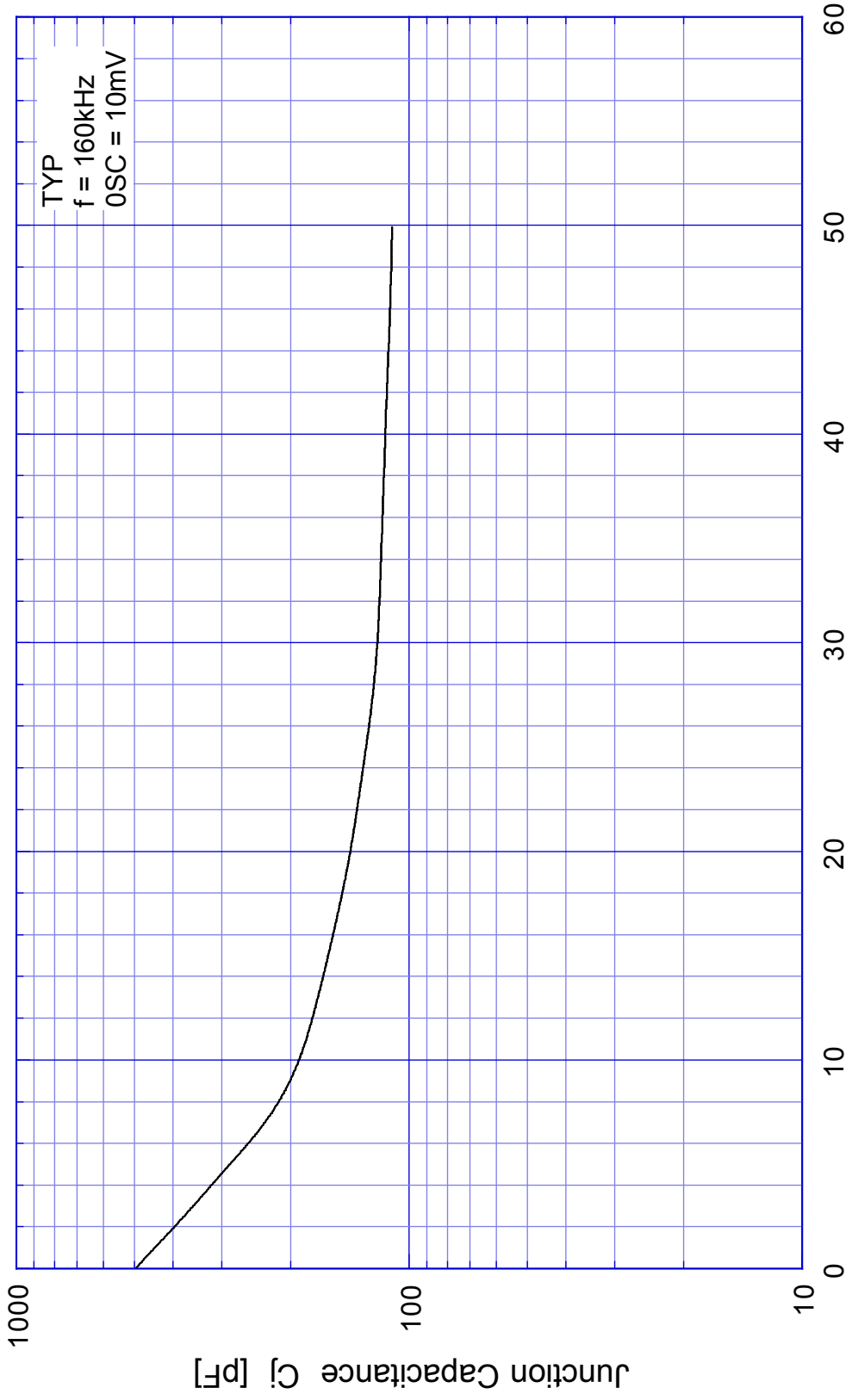

Off-State Applied Voltage V_D [V]

KP10LU07

Clamping Voltage

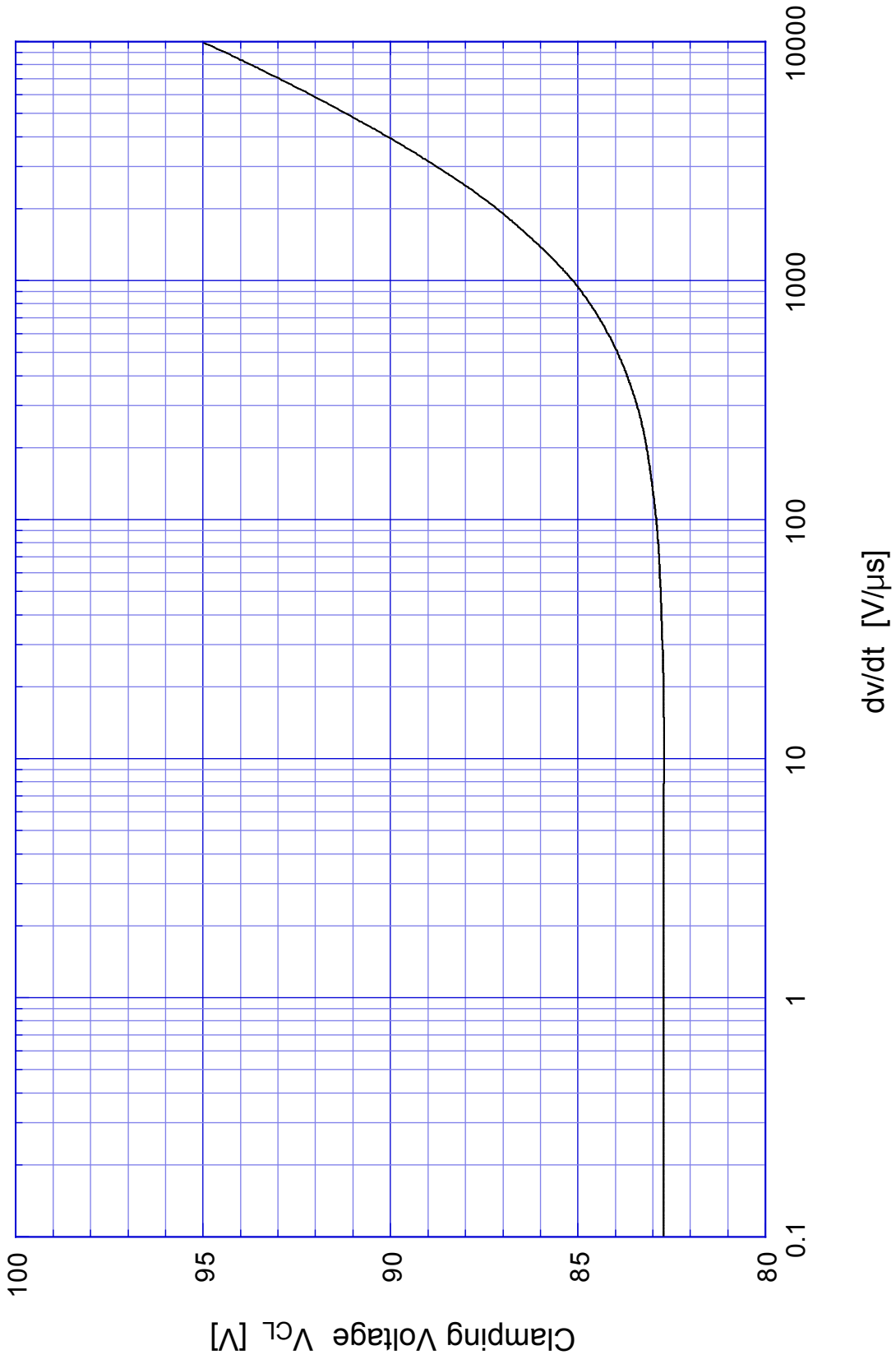

Mouser Electronics

Authorized Distributor

Click to View Pricing, Inventory, Delivery & Lifecycle Information:

Shindengen:

[KP10LU07-5063](#) [KP10LU07-5073](#) [KP10LU07-5103](#)