

### TYPE 1 类型 1

Single PG/M thread & With nonconductive seal  
单PG/M螺纹孔带非导电密封圈

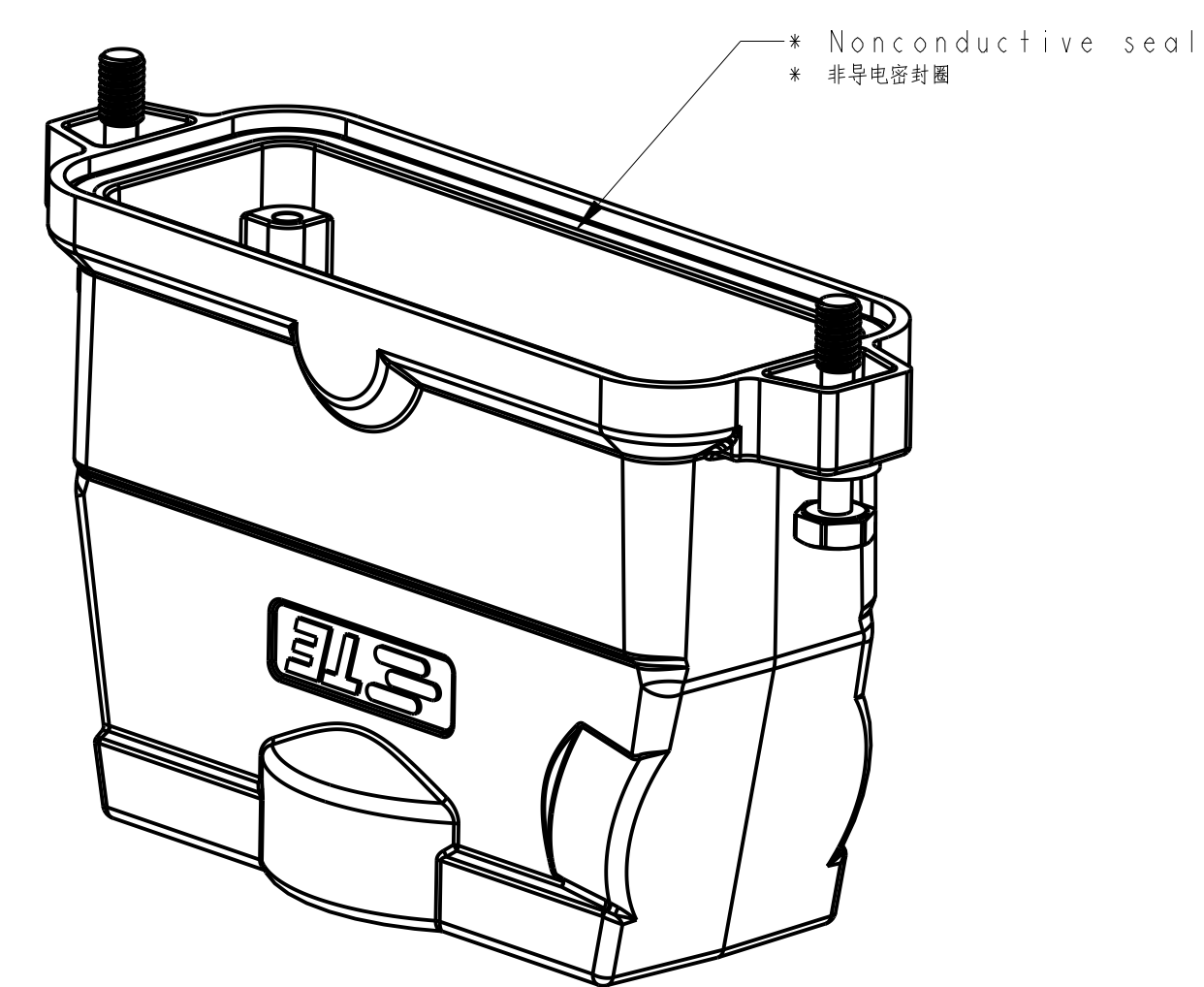
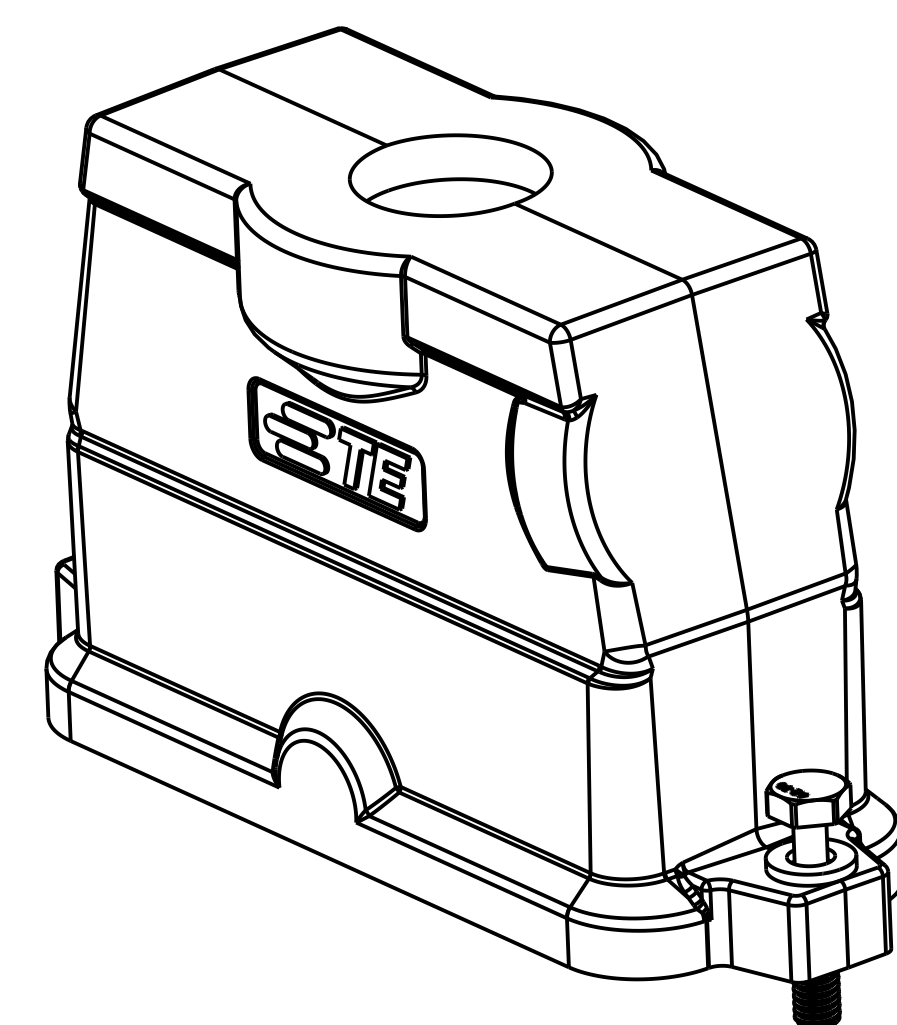
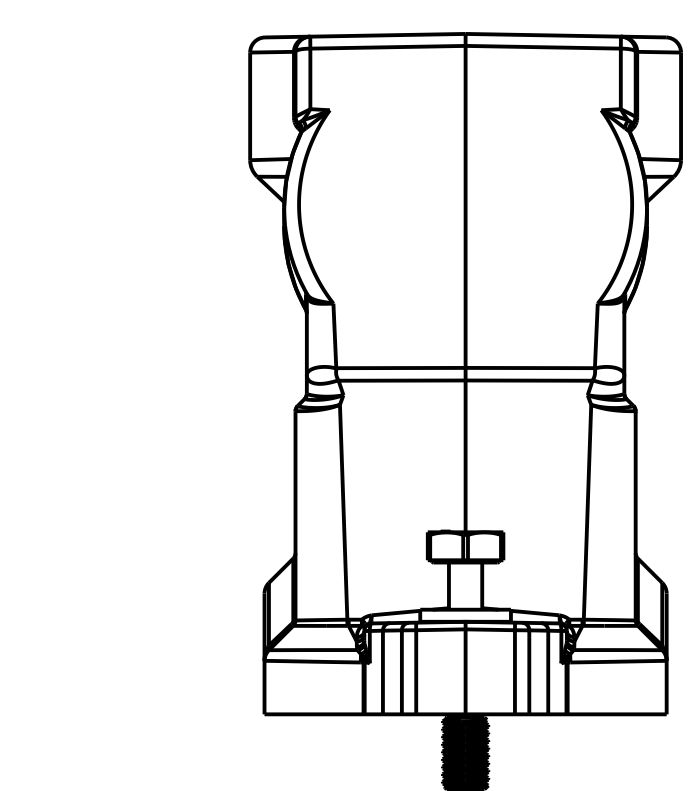
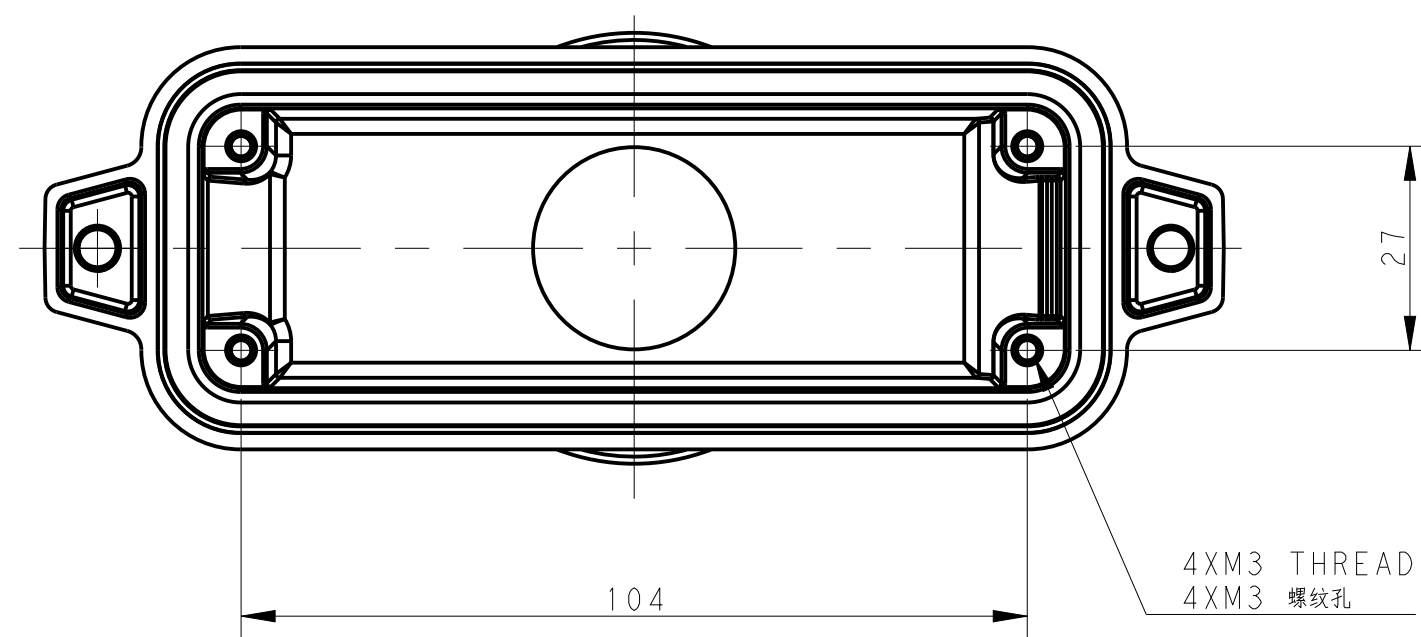
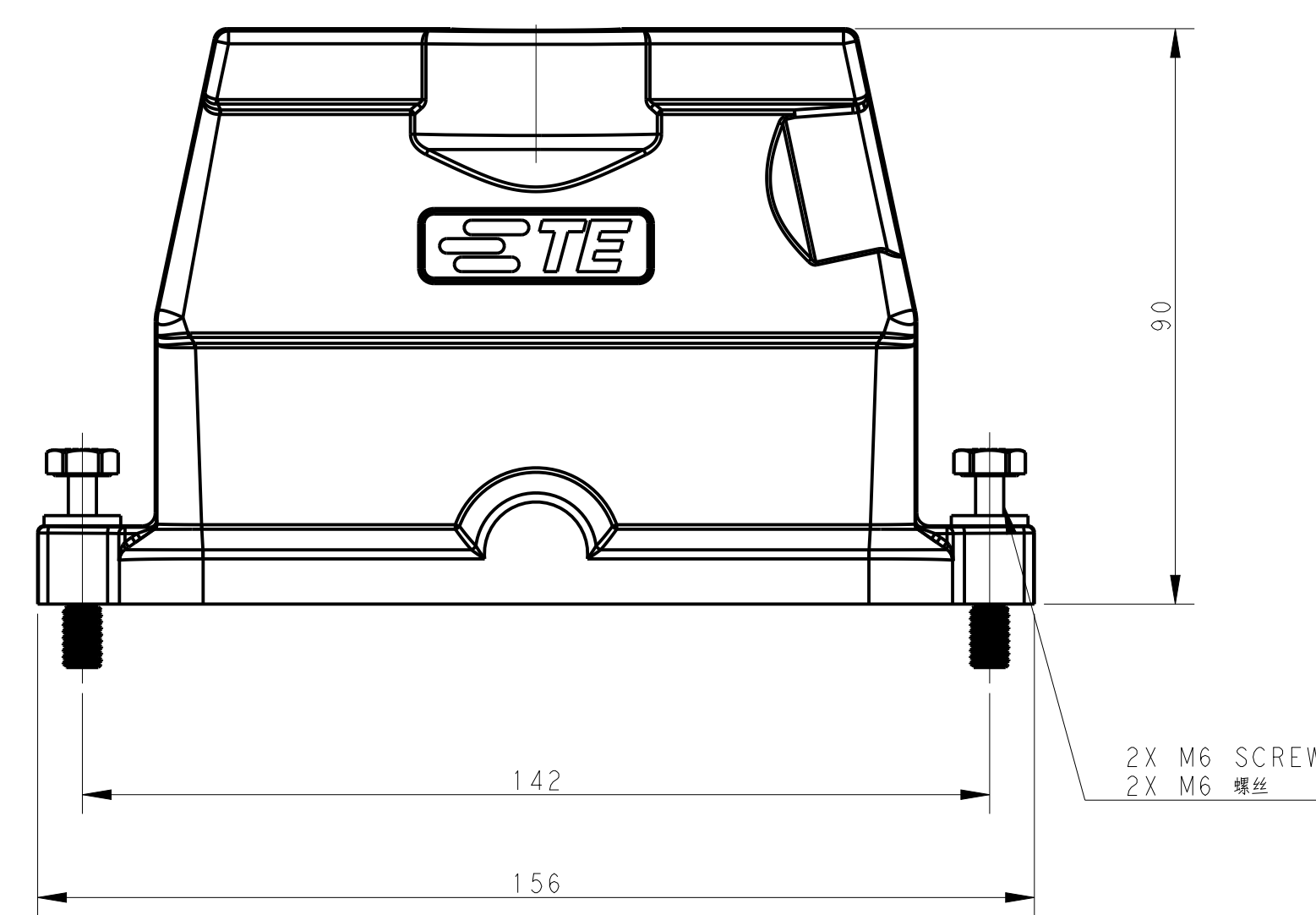
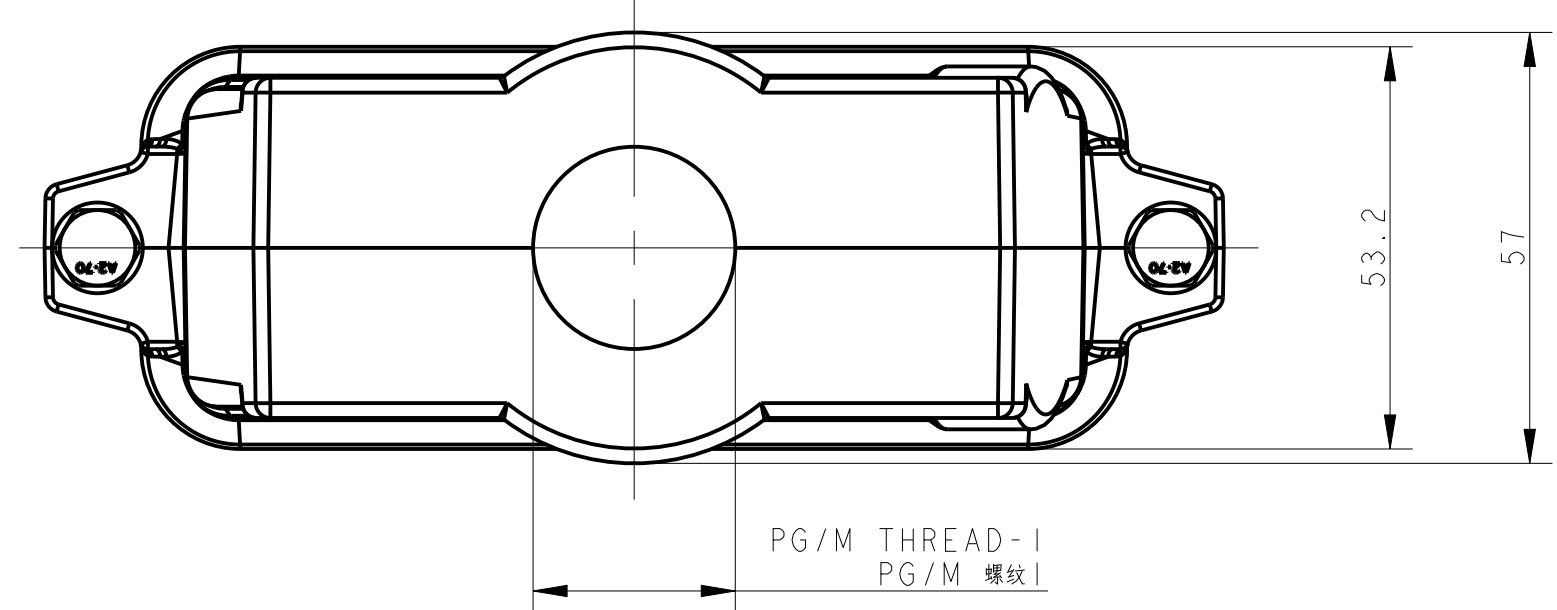

### TYPE 2 类型 2

Two PG/M threads & With nonconductive seal  
两个PG/M螺纹孔带非导电密封圈

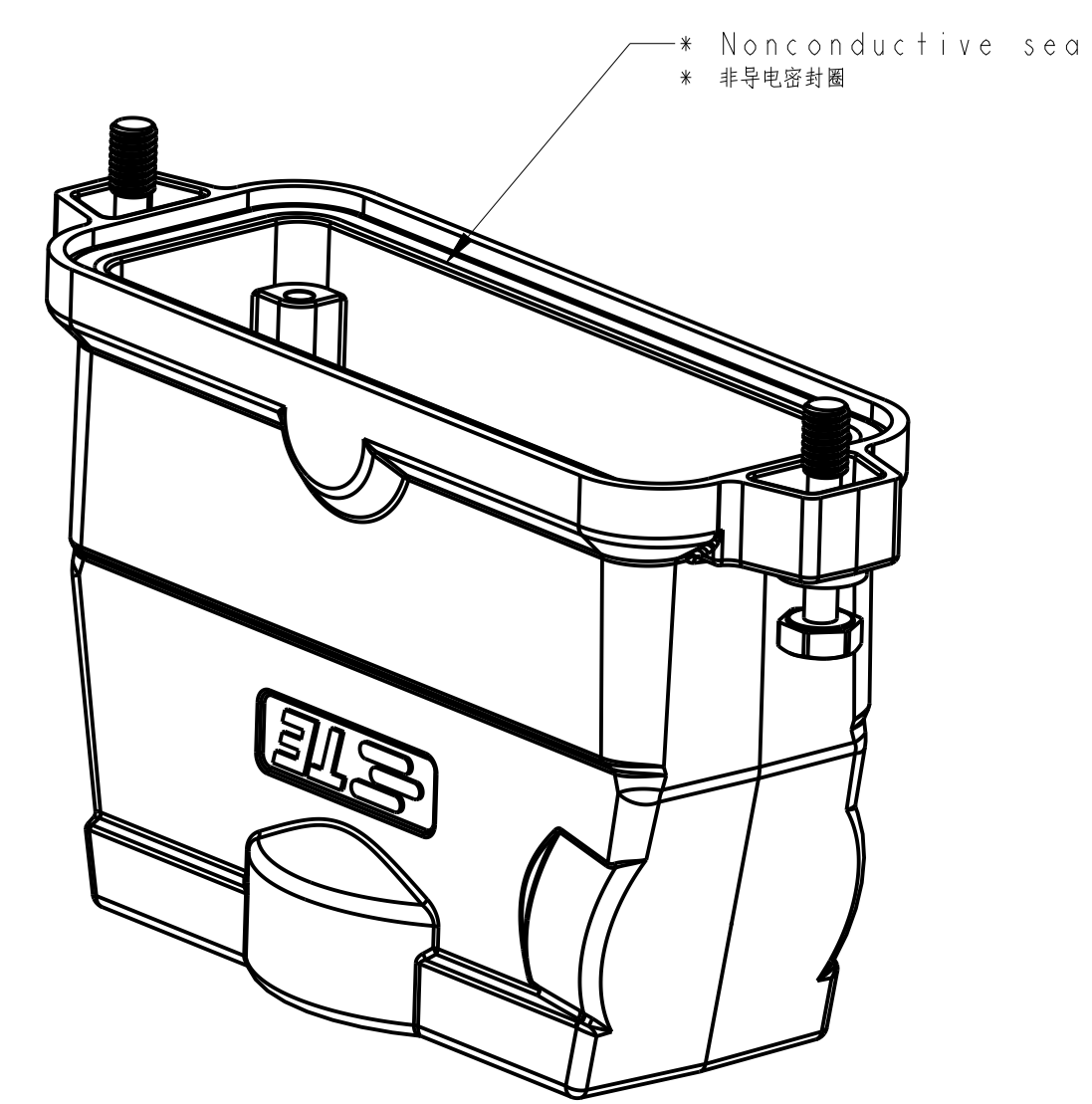
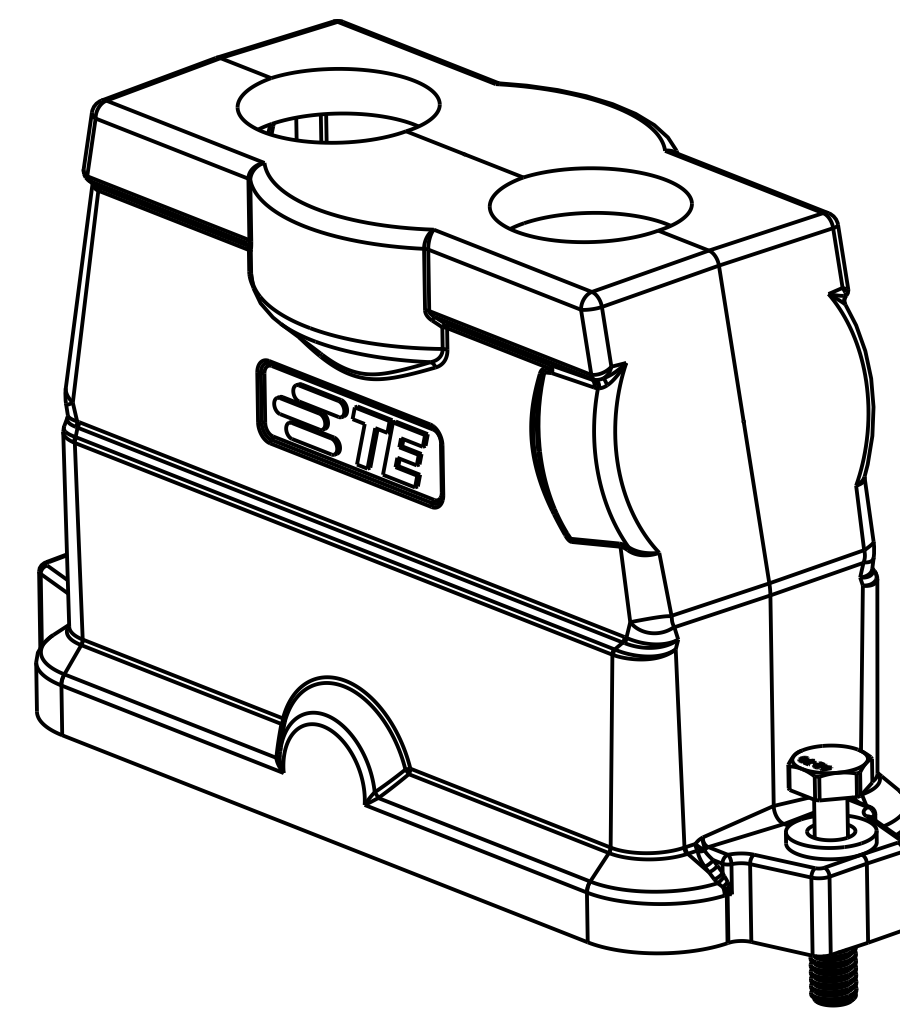
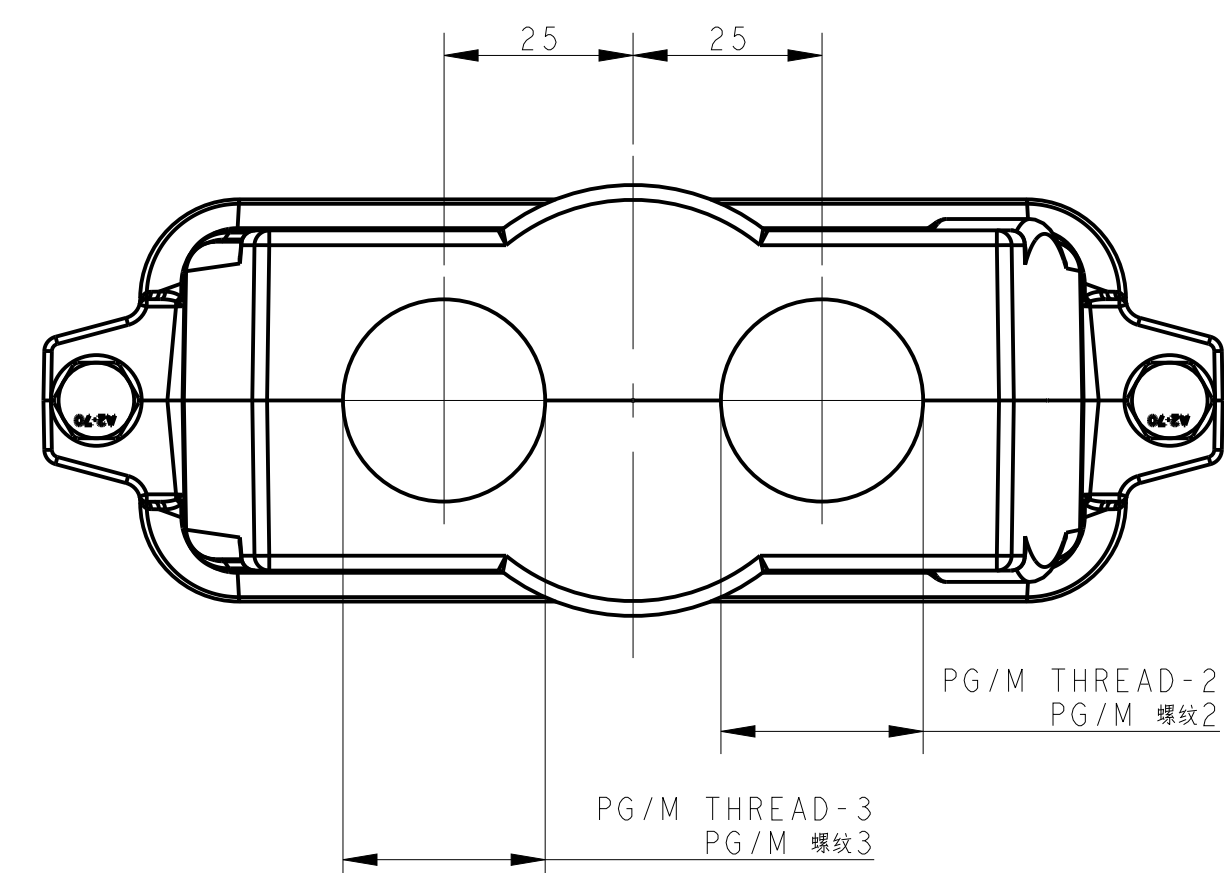

All dimension is same as TYPE 1, except those defined in this TYPE  
除了在本类型中定义的尺寸外, 其他尺寸同类型 1

### TYPE 4 类型 4

Single PG/M thread & With nonconductive seal, No logo  
单PG/M螺纹孔带非导电密封圈, 无Logo

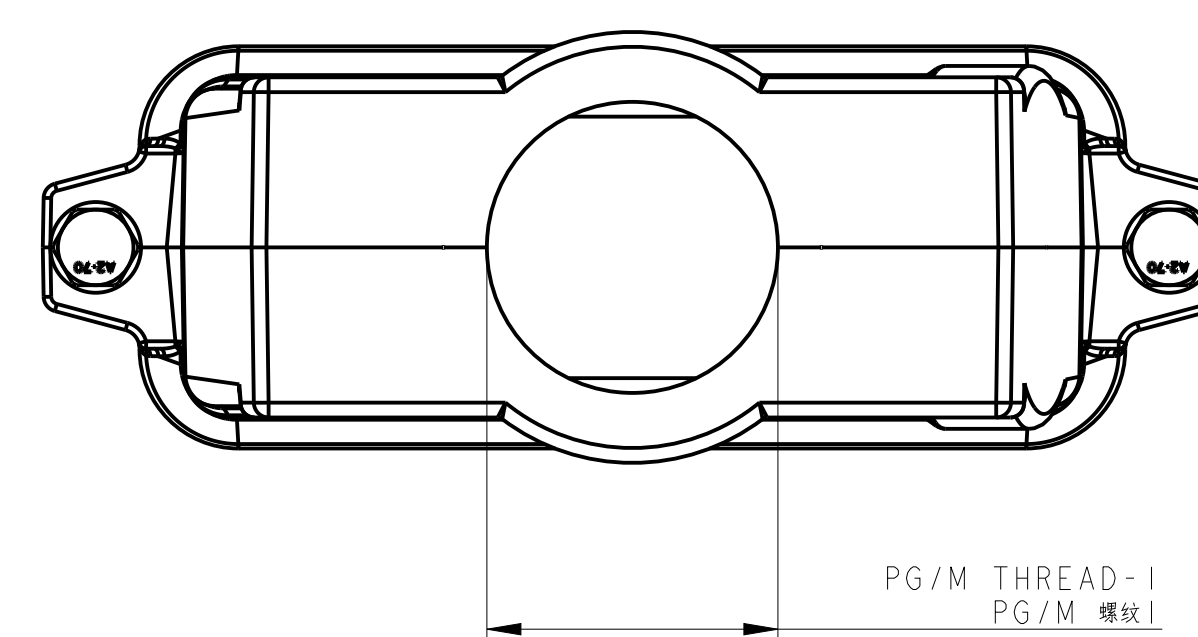

All dimension is same as TYPE 1, except those defined in this TYPE  
除了在本类型中定义的尺寸外, 其他尺寸同类型 1

### TYPE 3 类型 3

Single PG/M thread & With conductive seal  
单PG/M螺纹孔带导电密封圈

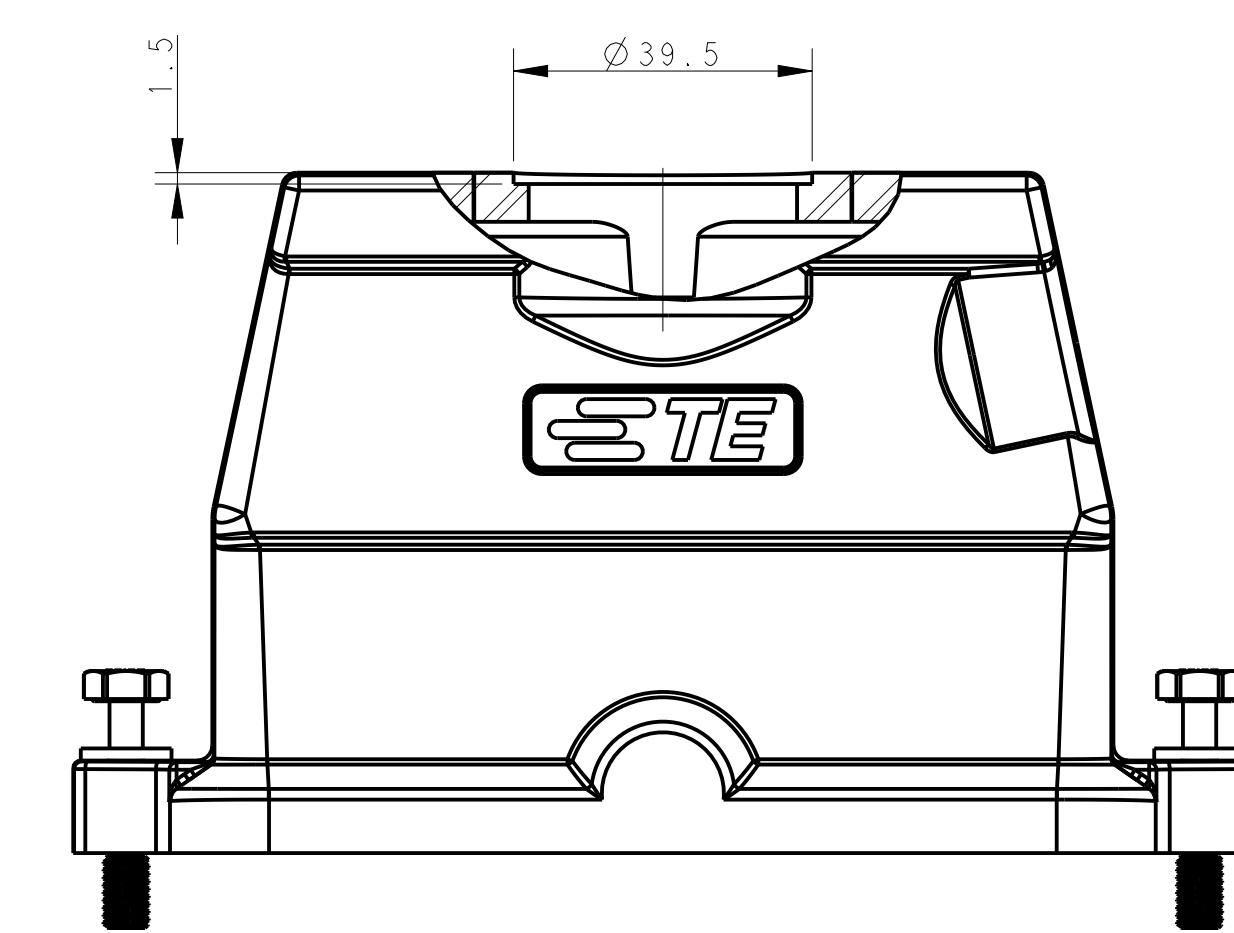
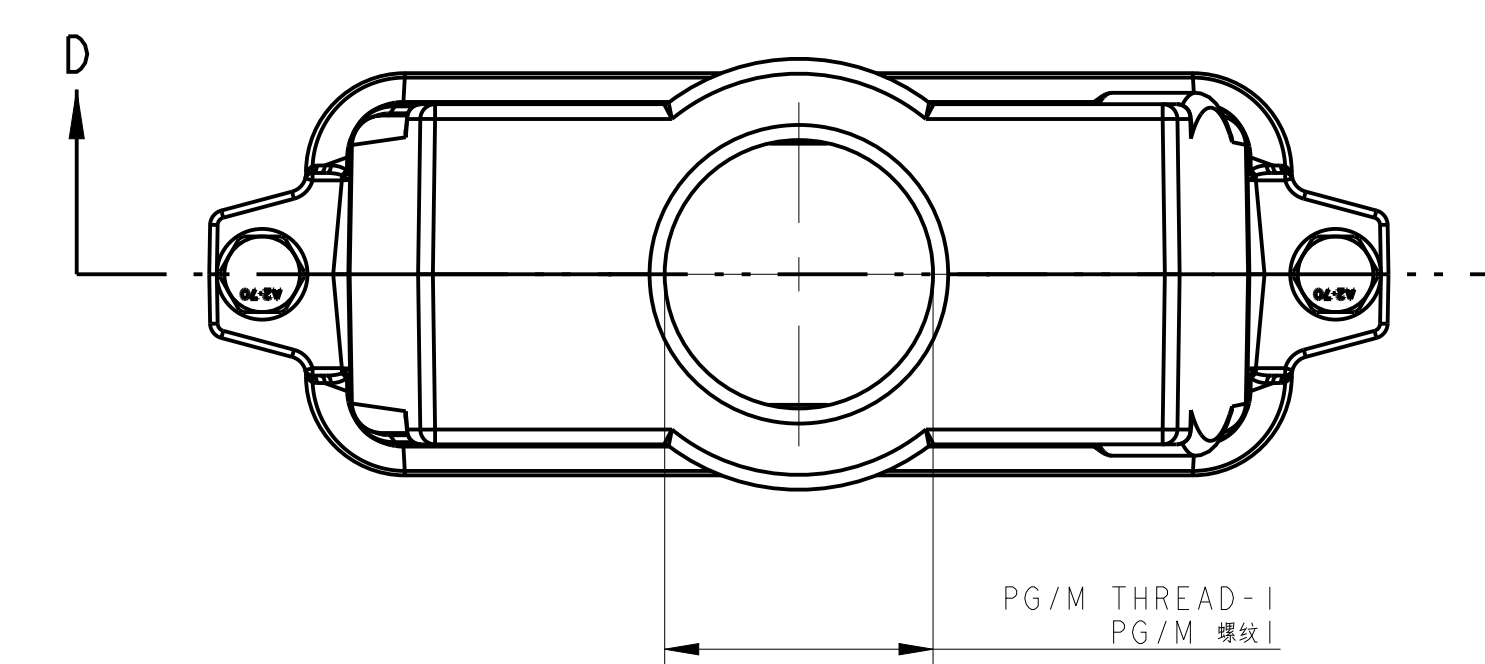

All dimension is same as TYPE 1, except those defined in this TYPE  
除了在本类型中定义的尺寸外, 其他尺寸同类型 1

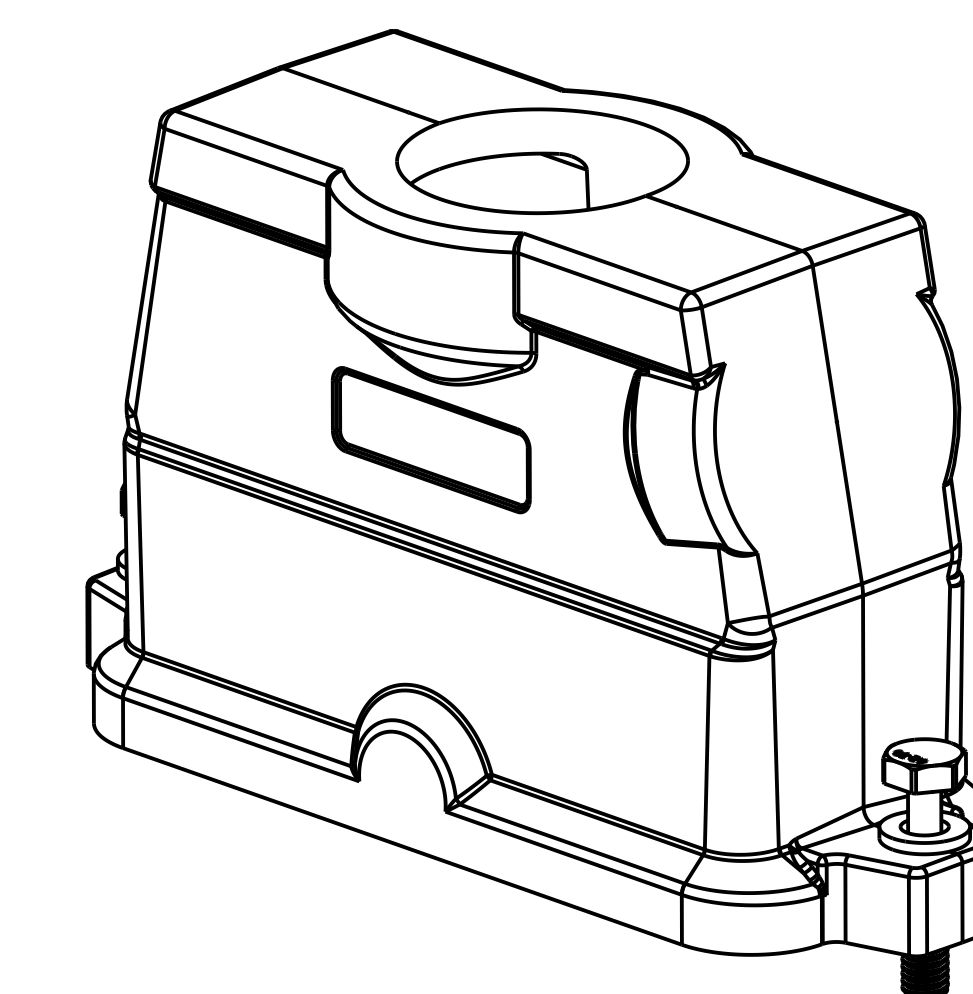
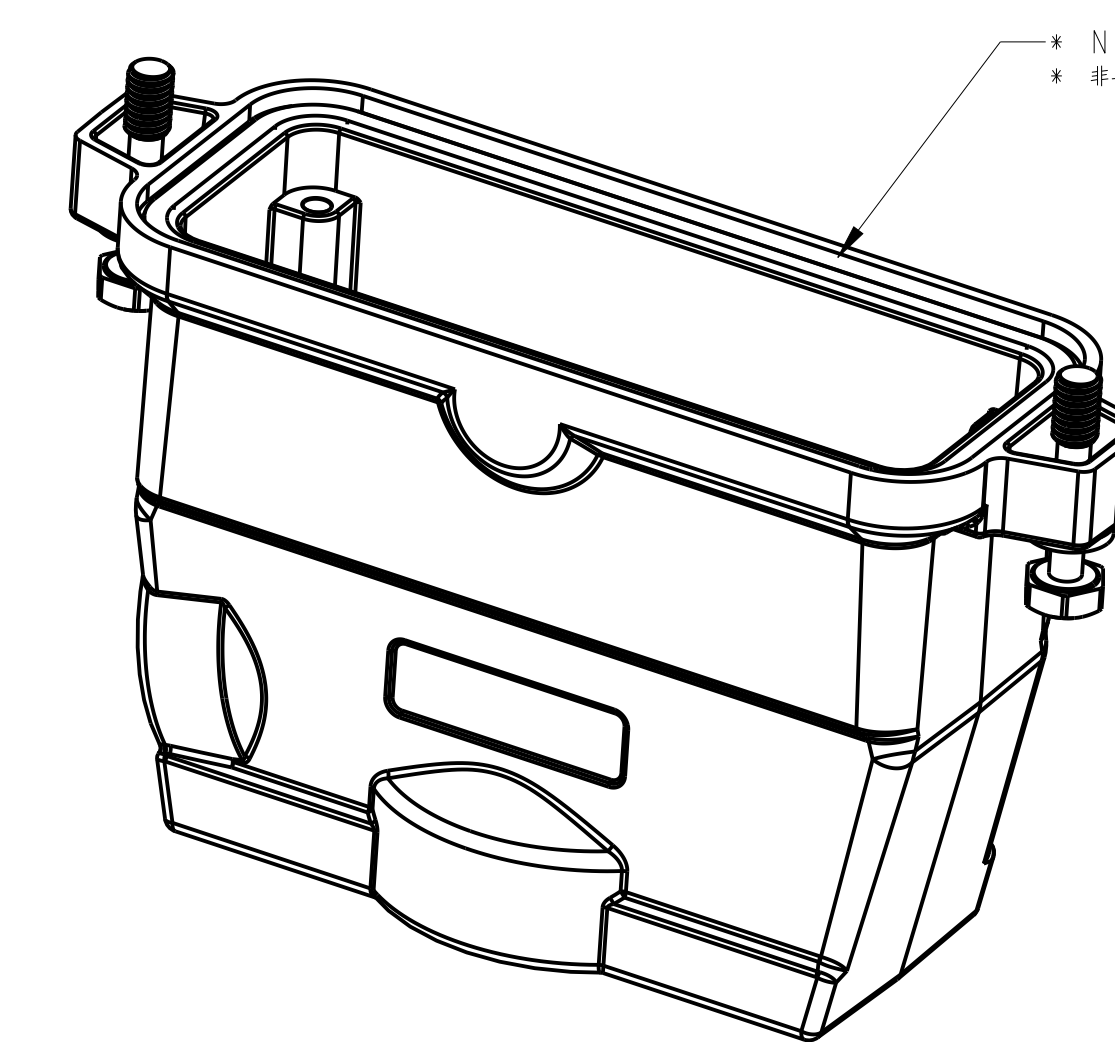
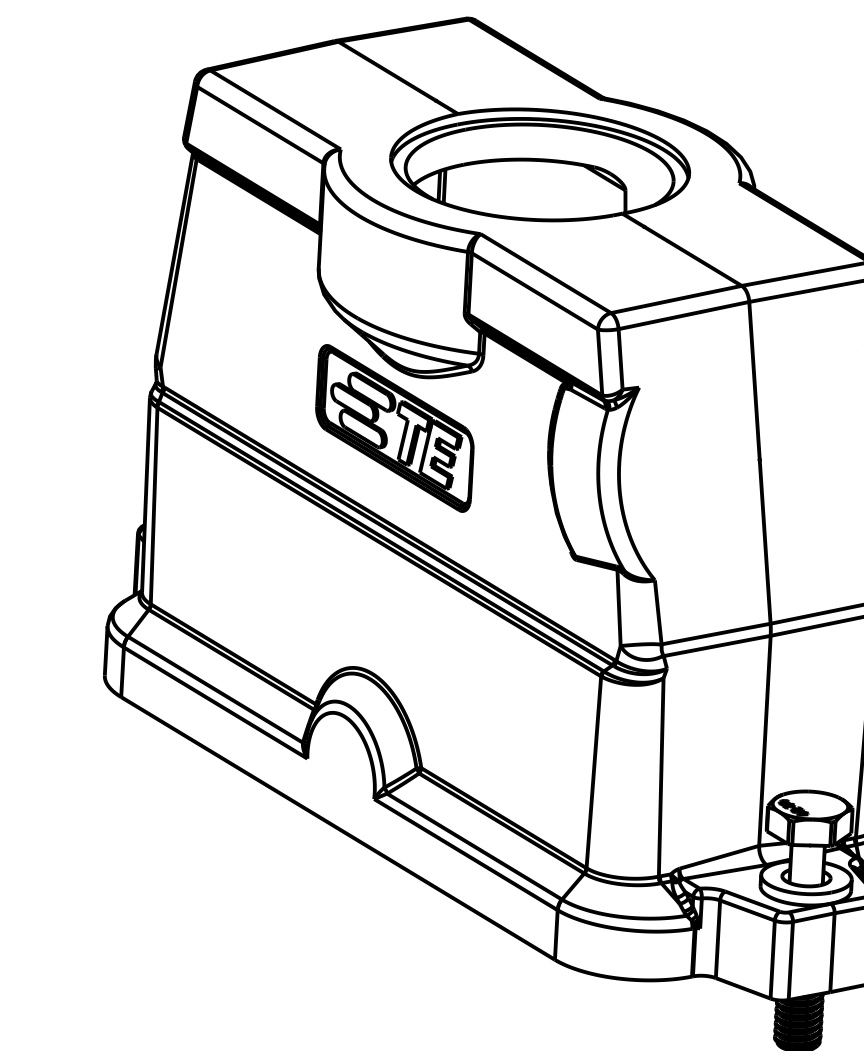
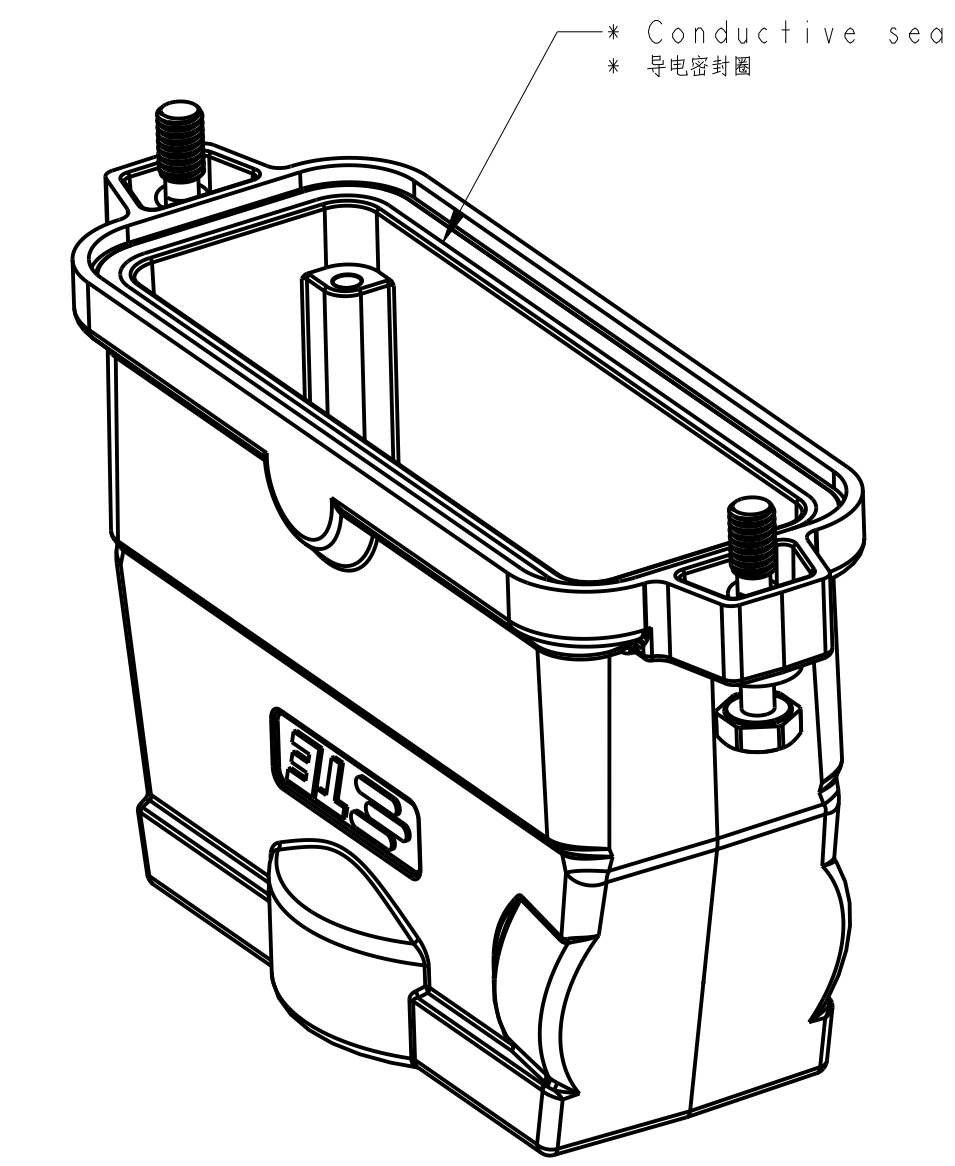

| REVISIONS |          |               |    |      |
|-----------|----------|---------------|----|------|
| REV       | DATE     | DESCRIPTION   | BY | APPD |
| B3        | 20180318 | ECR-18-009564 | CD | CW   |
| B4        | 20180318 | ECR-18-017123 | KW | CW   |
| B5        | 20180318 | ECR-19-006656 | CD | CW   |
| B6        | 20180318 | ECR-19-007133 | BS | CW   |

|  |  |                   |        |         |                    |                                |
|--|--|-------------------|--------|---------|--------------------|--------------------------------|
| THIS DRAWING IS A CONTROLLED DOCUMENT. |  | DATE: 16 JUN 2015 | REV: 0 | BY: PLC | APPD: Y. Liang, Y. | PRODUCT SPEC: H24BPR-TGHC-PG/M |
| DIMENSIONS:                            |  | DATE: 16 JUN 2015 | REV: 1 | BY: PLC | APPD: Y. Liang, Y. | PRODUCT SPEC: H24BPR-TGHC-PG/M |
| MATERIAL:                              |  | DATE: 16 JUN 2015 | REV: 2 | BY: PLC | APPD: Y. Liang, Y. | PRODUCT SPEC: H24BPR-TGHC-PG/M |
| FINISH:                                |  | DATE: 16 JUN 2015 | REV: 3 | BY: PLC | APPD: Y. Liang, Y. | PRODUCT SPEC: H24BPR-TGHC-PG/M |
| CUSTOMER DRAWING                       |  | DATE: 16 JUN 2015 | REV: 4 | BY: PLC | APPD: Y. Liang, Y. | PRODUCT SPEC: H24BPR-TGHC-PG/M |

| REVISIONS |             |    |      |
|-----------|-------------|----|------|
| REV       | DATE        | BY | APPD |
| 1         | SEE SHEET 1 |    |      |

### TYPE 5 类型5

Two PG/M threads & With nonconductive seal, No Logo  
 两个PG/M螺柱孔及带有非导电密封胶, 无Logo

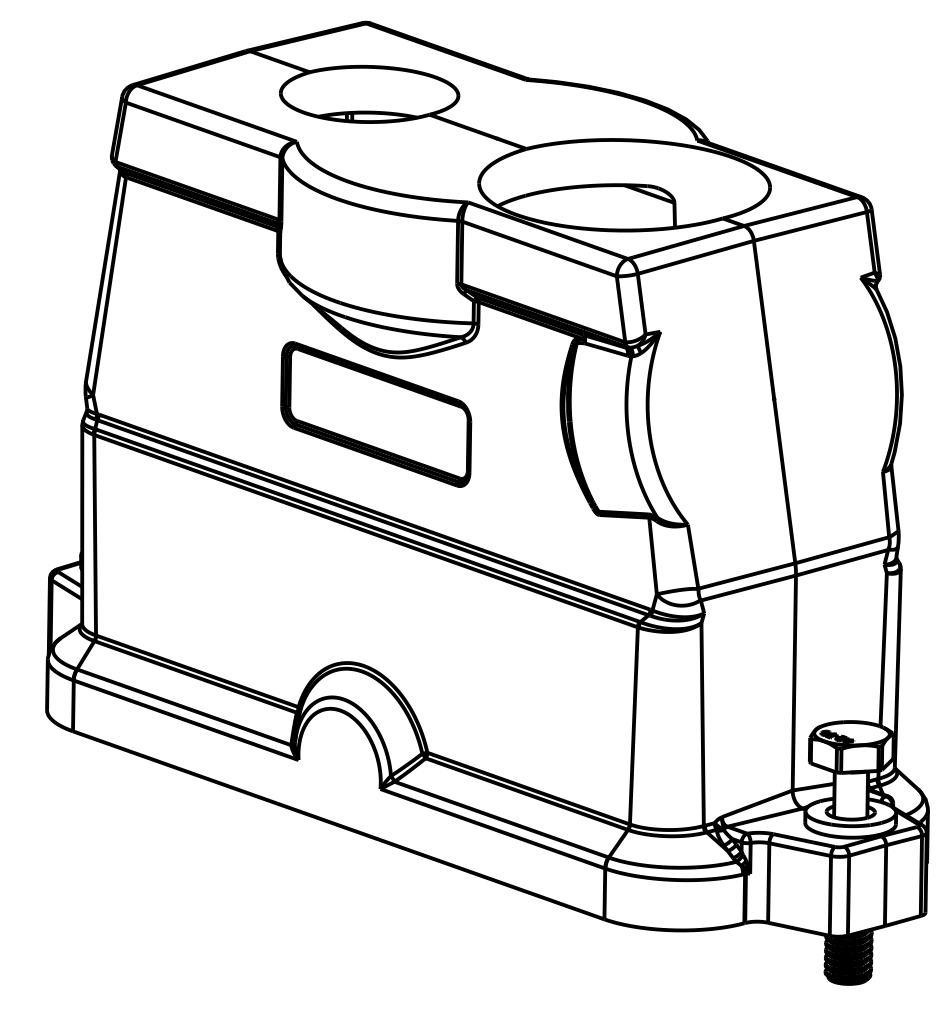
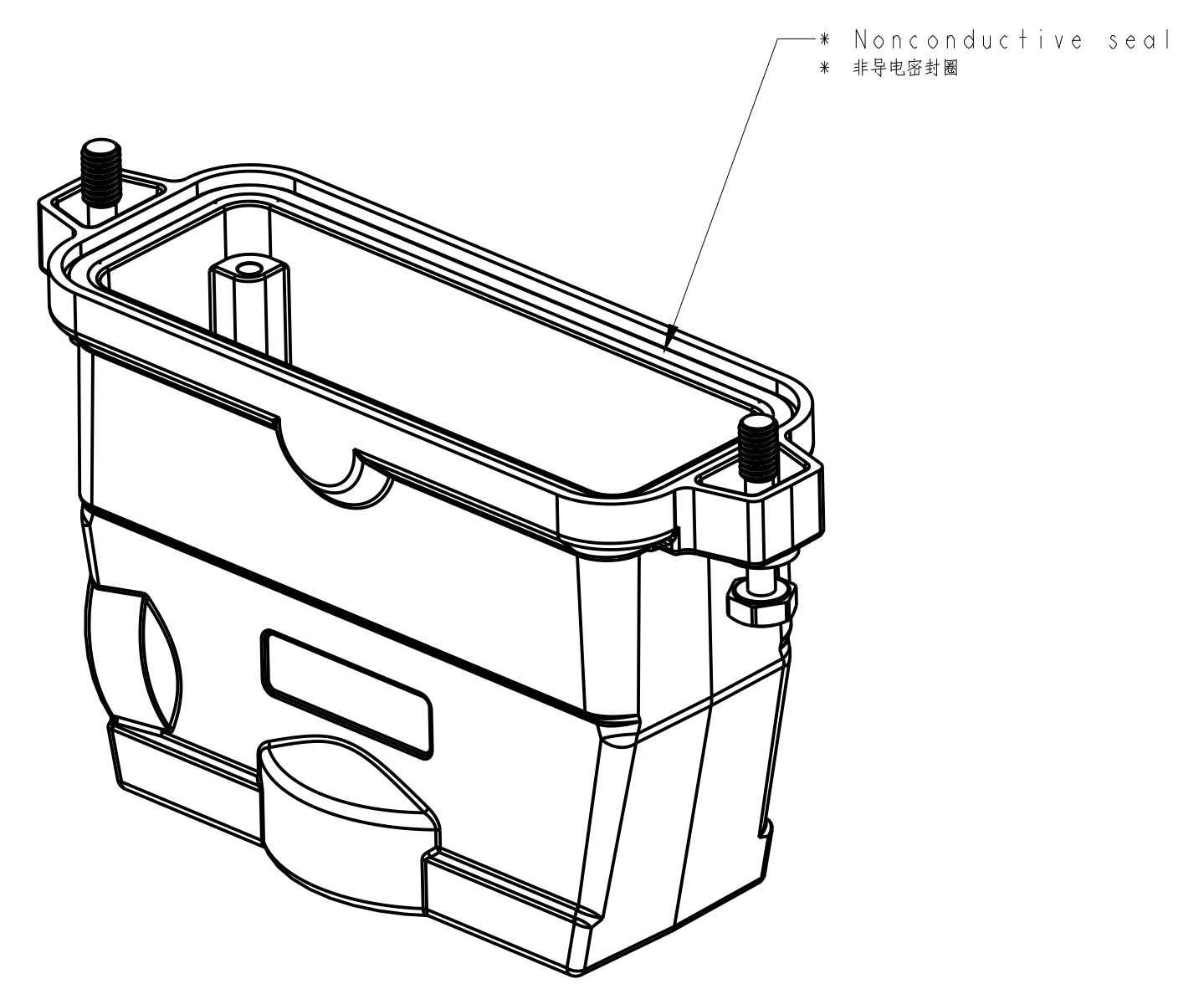
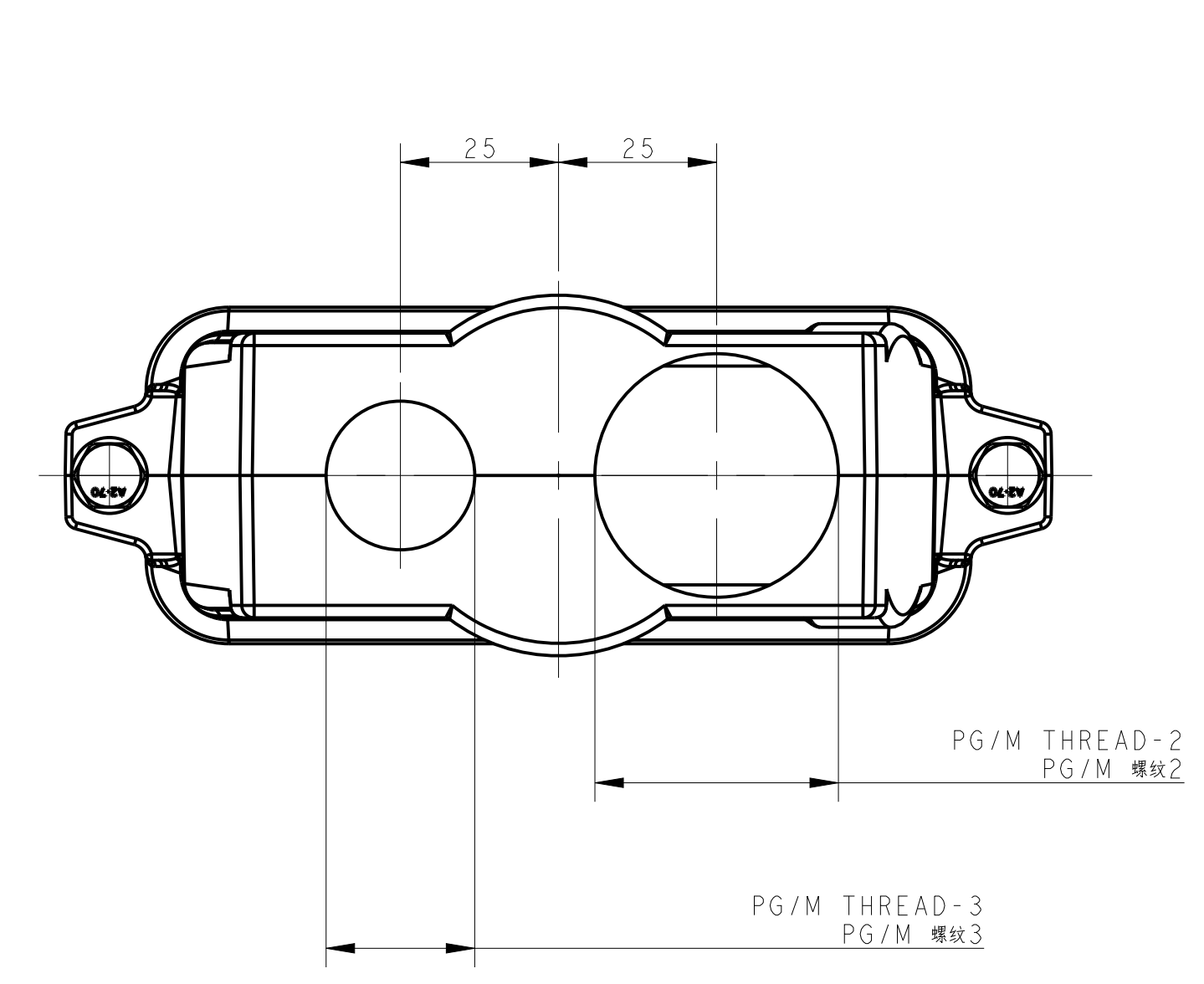

NOTES:  
 1. TECHNICAL CHARACTERISTICS:  
 HOOD MATERIAL: DIE CAST ALUMINIUM ALLOY  
 SURFACE TREATMENT: SEE TABLE  
 DEGREE OF PROTECTION: IP68 (MATED)

注:  
 1. 技术参数:  
 壳体材料: 铝合金  
 表面处理: 见表格  
 防护等级: IP68 (配合)

All dimension is same as TYPE 1, except those defined in this TYPE  
 除了在本类型中定义的尺寸外, 其他尺寸同类型1

### TYPE 6 类型6

Two PG/M threads & With nonconductive seal & Minus screw  
 两个PG/M螺柱孔及带有非导电密封胶及一字槽螺柱

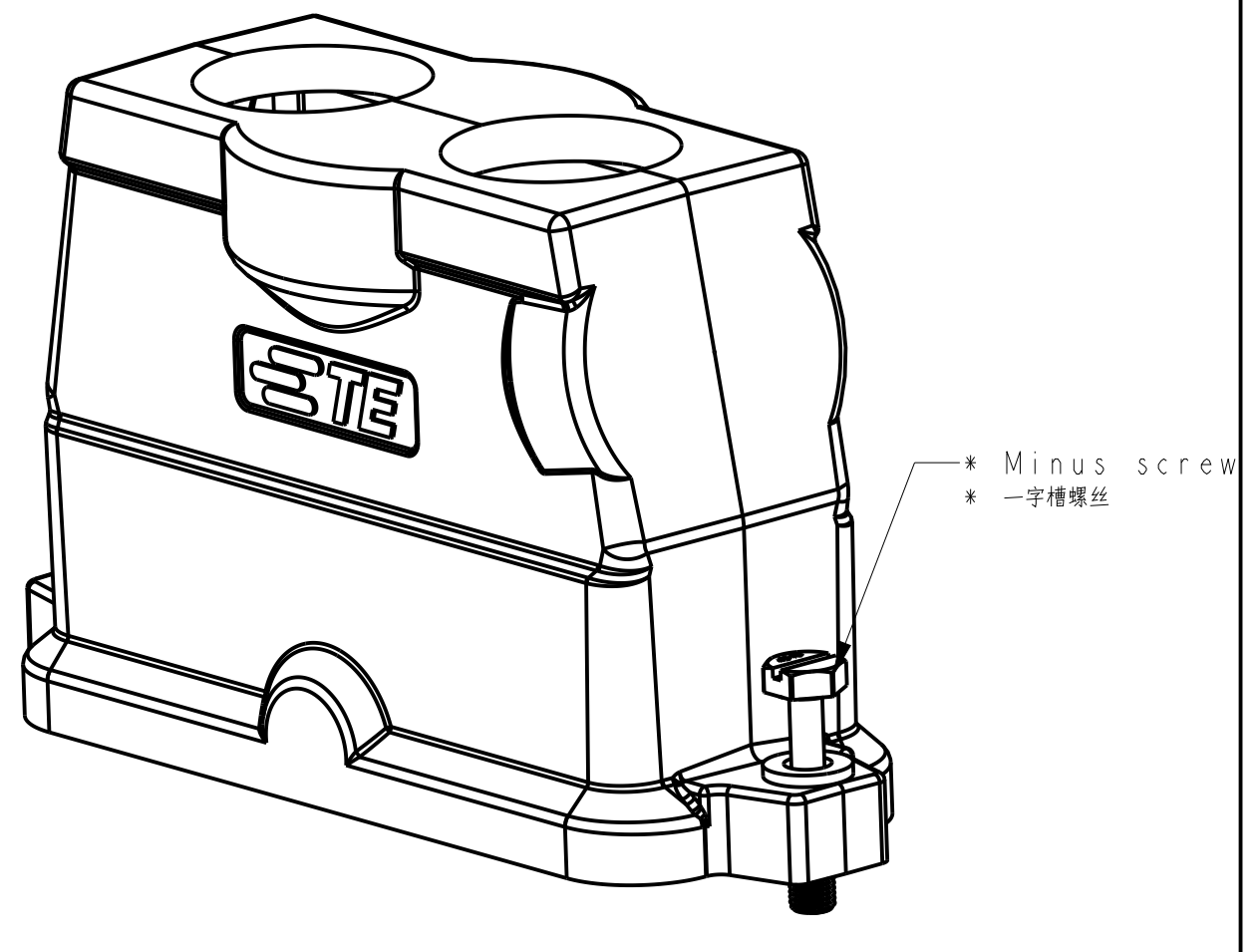
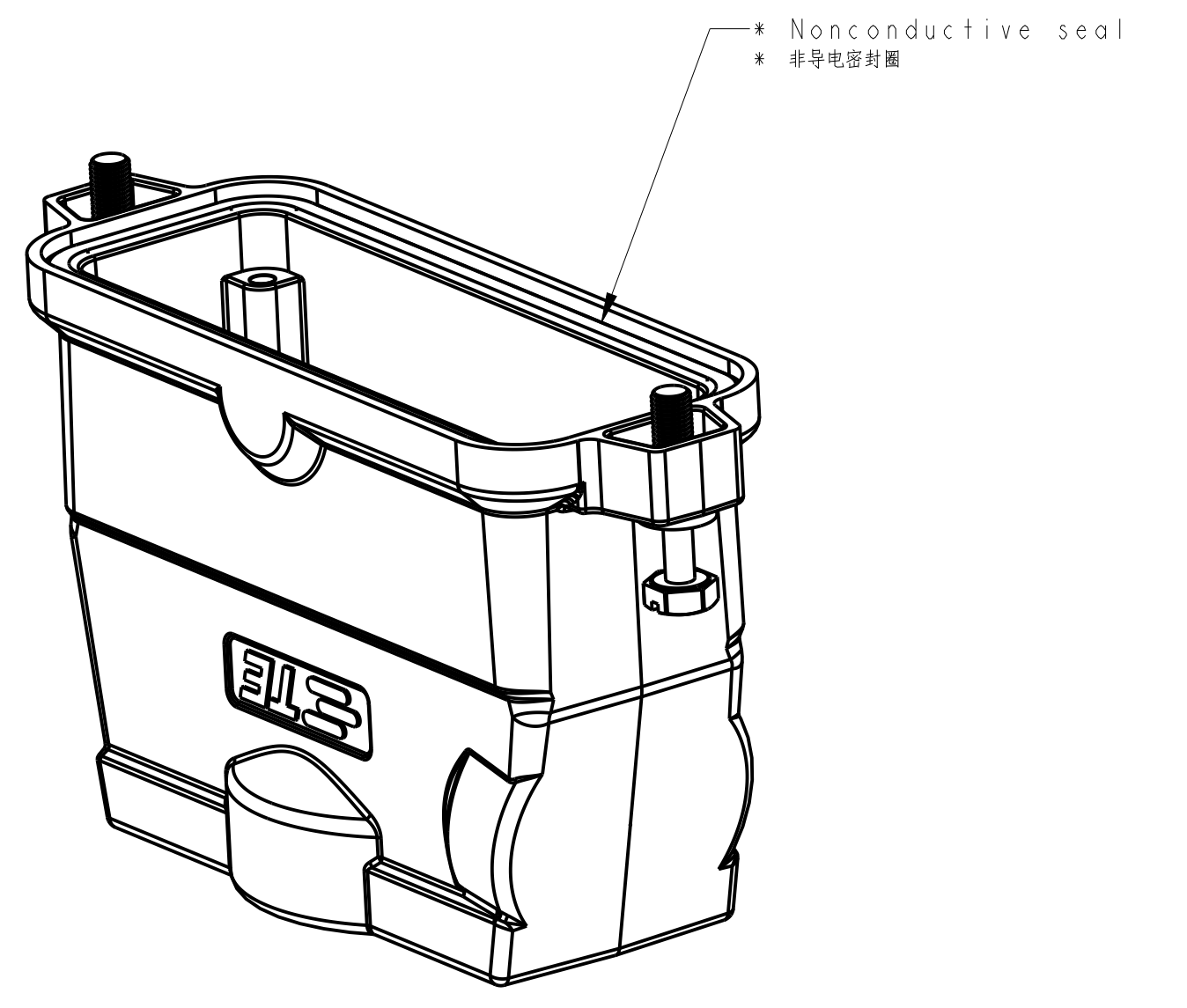
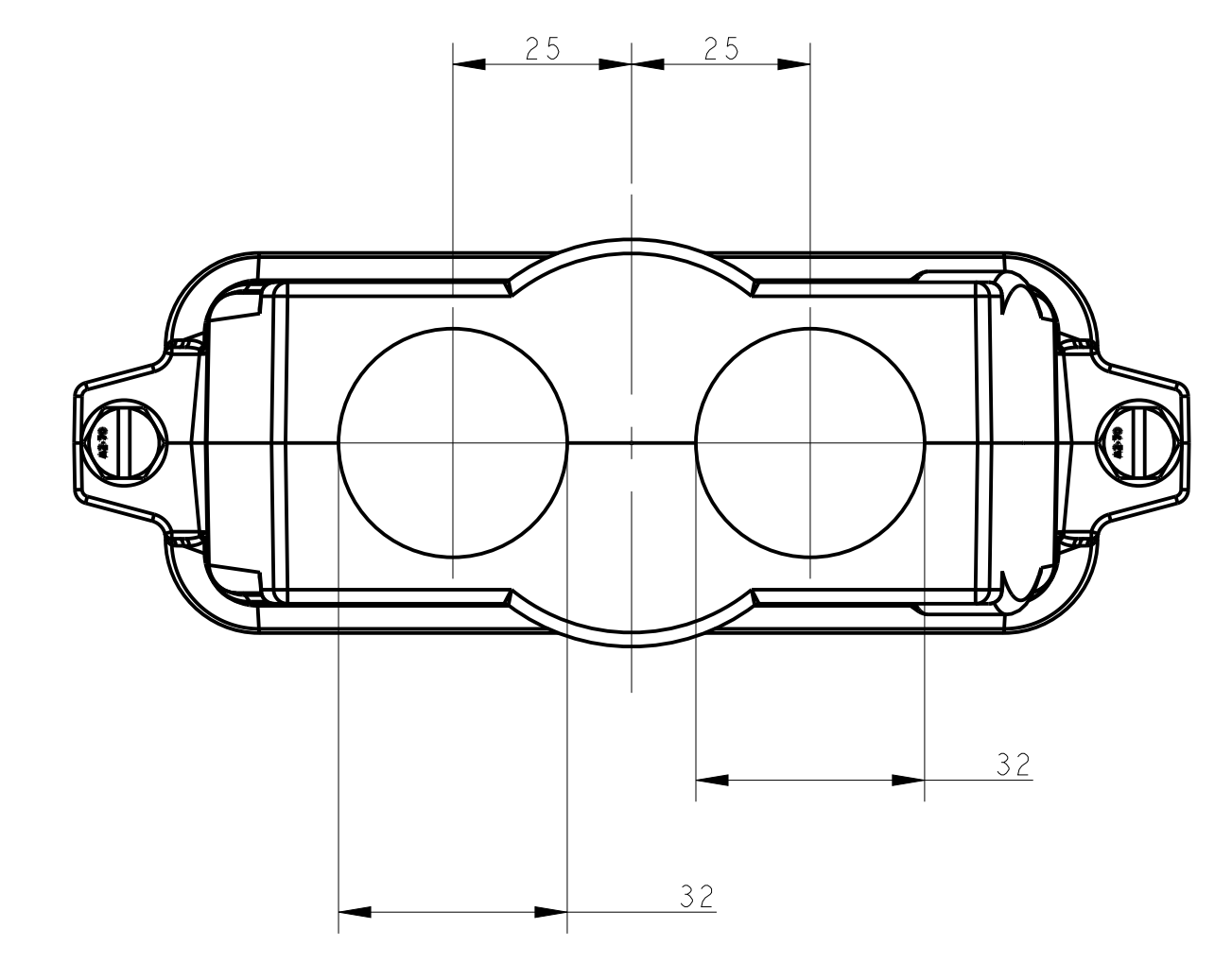

All dimension is same as TYPE 1, except those defined in this TYPE  
 除了在本类型中定义的尺寸外, 其他尺寸同类型1

| TYPE 6  | TYPE 4              | TYPE 5   | TYPE 3 | TYPE 2 | TYPE 1 |
|---|---------------------|--|--------|--------|--------|
| T1922242232-000<br>POWDER COATED, GREY<br>表面喷涂, 灰色          | H24BPR-TGHC-2M32    | H24BPR HOOD, CENTER LOCKING, MINUS SCREW, TOP ENTRY 2M32, POWDER COATED, GREY<br>H24BPR上盖, 中翻锁, 一字槽螺柱, 顶出2M32, 灰色粉末喷涂                                      | M32    | M32    | -      |
| T1922242125-001<br>POWDER COATED, DEEP GREY<br>表面喷涂, 深灰色    | H24BPR-TGHC-M25     | H24BPR HOOD, CENTER LOCKING, TOP ENTRY M25, POWDER COATED, DEEP GREY, NO LOGO<br>H24BPR上盖, 中翻锁, 顶出M25, 深灰色粉末喷涂, 无LOGO                                      | -      | -      | M25    |
| T1922242132-001<br>POWDER COATED, DEEP GREY<br>表面喷涂, 深灰色    | H24BPR-TGHC-M32     | H24BPR HOOD, CENTER LOCKING, TOP ENTRY M32, POWDER COATED, DEEP GREY, NO LOGO<br>H24BPR上盖, 中翻锁, 顶出M32, 深灰色粉末喷涂, 无LOGO                                      | -      | -      | M32    |
| T1922242150-001<br>POWDER COATED, DEEP GREY<br>表面喷涂, 深灰色    | H24BPR-TGHC-M50     | H24BPR HOOD, CENTER LOCKING, TOP ENTRY M50, POWDER COATED, DEEP GREY, NO LOGO<br>H24BPR上盖, 中翻锁, 顶出M50, 深灰色粉末喷涂, 无LOGO                                      | -      | -      | M50    |
| T1922242140-001<br>POWDER COATED, DEEP GREY<br>表面喷涂, 深灰色    | H24BPR-TGHC-M40     | H24BPR HOOD, CENTER LOCKING, TOP ENTRY M40, POWDER COATED, DEEP GREY, NO LOGO<br>H24BPR上盖, 中翻锁, 顶出M40, 深灰色粉末喷涂, 无LOGO                                      | -      | -      | M40    |
| T1922244025-001<br>POWDER COATED, DEEP GREY<br>表面喷涂, 深灰色    | H24BPR-TGHC-M40/M25 | H24BPR HOOD, CENTER LOCKING, TOP ENTRY M40/M25, POWDER COATED, DEEP GREY, NO LOGO<br>H24BPR上盖, 中翻锁, 顶出M40/M25, 深灰色粉末喷涂, 无LOGO                              | M25    | M40    | -      |
| T1922241129-001<br>POWDER COATED, SILVER WHITE<br>表面喷涂, 银白色 | H24BPR-TGHC-PG29    | H24BPR HOOD, CENTER LOCKING, TOP ENTRY PG29, POWDER COATED, SILVER WHITE, CONDUCTIVE, THREAD HOLE WITH STEP<br>H24BPR上盖, 中翻锁, 顶出PG29, 银白色粉末喷涂, 导电孔, 螺纹孔带台阶 | -      | -      | PG29   |
| T1922240129-001<br>POWDER COATED, BLACK<br>表面喷涂, 黑色         | H24BPR-TGHC-PG29    | H24BPR HOOD, CENTER LOCKING, TOP ENTRY PG29, POWDER COATED, BLACK, CONDUCTIVE, THREAD HOLE WITH STEP<br>H24BPR上盖, 中翻锁, 顶出PG29, 黑色粉末喷涂, 导电孔, 螺纹孔带台阶         | -      | -      | PG29   |
| T1922241221-000<br>POWDER COATED, SILVER WHITE<br>表面喷涂, 银白色 | H24BPR-TGHC-2PG21   | H24BPR HOOD, CENTER LOCKING, TOP ENTRY 2PG21, POWDER COATED, SILVER WHITE<br>H24BPR上盖, 中翻锁, 顶出2PG21, 银白色粉末喷涂   | PG21   | PG21   | -      |
| T1922241232-000<br>POWDER COATED, SILVER WHITE<br>表面喷涂, 银白色 | H24BPR-TGHC-M32/M25 | H24BPR HOOD, CENTER LOCKING, TOP ENTRY M32/M25, POWDER COATED, SILVER WHITE<br>H24BPR上盖, 中翻锁, 顶出M32/M25, 银白色粉末喷涂   | M25    | M32    | -      |
| T1922244025-000<br>POWDER COATED, SILVER WHITE<br>表面喷涂, 银白色 | H24BPR-TGHC-M40/M25 | H24BPR HOOD, CENTER LOCKING, TOP ENTRY M40/M25, POWDER COATED, SILVER WHITE<br>H24BPR上盖, 中翻锁, 顶出M40/M25, 银白色粉末喷涂   | M25    | M40    | -      |
| T1922241140-000<br>POWDER COATED, SILVER WHITE<br>表面喷涂, 银白色 | H24BPR-TGHC-M40     | H24BPR HOOD, CENTER LOCKING, TOP ENTRY M40, POWDER COATED, SILVER WHITE<br>H24BPR上盖, 中翻锁, 顶出M40, 银白色粉末喷涂   | -      | -      | M40    |
| T1922241136-000<br>POWDER COATED, SILVER WHITE<br>表面喷涂, 银白色 | H24BPR-TGHC-PG36    | H24BPR HOOD, CENTER LOCKING, TOP ENTRY PG36, POWDER COATED, SILVER WHITE<br>H24BPR上盖, 中翻锁, 顶出PG36, 银白色粉末喷涂   | -      | -      | PG36   |
| T1922241132-000<br>POWDER COATED, SILVER WHITE<br>表面喷涂, 银白色 | H24BPR-TGHC-M32     | H24BPR HOOD, CENTER LOCKING, TOP ENTRY M32, POWDER COATED, SILVER WHITE<br>H24BPR上盖, 中翻锁, 顶出M32, 银白色粉末喷涂   | -      | -      | M32    |
| T1922241129-000<br>POWDER COATED, SILVER WHITE<br>表面喷涂, 银白色 | H24BPR-TGHC-PG29    | H24BPR HOOD, CENTER LOCKING, TOP ENTRY PG29, POWDER COATED, SILVER WHITE<br>H24BPR上盖, 中翻锁, 顶出PG29, 银白色粉末喷涂   | -      | -      | PG29   |
| T1922241125-000<br>POWDER COATED, SILVER WHITE<br>表面喷涂, 银白色 | H24BPR-TGHC-M25     | H24BPR HOOD, CENTER LOCKING, TOP ENTRY M25, POWDER COATED, SILVER WHITE<br>H24BPR上盖, 中翻锁, 顶出M25, 银白色粉末喷涂   | -      | -      | M25    |
| T1922240121-000<br>POWDER COATED, SILVER WHITE<br>表面喷涂, 银白色 | H24BPR-TGHC-PG21    | H24BPR HOOD, CENTER LOCKING, TOP ENTRY PG21, POWDER COATED, SILVER WHITE<br>H24BPR上盖, 中翻锁, 顶出PG21, 银白色粉末喷涂   | -      | -      | PG21   |
| T1922240140-000<br>POWDER COATED, BLACK<br>表面喷涂, 黑色         | H24BPR-TGHC-M40     | H24BPR HOOD, CENTER LOCKING, TOP ENTRY M40, POWDER COATED, BLACK<br>H24BPR上盖, 中翻锁, 顶出M40, 黑色粉末喷涂   | -      | -      | M40    |
| T1922240136-000<br>POWDER COATED, BLACK<br>表面喷涂, 黑色         | H24BPR-TGHC-PG36    | H24BPR HOOD, CENTER LOCKING, TOP ENTRY PG36, POWDER COATED, BLACK<br>H24BPR上盖, 中翻锁, 顶出PG36, 黑色粉末喷涂   | -      | -      | PG36   |
| T1922240132-000<br>POWDER COATED, BLACK<br>表面喷涂, 黑色         | H24BPR-TGHC-M32     | H24BPR HOOD, CENTER LOCKING, TOP ENTRY M32, POWDER COATED, BLACK<br>H24BPR上盖, 中翻锁, 顶出M32, 黑色粉末喷涂   | -      | -      | M32    |
| T1922240129-000<br>POWDER COATED, BLACK<br>表面喷涂, 黑色         | H24BPR-TGHC-PG29    | H24BPR HOOD, CENTER LOCKING, TOP ENTRY PG29, POWDER COATED, BLACK<br>H24BPR上盖, 中翻锁, 顶出PG29, 黑色粉末喷涂   | -      | -      | PG29   |
| T1922240125-000<br>POWDER COATED, BLACK<br>表面喷涂, 黑色         | H24BPR-TGHC-M25     | H24BPR HOOD, CENTER LOCKING, TOP ENTRY M25, POWDER COATED, BLACK<br>H24BPR上盖, 中翻锁, 顶出M25, 黑色粉末喷涂   | -      | -      | M25    |
| T1922240121-000<br>POWDER COATED, BLACK<br>表面喷涂, 黑色         | H24BPR-TGHC-PG21    | H24BPR HOOD, CENTER LOCKING, TOP ENTRY PG21, POWDER COATED, BLACK<br>H24BPR上盖, 中翻锁, 顶出PG21, 黑色粉末喷涂   | -      | -      | PG21   |

|  |  |                   |           |                              |          |                            |                   |                                     |         |
|--|--|-------------------|-----------|------------------------------|----------|----------------------------|-------------------|-------------------------------------|---------|
| THIS DRAWING IS A CONTROLLED DOCUMENT. |  | DATE: 16 JUN 2015 | REV: 0    | BY: CMC                      | CHK: CMC | APPD: Y. Wang              | DATE: 16 JUN 2015 | TE Connectivity<br>H24BPR-TGHC-PG/M |         |
| DIMENSIONS: (mm)                       |  | 0 P L C           | 1 P L C   | 2 P L C                      | 3 P L C  | 4 P L C                    | 5 P L C           | 6 P L C                             | 7 P L C |
| MATERIAL: -                            |  | FINISH: -         | WEIGHT: - | APPLICATION SPEC: 114-137014 |          | REVISION: 114-137014       |                   | CUSTOMER DRAWING                    |         |
| SCALE: 1:1                             |  | SHEET: 2 of 2     |           | REV: B6                      |          | PART NUMBER: PG/M THREAD-3 |                   | TYPE: 类型6                           |         |