

Ultra Low Capacitance Bidirectional Symmetrical (BiSy) Single Line ESD Protection Diode in Silicon Package

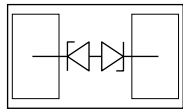

22543

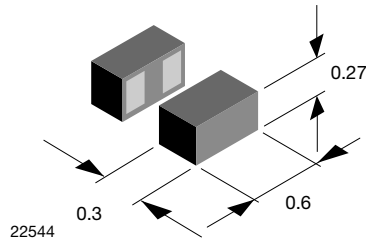

22544

MARKING

(example only)

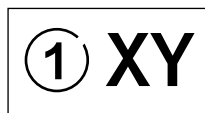

22454

1 = year code

Open circle = month code and pin 1

XY = type code

DESIGN SUPPORT TOOLS click logo to get started

FEATURES

- Ultra compact CLP0603 package
- Low package height < 0.3 mm
- 1-line ESD protection
- AEC-Q101 qualified available
- Working range ± 3.3 V
- Low leakage current < 0.05 μ A
- Ultra low load capacitance $C_D = 0.29$ pF typ.
- ESD immunity acc. IEC 61000-4-2
 ± 16 kV contact discharge
 ± 16 kV air discharge
- Lead plating: Au (e4)
- Lead material: Ni
- Backside coating
- Material categorization: for definitions of compliance please see www.vishay.com/doc?99912

ORDERING INFORMATION

PART NUMBER (EXAMPLE)	ENVIRONMENTAL AND QUALITY CODE			PACKAGING CODE 15K PER 7" REEL (8 mm TAPE) 15K/BOX = MOQ	ORDERING CODE (EXAMPLE)
	AEC-Q101 QUALIFIED	RoHS-COMPLIANT + LEAD (Pb)-FREE TERMINATIONS	GOLD PLATED		
		GREEN			
VBUS03B1-SD0	-	G	4	-08	VBUS03B1-SD0-G4-08
VBUS03B1-SD0	H	G	4	-08	VBUS03B1-SD0HG4-08

PACKAGE DATA

DEVICE NAME	PACKAGE NAME	TYPE CODE	WEIGHT	SOLDERING CONDITIONS
VBUS03B1-SD0	CLP0603-2L	3B	0.12 mg	260 °C/10 s at terminals Reflow soldering according JEDEC® STD-020

ABSOLUTE MAXIMUM RATINGS

PARAMETER	TEST CONDITIONS	SYMBOL	VALUE	UNIT
Peak pulse current	acc. IEC 61000-4-5, 8/20 μ s/single shot	I_{PPM}	2.5	A
Peak pulse power	Pin 1 to pin 2 acc. IEC 61000-4-5; $t_p = 8/20$ μ s; single shot	P_{PP}	45	W
ESD immunity	Contact discharge acc. IEC 61000-4-2; 10 pulses	V_{ESD}	± 16	kV
	Air discharge acc. IEC 61000-4-2; 10 pulses		± 16	
Operating temperature	Junction temperature	T_J	-55 to +150	°C
Storage temperature		T_{stg}	-55 to +150	°C



ESD PROTECTION FOR HIGH-SPEED SIGNAL OR DATA LINES

The VBUS03B1-SD0 is a Bidirectional and Symmetrical (BiSy) ESD protection device which clamps positive and negative overvoltage transients to ground. Connected between the signal or data line and the ground the VBUS03B1-SD0 offers a high isolation (low leakage current, low capacitance) within the specified working range. Due to the short leads and small package size of the tiny CLP0603 package the line inductance is very low, so that fast transients like and ESD strike can be clamped with minimal over- or undershoots. Due to the very low capacitance the VBUS03B1-SD0 can be used for high speed data ports like HDMI, USB 3.0 or Thunderbolt.

Table with 7 columns: PARAMETER, TEST CONDITIONS/REMARKS, SYMBOL, MIN., TYP., MAX., UNIT. Rows include Protection paths, Reverse stand-off voltage, Reverse voltage, Reverse current, Reverse breakdown voltage, Reverse clamping voltage, Capacitance, Clamping voltage, and Dynamic resistance.

Note

(1) Defined by design. Such a low leakage current is too low for a 100 % final test verification

TYPICAL CHARACTERISTICS ($T_{amb} = 25\text{ }^{\circ}\text{C}$, unless otherwise specified)

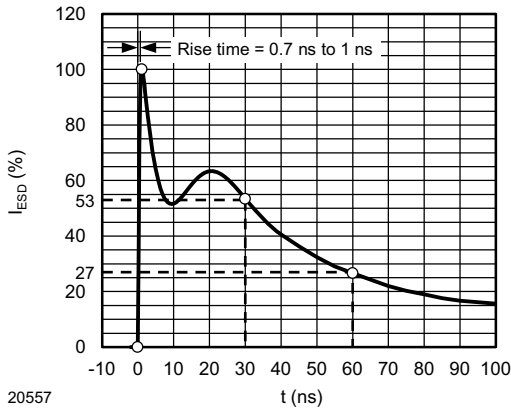

Fig. 1 - ESD Discharge Current Wave Form
acc. IEC 61000-4-2 (330 Ω /150 pF)

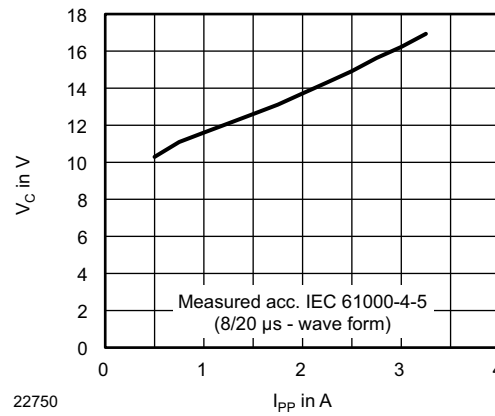

Fig. 4 - Typical Peak Clamping Voltage V_C vs.
Peak Pulse Current I_{PP}

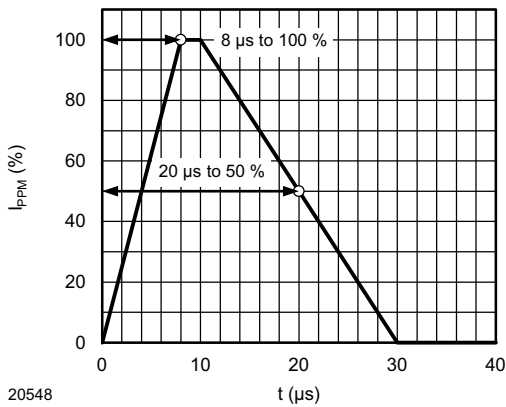

Fig. 2 - 8/20 μ s Peak Pulse Current Wave Form
acc. IEC 61000-4-5

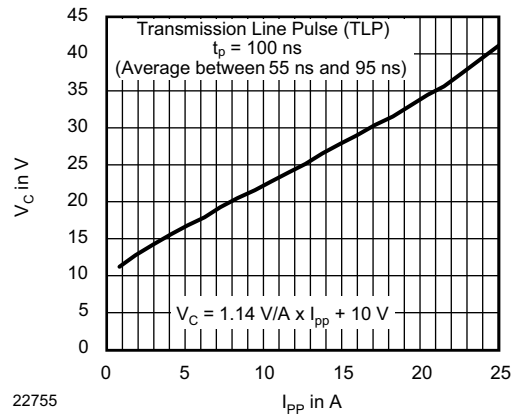

Fig. 5 - Typical Peak Clamping Voltage V_C vs.
Peak Pulse Current I_{PP}

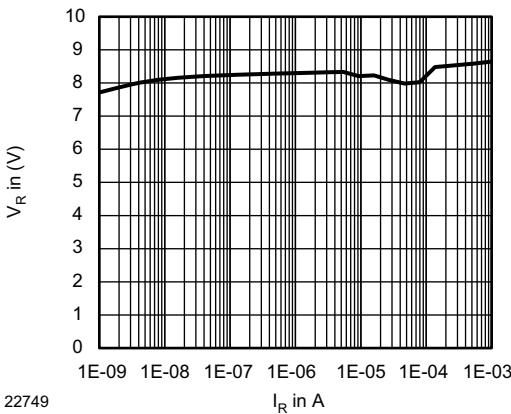

Fig. 3 - Typical Reverse Voltage V_R vs. Reverse Current I_R

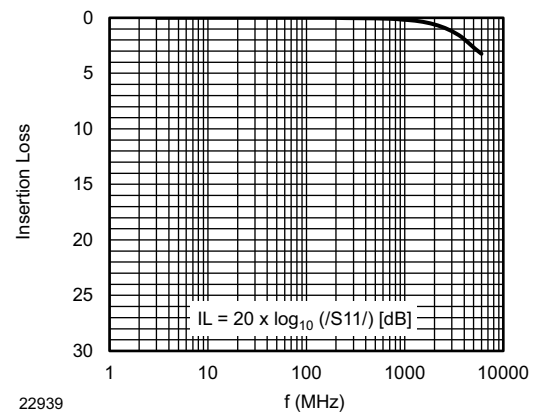
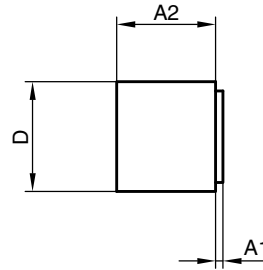
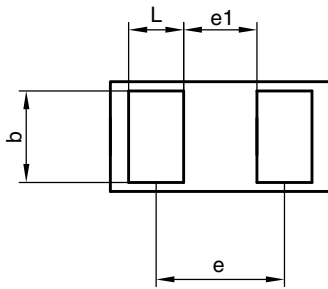

Fig. 6 - Typical Insertion Loss (IL) vs. Frequency



PACKAGE DIMENSIONS in millimeters (mils): CLP0603-2L



Package = chip dimensions in mm [mils]

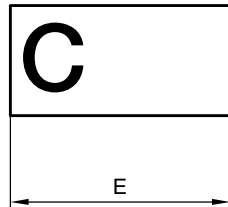

	Millimeters			mils		
	min.	nom.	max.	min.	nom.	max.
A	0.25	0.28	0.30	9.84	11.02	11.81
A1	0.01	0.01	0.02	0.39	0.39	0.79
A2	0.24	0.27	0.28	9.45	10.63	11.02
b	0.22	0.25	0.28	8.66	9.84	11.02
D	0.27	0.30	0.33	10.62	11.81	12.99
E	0.57	0.60	0.63	22.44	23.62	24.80
e		0.40			15.75	
e1		0.25			9.84	
L	0.12	0.15	0.18	4.72	5.91	7.09

22941

2 terminal leadless package (CLP)
Document no.: S8-V-3906.04-023 (4)
Created - Date: 22. Nov. 2010
Rev.8 - Date: 11. Nov. 2016

Footprint and soldering recommendation:

please see Application Note: www.vishay.com/doc?85917

CARRIER TAPE in millimeters: **CLP0603-2L**

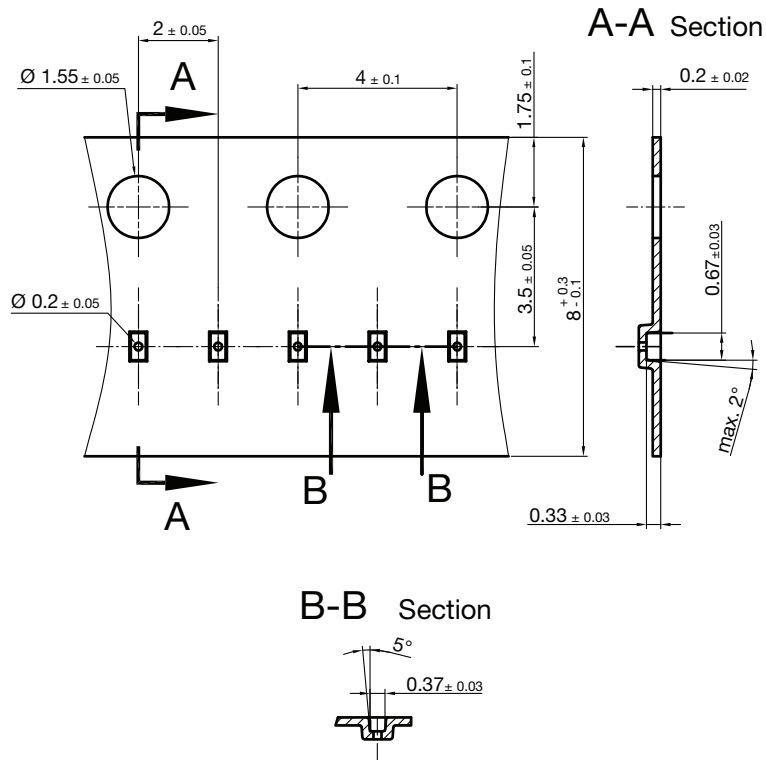

Cummulative tolerances of 10 sprocket holes is +/-0.2mm

22591
Document no. S8-V-3906.04-0025 (4)
Created - Date: 22. Nov. 2010

ORIENTATION IN CARRIER CLP0603-2L

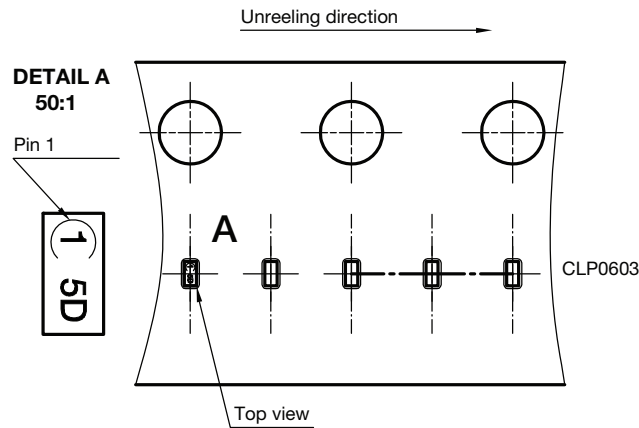

22607
Orientation in Carrier Tape (CLP0603)
S8-V-3906.04-026 (4)
22.10.2010



Disclaimer

ALL PRODUCT, PRODUCT SPECIFICATIONS AND DATA ARE SUBJECT TO CHANGE WITHOUT NOTICE TO IMPROVE RELIABILITY, FUNCTION OR DESIGN OR OTHERWISE.

Vishay Intertechnology, Inc., its affiliates, agents, and employees, and all persons acting on its or their behalf (collectively, "Vishay"), disclaim any and all liability for any errors, inaccuracies or incompleteness contained in any datasheet or in any other disclosure relating to any product.

Vishay makes no warranty, representation or guarantee regarding the suitability of the products for any particular purpose or the continuing production of any product. To the maximum extent permitted by applicable law, Vishay disclaims (i) any and all liability arising out of the application or use of any product, (ii) any and all liability, including without limitation special, consequential or incidental damages, and (iii) any and all implied warranties, including warranties of fitness for particular purpose, non-infringement and merchantability.

Statements regarding the suitability of products for certain types of applications are based on Vishay's knowledge of typical requirements that are often placed on Vishay products in generic applications. Such statements are not binding statements about the suitability of products for a particular application. It is the customer's responsibility to validate that a particular product with the properties described in the product specification is suitable for use in a particular application. Parameters provided in datasheets and / or specifications may vary in different applications and performance may vary over time. All operating parameters, including typical parameters, must be validated for each customer application by the customer's technical experts. Product specifications do not expand or otherwise modify Vishay's terms and conditions of purchase, including but not limited to the warranty expressed therein.

Except as expressly indicated in writing, Vishay products are not designed for use in medical, life-saving, or life-sustaining applications or for any other application in which the failure of the Vishay product could result in personal injury or death. Customers using or selling Vishay products not expressly indicated for use in such applications do so at their own risk. Please contact authorized Vishay personnel to obtain written terms and conditions regarding products designed for such applications.

No license, express or implied, by estoppel or otherwise, to any intellectual property rights is granted by this document or by any conduct of Vishay. Product names and markings noted herein may be trademarks of their respective owners.