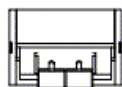

AX101936 Modular Connectors - MediaFlex Multimedia Angled Insert Duplex SC Singlemode

For more Information
please call

1-800-Belden1

**General Description:**

MediaFlex Multimedia Angled Insert Duplex SC Singlemode

Usage (Overall)

| | |
|------------------------|---------------------|
| Suitable Applications: | Fiber To The Desk |
| Related Parts: | MediaFlex Faceplate |

Physical Characteristics (Connectivity)**Dimensions**

Dimensions:

| Height (in.) | Width (in.) | Depth (in.) |
|--------------|-------------|-------------|
| 1.410 | 2.050 | 1.236 |

Materials

Materials:

| Description | Type | Material | Color |
|------------------|-----------|-------------------|-------|
| Front Connection | SC-DUPLEX | Plastic - UL94V-0 | Blue |
| Rear Connection | SC-DUPLEX | Plastic - UL94V-0 | Blue |
| Sleeve | | Zirconia-Ceramic | |
| Insert | | Plastic - UL94V-0 | |

Color

Color: Almond

Weight

Weight: 0.044 lbs.

Packaging

Packaging: Individually packaged in a suitable plastic bag.

Mechanical Characteristics (Connectivity)

| | |
|------------------------------|----------------|
| Storage Temperature Range: | -40°C To +70°C |
| Operating Temperature Range: | -10°C To +60°C |

Applicable Specifications and Agency Compliance (Overall)**Applicable Standards & Environmental Programs**

| | |
|---------------------------------------|----------------------------------|
| EU Directive 2002/95/EC (RoHS): | Yes |
| EU RoHS Compliance Date (mm/dd/yyyy): | 07/01/2006 |
| MII Order #39 (China RoHS): | EUP 50 |
| Safety Listing: | ACA, Bi-national Standard Listed |

Suitability

Suitability - Indoor: Yes - Indoor

Transmission Characteristics (Connectivity)**Notes (Overall)**

Notes: For proper installation refer to Installation Guide PX102063 available on our web site at <http://www.belden.com/pdfs/Techpprs/InstallationGuide.pdf>

Product Family

Part Number List:

| Item Number | Color |
|-------------|------------|
| AX101935 | Gray |
| AX101936 | Almond |
| AX101937 | Elec White |
| AX101938 | Black |
| AX102649 | Ivory |
| AX105638-GY | Gray |



AX101936 Modular Connectors - MediaFlex Multimedia Angled Insert Duplex SC Singlemode

| | |
|-------------|------------|
| AX105638-AL | Almond |
| AX105638-EW | Elec White |
| AX105638-BK | Black |

Put Ups and Colors:

| Item # | Putup | Ship Weight | Color | Notes | Item Desc |
|----------|-------|-------------|-------|-------|-------------------------------|
| AX101936 | 1 EA | 0.044 LB | | | MEDIAFLEX SC DX SM INSERT ALM |

Revision Number: 0 Revision Date: 09-13-2013

© 2015 Belden, Inc
All Rights Reserved.

Although Belden makes every reasonable effort to ensure their accuracy at the time of this publication, information and specifications described herein are subject to error or omission and to change without notice, and the listing of such information and specifications does not ensure product availability. Belden provides the information and specifications herein on an "AS IS" basis, with no representations or warranties, whether express, statutory or implied. In no event will Belden be liable for any damages (including consequential, indirect, incidental, special, punitive, or exemplary damages) whatsoever, even if Belden has been advised of the possibility of such damages, whether in an action under contract, negligence or any other theory, arising out of or in connection with the use, or inability to use, the information or specifications described herein. All sales of Belden products are subject to Belden's standard terms and conditions of sale. Belden believes this product to be in compliance with EU RoHS (Directive 2002/95/EC, 27-Jan-2003). Material manufactured prior to the compliance date may be in stock at Belden facilities and in our Distributor's inventory. The information provided in this Product Disclosure, and the identification of materials listed as reportable or restricted within the Product Disclosure, is correct to the best of Belden's knowledge, information, and belief at the date of its publication. The information provided in this Product Disclosure is designed only as a general guide for the safe handling, storage, and any other operation of the product itself or the one that it becomes a part of. This Product Disclosure is not to be considered a warranty or quality specification. Regulatory information is for guidance purposes only. Product users are responsible for determining the applicability of legislation and regulations based on their individual usage of the product.