

view without cover

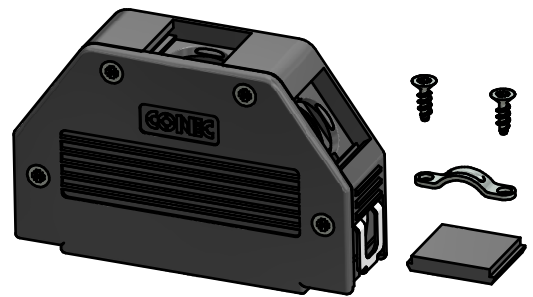

HOOD ASSEMBLY CONSISTS OF:

- 1. HOOD + COVER: ABS UL 94 V-0; BLACK
- 2. BLANKING PLUGS: ABS UL 94 V-0; BLACK
- 3. CABLE STRAIN RELIEF: STEEL; NICKEL PLATED
- 4. CLIP: STAINLESS STEEL
- 5. COUNTERSUNK HEAD SCREWS: STEEL; NICKEL PLATED

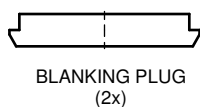
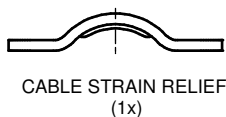
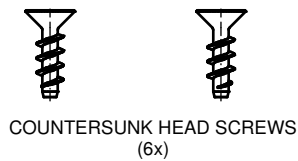

c	Part-No.	Part-No.
	Bulk package	Single package
	16-001850	16-001850E

RoHS compliant

THIS DRAWING MAY NOT BE COPIED OR REPRODUCED IN ANY WAY, AND MAY NOT BE PASSED ON TO A THIRD PARTY WITHOUT WRITTEN PERMISSION. OWNERSHIP AND COPYRIGHT OF CONEC GmbH DO NOT ALTER CAD DRAWING BY HAND	finish:	tolerance	dim. in mm		scale:	2:1 (1:1)			
	see table				material:	see drawing			
			date	name		title: Plastic Hood 50pos with Snap Lock / top and two sides cable exit			
			drawn	12.11.12	Strakerjahn				
			appd.	06.05.14	Koch				
			norm			dwg no: 16K1A3137			
	2 x c	Ä5619	22.04.15	K.H.	d-old				SK0823Y15
	3 x b	Ä5357	25.09.14	K.H.			DIN-A3		
	a	Original					sh: 1		
	rev.	description	date	name	CONEC		part no: c b SEE TABLE		