

4

3

2

1

THIS DRAWING IS UNPUBLISHED.

RELEASED FOR PUBLICATION

20

© COPYRIGHT 20

BY -

ALL RIGHTS RESERVED.

REVISIONS

P	LTR	DESCRIPTION	DATE	DWN	APVD
	C7	PART STATUS UPDATED	11JAN2018	RK	PS

0.5±0.1

10.9

TEST FACILITY

CLAMPING SCREW

INTERLOCKING FEATURE

A

1 MATERIALS AND FINISH
 HOUSING: PA 6-6, UL 94-V0, COLOR GREEN.
 CLAMP: BRASS, NICKEL PLATED.
 TERMINAL: BRASS, TIN PLATED.
 CLAMPING SCREW: M3, BRASS, NICKEL PLATED.
 2 SUITABLE FOR 1,6-2,4mm PC BOARD THICKNESS.
 3 END-TO-END STACKABLE W/INTERLOCK WITHOUT LOSS OF CENTERLINE SPACING.
 4 WIRE SIZE RANGE: 12 - 30 AWG
 5 RECOGNIZED UNDER THE COMPONENT PROGRAM OF UNDERWRITERS LABORATORIES INC. FILE NO E60677.
 6 IMQ CERTIFICATE WITH SURVEILLANCE IMQ IN CONFORMITY WITH IEC 998-1/998-2-1.

7 NOT CUMULATIVE TOLERANCE.

8 P/N 1-282925-0 IS A KIT PACKAGE COMPRISED OF THE FOLLOWING:(3) OF 25 POS. GLUED ASSEMBLIES AND (4) OF 22 POS. GLUED ASSEMBLIES. EACH GLUED ASSEMBLY IS PACKAGED SEPERATLY IN A UNIT BOX.

9 INK MARKING, BLACK COLOR.
 NUMERICAL SEQUENCE: FROM LEFT TO RIGHT FOR EACH GLUED ASSEMBLY.

10 INK MARKING, BLACK COLOR. SEE DETAIL FOR MARKING.

11 PARTS TO BE SHIPPED WITH CAGES IN THE CLOSED POSITION WITH SCREW TORQUE TO 3 IN-lbs MIN.

12 PRELIMINARY PART NUMBER

13 SECTIONS GLUED USING CYANOLIT 241F OR TE ENGINEERING APPROVED EQUIVALENT.

282925-3 AS SHOWN

45.0

30.3

4.0±0.3

0.80±0.05

7.3 REF

3.6

WIRE ENTRY

2.54 REF

1.0±0.1

5.08±0.05

DIM.A	NO OF POS.	PART NUMBER
12/10	12	2-282925-3
12/10	15	2-282925-2
13/11/10	21	2-282925-1
13/11/10	15	1-282925-5
13/10	12	1-282925-2
8/9	163	1-282925-0
OBSOLETE	3	282925-3
OBSOLETE	2	282925-2

RECOMMENDED PC BOARD LAYOUT

5.08

1.4^{+0.1}₋₀

0.1

THIS DRAWING IS A CONTROLLED DOCUMENT.

DIMENSIONS:	TOLERANCES UNLESS OTHERWISE SPECIFIED:
mm	
0 PLC	±-
1 PLC	±.3
2 PLC	±.25
3 PLC	±-
4 PLC	±-
ANGLES	±2
MATERIAL	FINISH
1	1

DWN	09NOV2001
E. ZANOLINI	
CHK	09NOV2001
D. BIEVENOUR	
APVD	09NOV2001
D. BIEVENOUR	
PRODUCT SPEC	108-20166
APPLICATION SPEC	114-20079
WEIGHT	-
CUSTOMER DRAWING	

STE TE Connectivity	
NAME TERMINAL BLOCK, PCB MOUNT 3RD LEVEL STACKING W/INTERLOCK, 5.08mm PITCH	
SIZE	A300779
CAGE CODE	C-282925
DRAWING NO	
RESTRICTED TO	-
SCALE	2:1
SHEET	1 OF 3
REV	C7

1470-19 (3/13)

THIS DRAWING IS UNPUBLISHED.

RELEASED FOR PUBLICATION

20

© COPYRIGHT 20 BY -

ALL RIGHTS RESERVED.

REVISIONS

P	LTR	DESCRIPTION	DATE	DWN	APVD
-		SEE SHEET 1	-	-	-

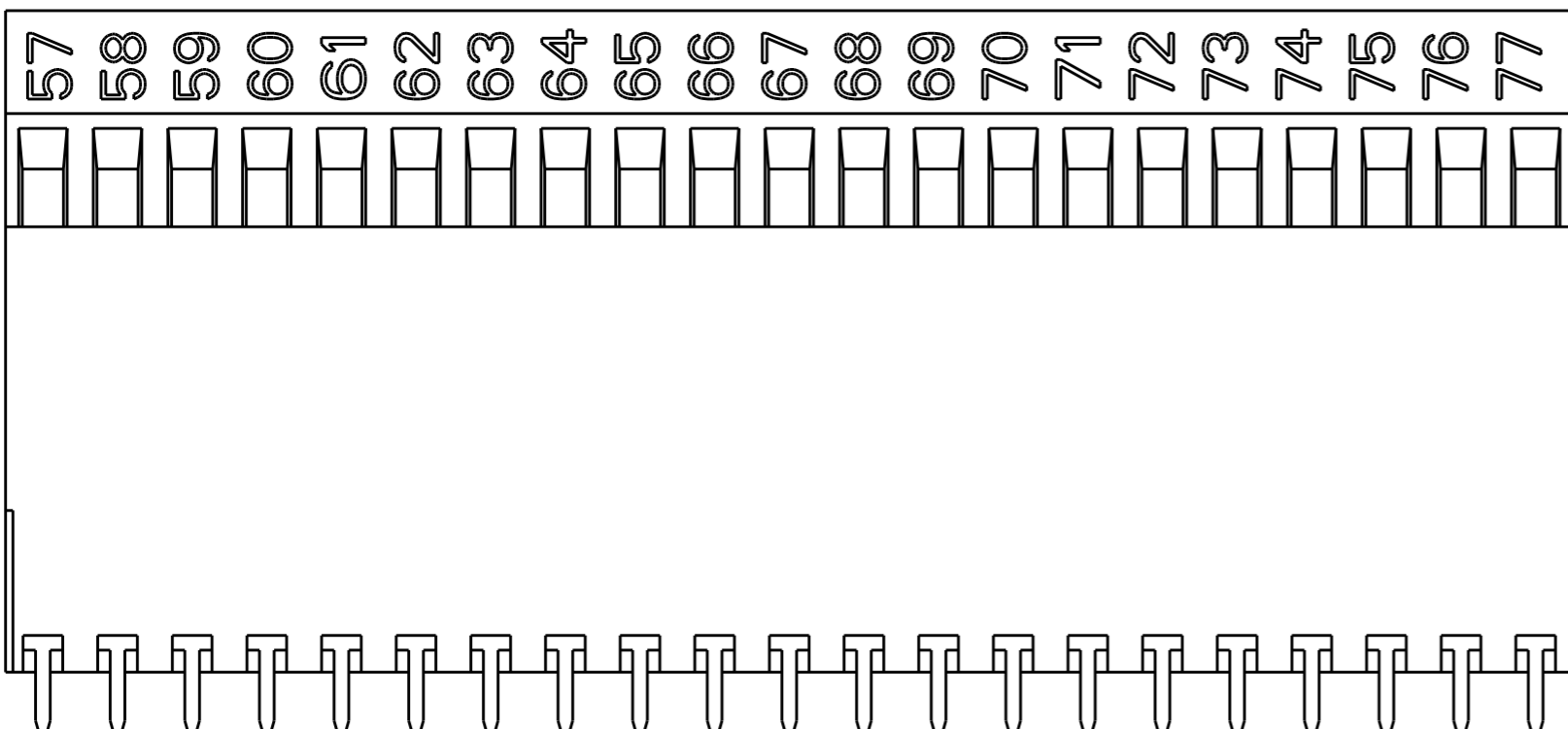

DETAIL D
SCALE 2:1

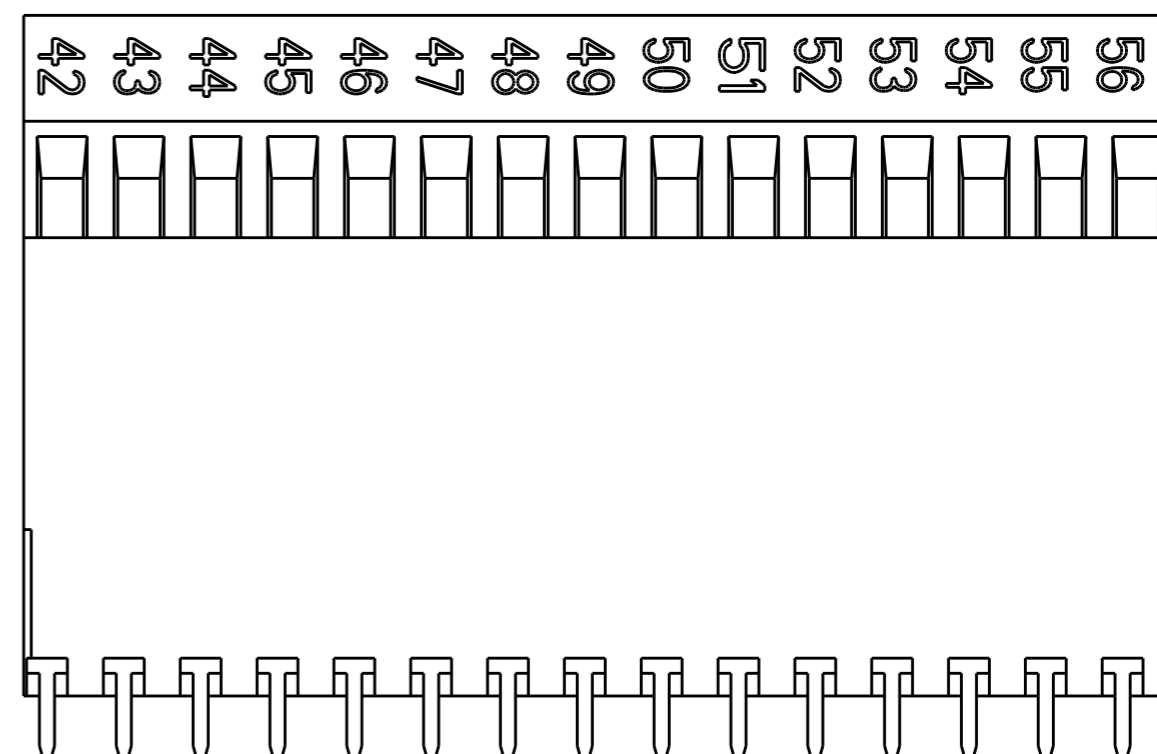

DETAIL C
SCALE 2:1

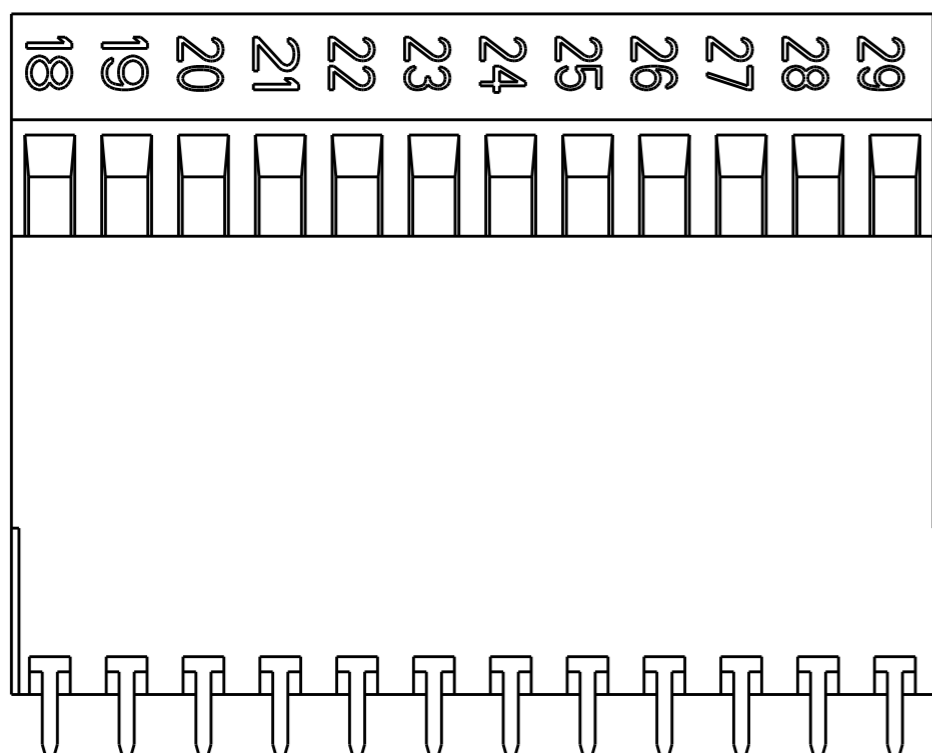

DETAIL B
SCALE 2:1

THIS DRAWING IS A CONTROLLED DOCUMENT.

DIMENSIONS:
mm

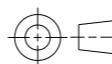

TOLERANCES UNLESS OTHERWISE SPECIFIED:

- 0 PLC ±.3
- 1 PLC ±.3
- 2 PLC ±.25
- 3 PLC ±.
- 4 PLC ±.
- ANGLES ±2

MATERIAL



FINISH



DWN 09NOV2001

E. ZANOLINI

CHK 09NOV2001

D. BIEVENOUR

APVD 09NOV2001

D. BIEVENOUR

PRODUCT SPEC

108-20166

APPLICATION SPEC

114-20079

WEIGHT

-

CUSTOMER DRAWING



TE Connectivity

NAME
TERMINAL BLOCK, PCB MOUNT
3RD LEVEL
STACKING W/INTERLOCK, 5.08mm PITCH

SIZE CAGE CODE DRAWING NO RESTRICTED TO

A300779 C-282925

SCALE 2:1 SHEET 2 OF 3 REV C7

THIS DRAWING IS UNPUBLISHED.

RELEASED FOR PUBLICATION

20

© COPYRIGHT 20 BY -

ALL RIGHTS RESERVED.

REVISIONS

P	LTR	DESCRIPTION	DATE	DWN	APVD
	-	SEE SHEET 1	-	-	-

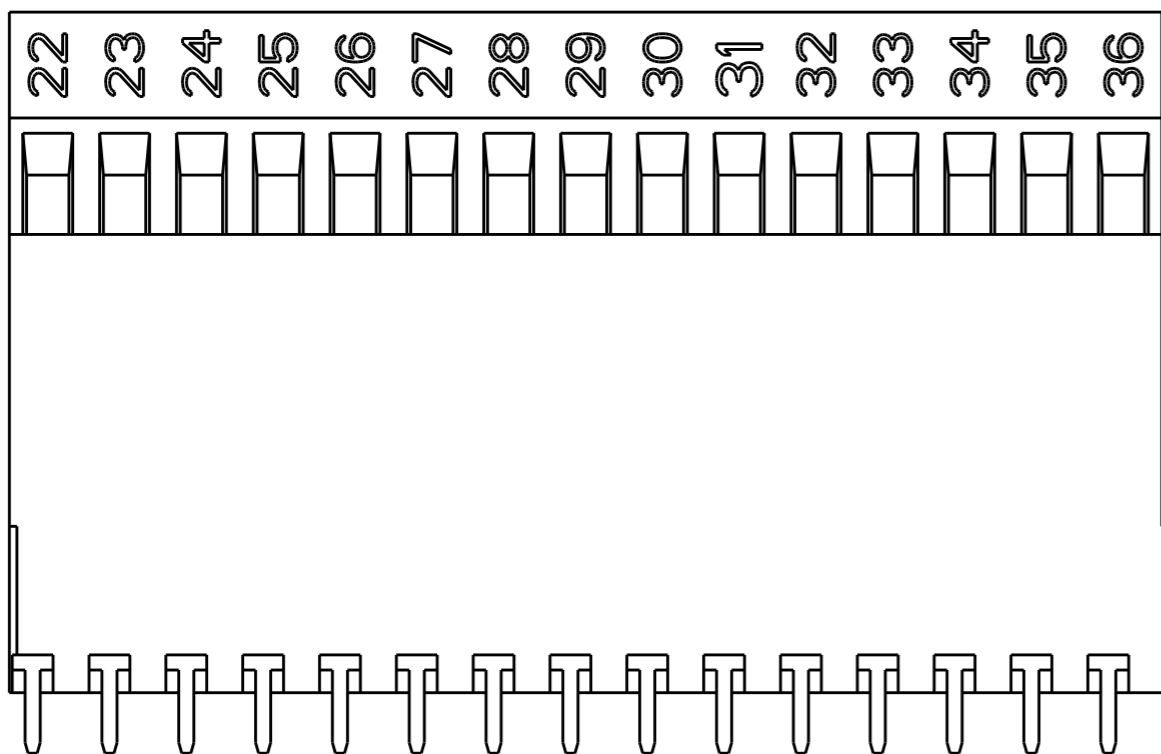

DETAIL E
SCALE 2:1

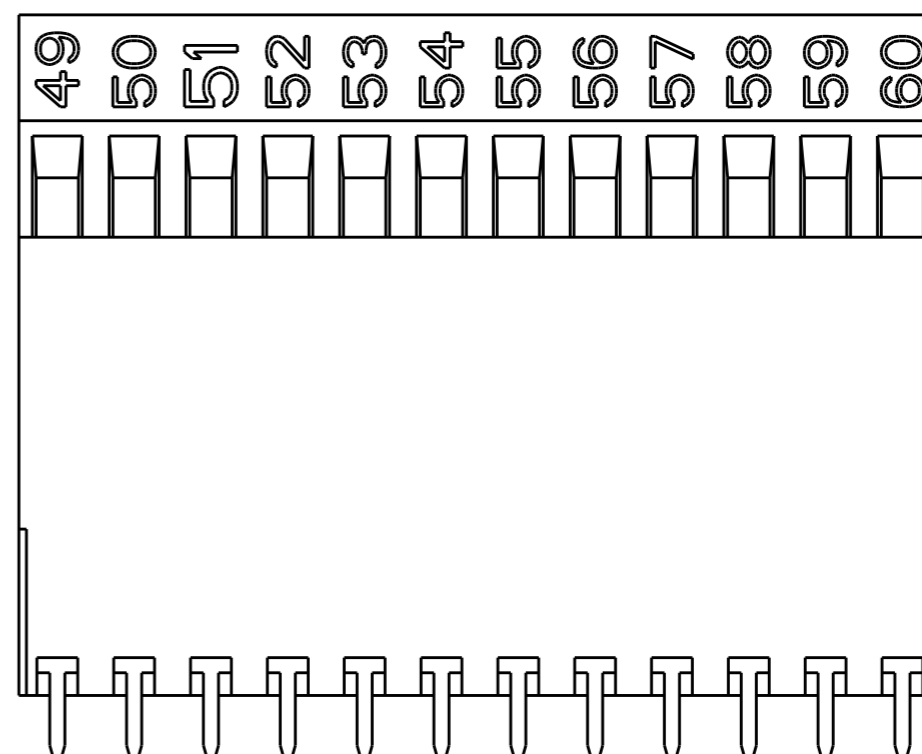

DETAIL F
SCALE 2:1

THIS DRAWING IS A CONTROLLED DOCUMENT.

DIMENSIONS: mm	TOLERANCES UNLESS OTHERWISE SPECIFIED:
	0 PLC ±-
	1 PLC ±.3
	2 PLC ±.25
	3 PLC ±-
	4 PLC ±-
	ANGLES ±2
MATERIAL	FINISH

DWN	E. ZANOLINI	09NOV2001
CHK	D. BIEVENOUR	09NOV2001
APVD	D. BIEVENOUR	09NOV2001
PRODUCT SPEC	108-20166	
APPLICATION SPEC	114-20079	
WEIGHT	-	
CUSTOMER DRAWING		

TE Connectivity			
NAME TERMINAL BLOCK, PCB MOUNT 3RD LEVEL STACKING W/INTERLOCK, 5.08mm PITCH			
SIZE	CAGE CODE	DRAWING NO	RESTRICTED TO
A3	00779	C-282925	-
SCALE 2:1		SHEET 3 OF 3	REV C7