

THESE DRAWINGS ARE THE PROPERTY OF QUALTEK ELECTRONICS AND NOT TO BE REPRODUCED FOR OR COMMUNICATED TO A THIRD PARTY WITHOUT THE EXPRESS WRITTEN PERMISSION OF AN OFFICER OF QUALTEK ELECTRONICS.

REVISION			
REV.	DESCRIPTION	DATE	APPROVED
B	RoHS Compliancy	06-01-06	DP

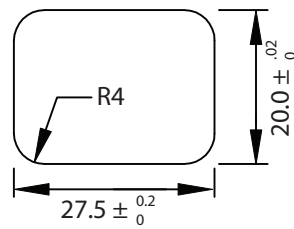

PANEL CUTOUT

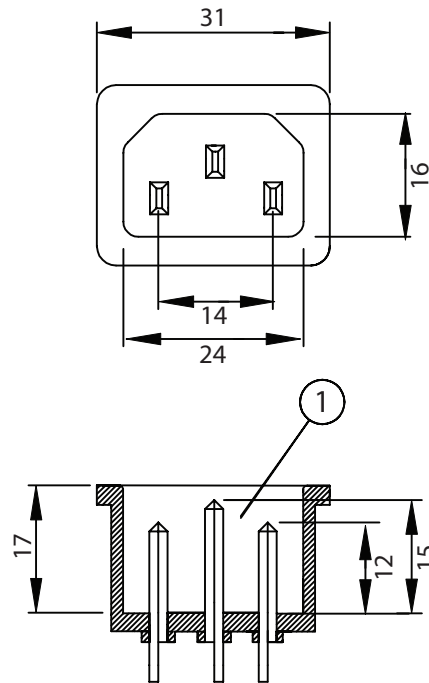
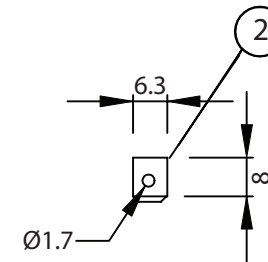
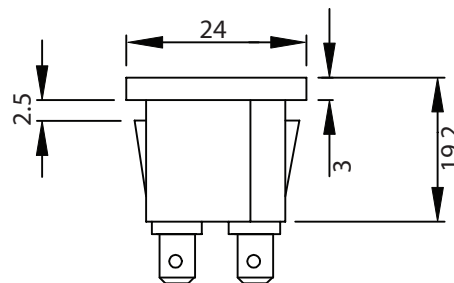
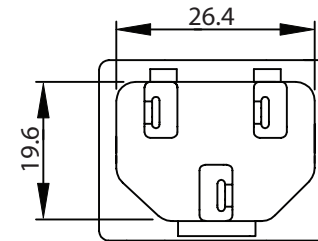

NOTES:

MATERIAL:

HOUSING: THERMOPLASTIC
 TERMINAL: COPPER ALLOY

RATING:

UL,CSA: 15A 250V AC
 VDE: 10A 250V AC

INSULATION RESISTANCE: OVER 100 OHM 500V DC

DIELECTRIC STRENGTH: 2000V AC ONE MINUTE

APPROVALS: UL,CSA,VDE

PANEL THICKNESS: 2.5mm

RoHS COMPLIANT

CONTROLLED

2	Terminal 6.3 Copper Alloy Tin-Plated	3	
1	Housing SNAP-IN TYPE Thermoplastic	1	
Dim range (mm)	Tolerance +/- (mm)	Qualtek Electronics Corp. PPC DIVISION	
0-1	0.15	Part Number:	701W-25/33 RoHS Compliant
1-6	0.20	Description:	AC RECEPTACLE
6-18	0.30		UNIT: mm
18-50	0.50		REV. B
50-120	0.70	Drawn / Date	Checked / Date
120-250	0.90	S.CHEN 11-08-99	11-08-99
250-500	1.20		Approved / Date JJH / 11-08-99

Mouser Electronics

Authorized Distributor

Click to View Pricing, Inventory, Delivery & Lifecycle Information:

[Qualtek:](#)

[701W-25/33](#)