

RoHS compliant

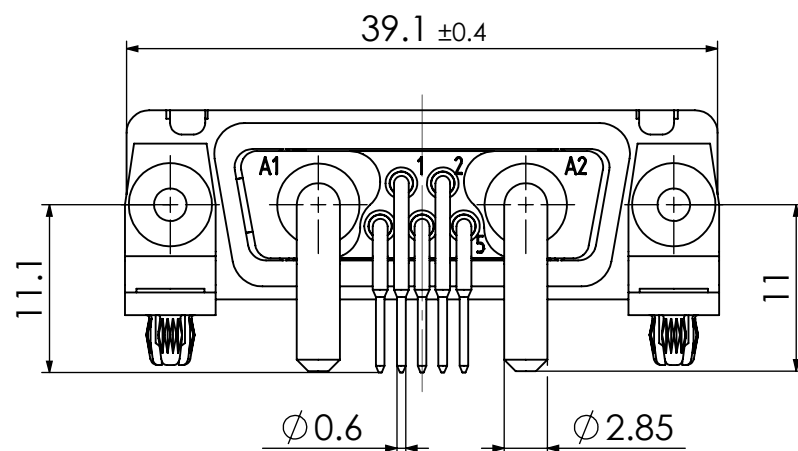

7	2	Snap-in rivet	PCB 1.6mm / Brass	tin plated
6	2	Clinch nut	MW 4-40 / Steel	tin plated
5	2	Bracket	F1080-13B / Steel	tin plated
4	2	High power contact	FMP008S104R	20A
3	5	Signal contact	S5 / Brass	0,8µm Au
2	1	Shell	Steel	tin plated
1	1	Insulator	PBT (-55°C - +130°C)	green
<i>No.</i>	<i>St.</i>	<i>Part</i>	<i>Type Description/Material</i>	<i>Surface plating/Colour/Class</i>

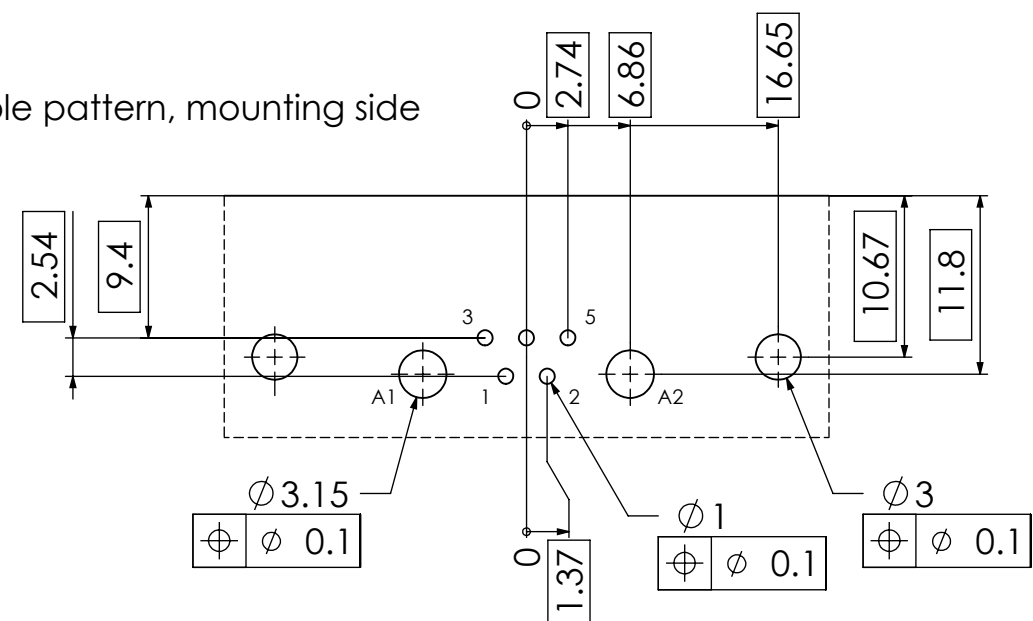

Measurement without
tolerance occ. to
ISO 2768-m

SCAL
2:1

	TITLE
--	-------

D-Sub Mixed-Layout Connector

DRAWN

NAME / DATE	mpostulka 22-04-2009
-------------	-------------------------

DWG.NO.	
---------	--

FM7W2S5-1343

REV.

1

1

REV.

DATE _____

CH.-NO.

ORIGINAL: DIN A3-DRAWING AS A FILE

REPLACEMENT FOR:

PAGES 1

COMMENT:
ALL RIGHTS ARE RESERVED BY US FOR THIS DRAWING. WITHOUT OUR PRIOR CONSENT,
IT MAY NEITHER BE DUBICATED NOR MADE AVAILABLE TO A THIRD PARTY,
AND IT ALSO MAY NOT BE IMPROPERLY USED BY TE RECEIVER, OR A THIRD PARTY.