

# PIN RECEPTACLES

FOR .015" - .022" DIAMETER PINS

## 9900

9900-0-15-XX-22-XX-04-0

Press-fit in .056 mounting hole

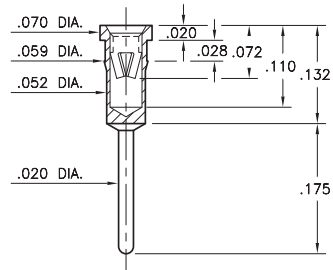

<p>9900 9900-0-15-XX-22-XX-04-0 Press-fit in .056 mounting hole</p>			

### SPECIFICATIONS:

**Shell Material:** Brass Alloy 360, 1/2 Hard

**Contact Material:** Beryllium Copper Alloy 172, HT

**Dimensions: Inches**

**Tolerances On:** Lengths: ±.005

Diameters: ±.002

Angles: ± 2°



**ORDER CODE:** XXXX - X - XX - XX - 22 - XX - 10 - 0

**BASIC PART #**

**SPECIFY SHELL FINISH:**

01 200 μ" TIN/LEAD OVER NICKEL

◆ 80 200 μ" TIN OVER NICKEL (RoHS)

◆ 15 10 μ" GOLD OVER NICKEL (RoHS)

**SPECIFY CONTACT FINISH:**

02 100 μ" TIN/LEAD OVER NICKEL

◆ 84 100 μ" TIN OVER NICKEL (RoHS)

◆ 27 30 μ" GOLD OVER NICKEL (RoHS)

**SELECT CONTACT:**

#22 CONTACT (DATA ON PAGE 252)

(For alternate contact choices, see group B on page 248)