

PART NUMBER

10118241-001RLF

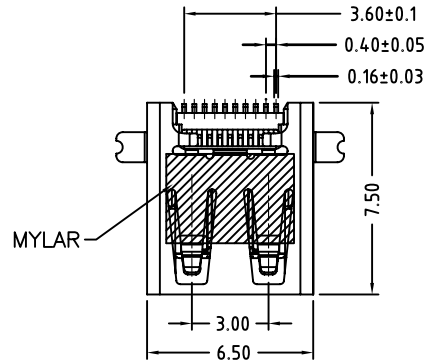

PART NO. DESCRIPTION:

- 10118241-00XXLF
  - RoHS COMPATIBLE
  - PACKING TYPE R:TAPE & REEL
  - CONTACT AREA PLATING 1:Au 15u"

NOTES:

1. MATERIAL:  
HOUSING: LCP+30%GF ,UL94 V-0,BLACK  
TERMINAL: COPPER ALLOY.  
SHELL: STAINLESS STEEL
2. FINISH:  
CONTACT AREA: GOLD PLATED  
CONTACT SOLDER AREA: GOLD FLASH PLATED  
SHELL: TIN PLATED  
UNDER NICKEL PLATED OVER ALL.
3. PRODUCT SPECIFICATION: GS-12-0983.
4. PACKAGING SPECIFICATION: GS-14-2164.
5. THE PRODUCT MEETS EUROPEAN UNION DIRECTIVES AND OTHER COUNTRY REGULATIONS AS DESCRIBED IN GS-22-008.
6. THE CONNECTOR CAN WITHSTAND EXPOSURE TO 260 DEGREE C PEAK TEMPERATURE FOR 10 SECONDS IN IR REFLOW OVEN.

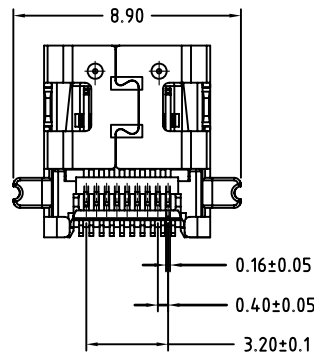
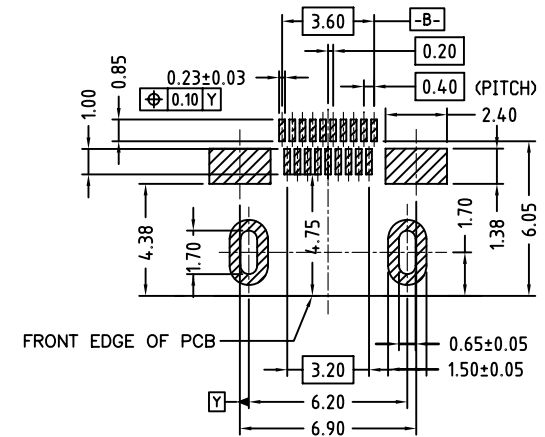
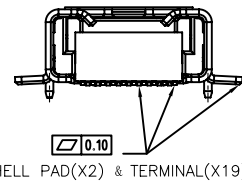
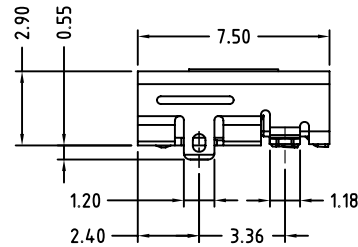
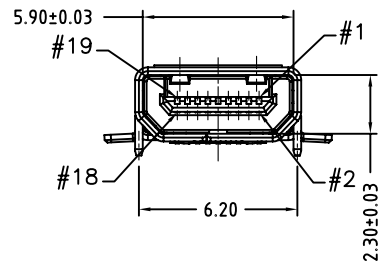

mat'l. code		surface ASME Y14.5		tolerance ASME Y14.5		projection		product family HDMI	
ltr		ecn no		dr		date		tolerances unless otherwise specified	
A		LS		09/13/11		angles		title	
B		ELX-N-16493		Henry		06/24/14		HDMI TYPE D RECEPTACLE	
						linear		MM	
						X°±1°		scale	
						.X±0.25		FCI	
						.XX±0.20		dwg no	
						.XXX±0.10		sheet 1 of 1	
				dr		LEIF SHEN		09/13/11	
				enrg		LEIF SHEN		09/13/11	
				chr		GARY HSIEH		09/13/11	
				appd		GARY HSIEH		09/13/11	
sheet		revision		B				size	
index		sheet		1				10118241	
								A4	
								type	
								CUSTOMER Drawing	