

Spezifikation für Freigabe / specification for release

Kunde / customer :
 Artikelnummer / part number : **7446923010**
 Bezeichnung : **STROMKOMPENSIERTE DROSSEL WE-LF**
 description : **CURRENT-COMPENSATED CHOKE WE-LF**

LF



DATUM / DATE : 2012-08-07

A Mechanische Abmessungen / dimensions:

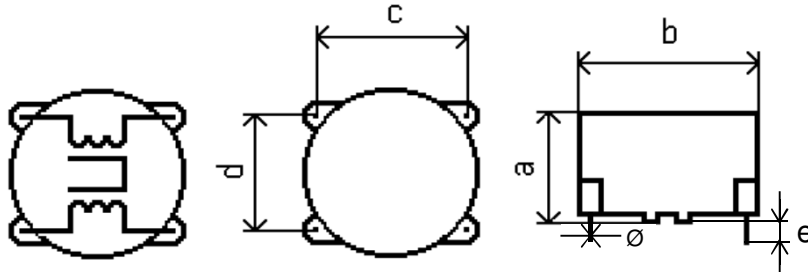

Gehäuse / case: XH		
a	20,0 max	mm
b	33,5 max	mm
c	30,2 ± 0,2	mm
d	20,1 ± 0,2	mm
e	3,5 ± 0,5	mm
Ø	0,8 x 0,8 typ	mm

B Elektrische Eigenschaften / electrical properties:

Eigenschaften / properties	Testbedingungen / test conditions	Wert / value	Einheit / unit	tol.
Leerlauf-Induktivität / inductance	10 kHz / 50 mV / 25 °C	L ₀	10.0	mH ±30%
DC-Widerstand / DC-resistance		R _{DC}	0.110	Ω max.
Nennstrom / nominal current		I _N	3.0	A max.
Nennspannung / nominal voltage	50 Hz	U _N	250	V

C Lötpad / soldering spec.:

D Prüfgeräte / test equipment:

FLUKE PM 6306 für/for L₀/L_N
 HP 34401 A für/for I_N und/and R_{DC}

E Testbedingungen / test conditions:

Luftfeuchtigkeit / humidity: 33%
 Umgebungstemperatur / temperature: +25 °C
 Prüfspannung / testing voltage: 1500 V, 50 Hz

F Werkstoffe & Zulassungen / material & approvals:

Gehäuse / case: UL94V-0
 Draht / wire: P155 IEC317-20
 Verguß / molding: UL94V-0

G Eigenschaften / general specifications:

Klimabeständigkeit/ climatic class: 40/125/21
 Betriebstemp. / operating temperature: -40 °C - + 125 °C
 Übertemperatur / temperature rise: < 55 K
 It is recommended that the temperature of the part does not exceed 125 °C under worst case operating conditions.

Freigabe erteilt / general release:	Kunde / customer		
Datum / date	Unterschrift / signature		
	Würth Elektronik		
	HasA	Version 4	12-08-07
	MST	Version 3	05-11-23
	MST	Version 2	05-03-08
Geprüft / checked	Kontrolliert / approved		
	Name	Änderung / modification	Datum / date

This electronic component has been designed and developed for usage in general electronic equipment. Before incorporating this component into any equipment where higher safety and reliability is especially required or if there is the possibility of direct damage or injury to human body, for example in the range of aerospace, aviation, nuclear control, submarine, transportation, (automotive control, train control, ship control), transportation signal, disaster prevention, medical, public information network etc. Würth Elektronik eiSos GmbH must be informed before the design-in stage. In addition, sufficient reliability evaluation checks for safety must be performed on every electronic component which is used in electrical circuits that require high safety and reliability functions or performance.

Würth Elektronik eiSos GmbH & Co. KG

D-74638 Waldenburg · Max-Eyth-Strasse 1 - 3 · Germany · Telefon (+49) (0) 7942 - 945 - 0 · Telefax (+49) (0) 7942 - 945 - 400
<http://www.we-online.com>