

**DIMENSIONS: mm**

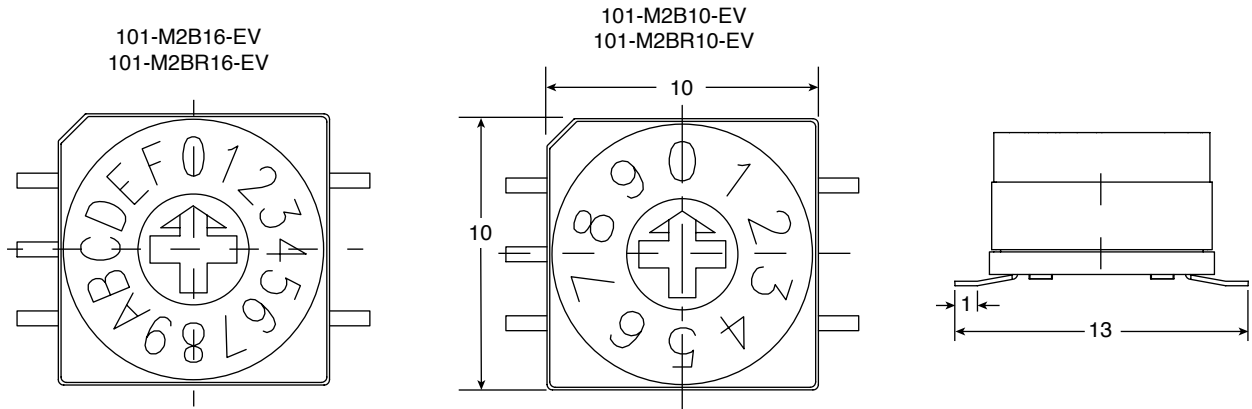

TYPE	CIRCUIT CHARACTERISTICS																
10 STEP	CODE	POSITION										X ON					
		0	1	2	3	4	5	6	7	8	9	A	B	C	D	E	F
	1	X	X		X	X	X	X		X							
	2		X	X			X	X									
	4				X	X	X	X									
8						X	X		X	X							

TYPE	CIRCUIT CHARACTERISTICS																
16 STEP	CODE	POSITION										X ON					
		0	1	2	3	4	5	6	7	8	9	A	B	C	D	E	F
	1	X	X	X	X	X	X	X	X	X	X	X	X	X	X	X	X
	2		X	X		X	X	X			X	X		X	X	X	X
	4				X	X	X	X				X	X	X	X	X	X
8						X	X	X	X	X	X	X	X	X	X	X	

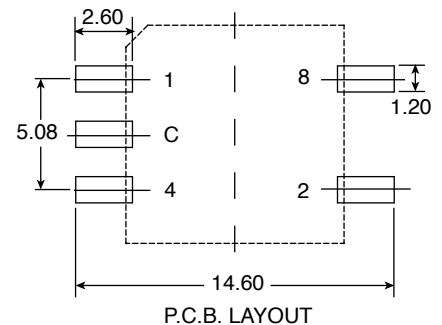
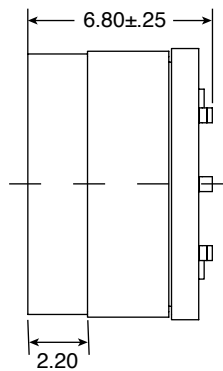

**Mechanical Specifications:**

- Operating Force: 400gf-cm Max.
- Operating Temperature: -60°C to 125°C

**Electrical Specifications:**

- Rating: Non Switching Rating 400mA/24VDC  
Switching Rating 150mA/24VDC
- Initial Contact Resistance: 100mΩ Max.
- Dielectric Strength: 250VAC 1 Minute
- Insulation Resistance: 100MΩ Min. (250VDC Megger)

MOUSER STOCK NO.	Packaging
101-M2B10-EV	Tube
101-M2B16-EV	Tube
101-M2BR10-EV	Reel
101-M2BR16-EV	Reel

**Note:**

- RoHS Compliant

**Coded Rotary Switches**

101-M2B10-EV, 101-M2B16-EV, 101-M2BR10-EV,  
101-M2BR16-EV

