



Main

| | |
|-------------------------------|--|
| Range of product | OsiSense XX |
| Sensor type | Ultrasonic sensor |
| Series name | General purpose |
| Sensor name | XX9 |
| Sensor design | Flat form 80 x 80 x 34 |
| Detection system | Diffuse |
| [Sn] nominal sensing distance | 3.28 ft (1 m) adjustable with remote teach push-button |
| Material | Plastic |
| Type of output signal | Analogue |
| Wiring technique | 4-wire |
| Analogue output function | 0...10 V |
| [Us] rated supply voltage | 15...24 V DC with reverse polarity protection |
| Electrical connection | Male connector M12 4 pins |
| [Sd] sensing range | 0.33...3.28 ft (0.1...1 m) |
| Beam angle | 7 ° |
| IP degree of protection | IP67 conforming to IEC 60529 |

Complementary

| | |
|---|---|
| Enclosure material | Valox |
| Front material | Epoxy |
| Thread type | M30 x 1.5 |
| Supply voltage limits | 10...28 V DC |
| [Sa] assured operating distance | 0.33...3.28 ft (0.1...1 m) (teach mode) |
| Blind zone | 0...3.94 in (0...100 mm) |
| Transmission frequency | 180 kHz |
| Repeat accuracy | 0.9 % |
| Deviation angle from 90° of object to be detected | -5...5 ° |
| Minimum size of detected object | Cylinder diameter 50.8 mm at 3.28 ft (1 m) |
| Status LED | 1 LED (dual colour) setting-up assistance 1 LED (green) supply on 1 LED (yellow) output state |
| Current consumption | 60 mA |
| Maximum switching capacity | 2 kOhm overload and short-circuit protection |
| Setting-up | Slope selection using teach button |
| Delay first up | 1200 ms |
| Delay response | 250 ms |
| Delay recovery | 250 ms |
| Marking | CE |
| Product weight | 0.66 lb(US) (0.3 kg) |

Environment

| | |
|---------------------------------------|--|
| standards | IEC 60947-5-2 |
| product certifications | CCSAus UL |
| ambient air temperature for operation | 32...158 °F (0...70 °C) |
| ambient air temperature for storage | -40...176 °F (-40...80 °C) |
| vibration resistance | +/-1 mm conforming to IEC 60068-2-6 10...55 Hz |
| shock resistance | 30 gn in all 3 axes 11 ms conforming to IEC 60068-2-27 |

| | |
|---------------------------------------|--|
| resistance to electrostatic discharge | 8 kV level 4 conforming to IEC 61000-4-2 |
| resistance to electromagnetic fields | 9.14 V/yd (10 V/m) level 3 conforming to IEC 61000-4-3 |
| resistance to fast transients | 1 kV level 3 conforming to IEC 61000-4-4 |

Offer Sustainability

| | |
|--|--|
| Not Green Premium product | Not Green Premium product |
| Compliant - since 1140 - Schneider Electric declaration of conformity | Compliant - since 1140 - Schneider Electric declaration of conformity |
| Reference contains SVHC above the threshold - go to CaP for more details | Reference contains SVHC above the threshold |
| Available | Available |
| WARNING: This product can expose you to chemicals including: | WARNING: This product can expose you to chemicals including: |
| Diisononyl phthalate (DINP), which is known to the State of California to cause cancer, and | Diisononyl phthalate (DINP), which is known to the State of California to cause cancer, and |
| Di-isodecyl phthalate (DIDP), which is known to the State of California to cause birth defects or other reproductive harm. | Di-isodecyl phthalate (DIDP), which is known to the State of California to cause birth defects or other reproductive harm. |
| For more information go to www.p65warnings.ca.gov | For more information go to www.p65warnings.ca.gov |

Contractual warranty

| | |
|-----------------|-----------|
| Warranty period | 18 months |
|-----------------|-----------|

Dimensions

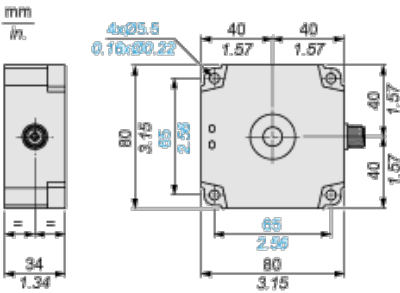

Minimum Mounting Distances

Side by side

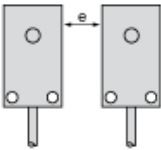

e : respect the distances indicated on the detection curves

Wiring Diagram

4-Wire Type



- (1) (+)
- (2) Return signal or teach
- (3) (-)
- (4) Output signal

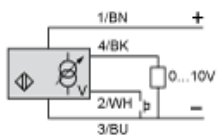

BN Brown

WH White

BU Blue

BK Black

Curves

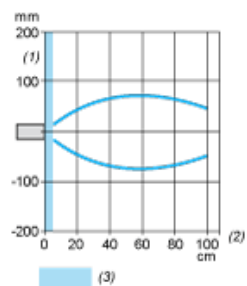

(1) Parallel movement

(2) Distance

(3) Blind zone for diffuse sensors.