



Main

| | |
|---------------------------|--------------------------------------|
| Range of product | Preventa XY2 |
| Product or component type | Dual emergency stop rope pull switch |
| Device short name | XY2CED |
| Housing colour | Red RAL 3000 |
| Overtoltage category | Class I conforming to EN/IEC 61140 |

Complementary

| | |
|--|---|
| Local signalling | Without pilot light |
| Number of cables | 2 |
| Trigger cable maximum length | 2 x 100 m |
| Bellow material | Nitril |
| Body material | Zamak |
| Cover material | Stainless steel |
| Reset | By flush push-button |
| Contacts type and composition | 2 x (1 NC + 1 NO) |
| Contact operation | Slow-break |
| Trigger cable anchor point | RH and LH sides |
| Connections - terminals | Screw clamp terminal 1 x 0.5...2 x 1.5 mm ² |
| Tightening torque | 7.08...10.62 lbf.in (0.8...1.2 N.m) |
| Cable entry number | 3 tapped entry 1/2" NPT conduit entry |
| Safety level | Can reach category 4 with the appropriate monitoring system and correctly wired conforming to EN/ISO 13849-1 Can reach PL = e with the appropriate monitoring system and correctly wired conforming to EN/ISO 13849-1 Can reach SIL 3 with the appropriate monitoring system and correctly wired conforming to EN/IEC 61508 |
| Safety reliability data | B10d = 300000 with value given for a life time of 20 years limited by mechanical or contact wear conforming to IEC 60947-5-5 |
| Marking | CE |
| Mechanical durability | 60000 cycles |
| Distance between cable supports | 3...5 m |
| [Ie] rated operational current | 3 A at 240 V AC-15, A300 conforming to EN/IEC 60947-5-1 appendix A 0.27 A at 250 V DC-13, Q300 conforming to EN/IEC 60947-5-1 appendix A |
| [Ithe] conventional enclosed thermal current | 10 A |
| [Ui] rated insulation voltage | 500 V (degree of pollution: 3) conforming to EN/IEC 60947-1 300 V (degree of pollution: conforming to UL 508 300 V (degree of pollution: conforming to CSA C22.2 No 14 |
| [Uimp] rated impulse withstand voltage | 6 kV conforming to EN/IEC 60947-1 |
| Positive opening | With conforming to EN/IEC 60947-5-1 |
| Resistance across terminals | <= 25 MOhm conforming to EN/IEC 60255-7 category 3 |
| Short-circuit protection | 10 A by gG cartridge fuse conforming to EN/IEC 60269 |
| Terminals description ISO n°1 | (13-14)NO (21-22)NC |
| Product weight | 4.19 lb(US) (1.9 kg) |

Environment

| | |
|---------------------------------------|---|
| standards | EN/IEC 60204-1 EN/IEC 60947-5-1 EN/IEC 60947-5-5 EN/ISO 13850 UL 508 Machinery directive 2006/42/EC CSA C22.2 No 14 Work equipment directive 2009/104/EC |
| product certifications | UL category NISD emergency stop devices CSA CCC EAC |
| protective treatment | TC |
| ambient air temperature for operation | -13...158 °F (-25...70 °C) |
| ambient air temperature for storage | -40...158 °F (-40...70 °C) |
| vibration resistance | 10 gn (f = 10...300 Hz) conforming to EN/IEC 60068-2-6 |
| shock resistance | 50 gn 11 ms conforming to EN/IEC 60068-2-27 |
| IP degree of protection | IP66 conforming to IEC 60529 |

Offer Sustainability

| | |
|--|--|
| Green Premium product | Green Premium product |
| Compliant - since 1532 - Schneider Electric declaration of conformity | Compliant - since 1532 - Schneider Electric declaration of conformity |
| Reference not containing SVHC above the threshold | Reference not containing SVHC above the threshold |
| Available | Available |
| Need no specific recycling operations | Need no specific recycling operations |
| WARNING: This product can expose you to chemicals including: | WARNING: This product can expose you to chemicals including: |
| Diisononyl phthalate (DINP), which is known to the State of California to cause cancer, and | Diisononyl phthalate (DINP), which is known to the State of California to cause cancer, and |
| Di-isodecyl phthalate (DIDP), which is known to the State of California to cause birth defects or other reproductive harm. | Di-isodecyl phthalate (DIDP), which is known to the State of California to cause birth defects or other reproductive harm. |
| For more information go to www.p65warnings.ca.gov | For more information go to www.p65warnings.ca.gov |

Dimensions

Without Tensioner

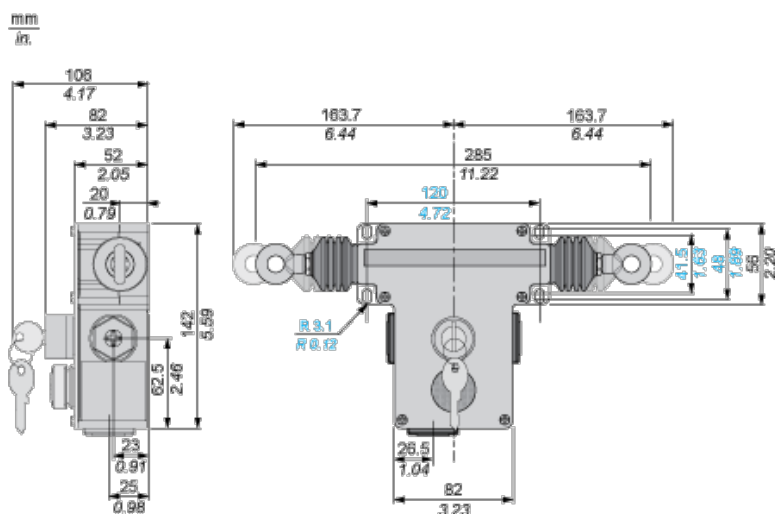

With Tensioners

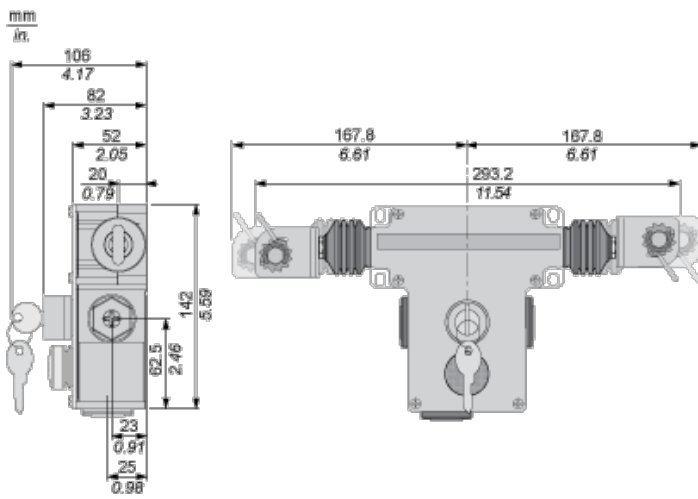

Electrical Curves

AC Supply 50/60 Hz. \sim Inductive Circuit

2-pole Contact Block

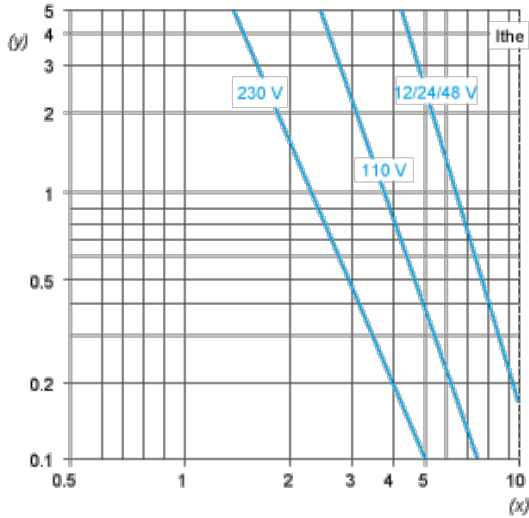

(y) Millions of operating cycles

(x) Current in A

DC Supply. Power Broken in W for 1 Million Operating Cycles. \sim Inductive Circuit

| | | | | |
|---------|---|----|----|-----|
| Voltage | V | 24 | 48 | 120 |
| \sim | W | 13 | 9 | 7 |

Mounting and Clearance

Adjustment Values (With End Spring)

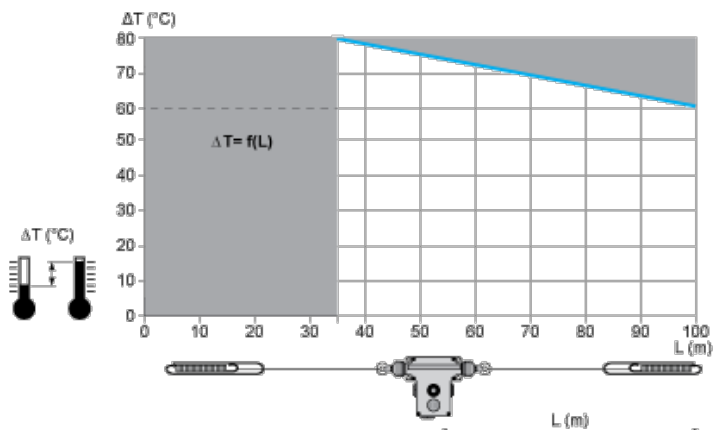

In Prohibited zone
grey :