

REMOVABLE CARTRIDGE OF DETECTOR

R451.950.000

0.01 - 12.4 GHZ

Series : **DETECTOR**

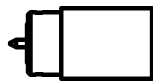
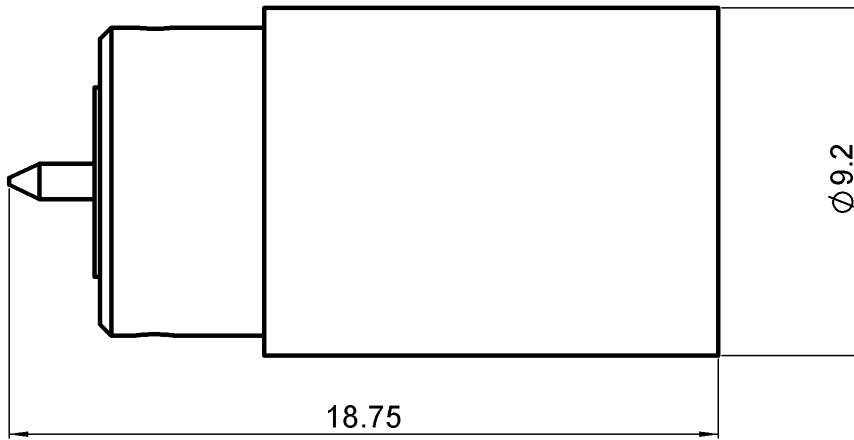

SCALE 1:1

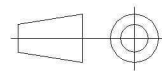
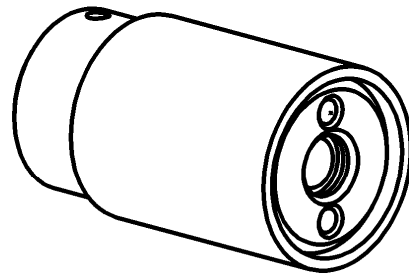

All dimensions are in mm.

Weight **7,0400 g**

Specification

Issue : 1110 F

In the effort to improve our products, we reserve the right to make changes judged to be necessary.

REMOVABLE CARTRIDGE OF DETECTOR**R451.950.000****0.01 - 12.4 GHZ**Series : **DETECTOR**ELECTRICAL CHARACTERISTICS :

Frequency Range :	0.01 – 12.4 GHz
Impedance :	50 Ohms
Polarity :	Negative
Frequency response :	
0.01- 8 GHz :	± 0.2 dB / Octave
0.01 – 12.4 :	± 0.5 dB
VSWR :	
0.01 – 8 GHz :	1.35
8 – 12.4 GHz :	1.50
Sensitivity :	
Low Level (Input power < -20 dBm) :	> 500 mV/mW
High Level (Input power = 0.35 mW):	> 100 mV
Tangential Sensitivity :	-44 dBm mini
Square Low Response Limit :	-12 dBm
Video Impedance :	1 kΩ Typical
Video capacity :	20 pF Typical
Average Power (CW) :	200 mW max
Schottky Diode Zero Bias	

Issue : 1110 F

In the effort to improve our products, we reserve the right to make changes judged to be necessary.

RADIALL 