

**Features**

- High Rejection
- Low Loss
- Symmetrical Attenuation

**Description**

Rugged mount, silver (Ag) coated ceramic filter. Developed for use in TCAS applications.

Weight: 20.4 grams typical

Material: Filter is composed of a ceramic block plated with Ag and a bracket made of 60-40 tin lead plated cold roll steel.

Filter complies with RoHS standards.

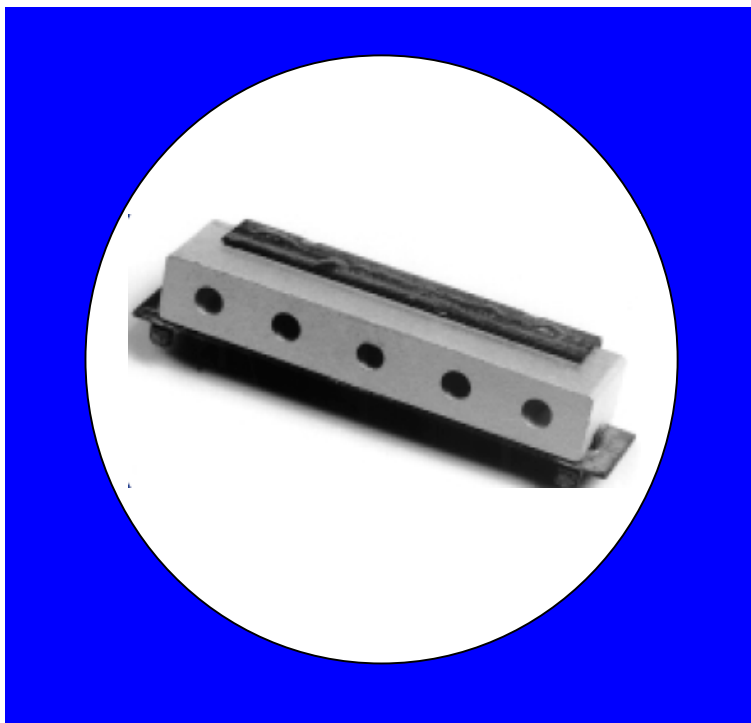
**Electrical Specifications**

| Parameter               | Frequency (MHz) | Typical @ 25°C | Spec. @ 25°C |
|-------------------------|-----------------|----------------|--------------|
| Passband Insertion Loss | 1025-1035       | 2.0 dB         | 2.5 dB max   |
| Passband Return Loss    | 1025-1035       | 15.0 dB        | 10.0 dB min  |
| Attenuation             | 1000            | 25.0 dB        | 18.0 dB min  |
|                         | 1100            | 45.0 dB        | 35.0 dB min  |

Note: Supplier shall test each filter to the critical electrical specifications of the above table. Any subsequent audits may deviate from in value due to measurement repeatability among different test systems. Such deviations shall not exceed the following limits:

| Specification Allowance |        |
|-------------------------|--------|
| Insertion Loss          | 0.1 dB |
| Return Loss             | 1.0 dB |
| Stopbands               | 1.0 dB |

## Mechanical Drawing

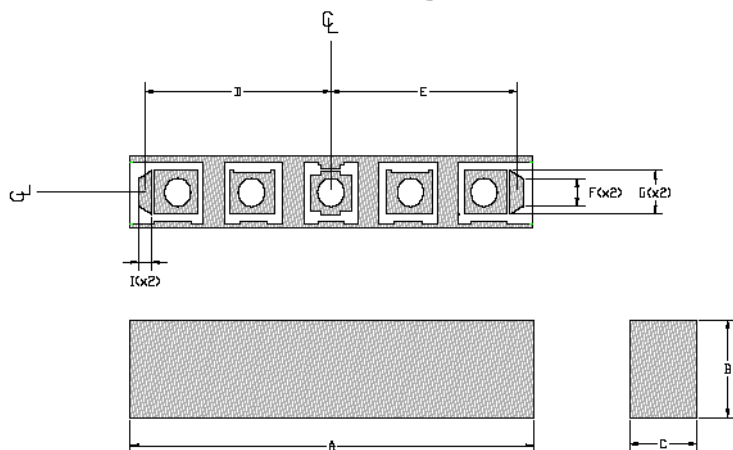

| Dim | Nominal (mm) | Tolerance (mm)<br>+/- or max |
|-----|--------------|------------------------------|
| A   | 47.95        | max                          |
| B   | 10.8         | max                          |
| C   | 7.85         | max                          |
| D   | 22.1         | 0.127                        |
| E   | 22.1         | 0.127                        |
| F   | 3.05         | 0.127                        |
| G   | 4.83         | 0.127                        |
| H   |              |                              |
| I   | 1.53         | 0.127                        |

## Electrical response

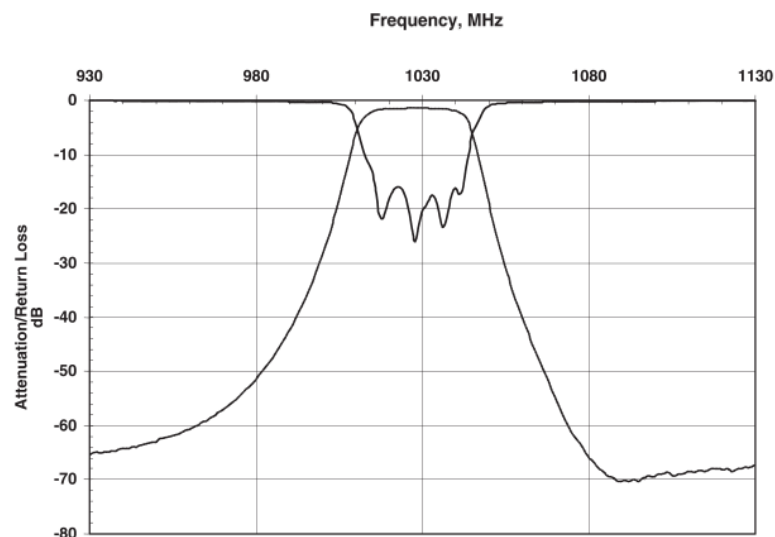

## PCB Layout

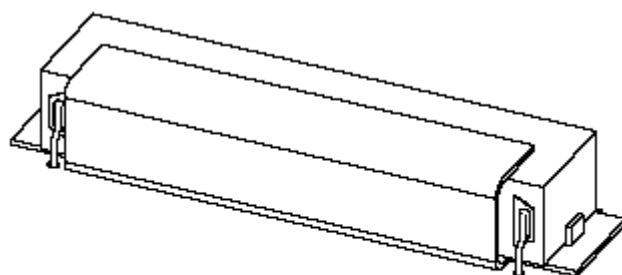

MOUNTING VARIES BY INDIVIDUAL CUSTOMER.

## Packaging and Marking

This product is shipped in pre-formed foam trays.

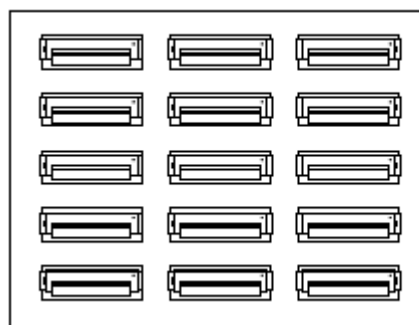
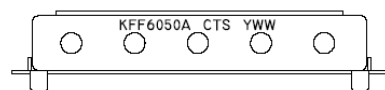

7 15 Slot Foam Trays

(100 max per box)