

SECTION A-A
SCALE 4:1

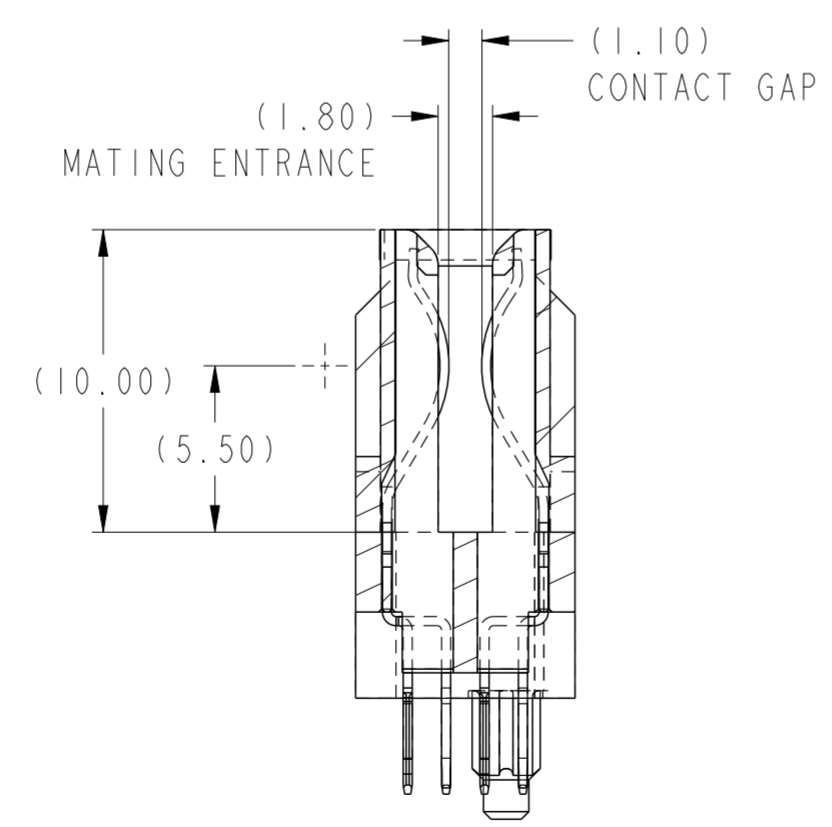

SECTION B-B
SCALE 4:1

| REV | ECN NO. | DR | DATE |
|-----|-----------------|----|------------|
| A | --- | HZ | 2012-06-11 |
| B | ELX-DG-012357-1 | JW | 2012-07-31 |
| | | | |
| | | | |

| | | | | | | | | | | |
|---------------|---------------------------------------|---------|----------------|-------------|------------------------|--------------|--------|-----------------|-----------|----------|
| spec ref | - | dr | Wei-Long Zhang | 2012/05/11 | projection | MM | size | A2 | scale | 1:1 |
| tolerance std | ISO 406 ISO 1101 | eng | Wei-Long Zhang | 2012/07/31 | | | ecn no | ELX-DG-012357-1 | rel level | Released |
| surface | ISO 1302 | chr | - | apppr | | | | | | |
| linear | 0.X ±0.3 0.XX ±0.10 0.XXX ±0.05 | angular | 0° ±2° | www.fci.com | Product - Customer Drw | sheet 1 of 4 | rev | B | | |

PDS: Rev :B

STATUS:Released

Printed: Jul 31, 2012

Copyright FCI.
FCI

| CONTACT TYPE | TOP LAYER DESCRIPTION | TABLE 1 (HPCE / SOLDER TAILS) PLATED THROUGH-HOLE REQUIREMENTS | | | | |
|----------------|-----------------------|---|------------------|--------------------|---------------|------------------------|
| | | DRILLED HOLE DIAMETER | COPPER THICKNESS | TIN-LEAD THICKNESS | TIN THICKNESS | FINISHED HOLE DIAMETER |
| POWER & SIGNAL | TIN-LEAD | 1.10-1.16 (1.15 DRILL) | 0.025 - 0.050 | 0.005 - 0.015 | -- | 0.94 - 1.10 |
| | IMMERSION TIN | 1.10-1.16 (1.15 DRILL) | 0.025 - 0.050 | -- | 0.9 - 1.5um | 0.94 - 1.10 |
| | COPPER (SEE NOTE 8) | 1.10-1.16 (1.15 DRILL) | 0.025 - 0.050 | -- | -- | 0.94 - 1.10 |

| CONTACT TYPE | TOP LAYER DESCRIPTION | TABLE 2 (HPCE / PRESS-FIT TAILS) PLATED THROUGH-HOLE REQUIREMENTS | | | | |
|----------------|-----------------------|--|------------------|--------------------|---------------|------------------------|
| | | DRILLED HOLE DIAMETER | COPPER THICKNESS | TIN-LEAD THICKNESS | TIN THICKNESS | FINISHED HOLE DIAMETER |
| POWER & SIGNAL | TIN-LEAD | 0.81-0.86 (0.85 DRILL) | 0.025 - 0.050 | 0.005 - 0.015 | -- | 0.65 - 0.80 |
| | IMMERSION TIN | 0.81-0.86 (0.85 DRILL) | 0.025 - 0.050 | -- | 0.9 - 1.5um | 0.70 - 0.80 |
| | COPPER (SEE NOTE 8) | 0.81-0.86 (0.85 DRILL) | 0.025 - 0.050 | -- | -- | 0.70 - 0.80 |

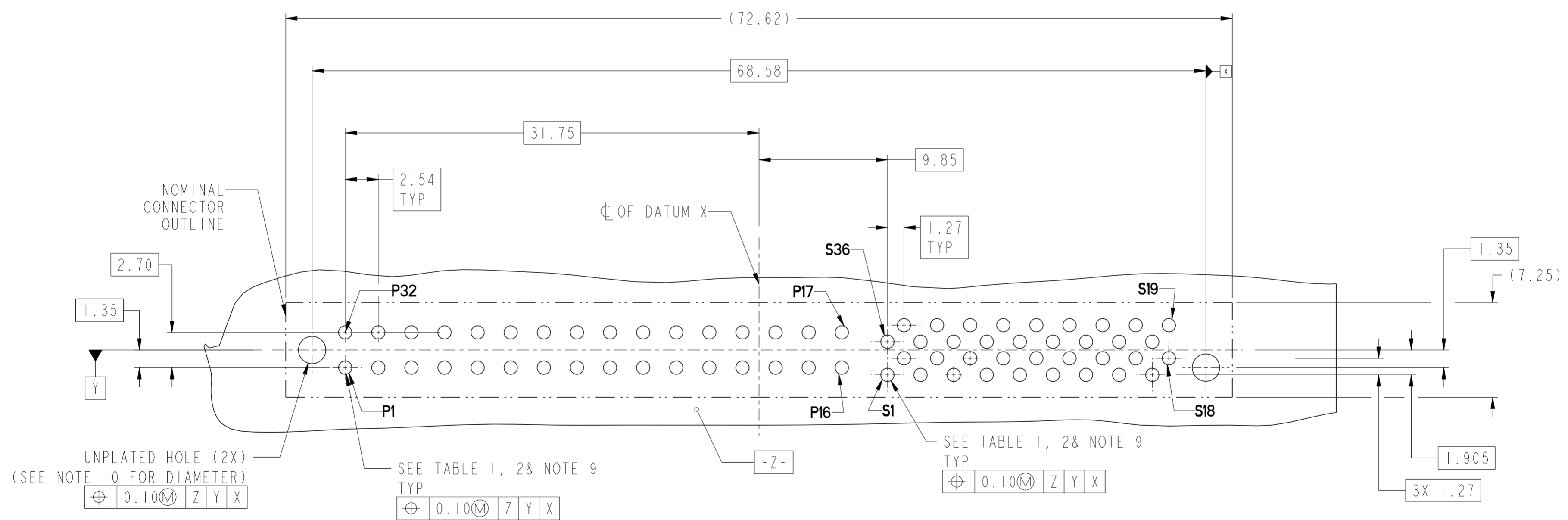

Copyright FCI.

| | | | | | | | | | | |
|---------------------------------------|---------------------|---------|----------------|---------------|-------------|----|--|-----------------|-------------------------------------|----------|
| spec ref | - | dr | Wei-Long Zhang | 2012/05/11 | projection | MM | size | A2 | scale | 1:1 |
| tolerance std | ISO 406 ISO 1101 | eng | Wei-Long Zhang | 2012/07/31 | | | ecn no | ELX-DG-012357-1 | rel level | Released |
| TOLERANCES UNLESS OTHERWISE SPECIFIED | | chr | - | apppr | | | | | | |
| surface | ISO 1302 | linear | 0.X | ± 0.3 | | | VERT RECT 32P + 36S HIGH POWER CARD EDGE | | dng no 10121037 | rev B |
| | | angular | 0° | $\pm 2^\circ$ | www.fci.com | | cat. no. | | Product - Customer Drw sheet 2 of 4 | |

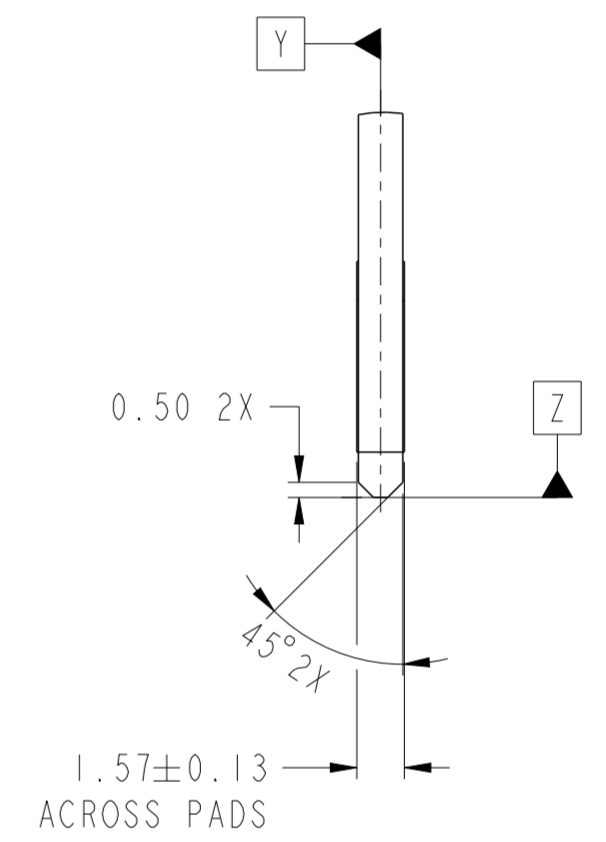
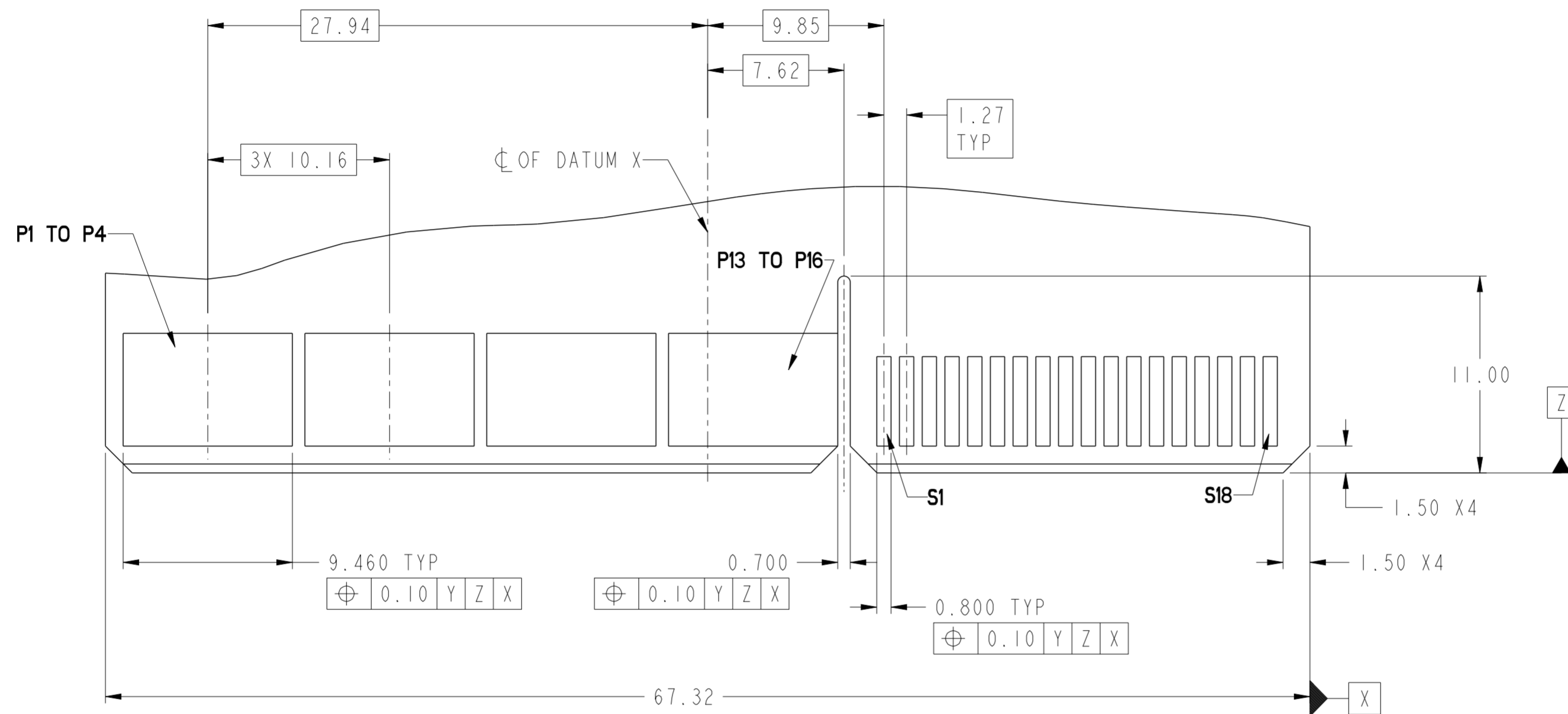

Copyright FCI.
FCI

| | | | | | | | | | | |
|---------------------------------------|---------------------|---------|----------------|------------|------------|--|--------------------|-----------------|------------------------|----------------|
| spec ref | - | dr | Wei-Long Zhang | 2012/05/11 | projection | MM | size | A2 | scale | 1:1 |
| tolerance std | ISO 406 ISO 1101 | eng | Wei-Long Zhang | 2012/07/31 | | | ecn no | ELX-DG-012357-1 | | |
| TOLERANCES UNLESS OTHERWISE SPECIFIED | | chr | - | appr | | | | Pai-Ming Zheng | 2012/07/31 | product family |
| surface | ISO 1302 | linear | 0.X | ±0.3 | | VERT RECT 32P + 36S HIGH POWER CARD EDGE | dwg no 10121037 | rev B | Product - Customer Drw | |
| | | angular | 0° | ±2° | | | | | cat. no. | sheet 3 of 4 |
| | | | | | | | | | | |

PDS: Rev :B

STATUS:Released

Printed: Jul 31, 2012

HPCE PART NUMBER (TABLE 3)

| PART NUMBER | TAIL TYPE | ORIENTATION KEY | DIM "A" TYPICAL TAIL LENGTH | DIM "B" RECOMMENDED BOARD THICKNESS |
|----------------|-----------|-----------------|-----------------------------|-------------------------------------|
| 10121037-001LF | SOLDER | YES | 3.17 ±0.25 | 1.59 - 2.38 |
| 10121037-002LF | SOLDER | NO | | |
| 10121037-003LF | PRESS-FIT | YES | 3.17 ±0.25 | 1.57 MIN |
| 10121037-004LF | PRESS-FIT | NO | | |

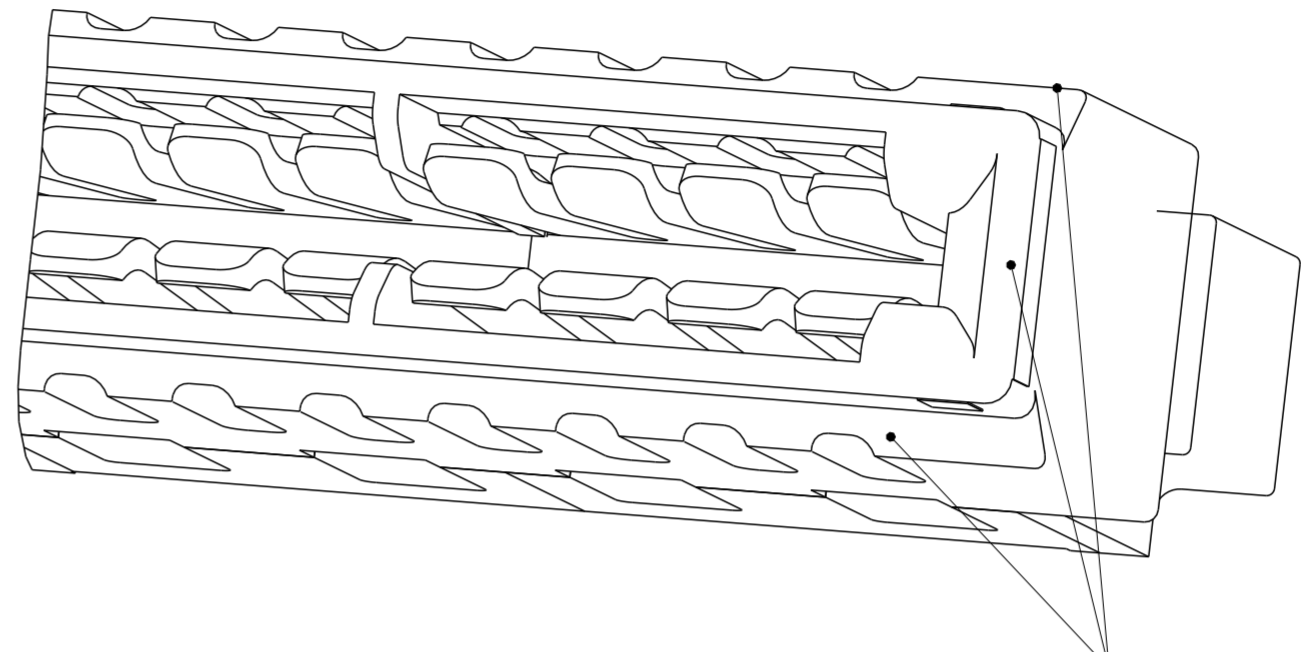

DETAIL VIEW FOR AROUND ENHANCE WALL

NOTES:

1. CONNECTOR MATERIALS:
 HOUSING: HIGH TEMPERATURE THERMAL PLASTIC, BLACK
 UL 94V-0 COMPLIANT
 CONTACTS: HIGH PERFORMANCE COPPER ALLOY.
2. CONTACT FINISH REF. GS-12-604 SECTION 5.2.
3. PRODUCT SPECIFICATION: GS-12-604.
4. APPLICATION SPECIFICATION: GS-20-128.
5. PRODUCT MARKING (FCI - PART NUMBER & DATE CODE) ON HOUSING IN AREA SHOWN.
6. PACKAGING MEETS FCI SPECIFICATION GS-14-937.
7. HOUSING COMPONENT WILL WITHSTAND EXPOSURE TO 260°C PEAK TEMPERATURE FOR 60 SECONDS IN A CONVECTION, INFRA-RED, OR VAPOR PHASE REFLOW OVEN.
8. COPPER PLATING THICKNESS IN CENTER OF VIA-HOLE CAN BE NO MORE THAN 0.003 LESS THAN OTHER AREAS.
9. ALL HOLE SIZES ARE FINISHED HOLE SIZES.
10. MOUNTING HOLES ARE UNPLATED
 \varnothing 2.40 +/- 0.1 FOR PRESS-FIT TAILS
 $\Delta\varnothing$ 2.18 +/- 0.03 FOR SOLDER TAILS
11. PRESS FIT APPLICATION TOOL DRAWING : 10119453.
12. Δ SYMBOL WILL BE NEXT TO ANY DIMENSION, VIEW OR NOTE WHICH HAS BEEN MODIFIED WITH THE CURRENT DRAWING REVISION.

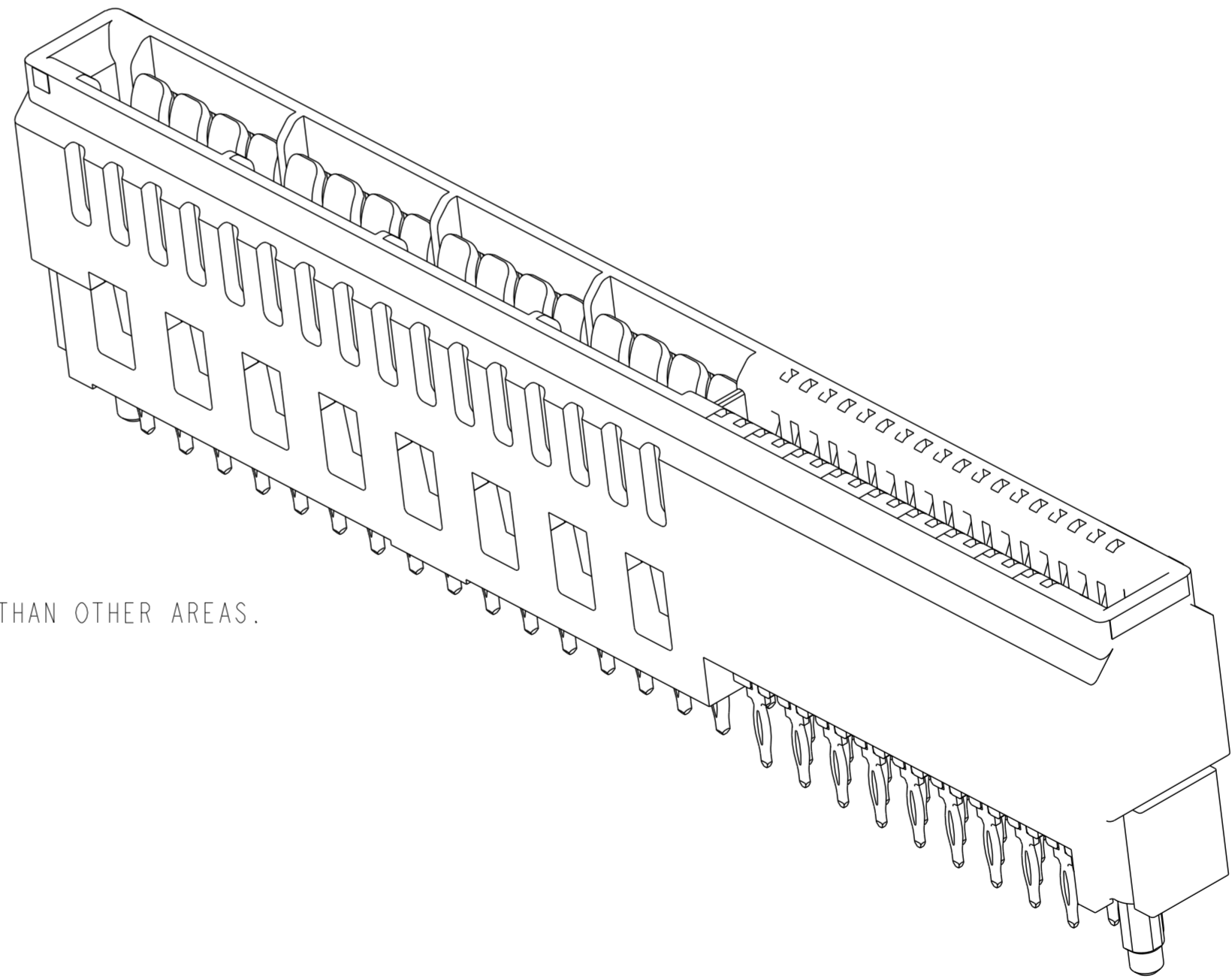

Copyright FCI. FCI

| | | | | | | | | | | |
|---------------|---------------------------------------|---------|----------------|------------|-------------|----------|------------------------|-----------------|----------------|-----------|
| spec ref | - | dr | Wei-Long Zhang | 2012/05/11 | projection | MM | size | A2 | scale | 1:1 |
| tolerance std | ISO 406 ISO 1101 | eng | Wei-Long Zhang | 2012/07/31 | | | ecn no | ELX-DG-012357-1 | | |
| surface | ISO 1302 | chr | - | app | | | Pei-Ming Zheng | 2012/07/31 | product family | rel level |
| linear | 0.X ±0.3 0.XX ±0.10 0.XXX ±0.05 | angular | 0° | ±2° | www.fci.com | cat. no. | Product - Customer Drw | sheet 4 of 4 | rev | B |