

THIS IS ISSUED IN STRICT CONFIDENCE THAT IT IS NOT USED AS A BASIS FOR MANUFACTURE OR SALE AND THAT IT IS NOT COPIED, REPRINTED OR DISCLOSED TO A THIRD PARTY EITHER WHOLLY OR IN PART WITHOUT THE PRIOR WRITTEN CONSENT OF CAL TEST ELECTRONICS, INC.

REVISIONS			
REV.	DESCRIPTIONS	DATE	APPROVED
—	CLASS A RELEASED	7/12/99	

- ADAPTER, 4mm BANANA PLUG WITH 4mm BANANA JACK.
- SPECIFICATIONS:
INSULATOR: POLYACETAL
PLUG BODY: BRASS, NICKEL PLATED
SPRING BODY: BERYLLIUM COPPER, NICKEL PLATED
- RATING:
CURRENT: 10A MAX.
RESISTANCE: $<0.8\text{m}\Omega$.
TEMPERATURE: -20°C TO $+80^{\circ}\text{C}$.

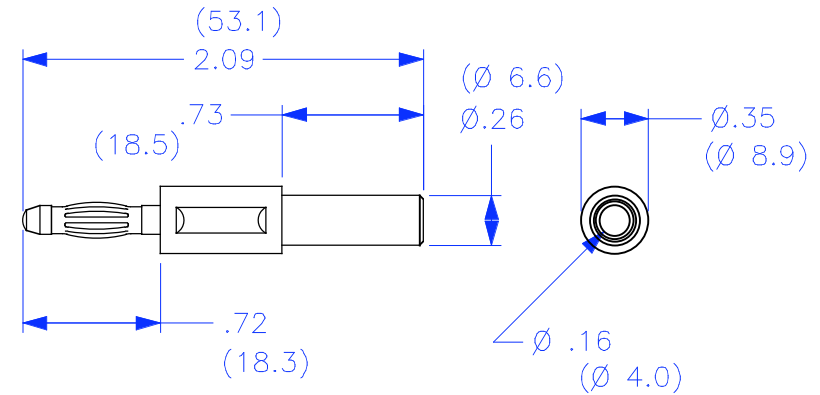

PART NUMBER

CT2473-#

COLOR: 0 — BLACK
2 — RED
4 — YELLOW
5 — GREEN
6 — BLUE
9 — WHITE

THIRD ANGLE PROJECTION		UNLESS OTHERWISE SPECIFIED DIMENSIONS ARE IN INCHES TOLERANCES ARE: FRACTIONS DECIMALS $\pm 1/32$.XX $\pm .02$.XXX $\pm .005$ DO NOT SCALE DRAWING		CONTRACT NO.		Cal Test Electronics 22820 Savi Ranch Parkway Yorba Linda, CA 92887-4610			
				APPROVALS		TITLE			
		MATERIAL	FINISH	DRAWN WDH		DATE 7/12/99		4mm BANANA PLUG ADAPTER w/4mm JACK	
				CHECKED					
				ENGR.				SIZE A	
NEXT ASSY				DESIGN ACTIVITY				CAGE CODE 43F45	
APPLICATION								DWG. NO. P247300	
								REV. —	
						SCALE 1:1		SHEET 1 OF 1	