

10137237 - 0 0 X 0 LF

1. TYPE 1 (Use Tray Packing)
2. TYPE 2 (Use Tape / Reel Packing)



(SEE 2.6 MIN
NOTE 3)

Creo File - REV E - 2016-02-12

PART NUMBER	DESCRIPTION	POS
10137237-0010LF	TYPE I SMT RIGHT ANGLE	8
10137237-0020LF	TYPE II SMT RIGHT ANGLE	8

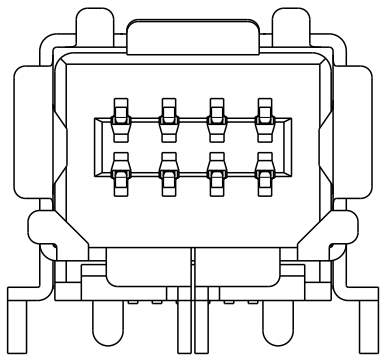

10137237-0020LF
D-SHAPE TYPE 2

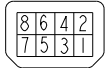

CIRCUIT NO.

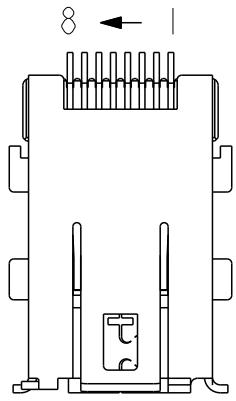

10137237-0010LF
D-SHAPE TYPE 1

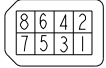

CIRCUIT NO.

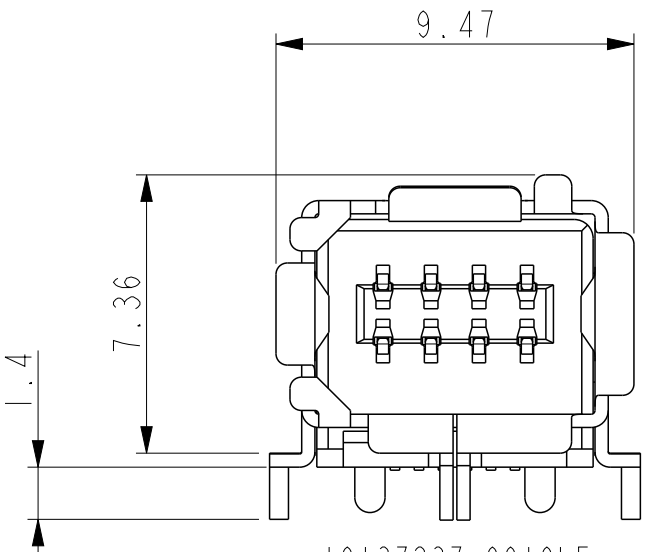
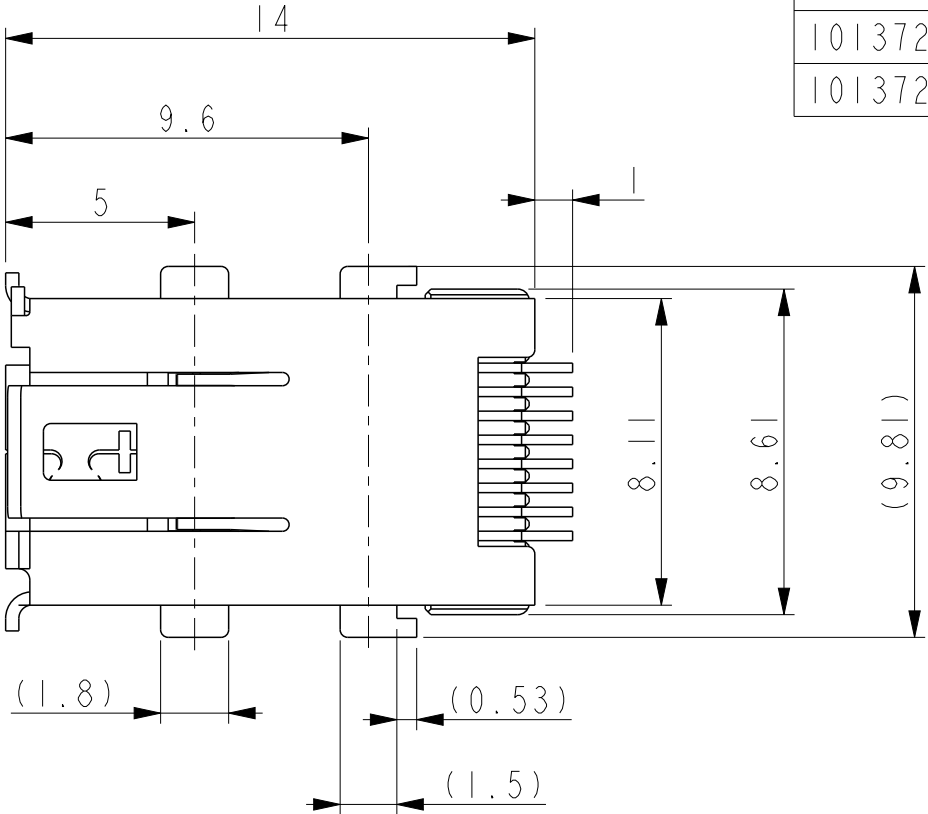

10137237-0010LF
D-SHAPE TYPE 1

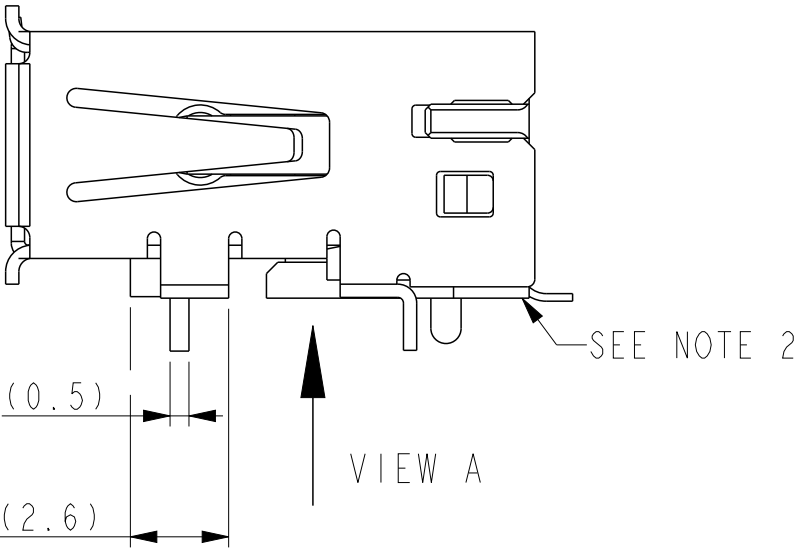

SEE NOTE 2

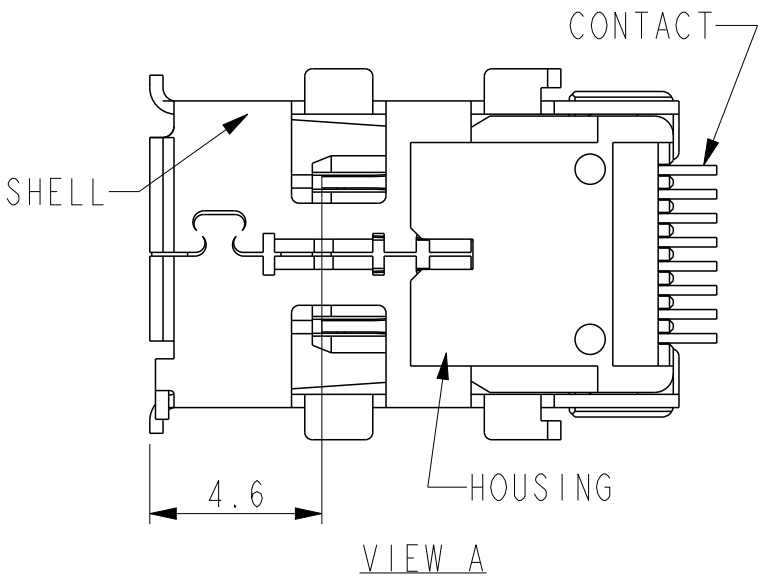
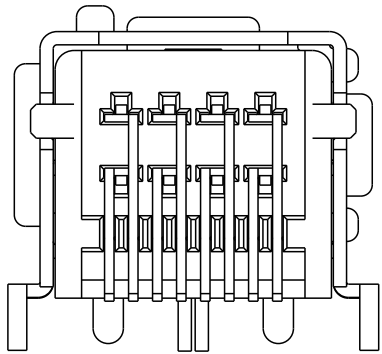

spec ref		GS-12-1345			dr		A P Sawanth		2016/07/12		projection		mm		size		A3		scale		5:1																
tolerance std		TOLERANCES UNLESS OTHERWISE SPECIFIED			eng		Mike Zhou		2017/08/14						ecn no		ELX-N-27705-1																				
ISO 406					chr		-		-																												
ISO 1101					appr		Tim Yao		2017/08/15								product family		rel level						Released												
surface		linear		0.X		±0.3		Amphenol FCI		title		MINI I/O CONN										dwg no		10137237										rev		C	
				0.XX		±-																															
				0.XXX		±-																															
ISO 1302		angular		0°		±-°				cat. no.		Product - Customer Drw										sheet 2 of 2															