

# R135-Series

## Rotary Switches

The R135 and R135A-Series rotary switches are single pole, single throw "L" rated up to 3A, feature an ON-OFF repeating action, and are available with a nylon actuating knob; nylon snap-in bracket or nickel-plated brass bushing. These switches are typically used to control lighting functions.



**Carling Technologies®**

Innovative Designs. Powerful Solutions.

INNOVATIVE DESIGNS. POWERFUL SOLUTIONS.

Carling Technologies, Inc.  
60 Johnson Avenue • Plainville, CT 06062-1177  
Phone: (860) 793-9281 • Fax: (860) 793-9231  
Email: [sales@carlingtech.com](mailto:sales@carlingtech.com) • [www.carlingtech.com](http://www.carlingtech.com)

### Dielectric Strength

UL/CSA: 1000V - live to dead metal parts

### Electrical Life

100,000 cycles

### Mechanical Life

100,000 cycles

### Operating Temperature

32°F to 185°F (0°C to 85°C)

**R135-A - BL**

<sup>1</sup>  
Base Part Number

<sup>2</sup>  
Knob Color

**1 BASE PART NUMBER: SERIES/CIRCUITRY/RATING/TERMINATION**

**1.5A 250 VAC; 3A 125 VAC L; 5A 12 VDC**  
 OFF-ON repeating      .375 threaded bushing      **R135**  
 OFF-ON repeating      nylon snap-in bezel      **R135-A**

Wire Leads

**2 KNOB COLOR<sup>1</sup>**

**BL**      Black  
**WH**      White

Notes:  
 Standard Wire Leads are 6" long, stripped 1/2" black. If different length required, please specify at the end of the part number. ex. R135-A-BL/20". Panel Cut-Out Recommendations: For sheet metal panels, switch must enter panel in same direction as the punch. Burr on bottom. Test cut hole in actual material.

<sup>1</sup> Custom colors available. Consult factory.

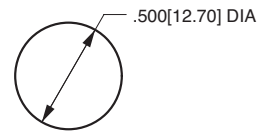
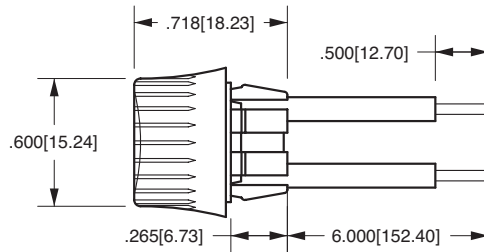
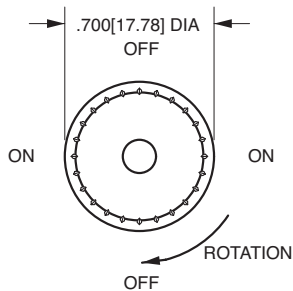

**NYLON BEZEL MOUNTING HOLE**  
 Snaps into .500[12.70] Dia. hole  
 Panel Thickness: .020[.508] to .078[1.98]

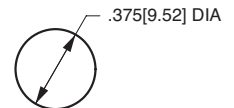

**THREADED BUSHING MOUNTING HOLE**  
 Fits into .375[9.52] Dia. hole  
 Bushing Length: .312[7.92]

\*Manufacturer reserves the right to change product specification without prior notice.