

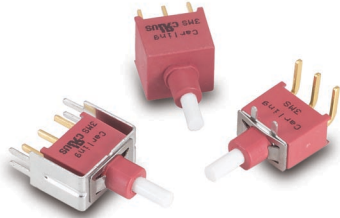

3MN-Series
Snap-Action Miniature Pushbutton Switch

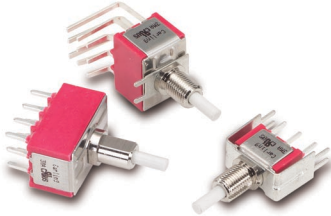

3MS-Series
Sealed Snap-Action Miniature Pushbutton Switch



3MA-Series
Alternate Action Miniature Pushbutton Switch

Specifications

Contact Rating	refer to ordering scheme
Electrical Life	50,000 make & break cycles @ full load
Contact Resistance.	<i>3MN & 3MA-Series:</i> 10 mΩ max. initial @ 2-4 VDC 100mA for both silver & gold plated contacts. <i>3MS-Series:</i> 50 mΩ max. initial @ 2-4 VDC 100mA for both silver & gold plated contacts.
Insulation Resistance . . .	1000 MΩ min.
Dielectric Strength	1500 Volts RMS @ sea level
Operating Temperature . . .	-30°C to +85°C
Index of Protection	<i>3MS -Series:</i> IP68
Cap Installation Support . .	<i>3MS-Series:</i> 10 lbs. max.
Solder Heat Resistance. . .	MIL-STD-202, Method 210
Actuator Travel25°

Materials

Case	<i>3MN & 3MA-Series:</i> Diallyl phthalate (DAP) (UL 94V-0) <i>3MS-Series:</i> Glass filled nylon 6/6, flame retardant, heat stabilized (UL 94V-0)
Plunger.	<i>3MN-Series:</i> Thermoplastic polyester, black <i>3MS & 3MA-Series:</i> Glass filled nylon or glass filled polyester (UL 94V-0)
Bushing	<i>3MN-Series:</i> Brass, nickel plated <i>3MA-Series:</i> Zinc, nickel plated
Housing.	<i>3MN & 3MA-Series:</i> Stainless Steel
Switch Support Retainer . .	<i>3MS-Series:</i> Stainless Steel
Terminal Seal	Epoxy

3M-Series Optional Cap

To order a cap assembled on a switch, specify the switch number followed by the cap part number and the word "assembled".

Ex: 3MN-SP-7-P2-B6-M6QE-C13ASSEMBLED

To order caps in bulk, specify the Series, followed by the cap. Ex.) 3MN-C13



1 SERIES OR SWITCH CATALOG NUMBER 3MN, 3MS or 3MA			
2 CAP SIZE			
C1	round 7.6mm dia.	C5	round 14.5mm dia.
C2	round 9.35 mm dia.	C6	brass chrome plated (for 3MA w/ PL bushing)
C3	square 11.7 x 11.7mm		
C4	round 5mm dia.		(for 3MA w/ PD bushing)

3 CAP COLOR			
1	white	5	yellow
2	black	6	green
3	red	7	blue
4	orange		
<small>1 Black, white & red standard. Other colors available. Consult factory.</small>			

3MN-Series Dimensional Specifications: in. [mm]

PLUNGER

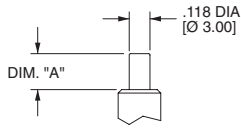

OPTION CODE	DIM. "A"
P0	.000 [0.00]
P1	.205 [5.20]
P2	.079 [2.00]

FOR B10,B11,B20,B21 ONLY

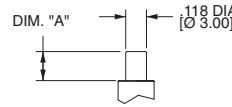

OPTION CODE	DIM. "A"
P0	.098 [2.50]
P1	.295 [7.50]
P2	.165 [4.20]

FOR B6 ONLY

ACTUATOR

AP1

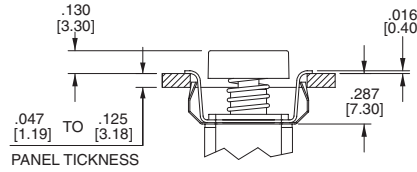
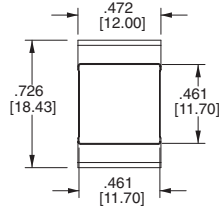

PANEL MOUNTING

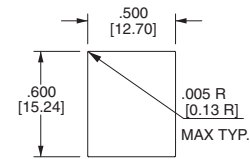

AP2

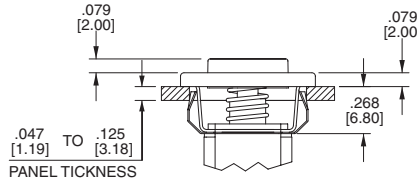
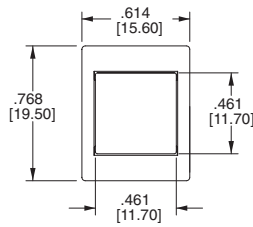

PANEL MOUNTING

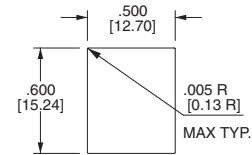

AP3

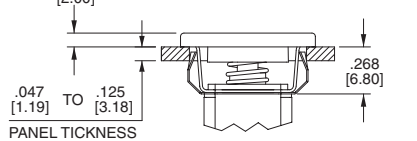
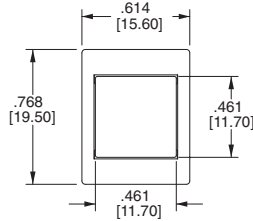

BUSHING

B10
STANDARD KEYWAY
THREADED SHOWN

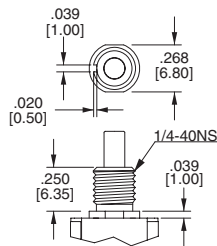

B20
STANDARD KEYWAY
NON-THREADED

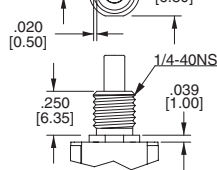

B11
THREADED SHOWN
WITH FLAT

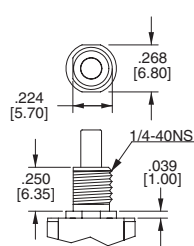

B21
NON-THREADED
WITH FLAT

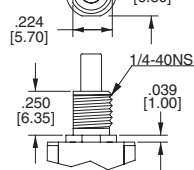

B6
NON-THREADED
(FOR TERMINATION
OPTIONS VS6-VS9 ONLY)

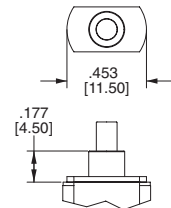

CAP

C1

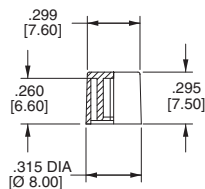

C2

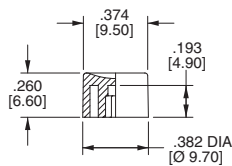

C3

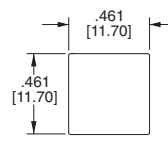

C4

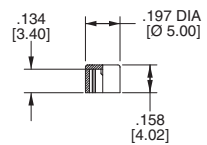

3MN-Series Dimensional Specifications: in. [mm]

TERMINATION

M1

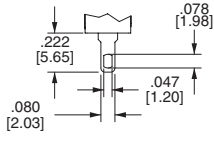

THK .030 [0.75]

M2

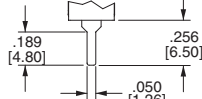

THK .030 [0.75]

M5

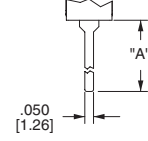

THK .030 [0.75]

OPTION CODE	DIM. "A"
M5-1	.750 [19.05]
M5-3	.425 [10.80]

SINGLE POLE

DOUBLE POLE

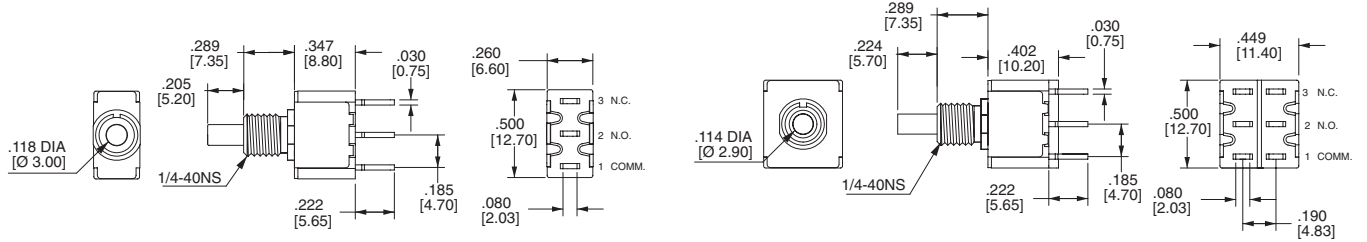

M6

SINGLE POLE

PC MOUNTING

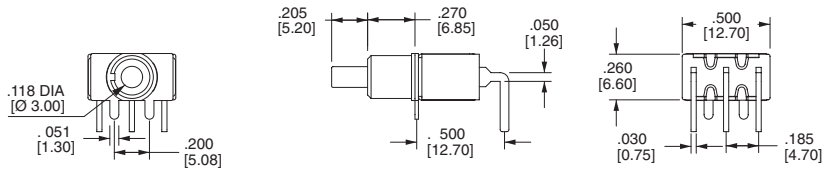

DOUBLE POLE

PC MOUNTING

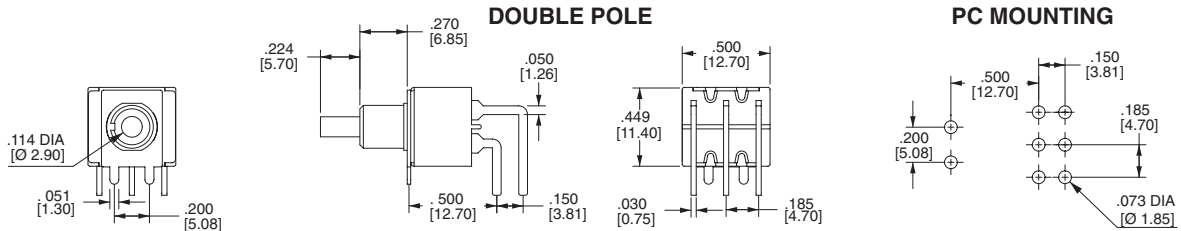

M7

SINGLE POLE

PC MOUNTING

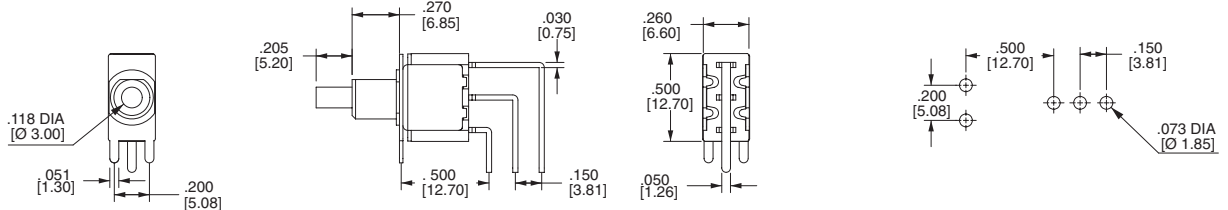

DOUBLE POLE

PC MOUNTING

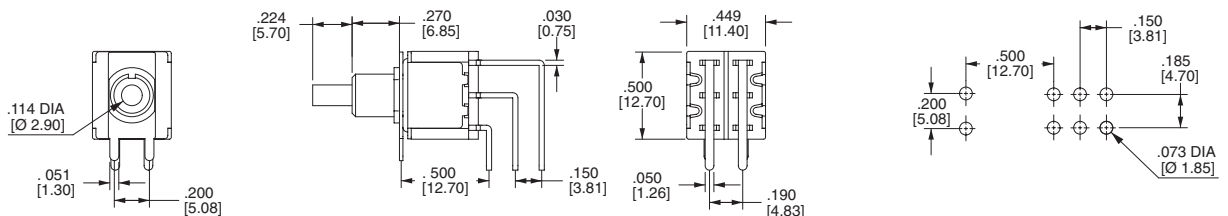

3MN-Series Dimensional Specifications: in. [mm]

TERMINATION

SINGLE POLE

OPTION CODE	DIM. "A"
VS2	.460 [11.68]
VS3	.630 [16.00]
VS7	[16.00]

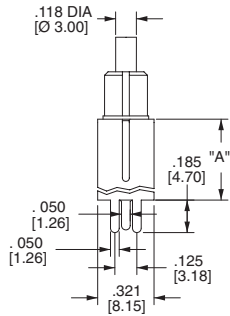

PC MOUNTING

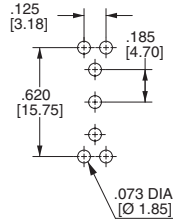

VS2-VS3

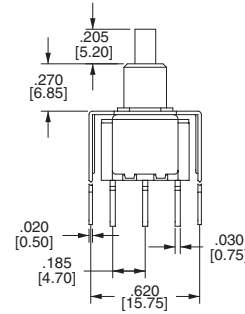

VS6-VS7 (For B6 Bushing Only)

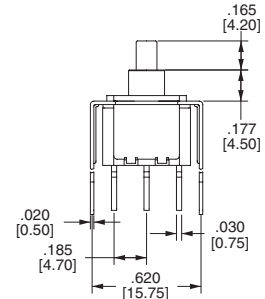

DOUBLE POLE

OPTION CODE	DIM. "A"
VS2	.460 [11.68]
VS3	.630 [16.00]
VS7	[16.00]

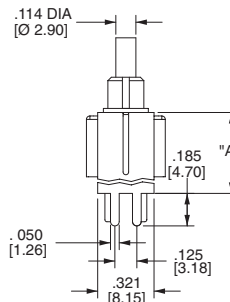

PC MOUNTING

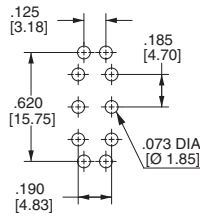

VS2-VS3

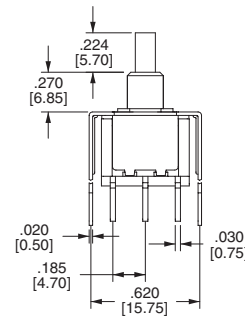

VS6-VS7 (For B6 Bushing Only)

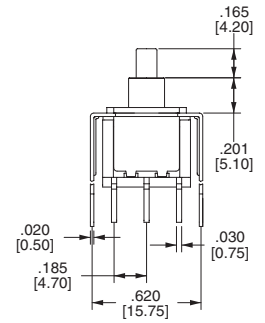

SINGLE POLE

OPTION CODE	DIM. "A"
VS4	.460 [11.68]
VS5	.630 [16.00]
VS9	[16.00]

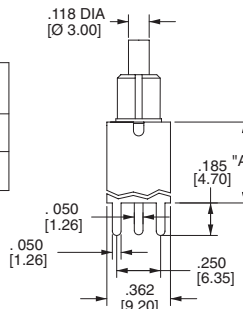

PC MOUNTING

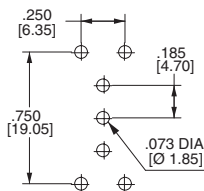

VS4-VS5

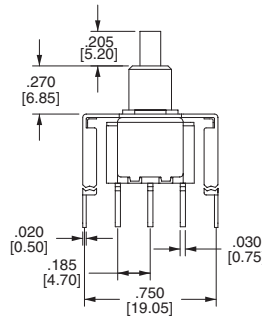

VS8-VS9 (For B6 Bushing Only)

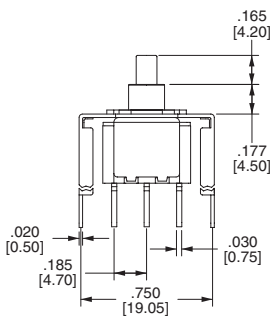

DOUBLE POLE

OPTION CODE	DIM. "A"
VS4	.460 [11.68]
VS5	.630 [16.00]
VS9	[16.00]

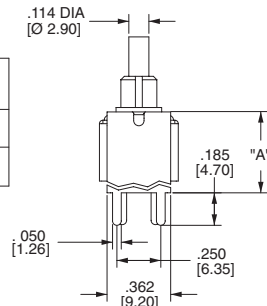

PC MOUNTING

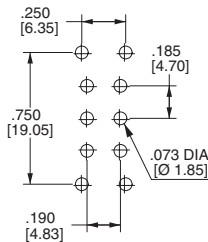

VS4-VS5

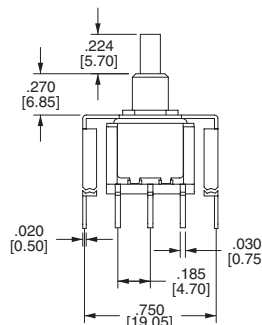

VS8-VS9 (For B6 Bushing Only)

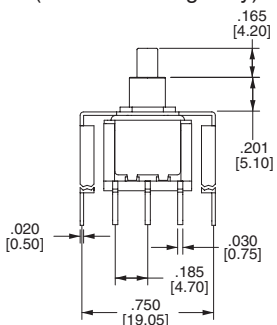

3MS-Series Dimensional Specifications: in. [mm]

PLUNGER

OPTION CODE	DIM. "A"
P1	.173 [4.40]
P2	.220 [5.60]
P3	.087 [2.20]

FOR B1 BUSHING

OPTION CODE	DIM. "A"
P1	.276 [7.00]
P2	.327 [8.30]
P3	.193 [4.90]

FOR B4 BUSHING

BUSHING

B1

B4

TERMINATION

M1

M2

SINGLE POLE

DOUBLE POLE

M6

SINGLE POLE

PC MOUNTING

DOUBLE POLE

PC MOUNTING

3MS-Series Dimensional Specifications: in. [mm]

TERMINATION

M7

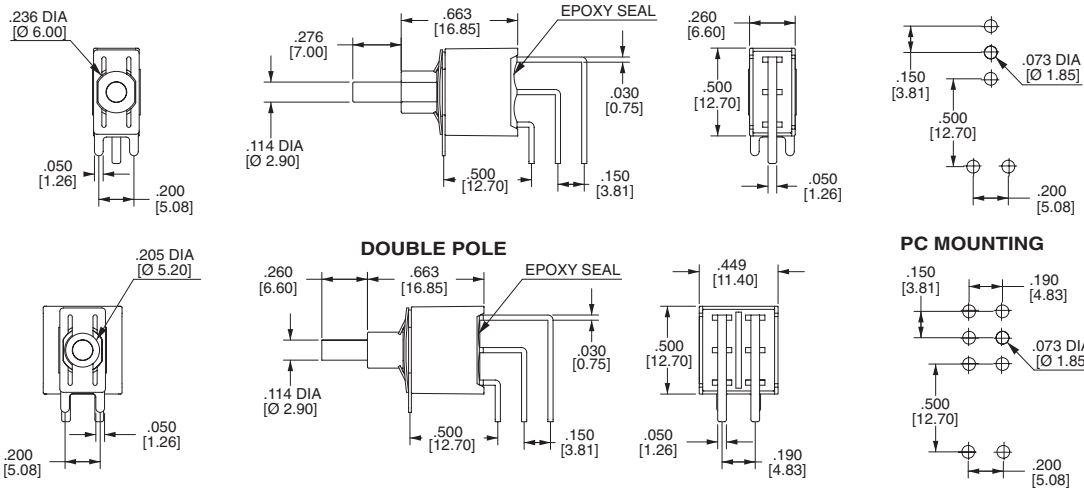

VS2-VS3

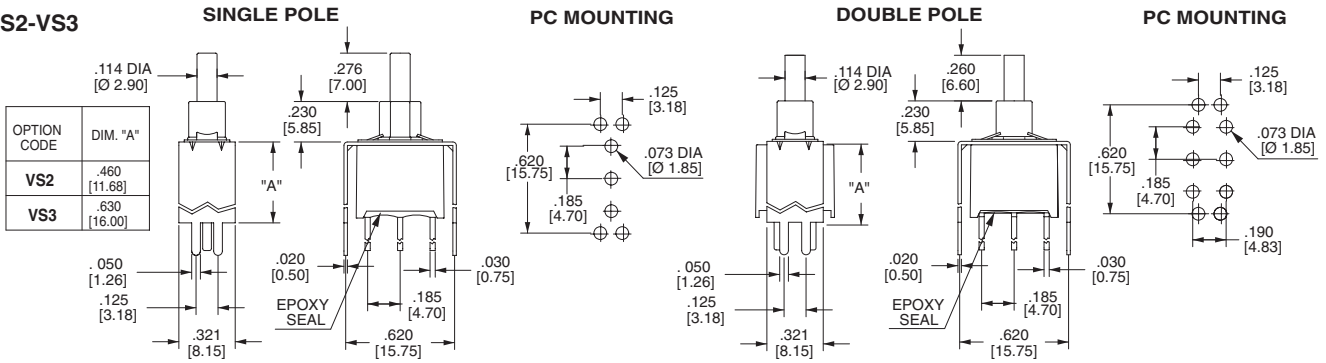

VS4-VS5

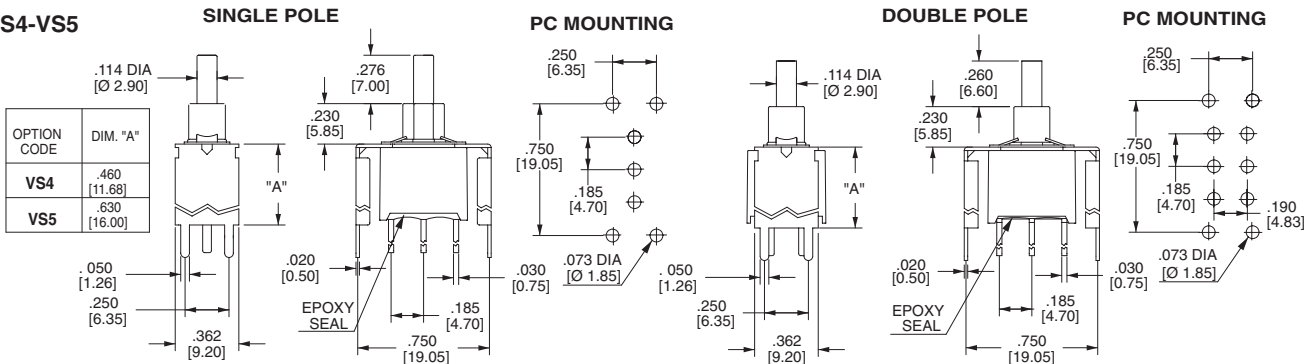

SNAP-IN TERMINATION OPTIONS

M61



M71

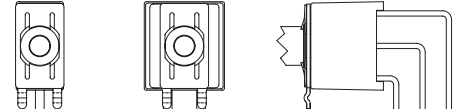

VS21, VS31

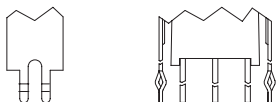

VS41, VS51

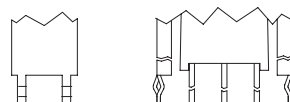

M61, M71, VS21, VS31, VS41, VS51 have the same P.C. mounting but with snap-in bracket.

3MA-Series Dimensional Specifications: in. [mm]

ACTUATOR

AP1

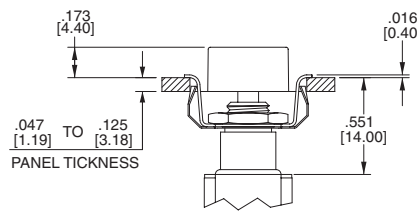
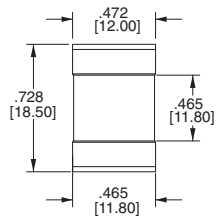

PANEL MOUNTING

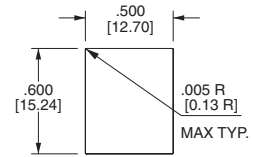

AP2

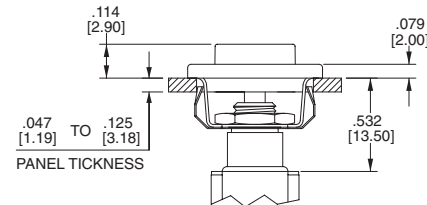
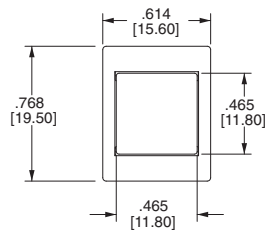

PANEL MOUNTING

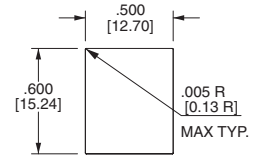

PLUNGER

PA,PI

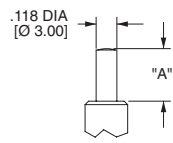

OPTION CODE	DIM. "A"
PA	.299 [7.60]
PI	.244 [6.20]

PL

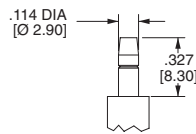

PC

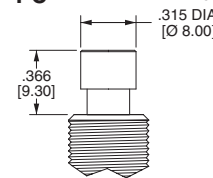

Brass Chrome Plated

PD

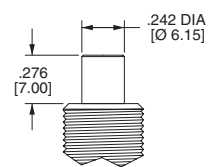

PC, PD Plunger must fit with BD bushing

CAP

C1

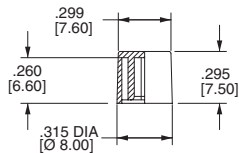

C2

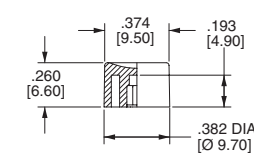

C3

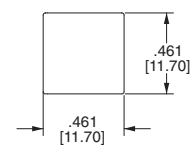

C4

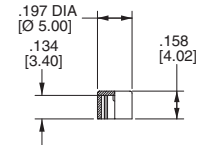

C5

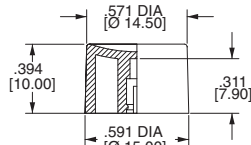

For PL Bushing Only

C6

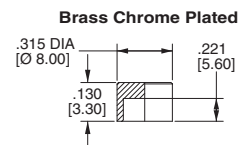

For PD Bushing Only

BUSHING

B10 Threaded
B20 Non-Threaded

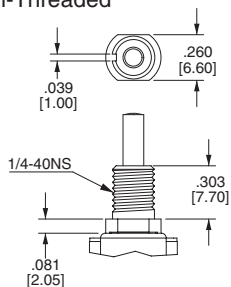

B21 Non-Threaded

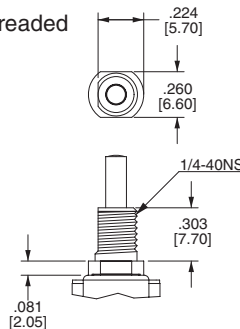

BD

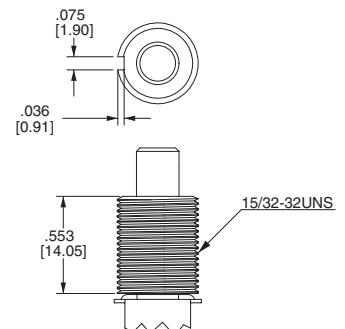

3MA-Series Dimensional Specifications: in. [mm]

TERMINATION

M1

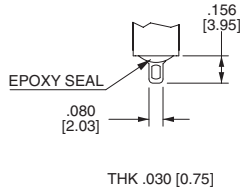

M2

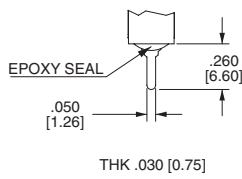

M5

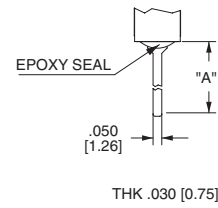

OPTION CODE	DIM. "A"
M5-1	.750 [19.05]
M5-2	.964 [24.48]
M5-3	.425 [10.80]
M5-4	1.062 [26.97]

SINGLE POLE

DOUBLE POLE

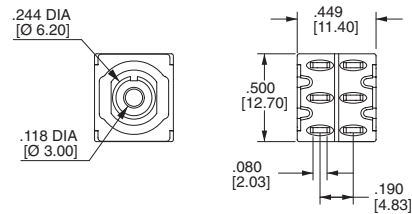
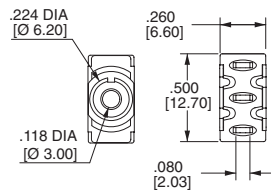
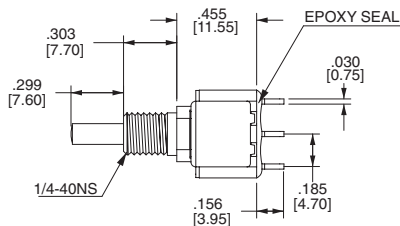

3 POLE

4 POLE

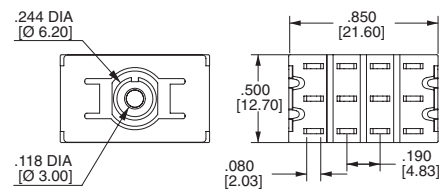
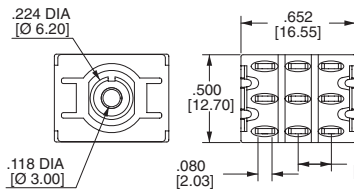
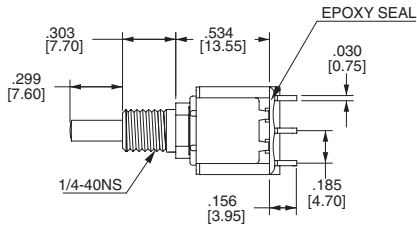

M6

SINGLE POLE

PC MOUNTING

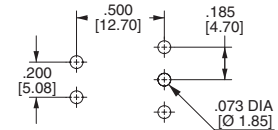
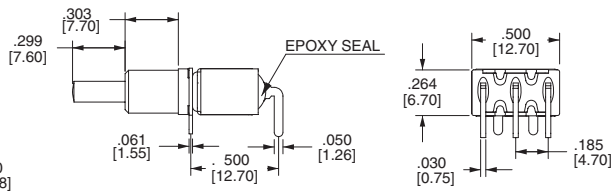
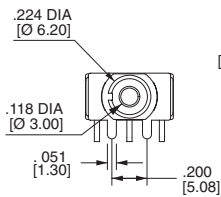

DOUBLE POLE

PC MOUNTING

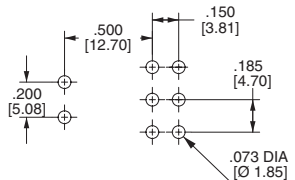
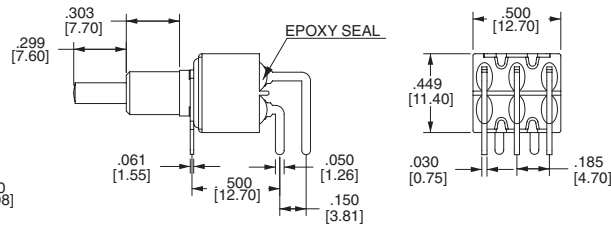
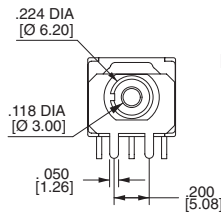

3MA-Series Dimensional Specifications: in. [mm]

TERMINATION

M7

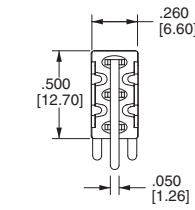
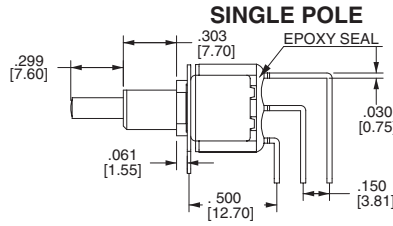
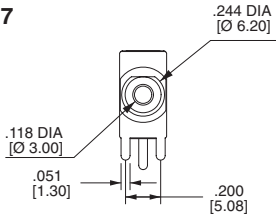

PC MOUNTING

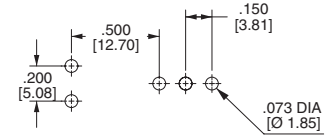

DOUBLE POLE

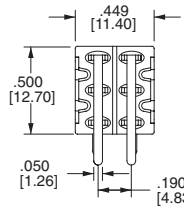
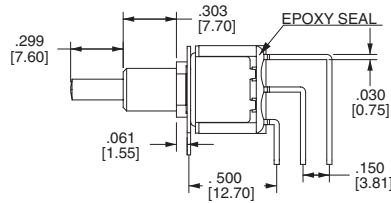
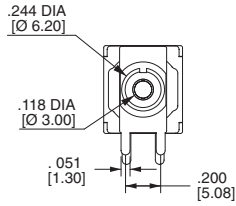

PC MOUNTING

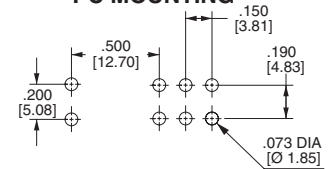

THREE POLE

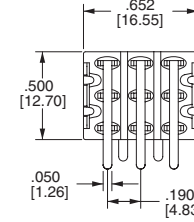
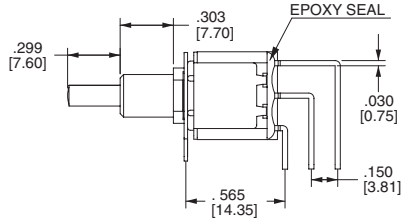
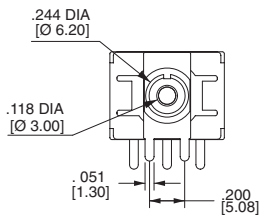

PC MOUNTING

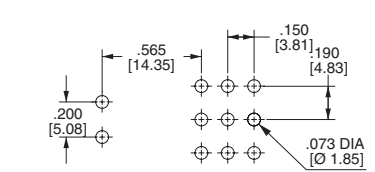

FOUR POLE

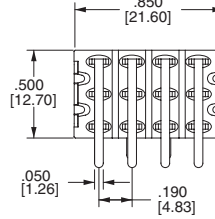
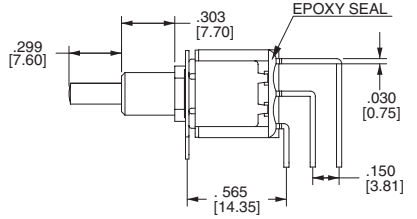
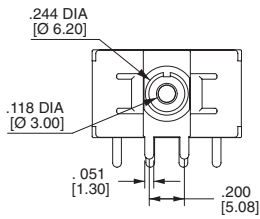

PC MOUNTING

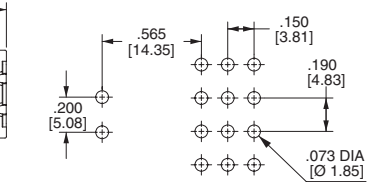

VS2-VS3

OPTION CODE	DIM. "A"
VS2	.460 [11.68]
VS3	.630 [16.00]

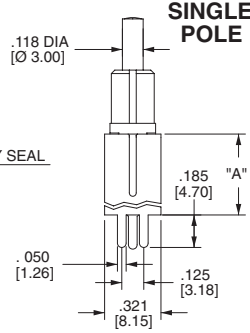
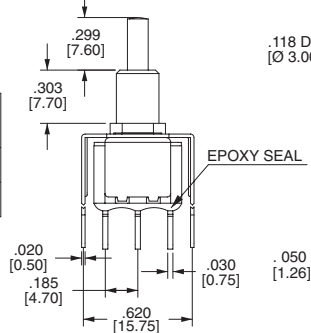

SINGLE POLE PC MOUNTING

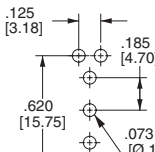

DOUBLE POLE

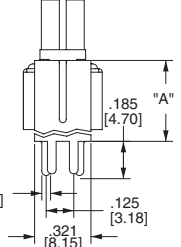

PC MOUNTING

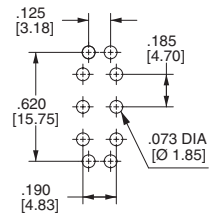

VS4-VS5

OPTION CODE	DIM. "A"
VS4	.460 [11.68]
VS5	.630 [16.00]

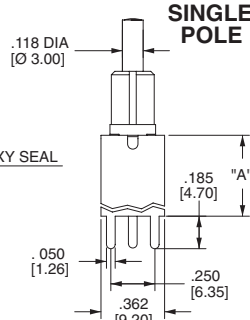
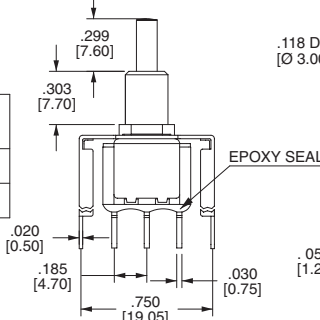

SINGLE POLE PC MOUNTING

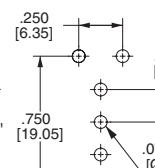

DOUBLE POLE

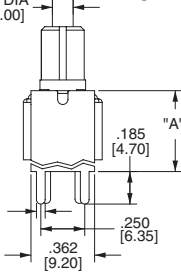

PC MOUNTING

