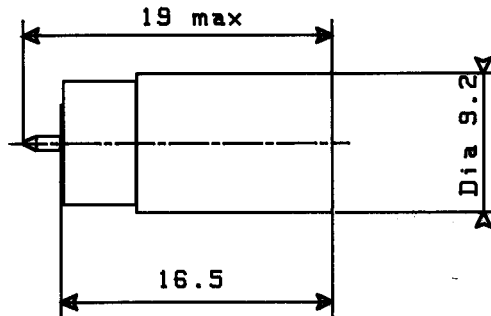

**RADIALL****R451953000****TECHNICAL
DATA SHEET**TITLE REMOVABLE CARTRIDGELTR. ADRAWING:

Mounted in a detector case type R 451576500.

General tolerances : ± 0.5 mmELECTRICAL CHARACTERISTICS:

FREQUENCY RANGE : .01 - 18 GHz
 IMPEDANCE : 50 Ohms
 POLARITY : Positive
 FREQUENCY RESPONSE:
 (0.01 - 8 GHz) : ± 0.2 dB/Octave
 (0.01 - 12.4 GHz) : ± 0.5 dB
 (0.01 - 18 GHz) : ± 1 dB
 V.S.W.R. :
 (0.01 - 8 GHz) : ≤ 1.35
 (8 - 18 GHz) : ≤ 1.50
 SENSITIVITY:
 LOW LEVEL (Input power < -20 dbm): > 500 mV/mW
 HIGH LEVEL (Input power $= 0.35$ mW): > 100 mV
 TANGENTIAL SENSITIVITY : - 44 dB mini
 SQUARE LAW RESPONSE LIMIT : - 12 dBm
 VIDEO IMPEDANCE : 1 k Ω Typical
 VIDEO CAPACITY : 20 pF Typical
 AVERAGE POWER (CW) : 200 mW Maxi
 SCHOTTKY DIODE : $\langle\langle$ Zero bias $\rangle\rangle$

PEN

QUALITY Dpt App.

CAT

MO
B

13 MAY 1992

PAGE

DATE

NAME

1/1

11/05/92

K.LUCIEN

LTR

REVISIONS

DATE

APP.