

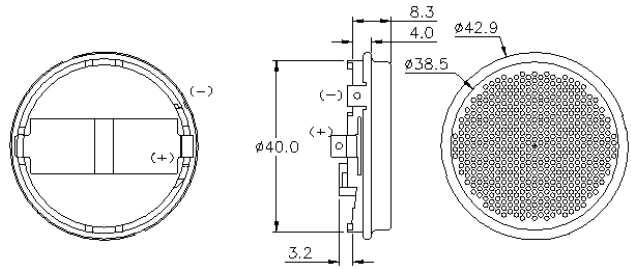

Dimensions: dimensions are in mm



Transmitting Sound Pressure Level

Tested under 300Vac pk-pk, 200Vdc bias @50 cm

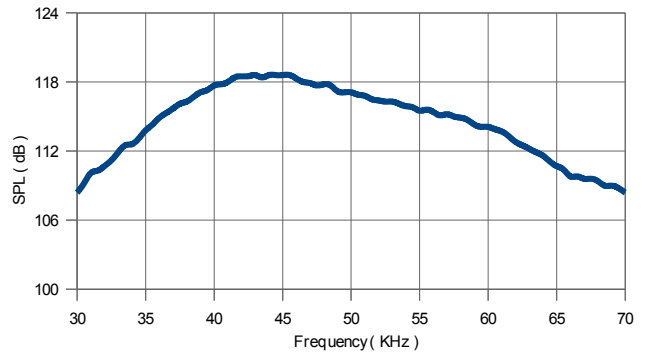

Specification

500ES430	Transceiver
Center Frequency	50.0±1.0KHz
Transmitting Sound Pressure Level at 50.0KHz; 0dB re 20µPa per 300Vac pk-pk, 200Vdc bias at 50 cm	116 dB min.
Receiving Sensitivity at 50.0KHz, 200Vdc bias, 0dB = 1 volt/Pa (0dB =1 volt/µbar)	-43 dB min. (-63 dB) min.
Capacitance at 1KHz ±20%	400 - 500 pF
Suggested DC Bias Voltage	200 V
Suggested AC Driving Voltage	300V pk-pk
Maximum Combined Voltage	400V
Total Beam Angle	-6dB 13° typical
Operation Temperature	0 to 60°C
Standard Finish	
Foil (Diaphragm)	See below
Housing	See below

All specification taken typical at 25°C

Models available

Model	Foil	Housing
500ES43AB	Aluminum	Black Painted Steel
500ES43AS	Aluminum	SUS 304
500ES43GB	Gold	Black Painted Steel
500ES43GS	Gold	SUS 304

Receiving Sensitivity: Tested under 200Vdc bias

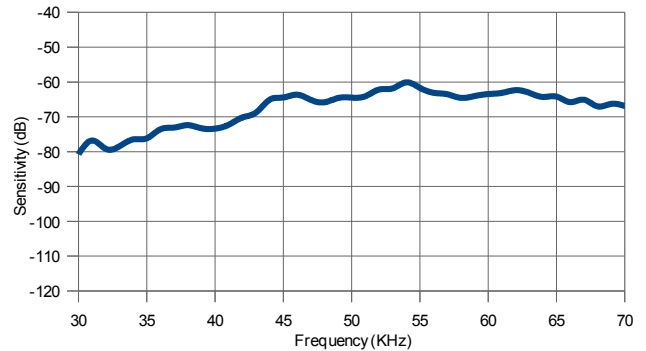

Beam Angle: Tested at 50.0Khz frequency

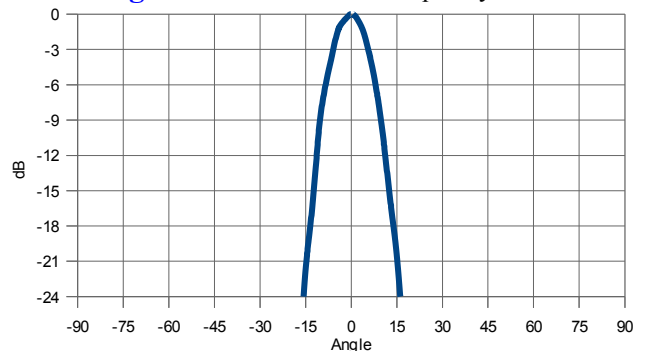

S. Square Enterprise Company Limited
Pro-Wave Electronics Corporation

[Http://www.pro-wave.com.tw](http://www.pro-wave.com.tw) ; E-mail: sales@pro-wave.com.tw ; Tel: 886-2-22465101 ; Fax: 886-2-22465105