

In case of consideration for using Automotive equipment / device which demand high reliability, kindly contact our sales window correspondents.

Jul.1.2019 Copyright 2019 HIROSE ELECTRIC CO., LTD. All Rights Reserved.

COUNT	DESCRIPTION OF REVISIONS	BY	CHKD	DATE	COUNT	DESCRIPTION OF REVISIONS	BY	CHKD	DATE
2	RE-K-01603	MS	M.I	02.02.25					
1									

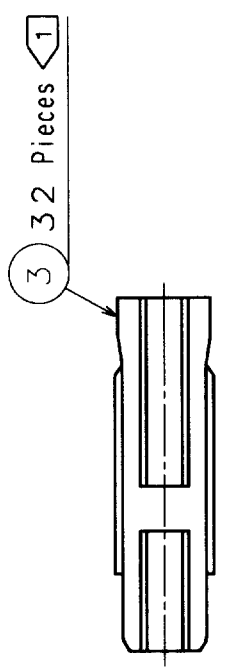
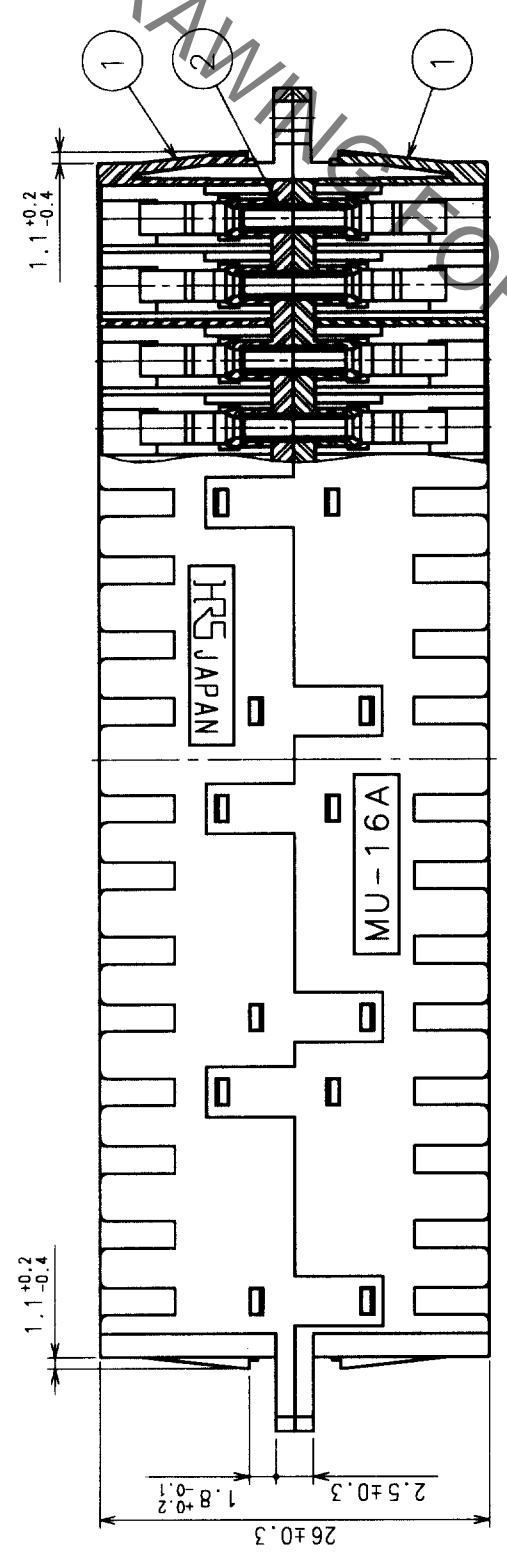
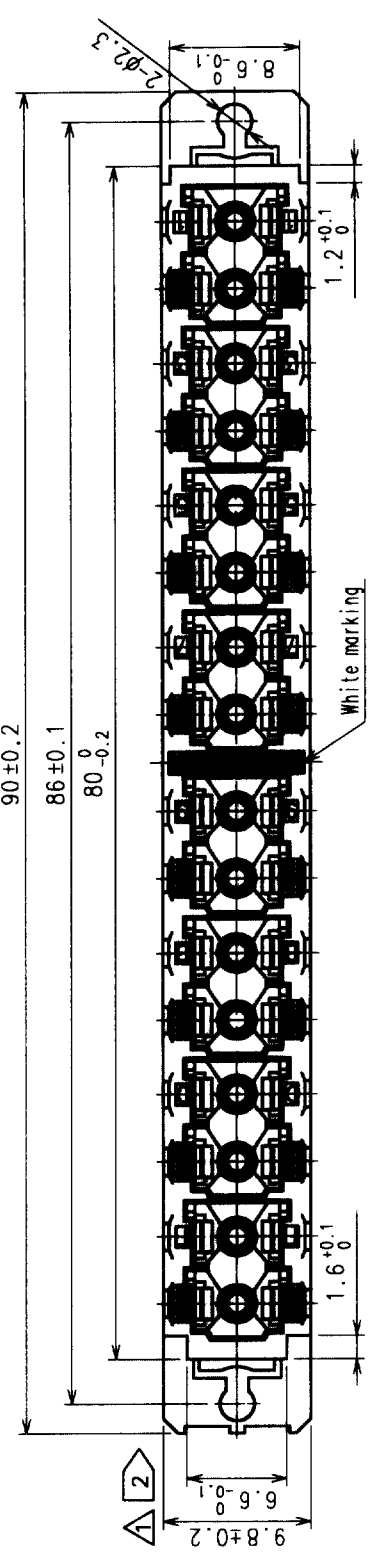

Recommended Panel Cutout
(Panel thickness t = 1.6)

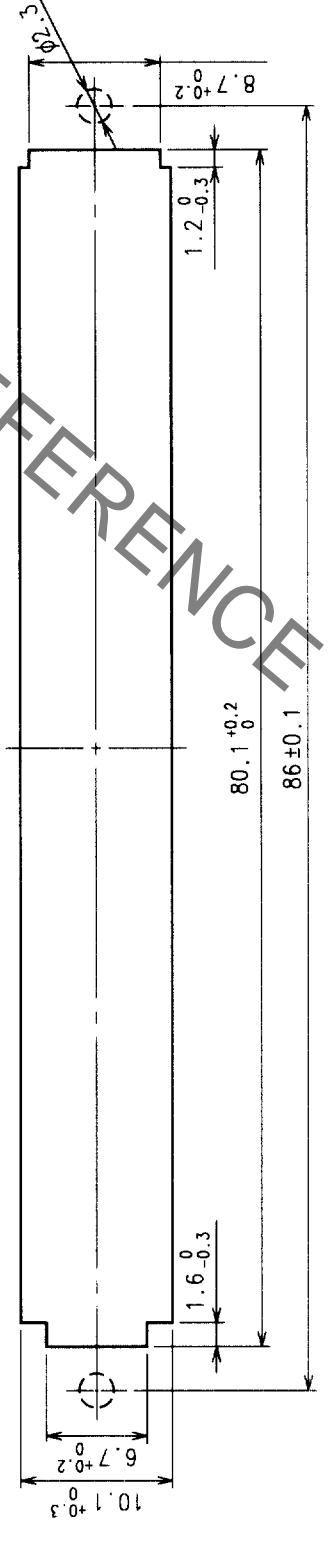

NOTES
 1 Delivered with cap installed.
 2 Correct errors. (Revised configuration)
 A

NO.	ZIRCONIA	SYNTHETIC RESIN	FINISH, REMARKS	DESIGNED	CHECKED	APPROVED	RELEASED
2	ZIRCONIA						
1	SYNTHETIC RESIN						
NO.	MATERIAL	FINISH, REMARKS	DRAWN	DESIGNED	CHECKED	APPROVED	RELEASED
			M. SHIBUTANI	M. SHIBUTANI	M. INOUE	F. MAGA	
			00 10 31	00 10 31	00 11 01	00 11 01	

DRAWING NO.	EDC3-174159	PART NO.	HMUA-16A-2
SCALE	2:1	CODE NO.	CL710-0143-2
UNITS	mm		

TO	
OPT	

HRS DRAWING FOR REFERENCE