

REVISIONS			
REV	DESCRIPTION	DATE	APPROVED
A	INITIAL RELEASE ECO 6709	2/22/13	J Kordik

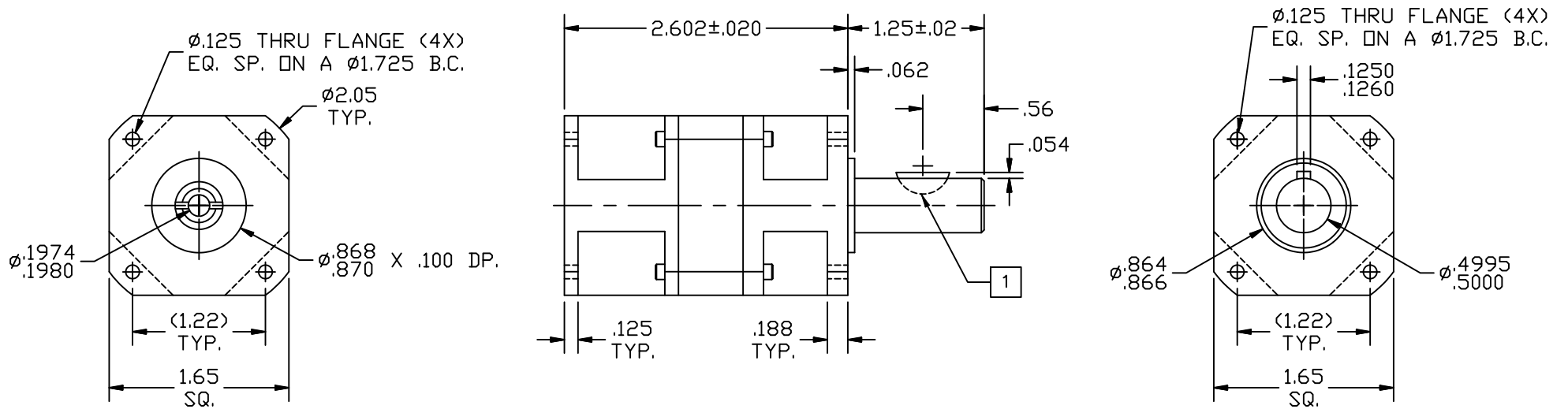

NOTES: UNLESS OTHERWISE SPECIFIED

- 1 #404 WOODRUFF KEY.
2. 17PL010 RATIO- 10:1
3. FOR TECHNICAL DETAILS, CONTACT APPLIED MOTION PRODUCTS.

TOLERANCES	THIRD ANGLE PROJECTION		APPLIED MOTION PRODUCTS, INC.		
DECIMALS: [MM] INCH X.XXX = $\pm .005$ X.XX = $\pm [0.13].010$ X.X = $\pm [0.25].020$					
ANGLES: MACH. = $\pm 5^\circ$ CHAM. = $\pm 5^\circ$					
COMPUTER DATA BASE DRAWING	APPROVALS	DATE	OUTLINE, GEAR HEAD, PL17, 1 STAGE		
	DRAWN <i>R. JONEZ</i>	<i>2/22/13</i>			
	CHECKED		B	DWG NO. 17PL010	REV A
	APPROVED		SCALE: FULL		SHEET 1 OF 1