



- Crimp all three terminals at once.
- Faster loading of plug molds.
- Reduce plug molding and cycle time.
- Reduce plug cost while improving plug quality.
- 7-Shape blades feature ledge to maintain position during overmolding.
- Pass elevated temperature pullout test with low cost PVC.
- Automated terminating equipment is available, see page 8-60.
- See page 8-60 for wire stripper information.
- DFARS Compliant

## Heyco® Preassembled Cordset Components

For Heyco Application Equipment, see pages 8-59 and 8-60

### Male Bridge–NEMA 5-15P

| PART DATA                 |         |           | PART         | APPLICATION TOOLING* |            |                        |       | CRIMP DIMENSIONS |       |
|---------------------------|---------|-----------|--------------|----------------------|------------|------------------------|-------|------------------|-------|
| Type                      | Color   | AWG Range |              | Die                  | Feeds      | Crimp Punch            | Anvil | A in.            | B in. |
| 5-15P Male Bridge         | Black   | 18-14     | <b>S7560</b> | Z360                 | Semi-Auto* | Z318, Z408             | Z302  | .26              | .40   |
|                           | Natural | 18-14     | <b>S7561</b> |                      |            |                        |       |                  |       |
|                           | Clear   | 18-14     | <b>S7596</b> |                      |            |                        |       |                  |       |
| 5-15P Male Bridge Tinned  | Black   | 18-14     | <b>S7564</b> |                      |            |                        |       |                  |       |
|                           | Natural | 18-14     | <b>S7599</b> |                      |            |                        |       |                  |       |
|                           | Clear   | 18-14     | <b>S7598</b> |                      |            |                        |       |                  |       |
| 5-15P Male Bridge 7-Shape | Black   | 18-14     | <b>S7562</b> | Z461                 | Semi-Auto* | Z446, Z454, Z444, Z453 | Z445  | .30              | .44   |
| 5-15P Male Bridge         | Natural | 12-10     | <b>S7590</b> |                      |            |                        |       |                  |       |
|                           | Clear   | 12-10     | <b>S7592</b> |                      |            |                        |       |                  |       |
|                           | Clear   | 12-10     | <b>S7597</b> |                      |            |                        |       |                  |       |
| 5-15P Male Bridge 7-Shape | Black   | 12-10     | <b>S7591</b> |                      |            |                        |       |                  |       |
|                           | Natural | 12-10     | <b>S7593</b> |                      |            |                        |       |                  |       |
|                           | Clear   | 12-10     | <b>S7589</b> |                      |            |                        |       |                  |       |

**NEW!**

7-Shape Blades feature a retention ledge to maintain position during overmolding (mold stop).

\*Semi-Automatic Terminating Equipment is available, see below and page 8-58.



Heyco Male Bridge Machine  
(see page 8-60)

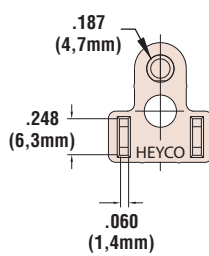

**S7560**

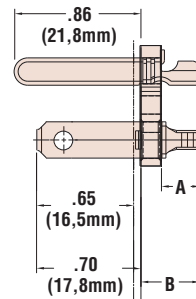

.050 REC. OVERMOLD THICKNESS ON FACE

Quick  
Specs

Materials

Alloy 260 Brass (70% Cu, 30% Zn. Higher Cu content resists dezincification)  
Black and Natural - 6/6 Nylon, Clear - Polycarbonate

Certifications



Recognized Component under UL File E164169 (Component Blades only)



Certified by the Canadian Standards Association File 91824

Standards

NEMA 5-15P