

Slotted pan head tapping screws
DIN 7971-ST 2,2x9,5-F
Maximum screwing torque=0,25 mN

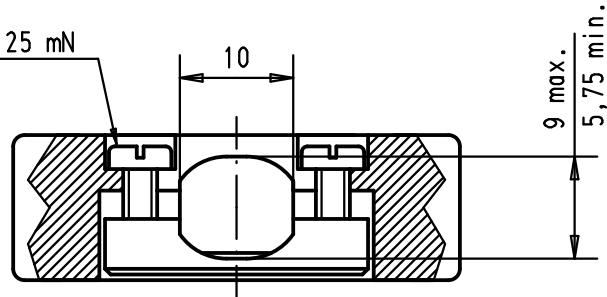

A

						Dat.	Name	 All Dim. in mm Orig. Size DIN A 4	D-Sub, Hood 15 poles, for spring or slide locking, top cable entry	Maßstab/ Scale 1.5:1
					Detail.	28-MAR-02	CV			
					Insp.	25-MAY-11	JMDV			
					Stand.					
09 67 015 0413	Thermoplastic metallized	EC03223	25-MAY-11	SD	HARTING EURL F-95972 Paris			TB 0967015041x	Blatt/ Page 1/	
09 67 015 0411	Thermoplastic grey RAL 7032	29760	28-MAR-02	CV						
Part number	Material	Mod.	Dat.	Name				Sub.		