

**SMA - SMB DETECTOR****R451.539.411****10 - 15 GHz**Series : **DETECTOR**

SCALE 1:1

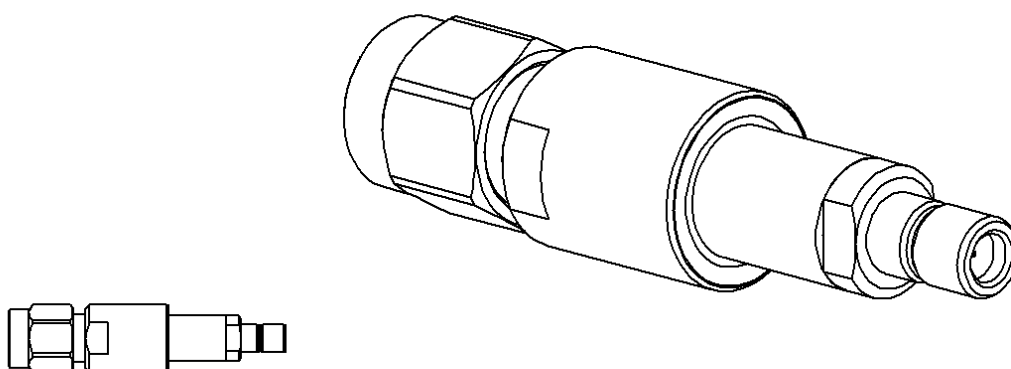
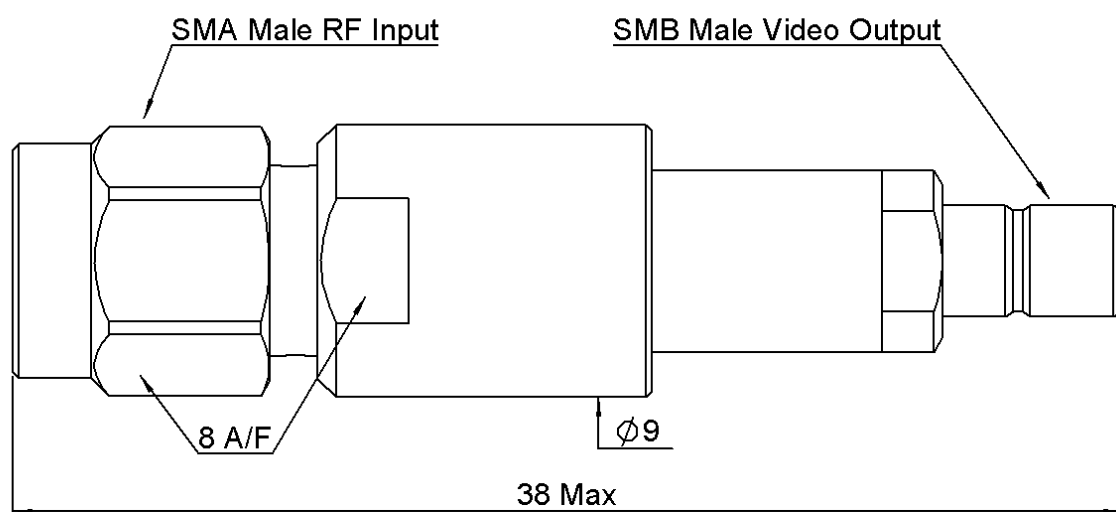
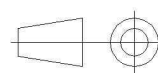

All dimensions are in mm.

Weight **9,0300 g**

Specification

**Issue : 1002 J**

In the effort to improve our products, we reserve the right to make changes judged to be necessary.

**RADIAL** 

**SMA - SMB DETECTOR****10 - 15 GHZ****R451.539.411**Series : **DETECTOR****ELECTRICAL CHARACTERISTICS**

FREQUENCY RANGE (GHz)	10 – 15
IMPEDANCE	50 Ohms
SENSITIVITY LEVEL (Input Power <= -20 dBm)	> 500 mV / mW
FREQUENCY RESPONSE 10 – 15 GHz	± 0.30 dB
VSWR 10 – 15 GHz	<= 1.50
AVERAGE POWER	200 mW at 25°C
PEAK POWER	2W (10 nS , 1mS)
OUTPUT POLARITY	Positive
FILTERING CAPACITY (Typical)	20 pF
DIODE	Schottky “Zero Bias”

**MECHANICAL CHARACTERISTICS**

RF INPUT CONNECTOR	SMA Male Per MIL C 39012
VIDEO OUTPUT CONNECTOR	SMB Male Per MIL C 39012

**ENVIRONMENTAL CHARACTERISTICS**

OPERATING TEMPERATURE RANGE (°C)	- 25 / +65
STORAGE TEMPERATURE RANGE (°C)	- 50 / +70

**Issue : 1002 J**

In the effort to improve our products, we reserve the right to make changes judged to be necessary.

