

REV
NC 0460-244-16**

REVISIONS			
SYM	DESCRIPTION	DATE	APPROVED
NC	NEW RELEASE PER E.O. P19398	11-17-06	ADR

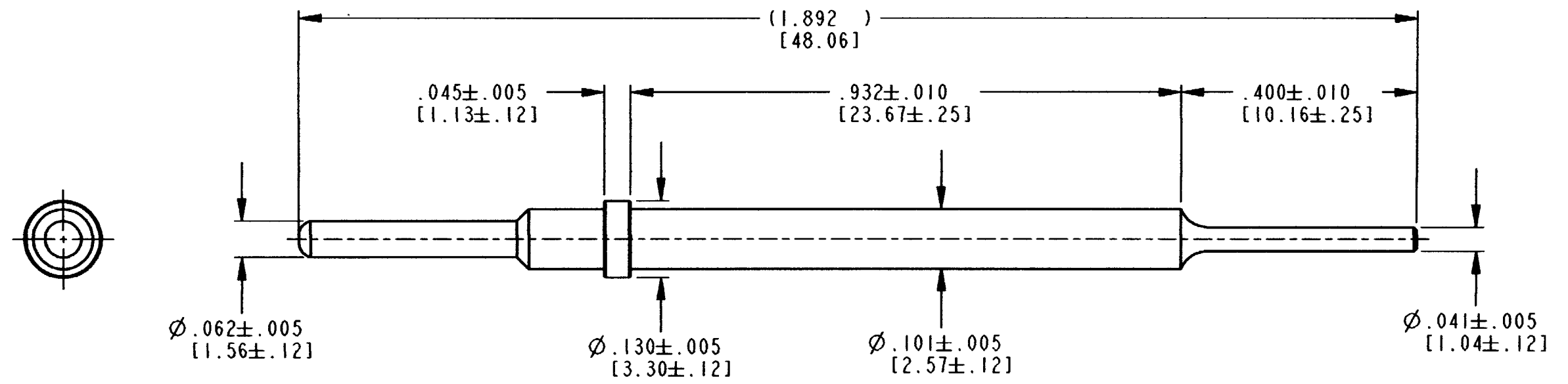

- NOTES:
1. DIMENSIONS ARE IN INCHES [mm].
 2. WHEN ** = 31: PLATING IS GOLD.
WHEN ** = 141: PLATING IS NICKEL.
 3. FOR CONTACT APPLICATION, SEE DRAWING 0425-202-0000.

SIGNATURE & DATE	
DR	J. APOSTOL 24OCT2006
CHK	<i>[Signature]</i> 11/02/06
PE	<i>[Signature]</i> 11/27/06
APPD	<i>[Signature]</i> 11-17-06
SCALE	NONE WT

CONTACT PIN
SIZE 16
EXTENSION

ENVELOPE

EP	MATL. CODE
The Deutsch Company DEUTSCH I.P.D. 3850 INDUSTRIAL AVE. HEMET, CALIF. 92545	
B	0460-244-16**
DWG SIZE	CODE 11139 SHEET OF