

# WRAPOST RECEPTACLES

**FOR .022" - .032" DIAMETER PINS (#06 CONTACT)**  
**FOR .022" - .034" DIAMETER PINS (#16 CONTACT)**

## 2297

**2297-X-17-XX-16-XX-02-0**

Press-fit in .067 mounting hole

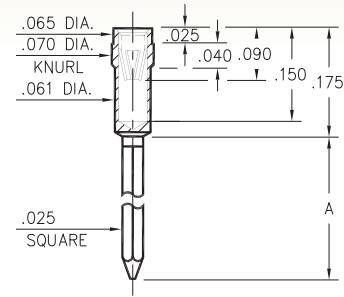

Basic Part Number	# of Wraps	Length A
<b>2297-2</b>	2	.370
<b>2297-3</b>	3	.430

## 0280

**0280-X-17-XX-06-XX-02-0**

Press-fit in .081 mounting hole

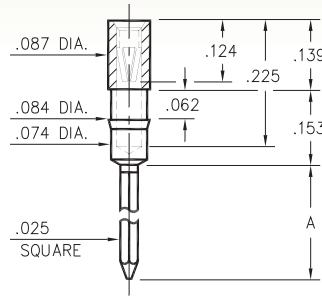

Basic Part Number	# of Wraps	Length A
<b>0280-2</b>	2	.360
<b>0280-3</b>	3	.510

## 0281

**0281-3-17-XX-06-XX-02-0**

Press-fit in .080 mounting hole

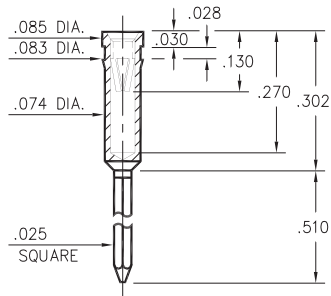

### SPECIFICATIONS:

**Shell Material:** Brass Alloy 360, 1/2 Hard

**Contact Material:** Beryllium Copper Alloy 172, HT

**Dimensions:** Inches

**Tolerances On:** Lengths: ±.005

Diameters: ±.002

Angles: ±2°



**ORDER CODE:** XXXX - X - 17 - XX - XX - XX - 02 - 0

**BASIC PART #** →

**SPECIFY SHELL FINISH:** →

- 01 200 μ" TIN/LEAD OVER NICKEL
- ◆ 80 200 μ" TIN OVER NICKEL (RoHS)
- ◆ 15 10 μ" GOLD OVER NICKEL (RoHS)

**SPECIFY CONTACT FINISH:** →

- 01 200 μ" TIN/LEAD OVER NICKEL
- ◆ 80 200 μ" TIN OVER NICKEL (RoHS)
- ◆ 27 30 μ" GOLD OVER NICKEL (RoHS)

**SELECT CONTACT:**

**#06 or #16 CONTACT** (DATA ON PAGES 255 & 256)  
 (For alternate contact choices, see group D on page 248)

