

NOTES:

1. SHELL MATERIAL: BRASS ALLOY 360 OR 385.
2. SHELL FINISH: 10 micro inches GOLD OVER 100 micro inches NICKEL.
3. CONTACT MATERIAL: BERYLLIUM COPPER ALLOY 172, HEAT TREATED.
4. CONTACT FINISH: 30 micro inches GOLD OVER 50 micro inches NICKEL.
5. INSULATOR MATERIAL: EPOXY TYPE FR-4, RATED UL 94 V-O.

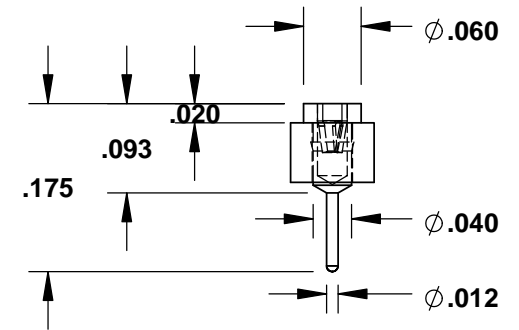
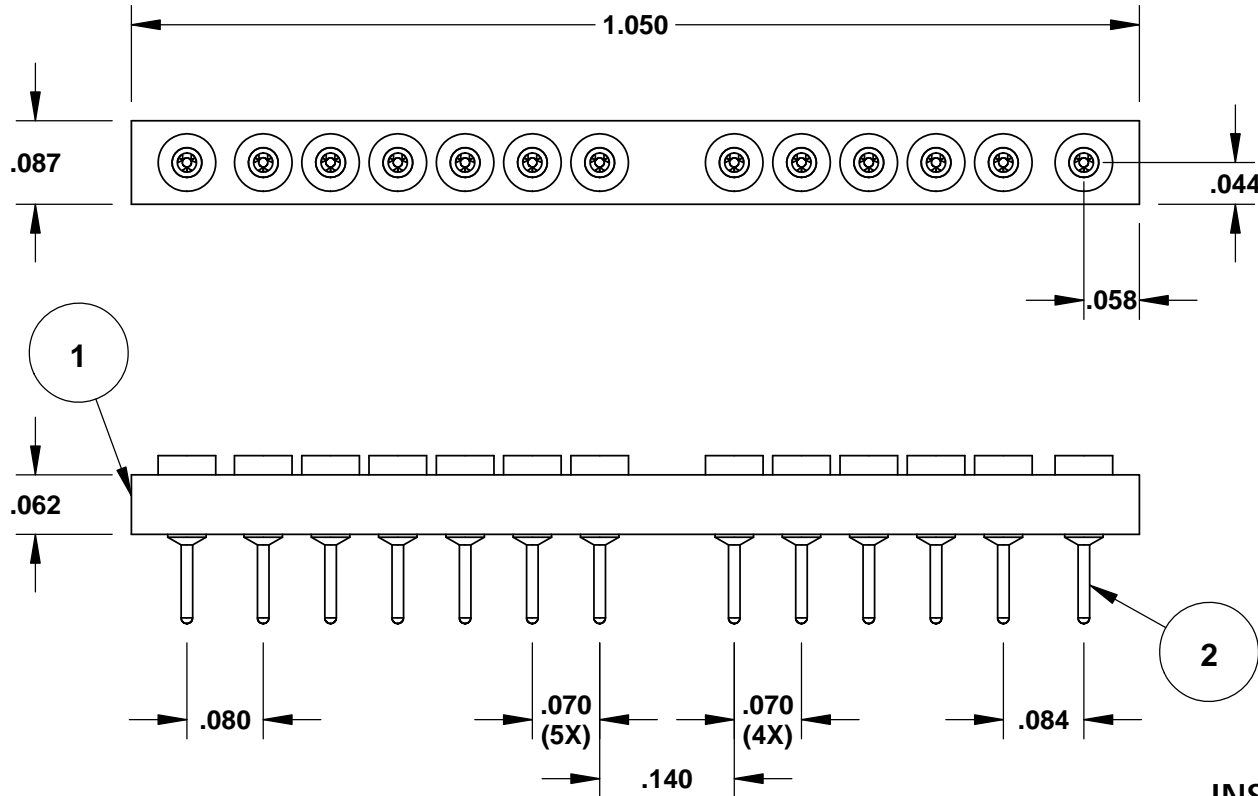
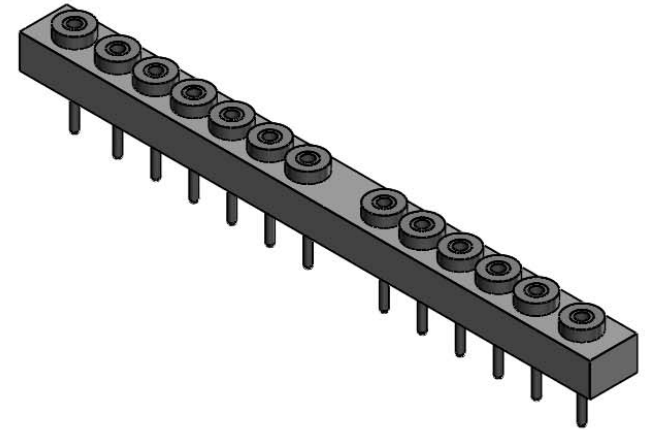

INSULATOR HOLE DIAMETERS ARE .042"

ITEM NO.	PART NUMBER	DESCRIPTION	QTY.	MATERIAL: SEE NOTES X & X	CORNER BREAKS AND FILLETS .002" MAX.	THIS DRAWING CONTAINS INFORMATION PROPRIETARY TO MILL-MAX MFG. CORP. ANY REPRODUCTION OR USE OF THIS DOCUMENT IS PROHIBITED WITHOUT THE WRITTEN CONSENT OF MILL-MAX MFG. CORP.	MILL-MAX® MFG. CORP. P.O. BOX 300, 190 PINE HOLLOW ROAD OYSTER BAY, N.Y. 11771-0300 TEL: (516) 922-6000, FAX: (516) 922-9253 WEB-SITE: www.MILL-MAX.com
1	TO BE DETERMINED	CUSTOM FR-4 INSULATOR	1	FINISH: SEE NOTES X & X		DRAWN: LN	DATE: 6/30/16
2	7491-0-15-15-09-27-04-0	RECEPTACLE	13	PIN SURFACE AREA: X	TOLERANCES UNLESS OTHERWISE SPECIFIED PIN TOLERANCE: LENGTHS $\pm .005$ DIAMETERS $\pm .002$ ANGLES $\pm 2$ INSULATOR TOLERANCE: LENGTHS $\pm .005$ THICKNESS $\pm .003$	CHECKED: X	ENGINEER: LN
X	X	X	X	UNITS OF MEASUREMENT: INCHES		CUSTOMER: SCT CERAMICS FRANCE	DESCRIPTION: CUSTOM 13 POSITION SOCKET
REV.	DESCRIPTION	BY	DATE	ECN NO.		APPROVAL:	DRAWING NUMBER: TO BE DETERMINED
							REV. -
						FILE NAME: 'MAX8/PROPOSALS/XXXX.drw	SHEET X OF X